

TOWER - 09_3RD TO 15, 17TH TO 24, 26TH TO 33TH & 35TH TO 41TH FLOOR PLAN ROAD SIDE

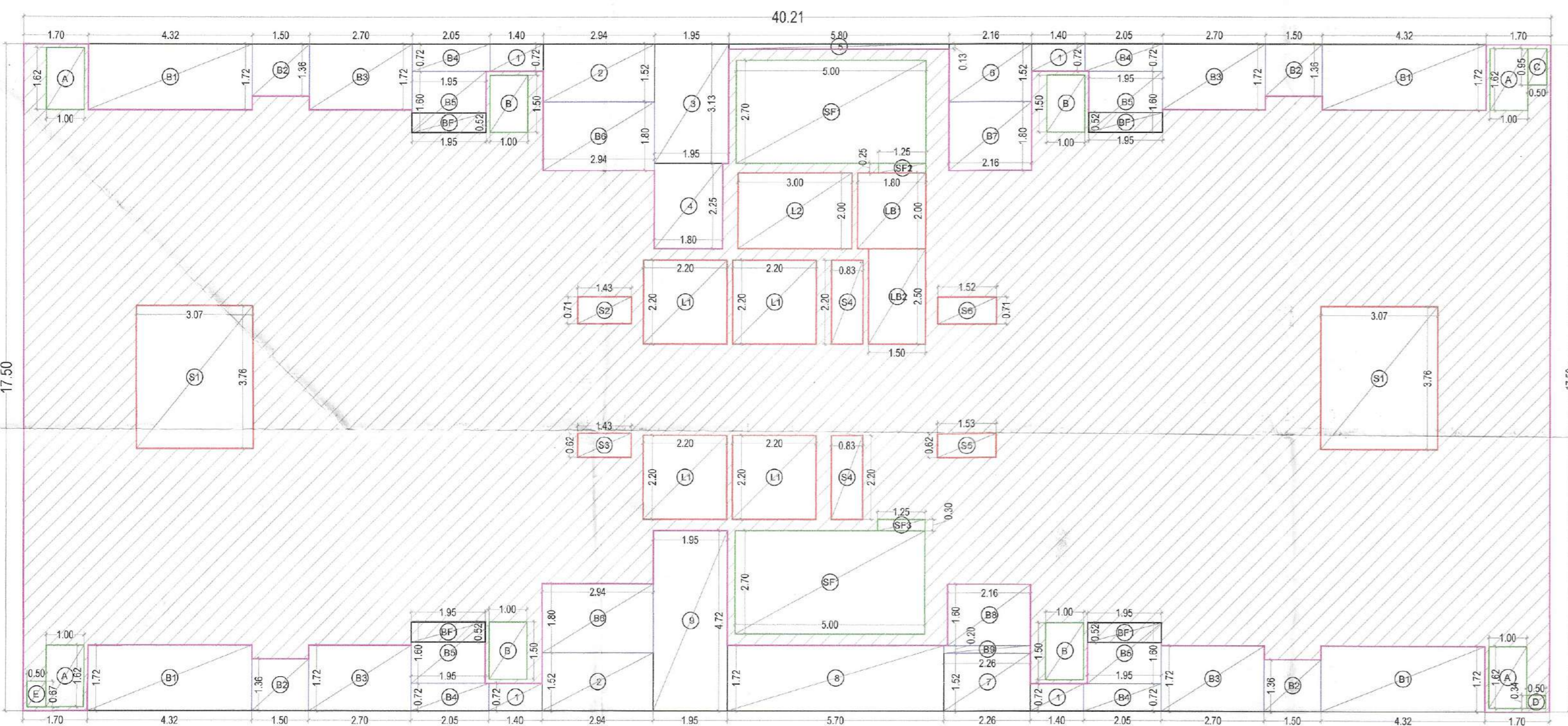

TYPE C TOWER 09_3RD TO 15, 17TH TO 24, 26TH TO 41ST AREA LINE DIAGRAM

PLUMBING LEGEND:-

- 110 OD SOL. & VENT PIPE
- 110 OD WASTE & VENT PIPE
- 110 OD KITCHEN WASTE & VENT PIPE
- 100 OD ANTI-SIPHONAGE PIPE
- DOMESTIC WATER SUPPLY DOWN TAKE PIPE
- FLUSHING WATER SUPPLY DOWN TAKE PIPE
- 150 OD RAIN WATER PIPE FOR TERRACE
- DOMESTIC WATER RISER PIPE
- FLUSHING WATER RISER PIPE
- 110 OD CONDENSATE WATER DRAIN PIPE
- ACCESS DOOR
- R.L. ROAD LEVEL
- INVERT LEVEL OF PIPE
- CL CONNECTION LEVEL

FAR AREA AT TYPE C TOWER 9 TYPICAL FLOOR (All Distances are in Meter & Areas in Sqm)						
ITEM	NO.S	SHAP	FORMULA	WIDTH (MTR.)	LENGTH (MTR.)	AREA(SQ.MT.)
A	1	RECTANGLE	L X B	40.210	17.500	703.675
TOTAL (A) =						703.675
BALCONY IN NON FAR AREA (B)						
ITEM	NO.S	SHAP	FORMULA	WIDTH (MTR.)	LENGTH (MTR.)	AREA(SQ.MT.)
B1	4	RECTANGLE	L X B	4.320	1.720	29.722
B2	4	RECTANGLE	L X B	1.500	1.300	8.100
B3	4	RECTANGLE	L X B	2.700	1.720	18.576
B4	4	RECTANGLE	L X B	2.050	0.720	5.904
B5	4	RECTANGLE	L X B	1.800	1.950	12.480
B6	2	RECTANGLE	L X B	2.940	1.800	10.584
B7	1	RECTANGLE	L X B	2.160	1.800	3.888
B8	1	RECTANGLE	L X B	2.160	1.800	3.456
B9	1	RECTANGLE	L X B	2.280	0.200	0.452
TOTAL (B) =						93.222
BALCONY IN FAR AREA (C)						
ITEM	NO.S	SHAP	FORMULA	WIDTH (MTR.)	LENGTH (MTR.)	AREA(SQ.MT.)
BF1	4	RECTANGLE	L X B	1.950	0.520	4.056
TOTAL (C) =						4.056
NON FAR SERVICES SHAFT AREA (D)						
ITEM	NO.S	SHAP	FORMULA	WIDTH (MTR.)	LENGTH (MTR.)	AREA(SQ.MT.)
A	4	RECTANGLE	L X B	1.000	1.620	6.480
B	4	RECTANGLE	L X B	1.000	1.500	6.000
C	1	RECTANGLE	L X B	0.500	0.950	0.475
D	1	RECTANGLE	L X B	0.500	0.340	0.170
E	1	RECTANGLE	L X B	0.500	0.670	0.335
TOTAL (D) =						13.460
CUTOUT AREA (E)						
ITEM	NO.S	SHAP	FORMULA	WIDTH (MTR.)	LENGTH (MTR.)	AREA(SQ.MT.)
1	4	RECTANGLE	L X B	1.400	0.720	4.032
2	2	RECTANGLE	L X B	2.940	1.520	8.938
3	1	RECTANGLE	L X B	1.950	3.130	6.104
4	1	RECTANGLE	L X B	1.800	2.250	4.050
5	1	RECTANGLE	L X B	5.800	0.130	0.754
6	1	RECTANGLE	L X B	2.160	1.520	3.283
7	1	RECTANGLE	L X B	2.260	1.520	3.435
8	1	RECTANGLE	L X B	5.700	1.720	9.804
9	1	RECTANGLE	L X B	1.950	4.720	9.204
TOTAL (E) =						49.604
NON FAR SERVICE SHAFT & LIFT (F)						
ITEM	NO.S	SHAP	FORMULA	WIDTH (MTR.)	LENGTH (MTR.)	AREA(SQ.MT.)
L1	4	RECTANGLE	L X B	2.200	2.200	19.360
L2	1	RECTANGLE	L X B	2.000	3.000	6.000
S1	2	RECTANGLE	L X B	3.070	3.760	23.088
S2	1	RECTANGLE	L X B	0.710	1.430	1.015
S3	1	RECTANGLE	L X B	1.43	0.62	0.887
S4	2	RECTANGLE	L X B	0.830	2.200	3.652
S5	1	RECTANGLE	L X B	1.530	0.620	0.949
S6	1	RECTANGLE	L X B	1.520	0.710	1.079
TOTAL (F) =						56.028
NON FAR STAIRCASE AREA (G)						
ITEM	NO.S	SHAP	FORMULA	WIDTH (MTR.)	LENGTH (MTR.)	AREA(SQ.MT.)
SF1	2	RECTANGLE	L X B	5.000	2.700	27.000
SF2	1	RECTANGLE	L X B	1.250	0.250	0.313
SF3	1	RECTANGLE	L X B	1.250	0.300	0.375
LB1	1	RECTANGLE	L X B	1.800	2.000	3.600
LB2	1	RECTANGLE	L X B	1.500	2.500	3.750
TOTAL (G) =						35.038
TOTAL FAR AREA AT TYP LVL = (A - B - C - D - E + F + G) H						
A	B	C	D	E	F	G
703.675	93.2216	13.460	49.604	56.028	35.038	4.056
TOTAL FAR (H) =						468.3803
TOTAL BUILT UP AREA (A-C-D-E)						
A	C	D	E			
703.675	13.460	49.604	56.028			
TOTAL FAR (H)						584.5834
						SQ.MT

DOOR SCHEDULE FLOOR (TOWER-9,10 & 11)

S.NO	TYPE	OPENING	LINTEL (FROM FLOOR)	SILL	HEIGHT	LOCATION
1	D1	1200	2450	50	2400	(MAIN DOOR); 0.6 HRS FIRE RATED DOOR
2	D2	900	2450	50	2400	BED ROOM, S ROOM
3	D3	750	2450	50	2400	TOILET BALCONY
4	D4	600	2450	50	2400	TOILET BALCONY
5	FDS	1800	2450	350	2100	FHC SHAFT
6	FD	1200	2450	50	2400	REFUGE (2.0 HRS FIRE RATED DOOR)

WINDOW SCHEDULE FLOOR (TOWER-9,10 & 11)

S.NO	TYPE	OPENING	LINTEL (FROM FLOOR)	SILL	HEIGHT	LOCATION
1	SD1	1650	2650	50	2550	LIVING/DINING
2	SD2	1600	2650	50	2550	M.BEDROOM
3	SD3	2000	2650	50	2550	BEDROOM-1 & 2
4	SD4	1200	2650	50	2550	KITCHEN
5	W	1500	2511	1111	1400	STAIRCASE
6	W1	1500	2750	950	1750	STAIRCASE
7	V	750	2700	1650	1050	TOILET

CLIENT:
SIGNATUREGLOBAL HOMES PVT. LTD

ARCHITECT:
NISAR AHMED ANSARI
ARCHITECT (B.ARCH)
CA/2205/36034

PROJECT:
PROPOSED MIXED LAND USE COLONY (96% RESIDENTIAL COMPONENT & 4% COMMERCIAL COMPONENT) UNDER TOD POLICY ON THE AREA MEASURING 13.5656 ACRES IN THE REVENUE ESTATE GADAUJI KALAN, SECTOR 37D, GURUGRAM MANESAR URBAN COMPLEX, LICENSE NO.172 OF 2024, DATED 03.12.2024, BEING DEVELOPED BY SIGNATUREGLOBAL HOMES PVT. LTD

DRAWING TITLE:
TOWER - 09_3RD TO 15TH, 17TH TO 24TH, 26TH TO 41ST TYPICAL FLOOR & AREA LINE DIAGRAM

SHEET NO. 55

SCALE:- 1:100

DATE:- 2025.08.14

ARCHITECT'S SIGN: NISAR AHMED ANSARI ARCHITECT (B.ARCH) CA/2205/36034

OWNER'S SIGN: SIGNATUREGLOBAL HOMES PVT. LTD

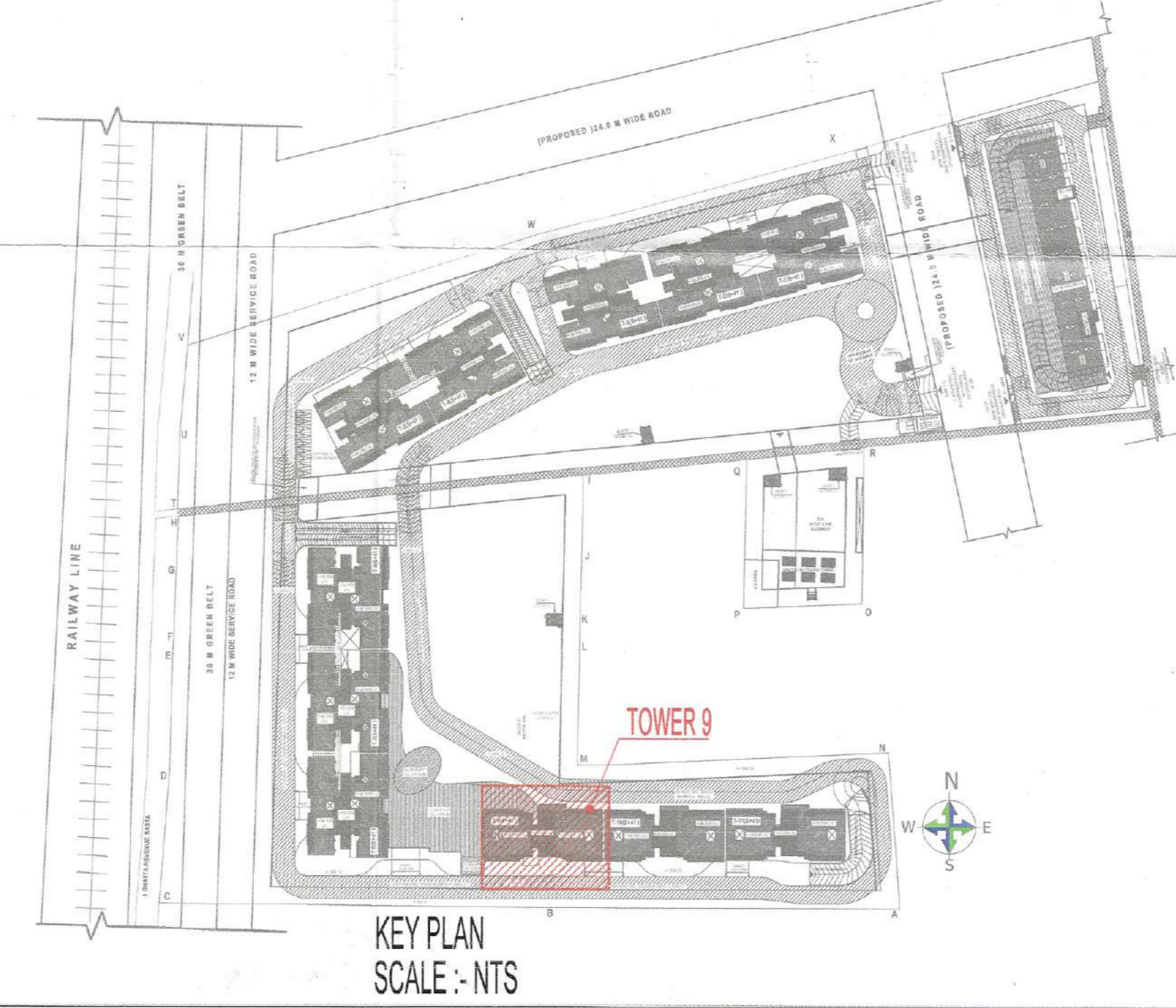

KEY PLAN SCALE :- NTS

Checked and found ok for Public Health (Internal) Service only subject to comments in forwarding letter No. 296976... Dt. 09/09/2025

Checked and found ok for Public Health (Internal) Service only subject to comments in forwarding letter No. 296976... Dt. 09/09/2025

Checked and found ok for Public Health (Internal) Service only subject to comments in forwarding letter No. 296976... Dt. 09/09/2025

Checked and found ok for Public Health (Internal) Service only subject to comments in forwarding letter No. 296976... Dt. 09/09/2025

Checked and found ok for Public Health (Internal) Service only subject to comments in forwarding letter No. 296976... Dt. 09/09/2025

Checked and found ok for Public Health (Internal) Service only subject to comments in forwarding letter No. 296976... Dt. 09/09/2025

Checked and found ok for Public Health (Internal) Service only subject to comments in forwarding letter No. 296976... Dt. 09/09/2025

Checked and found ok for Public Health (Internal) Service only subject to comments in forwarding letter No. 296976... Dt. 09/09/2025

Checked and found ok for Public Health (Internal) Service only subject to comments in forwarding letter No. 296976... Dt. 09/09/2025

Checked and found ok for Public Health (Internal) Service only subject to comments in forwarding letter No. 296976... Dt. 09/09/2025

Checked and found ok for Public Health (Internal) Service only subject to comments in forwarding letter No. 296976... Dt. 09/09/2025

Checked and found ok for Public Health (Internal) Service only subject to comments in forwarding letter No. 296976... Dt. 09/09/2025

Checked and found ok for Public Health (Internal) Service only subject to comments in forwarding letter No. 296976... Dt. 09/09/2025

Checked and found ok for Public Health (Internal) Service only subject to comments in forwarding letter No. 296976... Dt. 09/09/2025

Checked and found ok for Public Health (Internal) Service only subject to comments in forwarding letter No. 296976... Dt. 09/09/2025

Checked and found ok for Public Health (Internal) Service only subject to comments in forwarding letter No. 296976... Dt. 09/09/2025

Checked and found ok for Public Health (Internal) Service only subject to comments in forwarding letter No. 296976... Dt. 09/09/2025

Checked and found ok for Public Health (Internal) Service only subject to comments in forwarding letter No. 296976... Dt. 09/09/2025

Checked and found ok for Public Health (Internal) Service only subject to comments in forwarding letter No. 296976... Dt. 09/09/2025

Checked and found ok for Public Health (Internal) Service only subject to comments in forwarding letter No. 296976... Dt. 09/09/2025

Checked and found ok for Public Health (Internal) Service only subject to comments in forwarding letter No. 296976... Dt. 09/09/2025

Checked and found ok for Public Health (Internal) Service only subject to comments in forwarding letter No. 296976... Dt. 09/09/2025

Checked and found ok for Public Health (Internal) Service only subject to comments in forwarding letter No. 296976... Dt. 09/09/2025

Checked and found ok for Public Health (Internal) Service only subject to comments in forwarding letter No. 296976... Dt. 09/09/2025

Checked and found ok for Public Health (Internal) Service only subject to comments in forwarding letter No. 296976... Dt. 09/09/2025

Checked and found ok for Public Health (Internal) Service only subject to comments in forwarding letter No. 296976... Dt. 09/09/2025

Checked and found ok for Public Health (Internal) Service only subject to comments in forwarding letter No. 296976... Dt. 09/09/2025

Checked and found ok for Public Health (Internal) Service only subject to comments in forwarding letter No. 296976... Dt. 09/09/2025

Checked and found ok for Public Health (Internal) Service only subject to comments in forwarding letter No. 296976... Dt. 09/09/2025

Checked and found ok for Public Health (Internal) Service only subject to comments in forwarding letter No. 296976... Dt. 09/09/2025

Checked and found ok for Public Health (Internal) Service only subject to comments in forwarding letter No. 296976... Dt. 09/09/2025

Checked and found ok for Public Health (Internal) Service only subject to comments in forwarding letter No. 296976... Dt. 09/09/2025

Checked and found ok for Public Health (Internal) Service only subject to comments in forwarding letter No. 296976... Dt. 09/09/2025

Checked and found ok for Public Health (Internal) Service only subject to comments in forwarding letter No. 296976... Dt. 09/09/2025

Checked and found ok for Public Health (Internal) Service only subject to comments in forwarding letter No. 296976... Dt. 09/09/2025

Checked and found ok for Public Health (Internal) Service only subject to comments in forwarding letter No. 296976... Dt. 09/09/2025

Checked and found ok for Public Health (Internal) Service only subject to comments in forwarding letter No. 296976... Dt. 09/09/2025

Checked and found ok for Public Health (Internal) Service only subject to comments in forwarding letter No. 296976... Dt. 09/09/2025

Checked and found ok for Public Health (Internal) Service only subject to comments in forwarding letter No. 296976... Dt. 09/09/2025

Checked and found ok for Public Health (Internal) Service only subject to comments in forwarding letter No. 296976... Dt. 09/09/2025

Checked and found ok for Public Health (Internal) Service only subject to comments in forwarding letter No. 296976... Dt. 09/09/2025

Checked and found ok for Public Health (Internal) Service only subject to comments in forwarding letter No. 296976... Dt. 09/09/2025

Checked and found ok for Public Health (Internal) Service only subject to comments in forwarding letter No. 296976... Dt. 09/09/2025

Checked and found ok for Public Health (Internal) Service only subject to comments in forwarding letter No. 296976... Dt. 09/09/2025

Checked and found ok for Public Health (Internal) Service only subject to comments in forwarding letter No. 296976... Dt. 09/09/2025

Checked and found ok for Public Health (Internal) Service only subject to comments in forwarding letter No. 296976... Dt. 09/09/2025

Checked and found ok for Public Health (Internal) Service only subject to comments in forwarding letter No. 296976... Dt. 09/09/2025

Checked and found ok for Public Health (Internal) Service only subject to comments in forwarding letter No. 296976... Dt. 09/09/2025

Checked and found ok for Public Health (Internal) Service only subject to comments in forwarding letter No. 296976... Dt. 09/09/2025

Checked and found ok for Public Health (Internal) Service only subject to comments in forwarding letter No. 296976... Dt. 09/09/2025

Checked and found ok for Public Health (Internal) Service only subject to comments in forwarding letter No. 296976... Dt. 09/09/2025

Checked and found ok for Public Health (Internal) Service only subject to comments in forwarding letter No. 296976... Dt. 09/09/2025

Checked and found ok for Public Health (Internal) Service only subject to comments in forwarding letter No. 296976... Dt. 09/09/2025

Checked and found ok for Public Health (Internal) Service only subject to comments in forwarding letter No. 296976... Dt. 09/09/2025

Checked and found ok for Public Health (Internal) Service only subject to comments in forwarding letter No. 296976... Dt. 09/09/2025

Checked and found ok for Public Health (Internal) Service only subject to comments in forwarding letter No. 296976... Dt. 09/09/2025

Checked and found ok for Public Health (Internal) Service only subject to comments in forwarding letter No. 296976... Dt. 09/09/2025

Checked and found ok for Public Health (Internal) Service only subject to comments in forwarding letter No. 296976... Dt. 09/09/2025

Checked and found ok for Public Health (Internal) Service only subject to comments in forwarding letter No. 296976... Dt. 09/09/2025

Checked and found ok for Public Health (Internal) Service only subject to comments in forwarding letter No. 296976... Dt. 09/09/2025

Checked and found ok for Public Health (Internal) Service only subject to comments in forwarding letter No. 296976... Dt. 09/09/2025

Checked and found ok for Public Health (Internal) Service only subject to comments in forwarding letter No. 296976... Dt. 09/09/2025

Checked and found ok for Public Health (Internal) Service only subject to comments in forwarding letter No. 296976... Dt. 09/09/2025

Checked and found ok for Public Health (Internal) Service only subject to comments in forwarding letter No. 296976... Dt. 09/09/2025

Checked and found ok for Public Health (Internal) Service only subject to comments in forwarding letter No. 296976... Dt. 09/09/2025

Checked and found ok for Public Health (Internal) Service only subject to comments in forwarding letter No. 296976... Dt. 09/09/2025

Checked and found ok for Public Health (Internal) Service only subject to comments in forwarding letter No. 296976... Dt. 09/09/2025

Checked and found ok for Public Health (Internal) Service only subject to comments in forwarding letter No. 296976... Dt. 09/09/2025

Checked and found ok for Public Health (Internal) Service only subject to comments in forwarding letter No. 296976... Dt. 09/09/2025

Checked and found ok for Public Health (Internal) Service only subject to comments in forwarding letter No. 296976... Dt. 09/09/2025

Checked and found ok for Public Health (Internal) Service only subject to comments in forwarding letter No. 296976... Dt. 09/09/2025

Checked and found ok for Public Health (Internal) Service only subject to comments in forwarding letter No. 296976... Dt. 09/09/2025

Checked and found ok for Public Health (Internal) Service only subject to comments in forwarding letter No. 296976... Dt. 09/09/2025

Checked and found ok for Public Health (Internal) Service only subject to comments in forwarding letter No. 296976... Dt. 09/09/2025

Checked and found ok for Public Health (Internal) Service only subject to comments in forwarding letter No. 296976... Dt. 09/09/2025

Checked and found ok for Public Health (Internal) Service only subject to comments in forwarding letter No. 296976... Dt. 09/09/2025

Checked and found ok for Public Health (Internal) Service only subject to comments in forwarding letter No. 296976... Dt. 09/09/2025

Checked and found ok for Public Health (Internal) Service only subject to comments in forwarding letter No. 296976... Dt. 09/09/2025

Checked and found ok for Public Health (Internal) Service only subject to comments in forwarding letter No. 296976... Dt. 09/09/2025

Checked and found ok for Public Health (Internal) Service only subject to comments in forwarding letter No. 296976... Dt. 09/09/2025

Checked and found ok for Public Health (Internal) Service only subject to comments in forwarding letter No. 296976... Dt. 09/09/2025

Checked and found ok for Public Health (Internal) Service only subject to comments in forwarding letter No. 296976... Dt. 09/09/2025

Checked and found ok for Public Health (Internal) Service only subject to comments in forwarding letter No. 296976... Dt. 09/09/2025

Checked and found ok for Public Health (Internal) Service only subject to comments in forwarding letter No. 296976... Dt. 09/09/2025

Checked and found ok for Public Health (Internal) Service only subject to comments in forwarding letter No. 296976... Dt. 09/09/2025

Checked and found ok for Public Health (Internal) Service only subject to comments in forwarding letter No. 296976... Dt. 09/09/2025

Checked and found ok for Public Health (Internal) Service only subject to comments in forwarding letter No. 296976... Dt. 09/09/2025

Checked and found ok for Public Health (Internal) Service only subject to comments in forwarding letter No. 296976... Dt. 09/09/2025

Checked and found ok for Public Health (Internal) Service only subject to comments in forwarding letter No. 296976... Dt. 09/09/2025

Checked and found ok for Public Health (Internal) Service only subject to comments in forwarding letter No. 296976... Dt. 09/09/2025

Checked and found ok for Public Health (Internal) Service only subject to comments in forwarding letter No. 296976... Dt. 09/09/2025

Checked and found ok for Public Health (Internal) Service only subject to comments in forwarding letter No. 296976... Dt. 09/09/2025

Checked and found ok for Public Health (Internal) Service only subject to comments in forwarding letter No. 296976... Dt. 09/09/2025

Checked and found ok for Public Health (Internal) Service only subject to comments in forwarding letter No. 296976... Dt. 09/09/2025

Checked and found ok for Public Health (Internal) Service only subject to comments in forwarding letter No. 296976... Dt. 09/09/2025

Checked and found ok for Public Health (Internal) Service only subject to comments in forwarding letter No. 296976... Dt. 09/09/2025

Checked and found ok for Public