

This drawing is a "COPYRIGHT" contents of this drawing or part thereof may not be used or reproduced without the permission of the Architect.

S.T.P.(S) C.V.(P) Chairman
 Member/Secretary B.P.A.C. B.P.A.C.
 T.T.P.(H.Q.) A.T.P.(H.Q.)
 AD PA ATP
 RAJESH DUTT SD(HQ)
 FSD (H) Member B.P.A.C.

SACTIONED TO BE READ WITH THIS OFFICE MEMORANDUM NO. 24/62 DATED: 20/11/2016

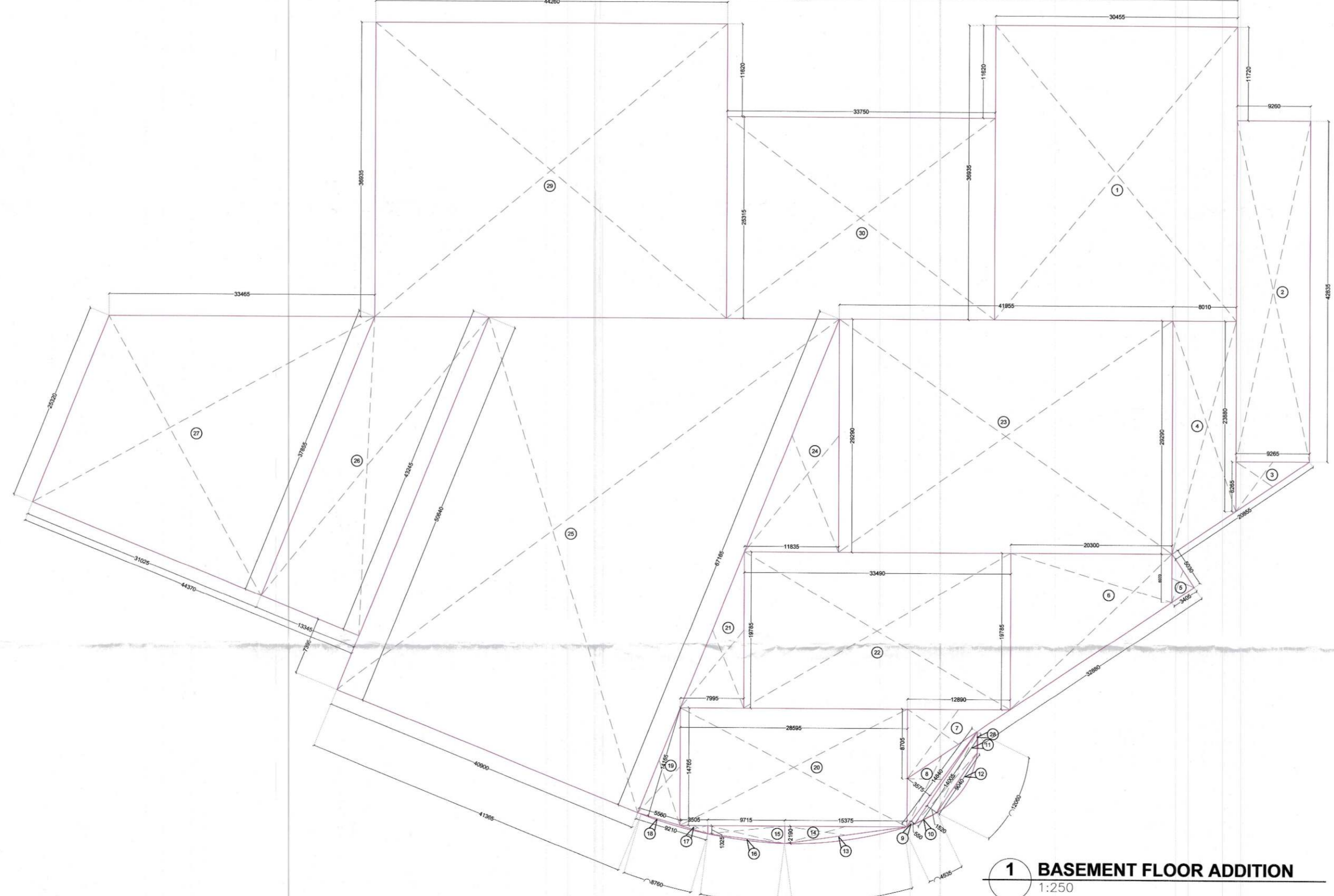

1 BASEMENT FLOOR ADDITION
1:250

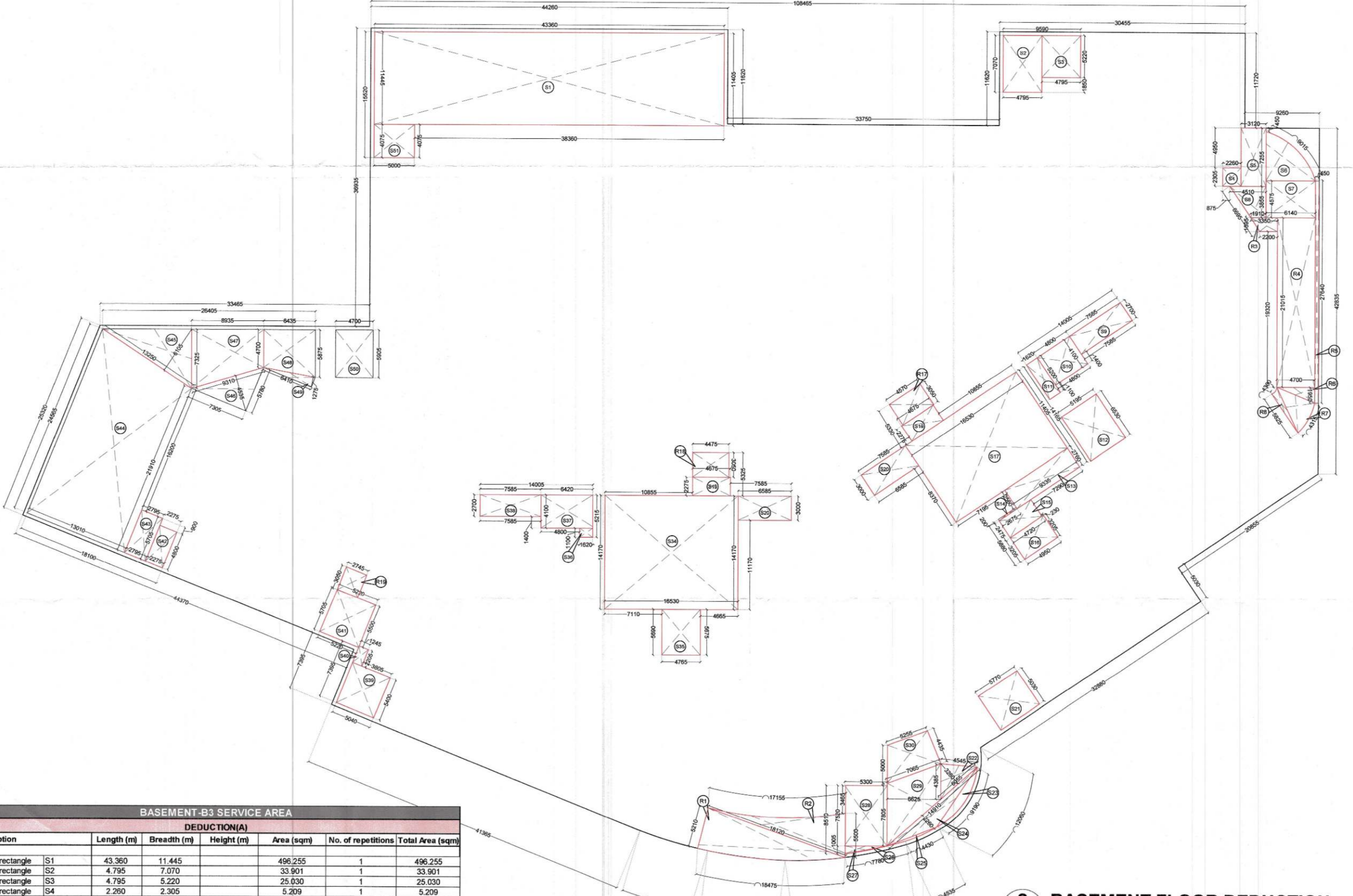

2 BASEMENT FLOOR DEDUCTION
1:250

BASEMENT-B3 SERVICE AREA						
DEDUCTIONS(A)						
Description	Length (m)	Breadth (m)	Height (m)	Area (sqm)	No. of repetitions	Total Area (sqm)
Area of rectangle S1	43.360	11.445		496.255	1	496.255
Area of rectangle S2	4.795	7.070		33.901	1	33.901
Area of rectangle S3	4.795	5.220		25.030	1	25.030
Area of rectangle S4	2.280	2.305		5.259	1	5.259
Area of rectangle S5	3.120	7.255		22.638	1	22.638
Area of polygon S6				25.093	1	25.093
Area of rectangle S7	4.575	6.140		28.091	1	28.091
Area of trapezium S8	4.510	1.910	3.855	12.375	1	12.375
Area of rectangle S9	7.585	2.700		20.480	1	20.480
Area of rectangle S10	4.800	4.100		19.680	1	19.680
Area of rectangle S11	5.200	1.620		8.424	1	8.424
Area of rectangle S12	5.195	6.530		33.923	1	33.923
Area of rectangle S13	9.335	2.760		25.765	1	25.765
Area of rectangle S14	2.675	0.200		0.535	1	0.535
Area of rectangle S15	4.720	2.475		11.682	1	11.682
Area of rectangle S16	4.950	3.205		15.865	1	15.865
Area of rectangle S17	16.530	11.405		188.525	1	188.525
Area of rectangle S18	4.675	2.275		10.636	2	21.271
Area of rectangle S19	6.585	3.000		19.755	2	39.510
Area of rectangle S20	5.770	5.030		29.023	1	29.023
Area of rectangle S21	6.055	3.280		9.930	1	9.930
Area of arc S22				6.900	1	6.900
Area of triangle S23				16.848	1	16.848
Area of arc S24	14.910	2.260		1.200	1	1.200
Area of arc S25				0.200	1	0.200
Area of arc S26				2.993	1	2.993
Area of triangle S27				39.856	1	39.856
Area of rectangle S28	5.300	7.620	1.005	39.856	1	39.856
Area of trapezium S29	7.805	4.385	6.625	40.379	1	40.379
Area of trapezium S30	7.065	5.255	4.435	27.320	1	27.320
Area of rectangle S31	16.530	14.170		234.230	1	234.230
Area of rectangle S32	4.765	5.675		27.041	1	27.041
Area of rectangle S33	1.620	1.100		1.782	1	1.782
Area of rectangle S34	6.420	4.100		26.322	1	26.322
Area of rectangle S35	7.585	2.700		20.480	1	20.480
Area of rectangle S36	5.140	5.400		27.756	1	27.756
Area of rectangle S37	1.245	2.205		2.745	1	2.745
Area of rectangle S38	5.220	5.705		29.780	1	29.780
Area of rectangle S39	2.275	4.600		10.460	1	10.460
Area of rectangle S40	2.795	5.705		15.945	1	15.945
Area of trapezium S41	21.910	24.565	13.010	302.320	1	302.320
Area of rectangle S42	13.250	6.105		80.446	1	80.446
Area of triangle S43	9.310	4.335		21.110	1	21.110
Area of trapezium S44	7.325	4.700	8.935	33.722	1	33.722
Area of trapezium S45	5.875	4.700	6.435	34.025	1	34.025
Area of triangle S46	6.410	1.275		4.086	1	4.086
Area of rectangle S47	4.700	5.905		27.754	1	27.754
Area of rectangle S48	5.000	4.075		20.375	1	20.375
Area of polygon R1				57.188	1	57.188
Area of polygon R2				36.752	1	36.752
Area of rectangle R3	3.350	2.200	1.695	4.704	1	4.704
Area of rectangle R4	4.700	21.015		98.771	1	98.771
Area of rectangle R5	0.450	27.640		12.438	1	12.438
Area of triangle R6				4.583	1	4.583
Area of polygon R7				11.640	1	11.640
Area of triangle R8				2.754	1	2.754
Total of all Deductions 'A'						2337.695

ADDITIONS(B)						
Description	Length (m)	Breadth (m)	Height (m)	Area (sqm)	No. of repetitions	Total Area (sqm)
Area of rectangle 1	30.455	36.935		1124.855	1	1124.855
Area of rectangle 2	9.265	42.835		396.866	1	396.866
Area of triangle 3				29.023	1	29.023
Area of trapezium 4	29.290	23.880	6.010	212.946	1	212.946
Area of triangle 5				5.030	1	5.030
Area of trapezium 6	19.784	6.070	20.299	262.405	1	262.405
Area of triangle 7				12.990	1	12.990
Area of triangle 8				14.840	1	14.840
Area of triangle 9				14.840	1	14.840
Area of arc 10				0.550	1	0.550
Area of trapezium 11	14.005	9.040	1.520	17.514	1	17.514
Area of arc 12				6.600	1	6.600
Area of arc 13				6.400	1	6.400
Area of triangle 14				2.190	1	2.190
Area of trapezium 15	1.025	2.190	9.715	15.617	1	15.617
Area of arc 16				1.300	1	1.300
Area of triangle 17				7.995	1	7.995
Area of arc 18				1.200	1	1.200
Area of triangle 19				5.560	1	5.560
Area of rectangle 20	28.594	14.764		422.162	1	422.162
Area of triangle 21				79.091	1	79.091
Area of rectangle 22	33.489	19.784		662.549	1	662.549
Area of rectangle 23	41.954	29.290		1228.833	1	1228.833
Area of triangle 24				11.835	1	11.835
Area of trapezium 25	50.640	67.055	40.900	2409.112	1	2409.112
Area of trapezium 26	37.855	43.245	13.345	541.140	1	541.140
Area of trapezium 27	25.320	37.855	31.025	980.002	1	980.002
Area of arc 28				0.180	1	0.180
Area of rectangle 29	44.260	36.935		1634.743	1	1634.743
Area of rectangle 30	33.750	25.315		854.381	1	854.381
Total of all Additions 'B'						11213.636

BASEMENT - PARKING SUMMARY						
NO.	BASEMENT	TOTAL BASEMENT AREA (IN SQM)	AREA FOR SERVICES (IN SQM)	AREA FOR PARKING (IN SQM)	NO. OF PARKING (AS/ECS) - PARKING AREA/32(sqm)	NO. OF PARKING BAYS
1	B1	11761	3287	8473	265	214
2	B2	11808	2988	8738	273	226
3	B3	11214	2338	8876	277	228
TOTAL		34680	8493	26087	815	668

BASEMENT - PARKING SUMMARY		
NO.	MAN PARKING	
1	B1	214
2	B2	226
3	B3	228
TOTAL	668	

NET NON-FAR SERVICES AREA 'A'	2337.695
NET PARKING AREA = (B-A)	8876.940
NET ECS	39

OWNER SIGN: _____ ARCHITECT SIGN: _____

MIS RAJESH BUILDHOME PVT. LTD. IN COLLABORATION WITH MIS ADAM M2K REALTORS LLP.

PROJECT
 PROPOSED RESIDENTIAL GROUP HOUSING COLONY OVER AN ADDITIONAL AREA MEASURING 0.03128 ACRE (LICENSE NO 131 OF 2025 DATED 29-07-2025) ADJOINING TO ALREADY LICENCED AREA MEASURING 8.13125 ACRES (AFTER MIGRATION OF 12.8822 ACRES INTO RESIDENTIAL PLOTTED COLONY UNDER GOA-1916 LICENSE NO-440F/2021 DATED 12.08.2021 OUT OF TOTAL 17.9675 ACRES UNDER LICENSE NO. 24 OF 2012) TOTAL AREA MEASURING 8.165 ACRES IN SECTOR 102 & 102-A, GURUGRAM

SCALE: 1:250 DATE: 17.11.2025
 DRAWING TITLE: BASEMENT 3 AREA DIAGRAM
 ARCHITECTS: MORPHOGENESIS, 41 INDUSTRIAL ESTATE, OKHA PHASE-III, NEW DELHI 110028, INDIA. TEL: +91 11 41828070. E-MAIL: STUDIO@MORPHOGENESIS.ORG
 DRAWING NO: S-08