

S.T.P. (HQ) Member Secretary
 S.T.P. (G) Member B.P.A.C.
 C.T.A. (Hr.) Chairman B.P.A.C.

J.D. P.A. A.T.P.

DTP(HQ)
 DDPT MEMBER BPAC
 Ram Avtar Bassi JD(HQ)

SANCTIONED
 TO BE READ WITH THIS OFFICE
 MEMO NO.:
 DATED :

- NOTES**
- Dimensions are not to be scaled.
 - All dimensions are in mm.
 - All windows and ventilators are openable.
 - Lift well are mechanically Pressurized.
 - Fire services install as per NBC.
 - 100% power backup for emergency services.

key plan

Owner's Sign&Stamp
 For ROF Infratech and Housing Pvt. Ltd.

 Authorized Signatory

Architect's Sign&Stamp
 JYOTI PRAKASH SHARMA
 CA2008/43101

Architects :

 JPS DESIGN STUDIO

Electrical, Plumbing, HVAC & Fire Fighting

 BEHERA ASSOCIATES PVT LTD
 F-623a, LADO SARAI
 BEHIND CNG FILLING STATION
 NEW DELHI - 110030
 EMAIL-behera.associates@gmail.com

Project Title :
 PROPOSED BUILDING PLAN OF AFFORDABLE GROUP
 HOUSING COLONY OVER AN AREA MEASURING
 11.1875 ACRE (LICENCE NO. 182 OF 2024 DATED
 10/12/2024 IN SECTOR 07, SOHNA, BEING DEVELOPED
 BY ROF INFRA TECH & HOUSING PVT. LTD.

Drawing Title :
 TOWER-05&06,07&08,16&17
 SECTIONS
 Scale : 1:125 Rev:
 Date : 27-12-2024 Drawing No :
 Drawn By : Piyush Sharma SD/AH/6A
 Checked By : J P SHARMA
 Sheet Size : A0 841x1189mm Drawing Status : Submission Drawing

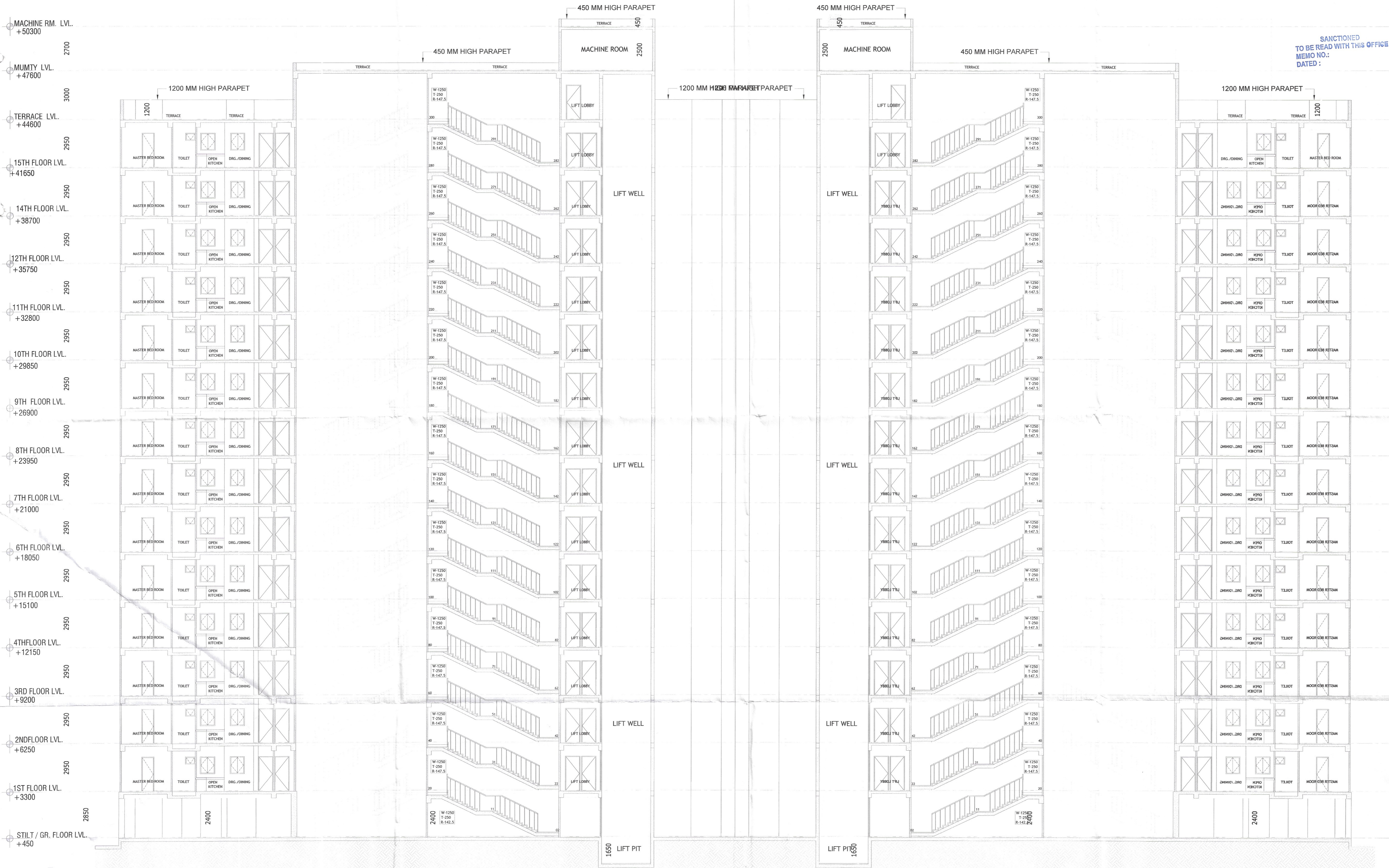

TYPICAL BUILDING SECTION - B
TOWER-05&06,07&08,16&17