

GROUP HOUSING COLONY SECTOR-102, GURUGRAM			
	ACRES		PERMISSIBLE SQM
GROUND HOUSING			
TOTAL SITE AREA	5.2902 Acres		21,408.65 SQM
GROUND COVERAGE			
PERMISSIBLE GROUND COVERAGE	35.00%		7,493.03 SQM
TOTAL PERMISSIBLE GROUND COVERAGE	26.62%		5,698.35 SQM
FAR			
RESIDENTIAL			
PERMISSIBLE FAR ON GROUP HOUSING	175.00%		37,465.13 SQM
PERMISSIBLE IGBC GOLD RATING (FAR)	12.00%		2,569.04 SQM
PERMISSIBLE TOTAL FAR	187.00%		40,034.17 SQM
COMMERCIAL PERMISSIBLE @0.5% FAR	0.50%		107.04 SQM
COMMERCIAL PROPOSED FAR			106.40 SQM
RESIDENTIAL PERMISSIBLE FAR			39,927.12 SQM
TDR CERTIFICATE REQUIRED FOR FAR	105.84%		22,658.91 SQM
TOTAL PERMISSIBLE FAR			62,693.08 SQM
TOTAL PROPOSED FAR	292.838%		62,692.57 SQM
GREEN			
REQUIRED GREEN	15.00%		3211.297
PROPOSED GREEN	28.885%		6183.902
DENSITY			
PERMISSIBLE DENSITY @ 100 - 300 PPA	100.00 PPA	300.00 PPA	
FOR FAR AREA 5.2902 Acres	530.00 Nos	1,587.00 Nos	
GROUP HOUSING			
PERMISSIBLE DENSITY	Min. 529 Nos	Max. 1,587 Nos	Proposed
MAIN UNITS	5 Person / Un	268	1,340 Nos
EWS 15% of Main Units	2 Person / Un	48	96 Nos
SERVICE PERSON UNIT 10% of Main Units	2 Person / Un	28	56 Nos
TOTAL PROPOSED DENSITY		282.03	1,492 Nos
PARKING			
REQUIRED ECS @1.5 ECS/ DU		402 ECS	
PROPOSED ECS		830 ECS	629 Nos

SITE FAR AREA CHART								
5	1	X	3.985	X	10.980	=	43.76	
6	1	X	3.500	X	8.500	=	29.75	
SITE FAR AREA								
1	1	X	2.560	X	6.765	=	17.32	
2	1	X	6.765	X	2.440	=	8.25	
3	1	X	10.450	X	1.650	=	17.24	
4	1	X	2.100	X	8.125	=	17.06	
SITE NON FAR AREA								
							59.88	
TOTAL	73.51 + 59.88 =							133.38

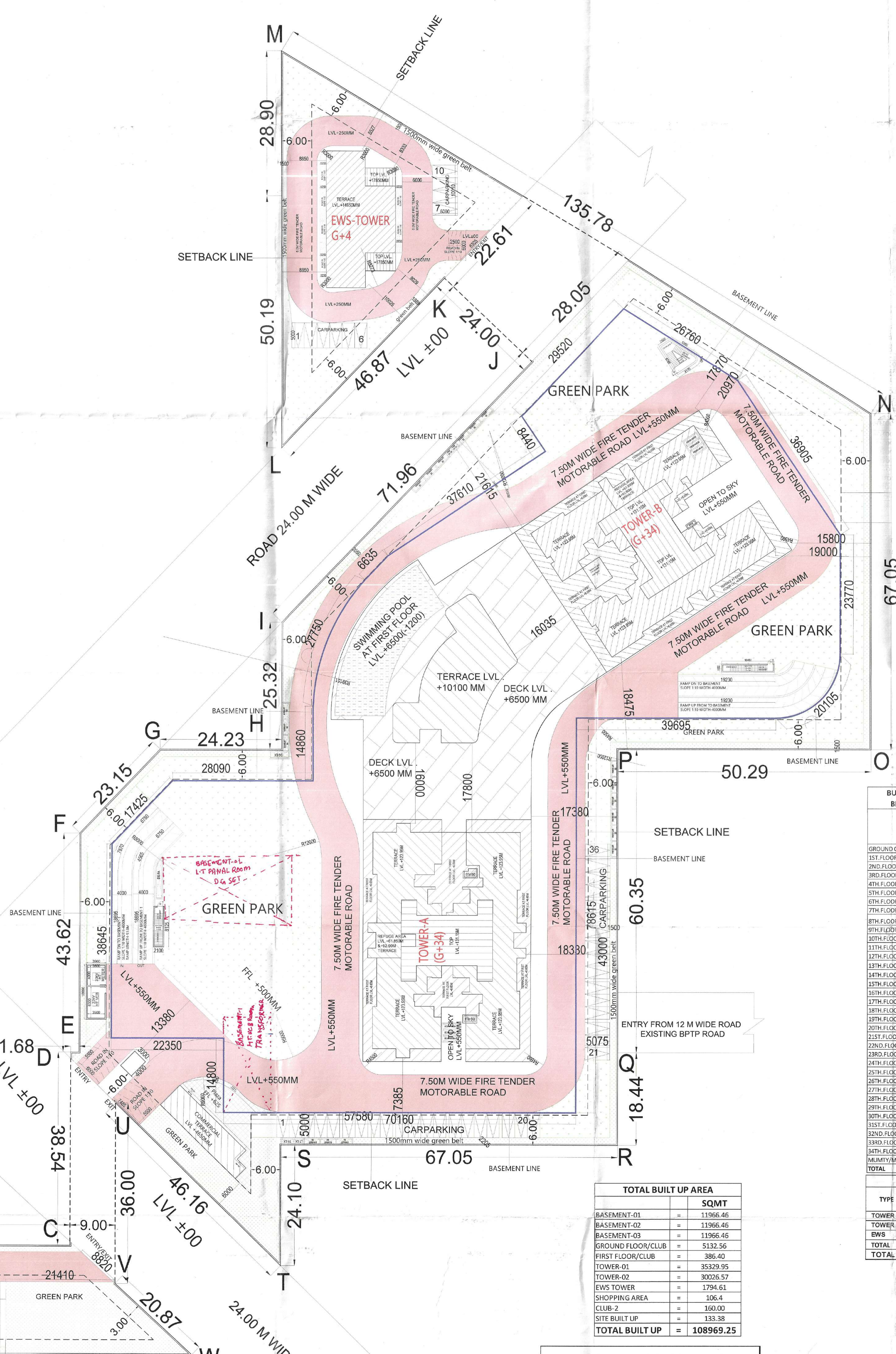
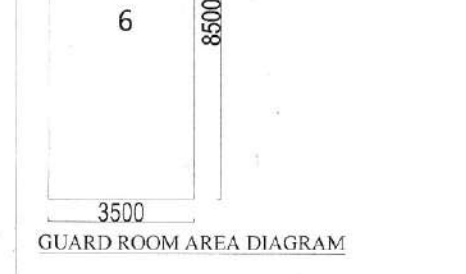
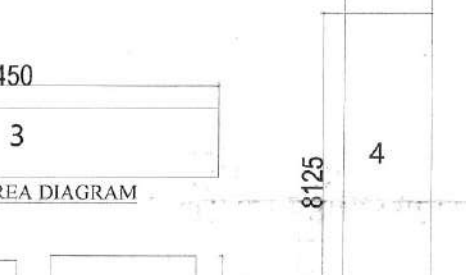
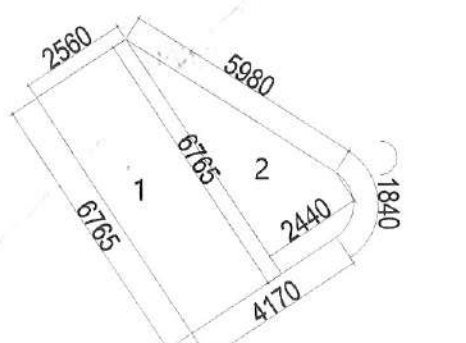

UNIT SUMMARY						
S.NO	TOWER NO.	UNIT TYPE	NO OF UNITS	CARPET AREA	BALCONY TERRACE AREA	TOTAL CARPET AREA
TOWER-1						
2BHK+UTILITY TYPE-01						
2BHK+UTILITY TYPE-02						
2BHK+UTILITY TYPE-03						
2BHK+UTILITY TYPE-04						
2BHK+UTILITY TYPE-05						
2BHK+UTILITY TYPE-06						
2BHK+UTILITY TYPE-07						
2BHK+UTILITY TYPE-08						
2BHK+UTILITY TYPE-09						
2BHK+UTILITY TYPE-10						
2BHK+UTILITY TYPE-11						
2BHK+UTILITY TYPE-12						
2BHK+UTILITY TYPE-13						
2BHK+UTILITY TYPE-14						
2BHK+UTILITY TYPE-15						
2BHK+UTILITY TYPE-16						
2BHK+UTILITY TYPE-17						
2BHK+UTILITY TYPE-18						
2BHK+UTILITY TYPE-19						
2BHK+UTILITY TYPE-20						
2BHK+UTILITY TYPE-21						
2BHK+UTILITY TYPE-22						
2BHK+UTILITY TYPE-23						
2BHK+UTILITY TYPE-24						
2BHK+UTILITY TYPE-25						
2BHK+UTILITY TYPE-26						
2BHK+UTILITY TYPE-27						
2BHK+UTILITY TYPE-28						
2BHK+UTILITY TYPE-29						
2BHK+UTILITY TYPE-30						
2BHK+UTILITY TYPE-31						
2BHK+UTILITY TYPE-32						
2BHK+UTILITY TYPE-33						
2BHK+UTILITY TYPE-34						
2BHK+UTILITY TYPE-35						
2BHK+UTILITY TYPE-36						
2BHK+UTILITY TYPE-37						
2BHK+UTILITY TYPE-38						
2BHK+UTILITY TYPE-39						
2BHK+UTILITY TYPE-40						
2BHK+UTILITY TYPE-41						
2BHK+UTILITY TYPE-42						
2BHK+UTILITY TYPE-43						
2BHK+UTILITY TYPE-44						
2BHK+UTILITY TYPE-45						
2BHK+UTILITY TYPE-46						
2BHK+UTILITY TYPE-47						
2BHK+UTILITY TYPE-48						
2BHK+UTILITY TYPE-49						
2BHK+UTILITY TYPE-50						
2BHK+UTILITY TYPE-51						
2BHK+UTILITY TYPE-52						
2BHK+UTILITY TYPE-53						
2BHK+UTILITY TYPE-54						
2BHK+UTILITY TYPE-55						
2BHK+UTILITY TYPE-56						
2BHK+UTILITY TYPE-57						
2BHK+UTILITY TYPE-58						
2BHK+UTILITY TYPE-59						
2BHK+UTILITY TYPE-60						
2BHK+UTILITY TYPE-61						
2BHK+UTILITY TYPE-62						
2BHK+UTILITY TYPE-63						
2BHK+UTILITY TYPE-64						
2BHK+UTILITY TYPE-65						
2BHK+UTILITY TYPE-66						
2BHK+UTILITY TYPE-67						
2BHK+UTILITY TYPE-68						
2BHK+UTILITY TYPE-69						
2BHK+UTILITY TYPE-70						
2BHK+UTILITY TYPE-71						
2BHK+UTILITY TYPE-72						
2BHK+UTILITY TYPE-73						
2BHK+UTILITY TYPE-74						
2BHK+UTILITY TYPE-75						
2BHK+UTILITY TYPE-76						
2BHK+UTILITY TYPE-77						
2BHK+UTILITY TYPE-78						
2BHK+UTILITY TYPE-79						
2BHK+UTILITY TYPE-80						
2BHK+UTILITY TYPE-81						
2BHK+UTILITY TYPE-82						
2BHK+UTILITY TYPE-83						
2BHK+UTILITY TYPE-84						
2BHK+UTILITY TYPE-85						
2BHK+UTILITY TYPE-86						
2BHK+UTILITY TYPE-87						
2BHK+UTILITY TYPE-88						
2BHK+UTILITY TYPE-89						
2BHK+UTILITY TYPE-90						
2BHK+UTILITY TYPE-91						
2BHK+UTILITY TYPE-92						
2BHK+UTILITY TYPE-93						
2BHK+UTILITY TYPE-94						
2BHK+UTILITY TYPE-95						
2BHK+UTILITY TYPE-96						
2BHK+UTILITY TYPE-97						
2BHK+UTILITY TYPE-98						
2BHK+UTILITY TYPE-99						
2BHK+UTILITY TYPE-100						
2BHK+UTILITY TYPE-101						
2BHK+UTILITY TYPE-102						
2BHK+UTILITY TYPE-103						
2BHK+UTILITY TYPE-104						
2BHK+UTILITY TYPE-105						
2BHK+UTILITY TYPE-106						
2BHK+UTILITY TYPE-107						
2BHK+UTILITY TYPE-108						
2BHK+UTILITY TYPE-109						
2BHK+UTILITY TYPE-110						
2BHK+UTILITY TYPE-111						
2BHK+UTILITY TYPE-112						
2BHK+UTILITY TYPE-113						
2BHK+UTILITY TYPE-114						
2BHK+UTILITY TYPE-115						
2BHK+UTILITY TYPE-116						
2BHK+UTILITY TYPE-117						
2BHK+UTILITY TYPE-118						
2BHK+UTILITY TYPE-119						
2BHK+UTILITY TYPE-120						
2BHK+UTILITY TYPE-121						
2BHK+UTILITY TYPE-122						
2BHK+UTILITY TYPE-123						
2BHK+UTILITY TYPE-124						
2BHK+UTILITY TYPE-125						
2BHK+UTILITY TYPE-126						
2BHK+UTILITY TYPE-127						
2BHK+UTILITY TYPE-128						
2BHK+UTILITY TYPE-129						
2BHK+UTILITY TYPE-130						
2BHK+UTILITY TYPE-131						
2BHK+UTILITY TYPE-132						
2BHK+UTILITY TYPE-133						
2BHK+UTILITY TYPE-134						
2BHK+UTILITY TYPE-135						
2BHK+UTILITY TYPE-136						
2BHK+UTILITY TYPE-137						
2BHK+UTILITY TYPE-138						
2BHK+UTILITY TYPE-139						
2BHK+UTILITY TYPE-140						
2BHK+UTILITY TYPE-141						
2BHK+UTILITY TYPE-142						
2BHK+UTILITY TYPE-143						
2BHK+UTILITY TYPE-144						
2BHK+UTILITY TYPE-145						
2BHK+UTILITY TYPE-146						
2BHK+UTILITY TYPE-147						
2BHK+UTILITY TYPE-148						
2BHK+UTILITY TYPE-149						
2BHK+UTILITY TYPE-150						

UNIT CALCULATIONS			
TOWER	FLOOR	NO. OF FLOOR	TOTAL NO. OF UNITS
TOWER-1			
GROUND FLOOR	0	4	134
FIRST FLOOR	4	4	134
TYPICAL FLOOR	4	124	134
REFUGE FLOOR	4	4	134
PANTHOUSE	2	2	134
TOTAL NO. OF UNITS			268
TOWER-2			
GROUND FLOOR	0	4	134
FIRST FLOOR	4	4	134
TYPICAL FLOOR	4	124	134
REFUGE FLOOR	4	4	134
PANTHOUSE	2	2	134
TOTAL NO. OF UNITS			268
EWS			
GROUND FLOOR	0	12	48
TYPICAL FLOOR	12	48	48
TOTAL NO. OF UNITS			48

SL. NO.	BLOCK/TOWER	GROUND COVERAGE	NO. OF FLOORS	TERRACE HEIGHT OF BUILDING	REFUGE	DESCRIPTION	TOTAL DUS	ECS / DUS	REQUIRED ECS
PARKING CALCULATION									
Total Main Dwelling Units							270	1.5	405
Provided Car Parking Bays							535		265
ECS @ 3.5 SQM							1925		1925
PROVIDED CAR PARKING BAYS							1925		1925
TOTAL CAR PARKING BAYS PROVIDED							2460		2460
EWS CAR PARKING BAYS PROVIDED							326/82/28		12/12/12
TOTAL CAR PARKING BAYS PROVIDED							830		629
REQUIRED PARKING BAYS FOR EWS @ 8% REQUIRED ECS							20.25		22
PROVIDED PARKING BAYS FOR EWS IN EWS STILL AND OPEN SITE (10+12)							22		22
SL. NO.	BLOCK/TOWER	GROUND COVERAGE	NO. OF FLOORS	TERRACE HEIGHT	REFUGE	DESCRIPTION	TOTAL DUS	ECS / DUS	REQUIRED ECS
1	TOWER-1	5016.12	G+34	123.95M	2 NOS.	BASEMENT-1	8011.24	250	173
2	TOWER-2	369.85	G+34	123.95M	2 NOS.	BASEMENT-2	1198.07	256	176
3	EWS	106.04	G	14.95M	NIL	BASEMENT-3	6546.540	268	223
10	SHOPPING	106.04	G	4.650 M.	NIL	OPEN SITE CAR PARKING BAYS PROVIDED	611/312/25	25	46
13	GUARD ROOM	24.00	G	3.00 M.	NIL	EWS CAR PARKING BAYS PROVIDED	326/82/28	12	12
TOTAL						TOTAL CAR PARKING BAYS PROVIDED	830		629
						REQUIRED PARKING BAYS FOR EWS @ 8% REQUIRED ECS	20.25		22
						PROVIDED PARKING BAYS FOR EWS IN EWS STILL AND OPEN SITE (10+12)	22		22

BUILDING BLOCKS	TOWER - 1				TOWER - 2				EWS TOWER							
	UNIT PER FLOOR	FAR AREA IN SQM	NON-FAR AREA IN SQM	BALCONY AREA IN SQM	BUILT UP AREA IN SQM	UNIT PER FLOOR	FAR AREA IN SQM	NON-FAR AREA IN SQM	BALCONY AREA IN SQM	BUILT UP AREA IN SQM	UNIT PER FLOOR	FAR AREA IN SQM	NON-FAR AREA IN SQM	BALCONY AREA IN SQM	BUILT UP AREA IN SQM	
GROUND CLUB	4	913.98	134.72		1038.70	GROUND CLUB	4	750.01	117.29	867.30	STREET PARKING	0	43.03	506.82	11.34	369.85
1ST FLOOR LVL	4	928.67	134.72	206.86	1033.39	1ST FLOOR LVL	4	764.02	117.29	881.31	1ST FLOOR LVL	12	361.78	35.40	34.00	337.18
2ND FLOOR LVL	4	928.67	134.72	206.86	1033.39	2ND FLOOR LVL	4	764.02	117.29	881.31	2ND FLOOR LVL	12	361.78	35.40	34.00	337.18
3RD FLOOR LVL	4	928.67	134.72	206.86	1033.39	3RD FLOOR LVL	4	764.02	117.29	881.31	3RD FLOOR LVL	12	361.78	35.40	34.00	337.18
4TH FLOOR LVL	4	928.67	134.72	206.86	1033.39	4TH FLOOR LVL	4	764.02	117.29	881.31	4TH FLOOR LVL	12	361.78	35.40	34.00	337.18
5TH FLOOR LVL	4	928.67	134.72	206.86	1033.39	5TH FLOOR LVL	4	764.02	117.29	881.31	5TH FLOOR LVL	12	361.78	35.40	34.00	337.18
6TH FLOOR LVL	4	928.67	134.72	206.86	1033.39	6TH FLOOR LVL	4	764.02	117.29	881.31	MULTI/MACHINE ROOM	7	76.04			76.04
7TH FLOOR LVL	4	928.67	134.72	206.86	1033.39	7TH FLOOR LVL	4	764.02	117.29	881.31	TOTAL	48	1250.15			1794.61
8TH FLOOR LVL	4	928.67	134.72	206.86	1033.39	8TH FLOOR LVL	4	764.02	117.29	881.31	SHOPPING AREA					
9TH FLOOR LVL	4	928.67	134.72	206.86	1033.39	9TH FLOOR LVL	4	764.02	117.29	881.31	GROUND FLOOR	7	106.40			106.40
10TH FLOOR LVL	4	928.67	134.72	206.86	1033.39	10TH FLOOR LVL	4	764.02	117.29	881.31	CLUB FIRST FLOOR		386.40			386.40
11TH FLOOR LVL	4	928.67	134.72	206.86	1033.39	11TH FLOOR LVL	4	764.02	117.29	881.31	TOWER-1		3146.51			3146.51
12TH FLOOR LVL	4	928.67	134.72	206.86	1033.39	12TH FLOOR LVL	4	764.02	117.29	881.31	TOWER-2		2085.80			2085.80
13TH FLOOR LVL	4	928.67	134.72	206.86	1033.39	13TH FLOOR LVL	4	764.02	117.29	881.31	EWS TOWER		1250.15			1250.15
14TH FLOOR LVL	4	928.67	134.72	206.86	1033.39	14TH FLOOR LVL	4	764.02	117.29	881.31	SHOPPING AREA		106.40			106.40
15TH FLOOR LVL	4	928.67	134.72	206.86	1033.39	15TH FLOOR LVL	4	764.02	117.29	881.31	CLUB-2 AREA		160.00			160.00
16TH FLOOR LVL	4	928.67	134.72	206.86	1033.39	16TH FLOOR LVL	4	764.02	117.29	881.31	TOTAL FAR AREA CHART		6269.92			6269.92
17TH FLOOR LVL (REFUGE)	4	883.08	151.31	206.86	1033.39	17TH FLOOR LVL (REFUGE)</										