

2 BHK+ SERVICE PERSON UNIT CARPET AREA (TYPE-1)

1	1	2.100	X	4.515	=	9.48
2	1	8.215	X	4.735	=	38.82
3	1	7.395	X	5.400	=	39.93
4	1	2.920	X	4.050	=	11.83
TOTAL CARPET AREA						= 100.06

BALCONY AREA CHART

A	1	1.800	X	8.365	=	15.06
B	2	1.200	X	2.210	=	5.30
C	1	1.200	X	2.952	=	3.54
D	1	3.020	X	1.800	=	5.44
E	1	2.570	X	1.800	=	4.63
BALCONY AREA						= 33.97

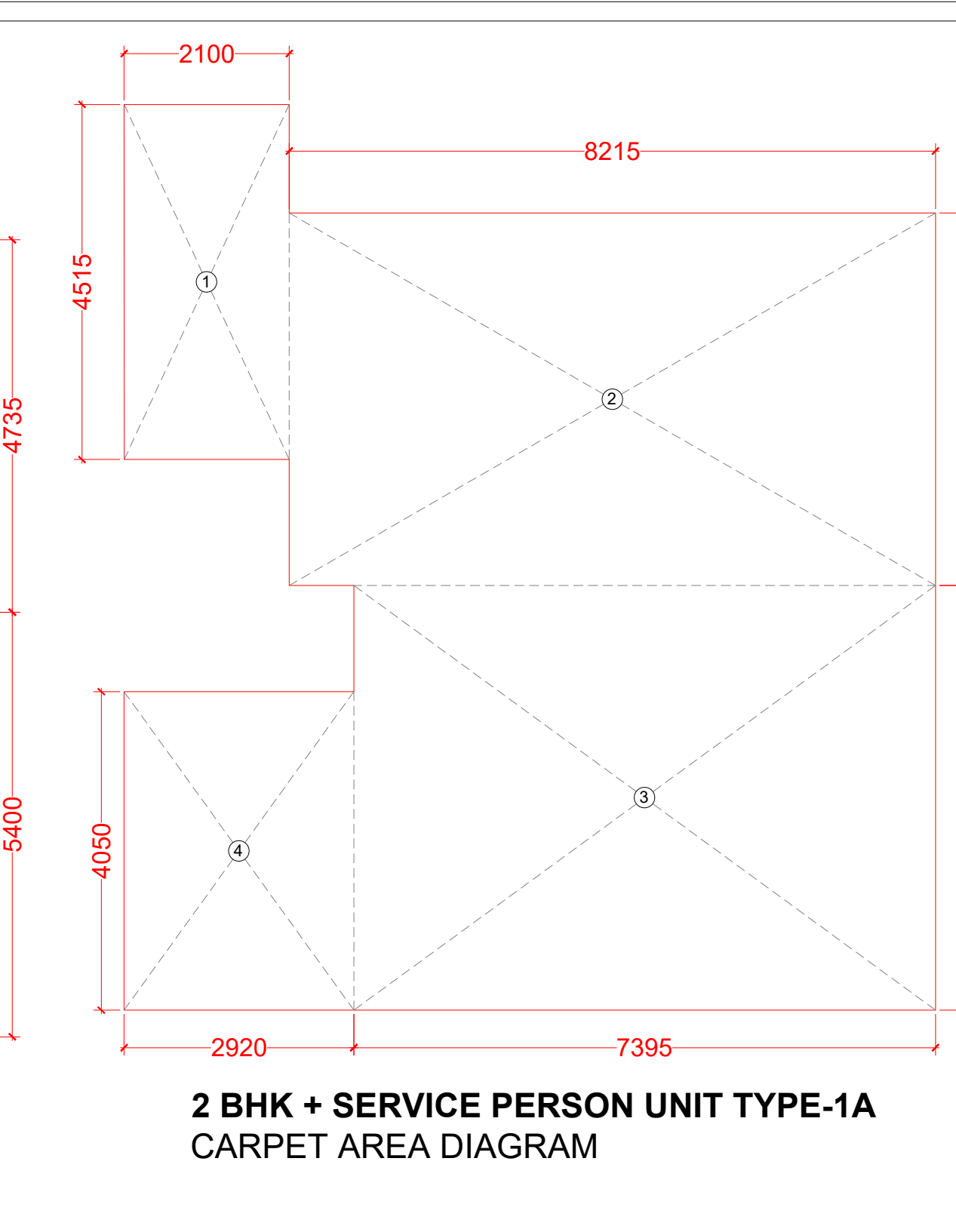
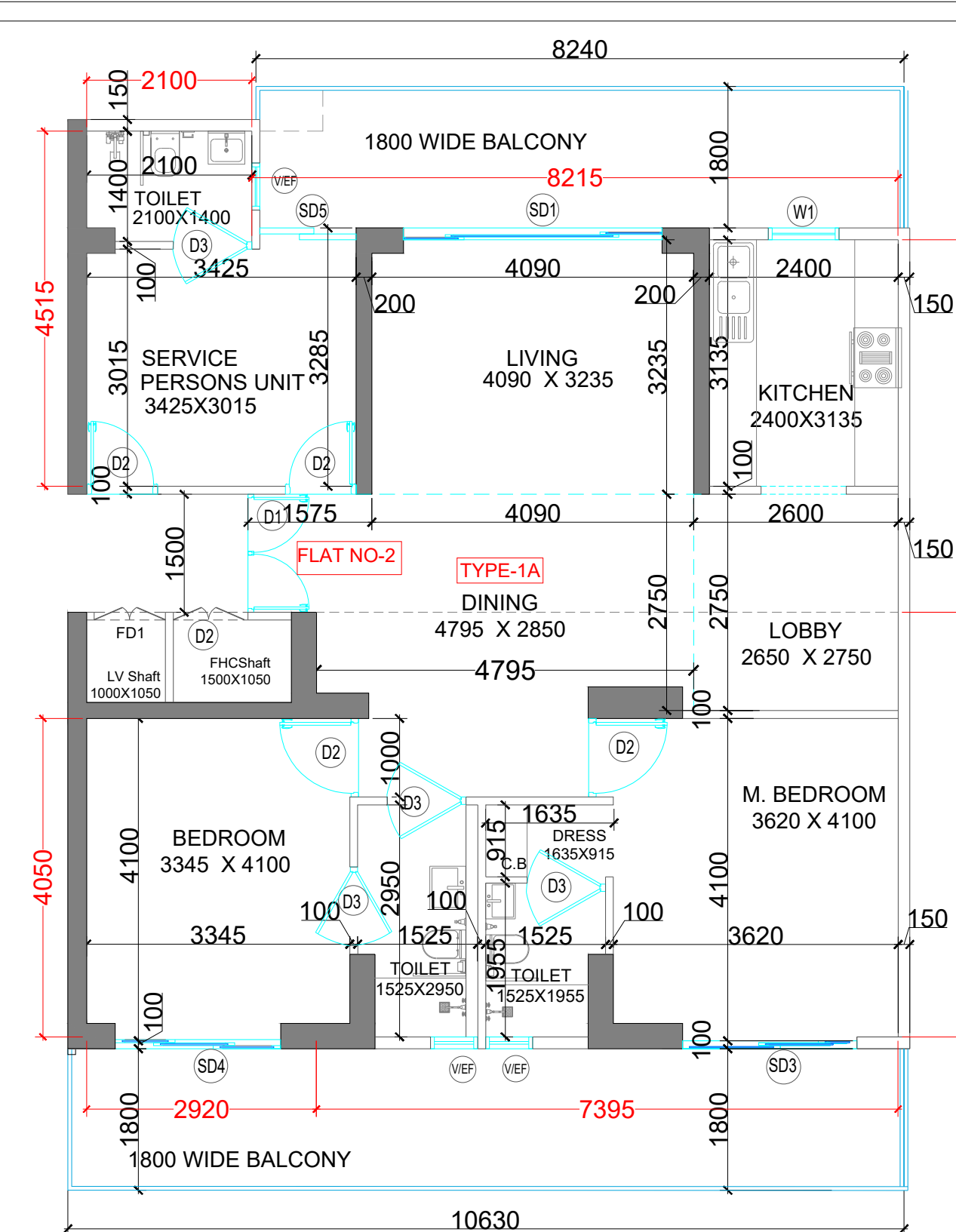

2 BHK+ SERVICE PERSON UNIT CARPET AREA (TYPE-1 A)

1	1	2.100	X	4.515	=	9.48
2	1	8.215	X	4.735	=	38.90
3	1	7.395	X	5.400	=	39.93
4	1	2.920	X	4.050	=	11.83
TOTAL CARPET AREA						= 100.14

BALCONY AREA CHART TYPE-1A

A	1	1.800	X	10.630	=	19.13
B	1	1.800	X	8.240	=	14.83
BALCONY AREA						= 33.97

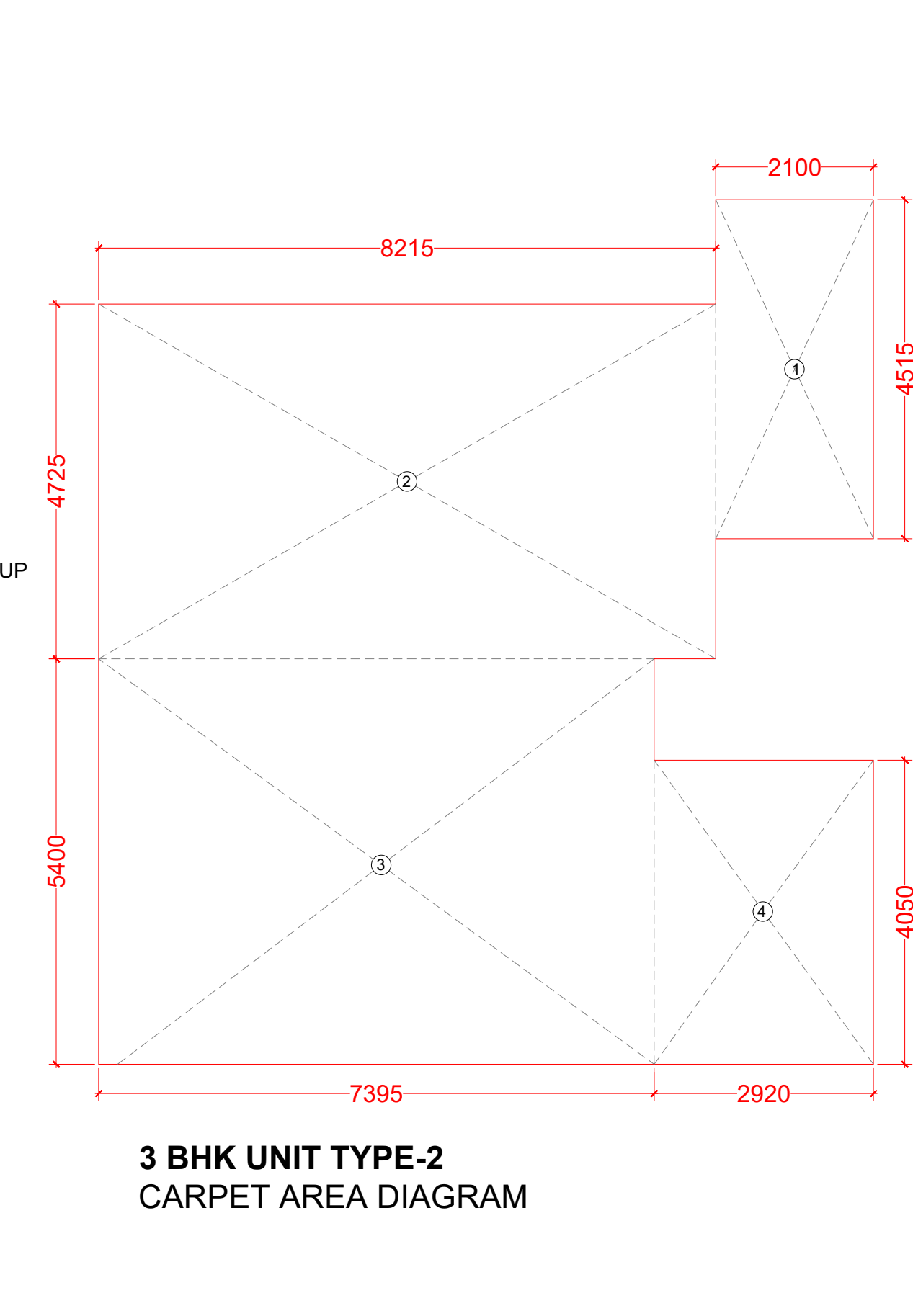
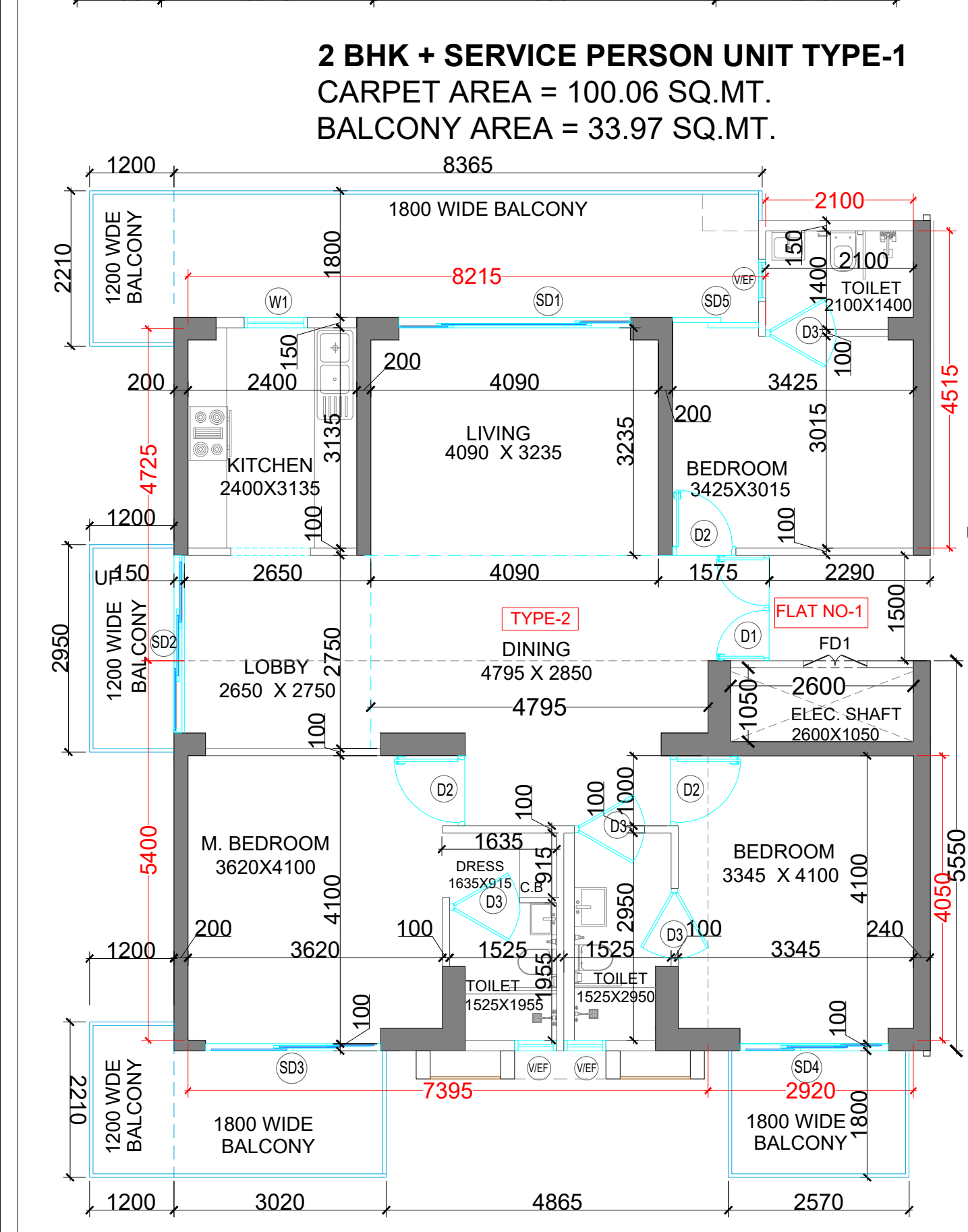

3 BHK UNIT CARPET AREA (TYPE-2)

1	1	2.100	X	4.515	=	9.48
2	1	8.215	X	4.735	=	38.82
3	1	7.395	X	5.400	=	39.93
4	1	2.920	X	4.050	=	11.83
TOTAL CARPET AREA						= 100.06

BALCONY AREA CHART

A	1	1.800	X	8.365	=	15.06
B	2	1.200	X	2.210	=	5.30
C	1	1.200	X	2.952	=	3.54
D	1	3.020	X	1.800	=	5.44
E	1	2.570	X	1.800	=	4.63
BALCONY AREA						= 33.97

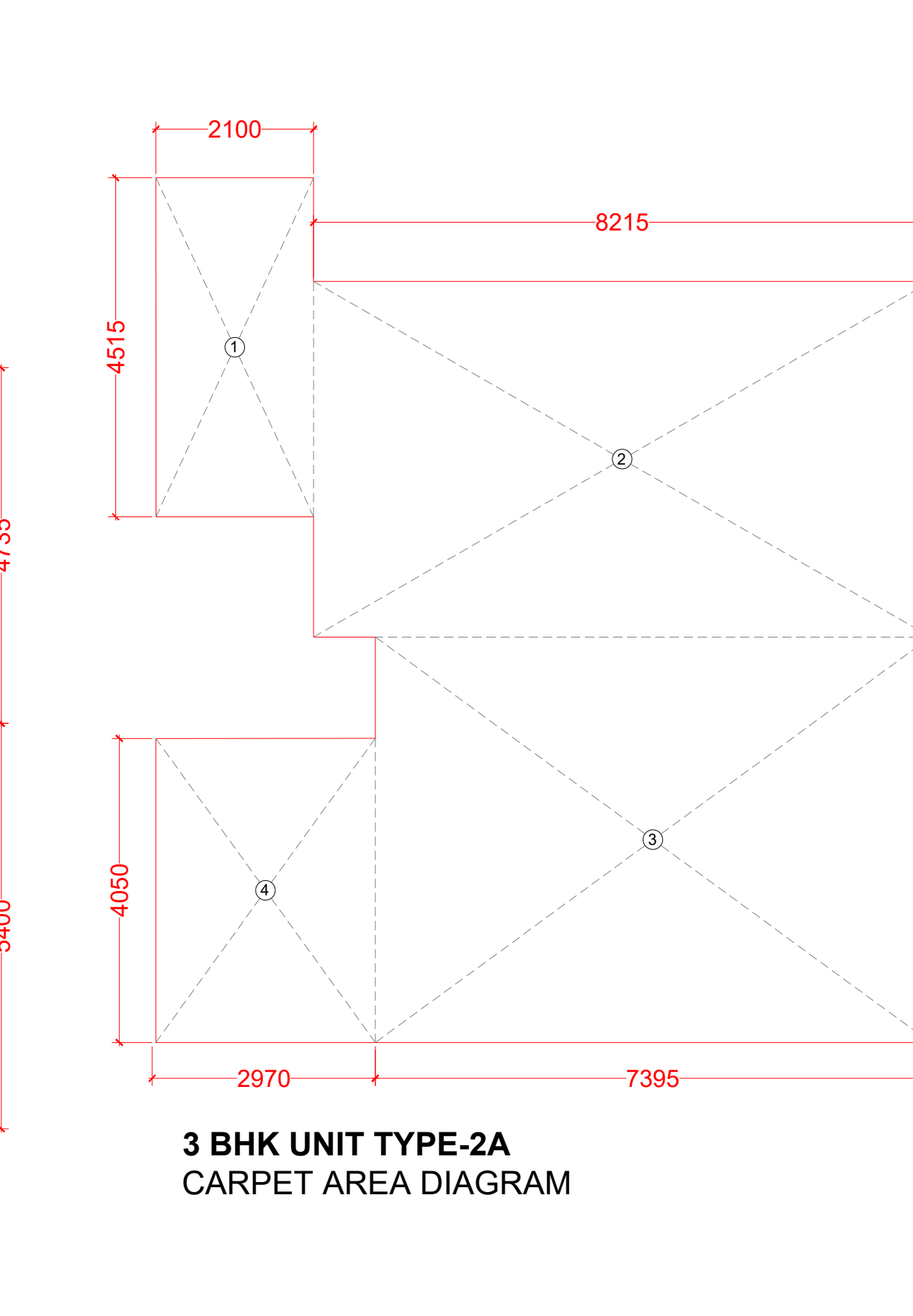
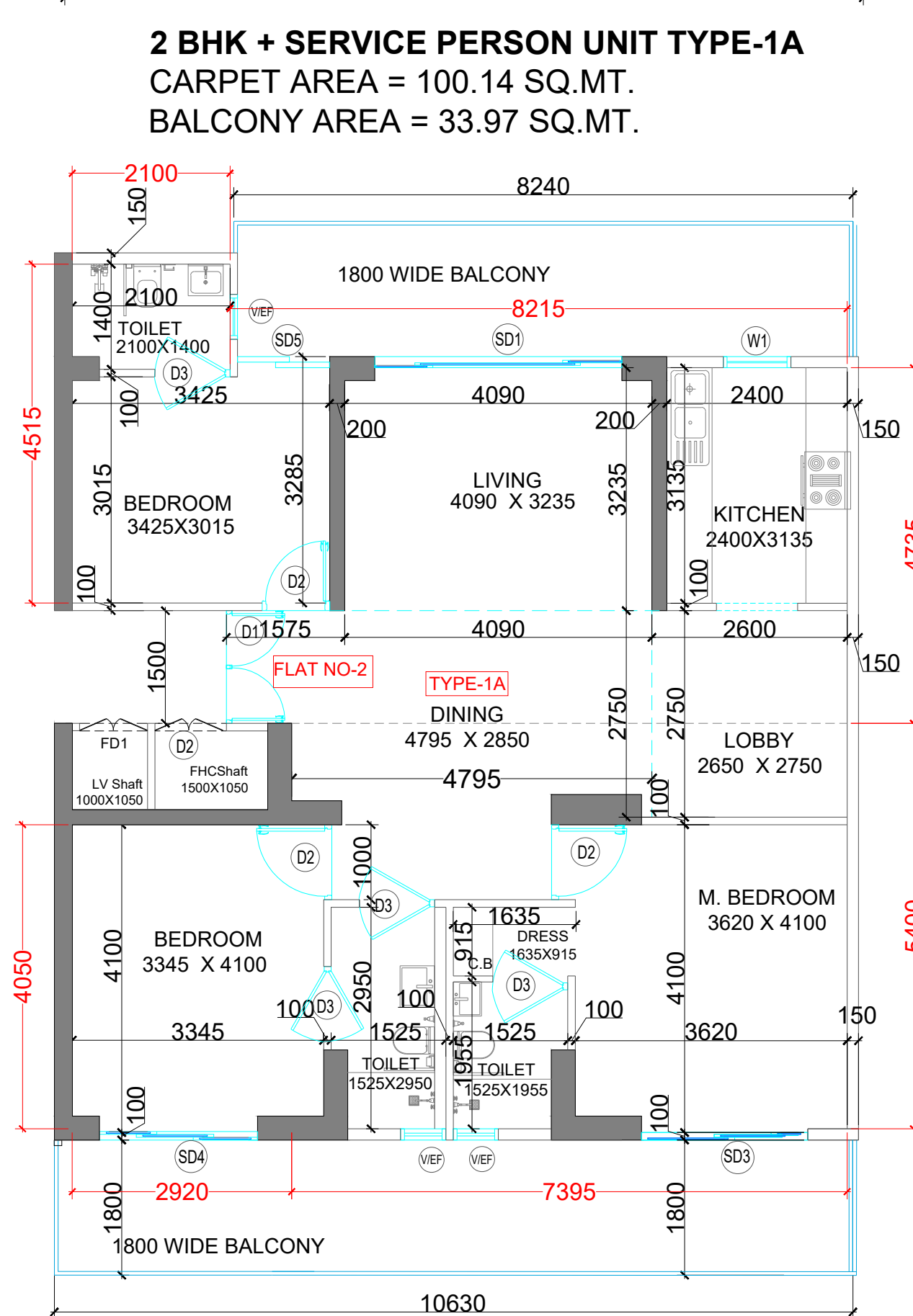

3 BHK UNIT CARPET AREA (TYPE-2 A)

1	1	2.100	X	4.515	=	9.48
2	1	8.215	X	4.735	=	38.90
3	1	7.395	X	5.400	=	39.93
4	1	2.920	X	4.050	=	11.83
TOTAL CARPET AREA						= 100.14

BALCONY AREA CHART TYPE-2A

A	1	1.800	X	10.630	=	19.13
B	1	1.800	X	8.240	=	14.83
BALCONY AREA						= 33.97

UNIT SUMMARY

S.NO	TOWER NO.	UNIT TYPE	NO OF UNITS	CARPET AREA	BALCONY/TERRACE AREA	TOTAL CARPET AREA	TOTAL BALCONY/TERRACE AREA
1	Tower-182	2nd. TO 10th.FLOOR TYPE-1 (2BHK + SERVICE PERSON UNIT)	9X2	18	100.06	33.97	1801.08
2		2nd. TO 10th.FLOOR TYPE-1A (2BHK + SERVICE PERSON UNIT)	9X2	18	100.14	33.97	1802.52
3		11TH. TO 17th.FLOOR TYPE-2 (3BHK UNIT)	7X2	14	100.06	33.97	1400.84
4		11TH. TO 17th.FLOOR TYPE-2A (3BHK UNIT)	7X2	14	100.14	33.97	1401.96
5		18th. FLOOR TYPE-2 (3BHK)	2	2	100.06	33.97	200.12
6		18th. FLOOR TYPE-3 (2BHK) (Refuge Area)	2	2	85.54	33.97	171.08
7		19TH.FLOOR TYPE-4 (3BHK WITH DECK)	2	2	100.14	59.44	200.28
8		19TH.FLOOR TYPE-2A (3BHK)	2	2	100.14	33.97	200.28
9		20TH.FLOOR TYPE-2 (3BHK)	2	2	100.06	33.97	200.12
10							
11							
				74		7378.28	2377.90

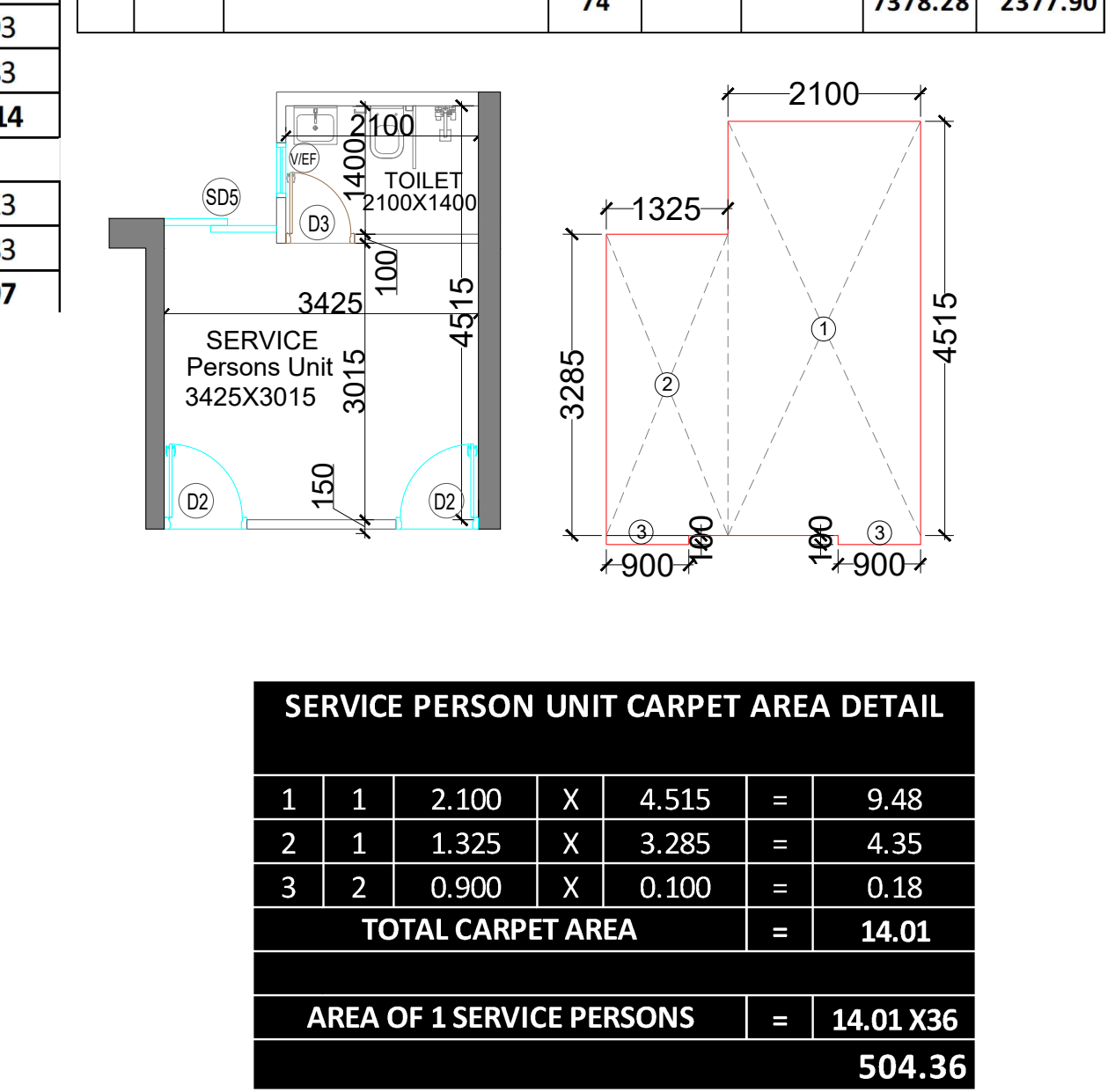

SERVICE PERSON UNIT CARPET AREA DETAIL

1	1	2.100	X	4.515	=	9.48
2	1	1.325	X	3.285	=	4.35
3	2	0.900	X	0.100	=	0.18
TOTAL CARPET AREA						= 14.01

AREA OF 1 SERVICE PERSONS = 14.01 X36 = 504.36

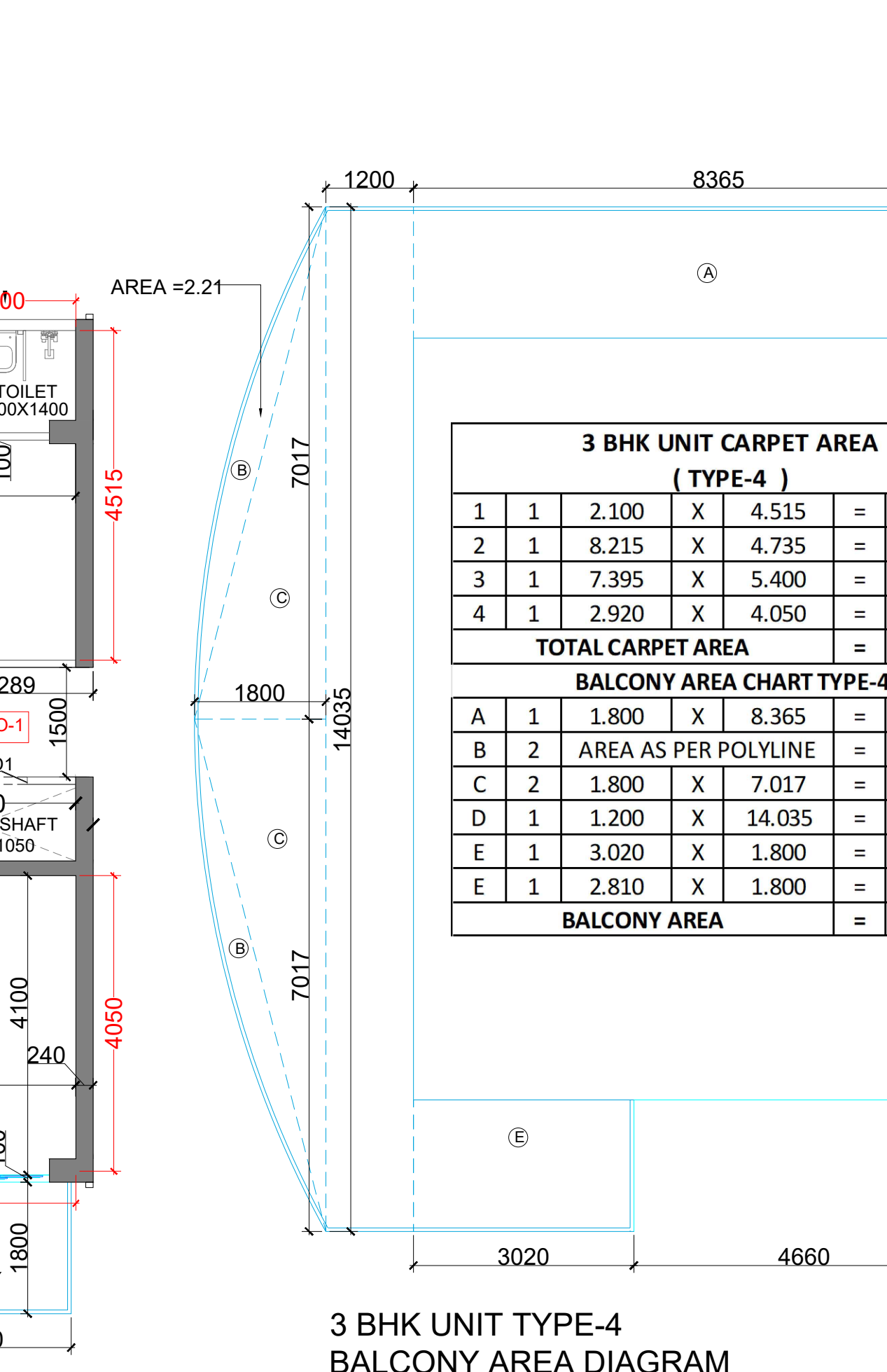
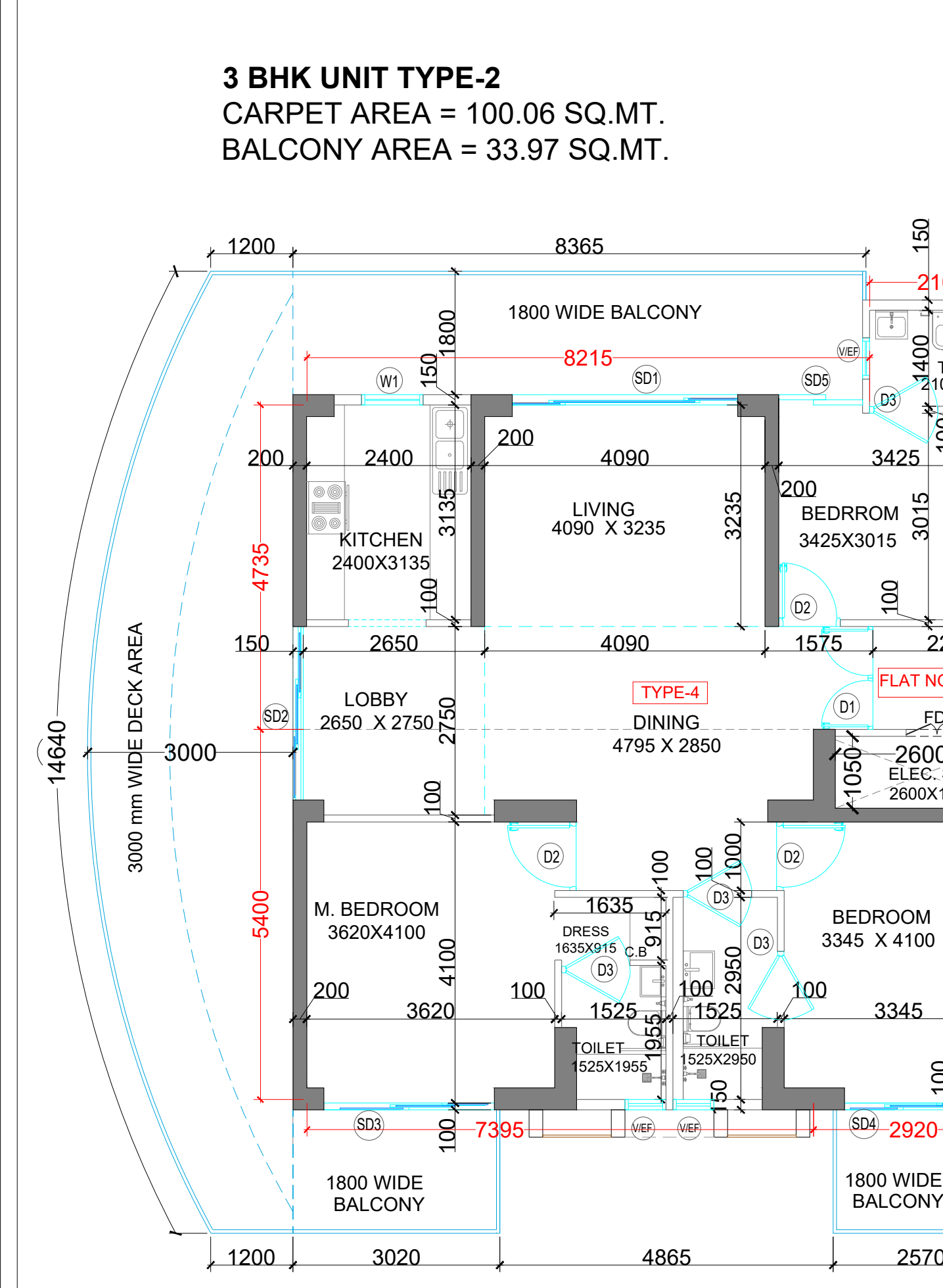

3 BHK UNIT CARPET AREA (TYPE-4)

1	1	2.100	X	4.515	=	9.48
2	1	8.215	X	4.735	=	38.90
3	1	7.395	X	5.400	=	39.93
4	1	2.920	X	4.050	=	11.83
TOTAL CARPET AREA						= 100.14

BALCONY AREA CHART TYPE-4

A	1	1.800	X	8.365	=	15.06
B	2	AREA AS PER POLYLINE			=	4.420
C	2	1.800	X	7.017	=	12.63
D	1	1.200	X	14.035	=	16.84
E	1	3.020	X	1.800	=	5.44
F	1	2.810	X	1.800	=	5.06
BALCONY AREA						= 59.44

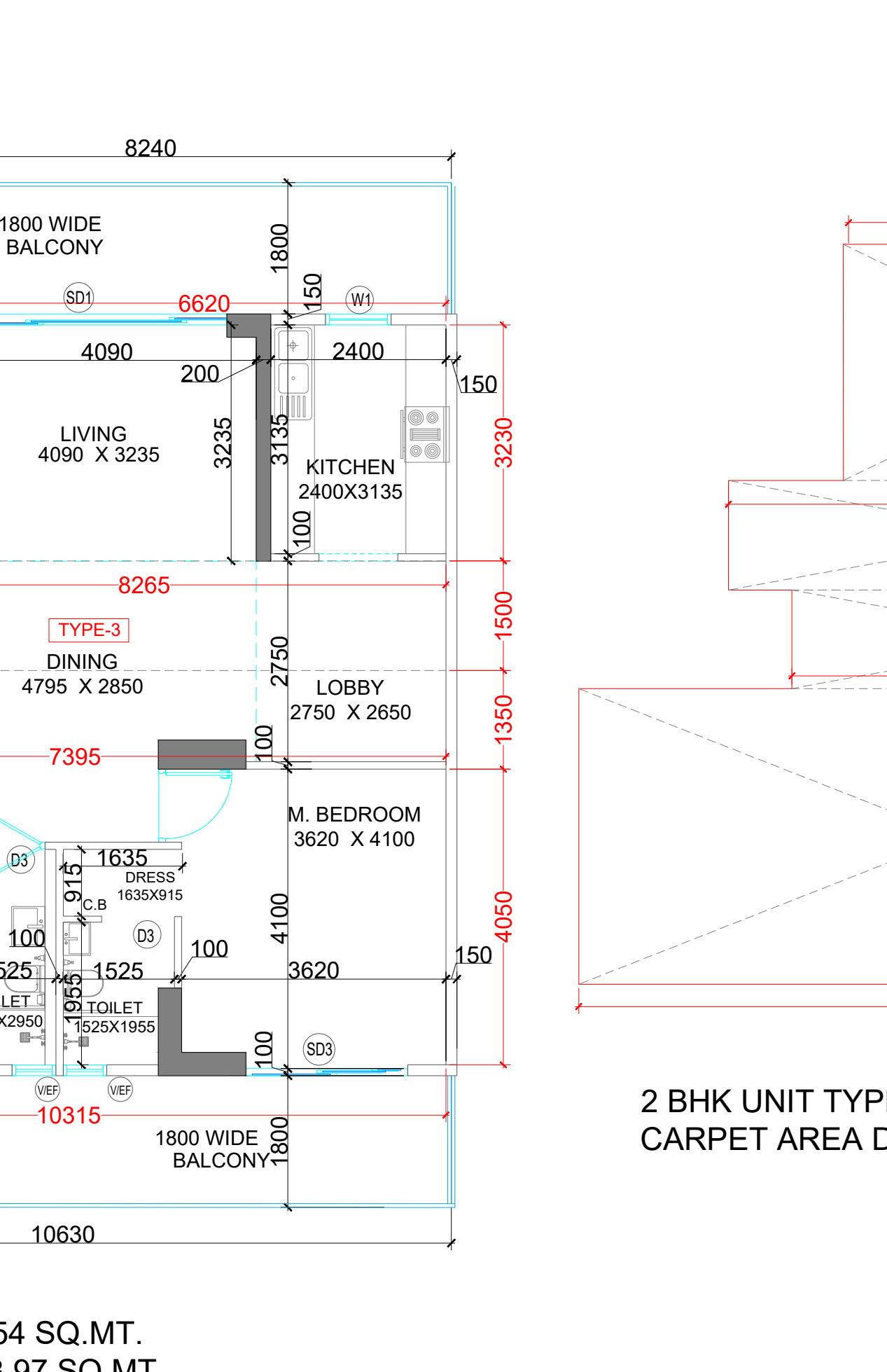
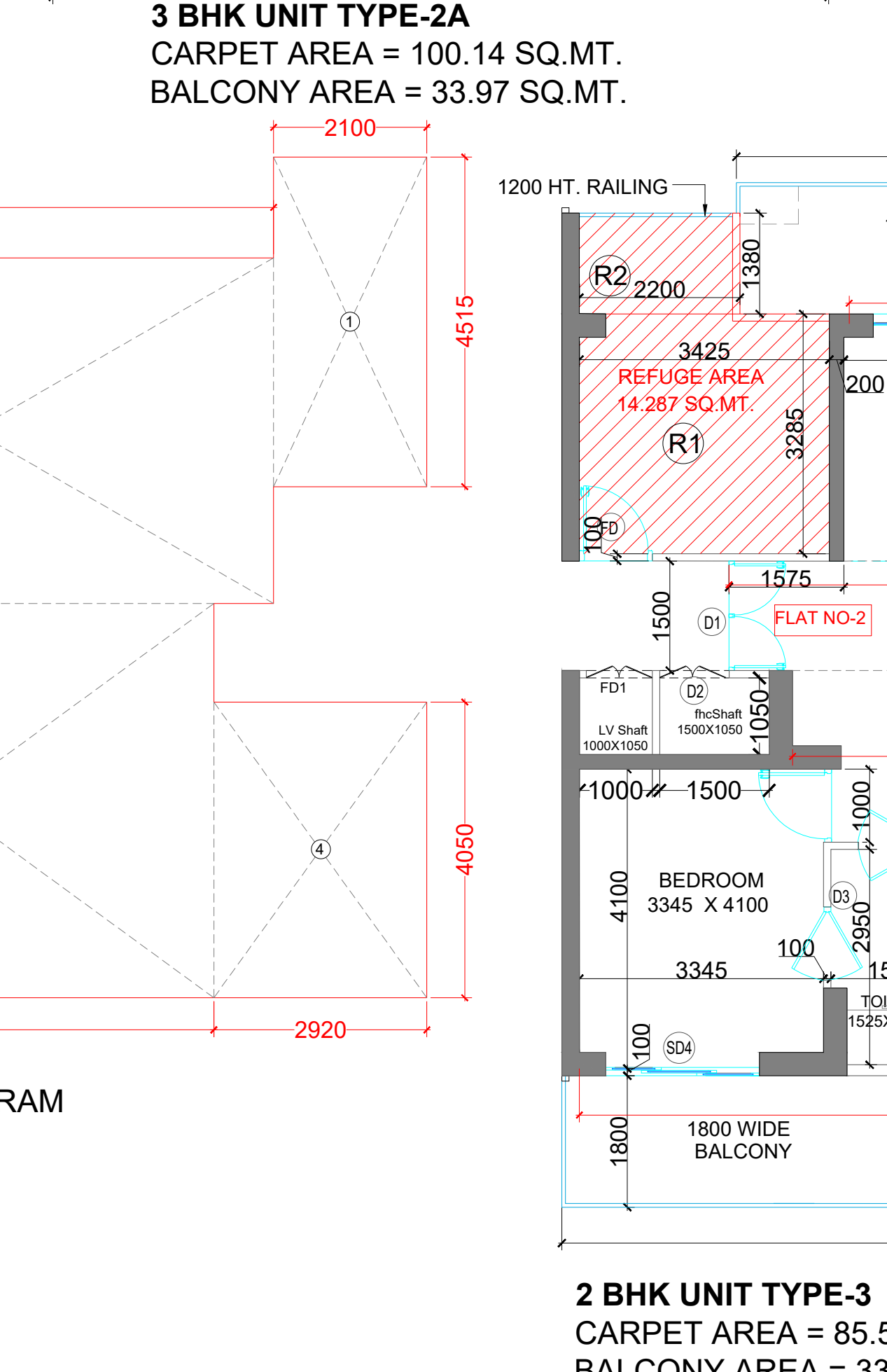

2 BHK UNIT CARPET AREA (REFUGE AREA) (TYPE-3)

1	1	6.620	X	3.230	=	21.38
2	1	8.265	X	1.500	=	12.40
3	1	7.395	X	1.350	=	9.98
4	1	10.315	X	4.050	=	41.78
TOTAL CARPET AREA						= 85.54

BALCONY AREA CHART TYPE-3

A	1	1.800	X	10.630	=	19.13
B	1	1.800	X	8.240	=	14.83
BALCONY AREA						= 33.97

CLIENT:- M/S EMPERIUM INFRASTRUCTURE PVT. LTD.

PROJECT :- PROPOSED GROUP HOUSING COLONY UNDER RETIREMENT HOUSING POLICY DATED 17.08.2021 OVER AN AREA MEASURING 1.03125 ACRES IN THE REVENUE ESTATE OF VILLAGE HARSARU, SECTOR -88A, DISTRICT GURUGRAM (HARYANA) (LICENCE NO 165 OF 2025 DATED 04.09.2025) BEING DEVELOPED BY M/S EMPERIUM INFRASTRUCTURE PVT. LTD.

SCALE : 1:100

DRAWING NAME: A1

UNIT PLANS & AREA DIAGRAM

DRAWING NO. SUB-10

APPLICANT'S SIGN. ARCHITECT'S SIGN