

DOOR, WINDOW & VENTILATOR SCHEDULE				
S.No.	TYPE	WIDTH	CILL	LINTEL
1	D	1.075	0	2.450
2	D1	1.000	0	2.450
3	D2	0.750	0	2.450
4	D3	0.995	0	2.450
5	DW1	1.750	0	2.450
6	W/EF	1.850	0	2.450
7	W1	1.525	900	2.450
8	V/PV	0.750	1.550	2.450

AREA STATEMENT						
TOTAL PLOT AREA = 8.650 M X 15.000 M		129.750	sq.mts.			
ERMISSIBLE COVERED F.A.R. @ 200%		259.500	sq.mts.			
TOTAL PERMISSIBLE GROUND COVERAGE @ 75%		97.313	sq.mts.			
ACHIVED F.A.R. @ 64%		83.040	sq.mts.			
TOTAL FAR 264%		342.540	sq.mts.			
PROPOSED F.A.R. AREA OF STILT						
A	1.730	X	1.535	=	2.656	sq.mts.
B	2.195	X	4.535	=	9.954	sq.mts.
C	1.730	X	1.730	=	2.993	sq.mts.
TOTAL FAR AREA OF A+B+C				=	15.603	sq.mts.
NON F.A.R. AREA OF STILT						
AA	8.650	X	11.320	=	97.918	sq.mts.
1+2+A+B+C				=	20.316	sq.mts.
TOTAL AREA FAR + NON FAR (AA - 1+2)				=	77.602	sq.mts.
PROPOSED F.A.R. ON FIRST FLOOR 5.854						
AA	8.650	X	11.320	=	97.918	sq.mts.
or	97.918	LESS	16.362	=	81.556	sq.mts.
1	2.485	X	1.565	=	3.889	sq.mts.
2	6.340	X	0.130	=	0.824	sq.mts.
3	1.850	X	4.075	=	7.539	sq.mts.
4	0.230	X	1.075	=	0.247	sq.mts.
5	1.500	X	1.075	=	1.613	sq.mts.
6	1.500	X	1.500	=	2.250	sq.mts.
TOTAL OF 1 TO 6				=	16.362	sq.mts.
PROPOSED F.A.R. ON FIRST FLOOR				=	81.556	sq.mts.
PROPOSED F.A.R. ON SECOND FLOOR				=	81.556	sq.mts.
PROPOSED F.A.R. ON THIRD FLOOR				=	81.556	sq.mts.
PROPOSED F.A.R. ON FOURTH FLOOR				=	81.556	sq.mts.
TOTAL PROPOSED F.A.R. AREA ON ALL FLOORS (STILT + FF + SF + TF + 4TH)				=	341.827	sq.mts.
NON F.A.R. AREA OF MUMTY						
A	1.730	X	1.535	=	2.656	sq.mts.
B	2.195	X	4.535	=	9.954	sq.mts.
C	1.730	X	1.730	=	2.993	sq.mts.
TOTAL AREA (A+B+C)				=	15.603	sq.mts.
FLOORS	FAR AREA	+	NON FAR AREA		TOTAL	SQ.MTS.
STILT AREA	15.603	+	77.602		93.205	sq.mts.
FIRST FLOOR			3+4+5+6		11.649	sq.mts.
SECOND FLOOR	81.556	+	3+4+5+6		93.205	sq.mts.
THIRD FLOOR	81.556	+	3+4+5+6		93.205	sq.mts.
FOURTH FLOOR	81.556	+	3+4+5+6		93.205	sq.mts.
MUMTY AREA=			15.603		15.603	sq.mts.
TOTAL ALL FLOOR AREA (FAR AREA + NON FAR AREA)				=	481.628	sq.mts.

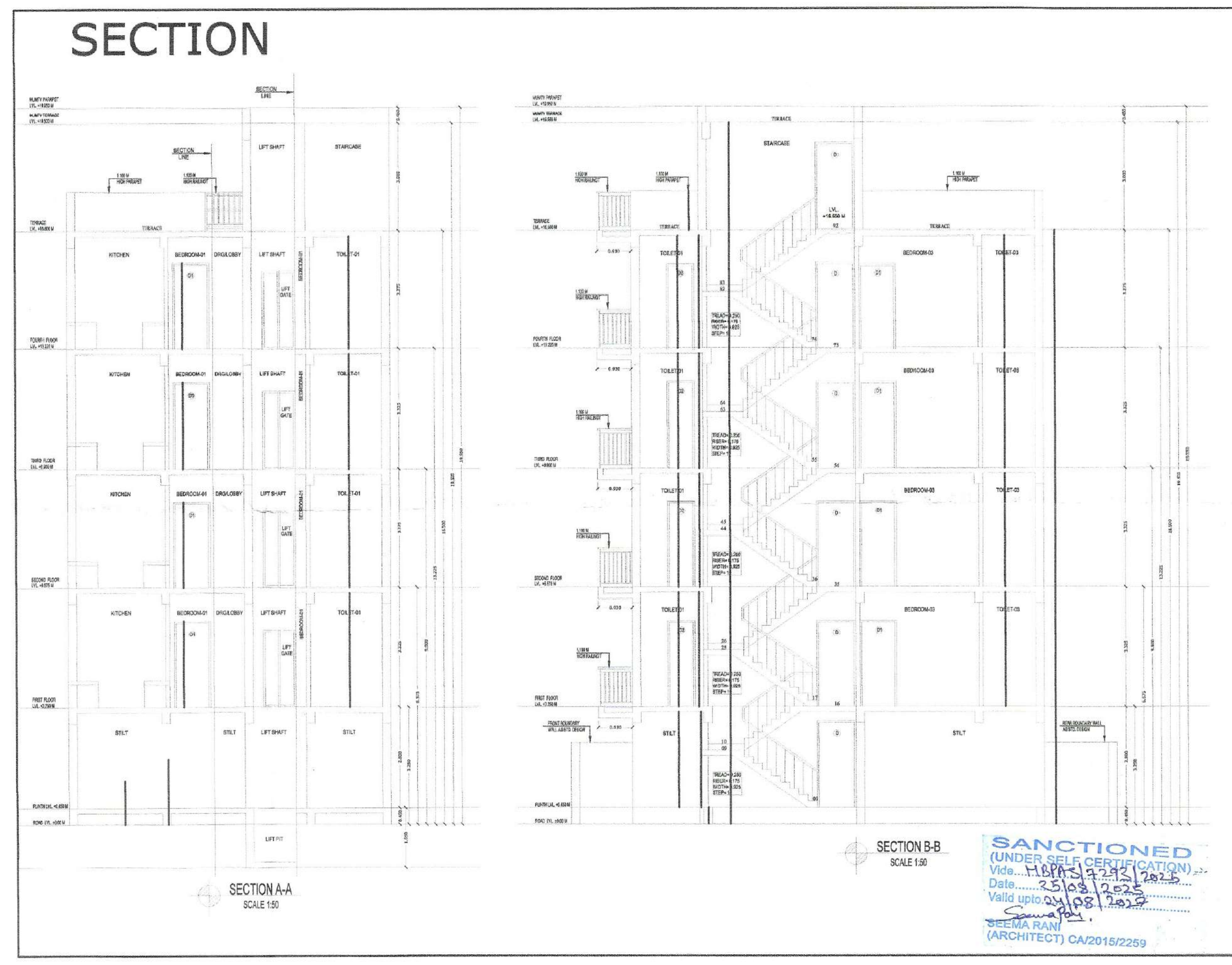

SANCTIONED
(UNDER SELF CERTIFICATION)
Vide... 11/09/2023
Date... 25/08/2023
Valid upto 01/08/2025
SEEMA RANI
(ARCHITECT) CA/2015/2259

OWNER NAME:- LION INFRADEVELOPERS LLP
PLOT NO:- A-04
at Sector 06, Sohna, Haryana

PROJECT NAME:- RESIDENTIAL PLOTTED COLONY UNDER DD.JAY MERASURING 12.505 ACRES (LICENCE NO. 188 OF 2023 DATED 15.07.2023) IN SECTOR-06, SOHNA BEING DEVELOPED BY LION INFRADEVELOPERS LLP.

STILT FLOOR PLAN, FIRST FLOOR PLAN, SECOND FLOOR PLAN, THIRD FLOOR PLAN, FOURTH FLOOR PLAN, TERRACE PLAN, MUMTY PLAN, D/W SCHEDULE, AREA CHART, ELEVATION & SECTION

Dwg. No. - AR/PLOT NO-A-04/SHEET 01 OF 01 Scale 1:50

ARCHITECT'S SIGN OWNER'S SIGN

Signature of Architect
SEEMA RANI
CA/2015/2259

FOR LION INFRADEVELOPERS LLP

Drawn by:- PANKAJ KAPOOR Mob. No. - 880093157