

DOOR, WINDOW & VENTILATOR SCHEDULE

S.No.	TYPE	WIDTH	CILL	LINTEL
1	D	1.075	0	2.450
2	D1	1.000	0	2.450
3	D2	0.750	0	2.450
4	D3	1.105	0	2.450
5	DW1	1.750	0	2.450
6	W/E	1.735	0	2.450
7	W1	1.525	900	2.450
8	V/PV	0.750	1.550	2.450

AREA STATEMENT

TOTAL PLOT AREA = (8.650 M X 15.000 M) - (1.150 M X 0.922 M / 2)	129.220	sq.mts.		
ERMISSIBLE COVERED F.A.R. @ 200%	258.440	sq.mts.		
TOTAL PERMISSIBLE GROUND COVERAGE @ 75%	96.915	sq.mts.		
ACHIVED F.A.R. @ 64%	82.701	sq.mts.		
TOTAL FAR 264%	341.141	sq.mts.		
PROPOSED F.A.R. AREA OF STILT				
A	1.730 X 1.535	= 2.656 sq.mts.		
B	2.195 X 4.535	= 9.954 sq.mts.		
C	1.730 X 1.730	= 2.993 sq.mts.		
TOTAL FAR AREA OF A+B+C	15.603	sq.mts.		
NON F.A.R. AREA OF STILT				
AA	8.650 X 11.320	= 97.918 sq.mts.		
1+2+A+B+C	20.488	sq.mts.		
TOTAL AREA FAR + NON FAR (AA - 1+2)	77.430	sq.mts.		
PROPOSED F.A.R. ON FIRST FLOORS.854				
AA	8.650 X 11.320	= 97.918 sq.mts.		
1	2.595 X 1.565	= 4.061 sq.mts.		
2	6.340 X 0.130	= 0.824 sq.mts.		
3	1.850 X 4.075	= 7.539 sq.mts.		
4	0.230 X 1.075	= 0.247 sq.mts.		
5	1.500 X 1.075	= 1.613 sq.mts.		
6	1.500 X 1.500	= 2.250 sq.mts.		
TOTAL OF 1 TO 6	16.534	sq.mts.		
PROPOSED F.A.R. ON FIRST FLOOR	81.384	sq.mts.		
PROPOSED F.A.R. ON SECOND FLOOR	81.384	sq.mts.		
PROPOSED F.A.R. ON THIRD FLOOR	81.384	sq.mts.		
PROPOSED F.A.R. ON FOURTH FLOOR	81.384	sq.mts.		
TOTAL PROPOSED F.A.R. AREA ON ALL FLOORS (STILT + FF + SF + TF+ 4TH)	341.139	sq.mts.		
NON F.A.R. AREA OF MUMTY				
A	1.730 X 1.535	= 2.656 sq.mts.		
B	2.195 X 4.535	= 9.954 sq.mts.		
C	1.730 X 1.730	= 2.993 sq.mts.		
TOTAL AREA (A+B+C)	15.603	sq.mts.		
FLOORS	FAR AREA	+ NON FAR AREA	TOTAL	SQ.MTS.
STILT AREA	15.603	+ 77.430	= 93.033	sq.mts.
FIRST FLOOR	81.384	+ 3+4+5+6	= 11.649	sq.mts.
SECOND FLOOR	81.384	+ 3+4+5+6	= 11.649	sq.mts.
THIRD FLOOR	81.384	+ 3+4+5+6	= 11.649	sq.mts.
FOURTH FLOOR	81.384	+ 3+4+5+6	= 11.649	sq.mts.
MUMTY AREA=		15.603	= 15.603	sq.mts.
TOTAL ALL FLOOR AREA (FAR AREA + NON FAR AREA)			480.768	sq.mts.

ELEVATION



SECTION

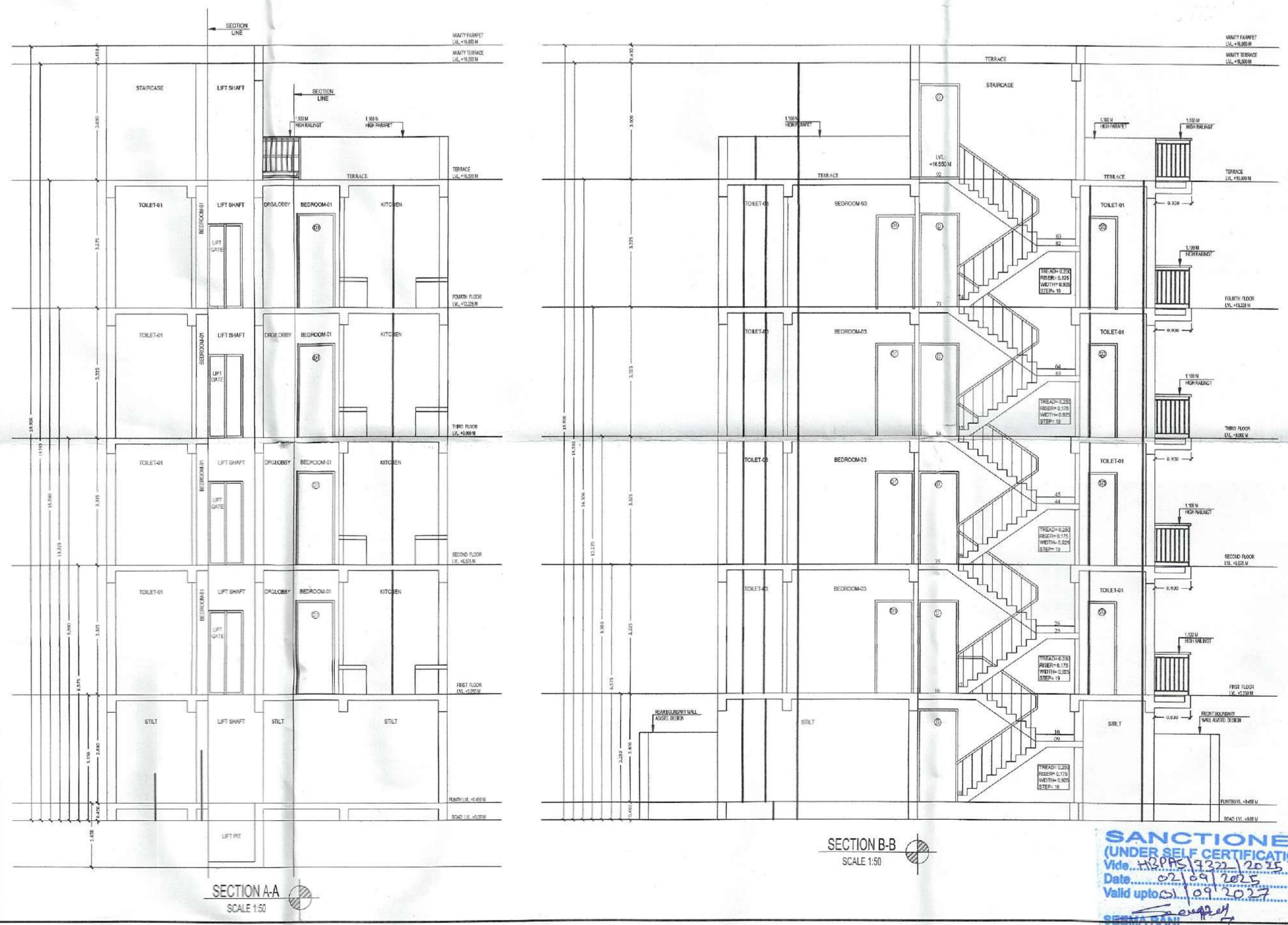

SANCTIONED
(UNDER SELF CERTIFICATION)
Vide: 10/05/2023/2023
Date: 02/09/2023
Valid upto: 09/2025
SEEMA RANI
(ARCHITECT) CA/2015/2259

OWNER NAME:- LION INFRADEVELOPERS LLP
PLOT NO= A-12A
of Sector 06, Sohna, Haryana

PROJECT NAME:- RESIDENTIAL PLOTTED COLONY UNDER DDJAY MERASURING 12.505 ACRES (LICENCE NO. 188 OF 2023 DATED 15.09.2023) IN SECTOR-06, SOHNA BEING DEVELOPED BY LION INFRADEVELOPERS LLP.

STILT FLOOR PLAN, FIRST FLOOR PLAN, SECOND FLOOR PLAN, THIRD FLOOR PLAN, FOURTH FLOOR PLAN, TERRACE PLAN, MUMTY PLAN, D/W SCHEDULE, AREA CHART, ELEVATION & SECTION

Diag. No.- AR/PLOT NO=A-12A/SHEET 01 OF 01 Scale 1:50

ARCHITECT'S SIGN: *Seema Rani*
Signature of Architect
SEEMA RANI
CA/2015/2259

OWNER'S SIGN: *Pankaj Kapoor*
FOR LION INFRADEVELOPERS LLP
AUTHORISED SIGNATORY

Drawn by:- PANKAJ KAPOOR Mob. No. - 8800093157