

**DOOR, WINDOW & VENTILATOR SCHEDULE**

S.No.	TYPE	WIDTH	CHILL	LINTEL
1	D	1.165	0	2.450
2	D1	1.000	0	2.450
3	D2	0.750	0	2.450
4	SD1	2.125	0	2.450
5	W/EF	1.200	0.9	2.450
6	W1	1.525	1.900	2.450
7	V/PV	0.600	1.550	2.450

**AREA STATEMENT**

TOTAL PLOT AREA = 7.000 M X 15.000 M	105.000	sq.mts.
PERMISSIBLE COVERED F.A.R. @ 200%	210.000	sq.mts.
TOTAL PERMISSIBLE GROUND COVERAGE @ 75%	78.750	sq.mts.
ACHIEVED F.A.R. @ 64%	67.200	sq.mts.
<b>TOTAL FAR 264%</b>	<b>277.200</b>	<b>sq.mts.</b>
<b>PROPOSED F.A.R. AREA OF STILT</b>		
A	1.845 X 1.730	= 3.192 sq.mts.
B	2.195 X 4.625	= 10.152 sq.mts.
<b>TOTAL FAR AREA OF A+B</b>		<b>= 13.344 sq.mts.</b>
<b>NON F.A.R. AREA OF STILT</b>		
AA	7.000 X 11.500	= 80.500 sq.mts.
1+2+4+5+6		= 18.276 sq.mts.
<b>TOTAL AREA FAR + NON FAR (AA - 1+2)</b>		<b>= 61.924 sq.mts.</b>
<b>PROPOSED F.A.R. ON FIRST FLOOR</b>		
AA	7.000 X 11.500	= 80.500 sq.mts.
1	2.115 X 1.565	= 3.310 sq.mts.
2	4.805 X 0.400	= 1.922 sq.mts.
3	1.850 X 4.165	= 7.705 sq.mts.
4	1.500 X 1.500	= 2.250 sq.mts.
<b>TOTAL OF 1 TO 4</b>		<b>= 15.187 sq.mts.</b>
<b>PROPOSED F.A.R. ON FIRST FLOOR</b>		<b>= 65.313 sq.mts.</b>
<b>PROPOSED F.A.R. ON SECOND FLOOR</b>		<b>= 65.313 sq.mts.</b>
<b>PROPOSED F.A.R. ON THIRD FLOOR</b>		<b>= 65.313 sq.mts.</b>
<b>PROPOSED F.A.R. ON FOURTH FLOOR</b>		<b>= 65.313 sq.mts.</b>
<b>TOTAL PROPOSED F.A.R. AREA ON ALL FLOORS (STILT + FF + SF + TF + 4TH)</b>		<b>= 274.596 sq.mts.</b>
<b>NON F.A.R. AREA OF MUMMY</b>		
A	1.845 X 1.730	= 3.192 sq.mts.
B	2.195 X 4.625	= 10.152 sq.mts.
<b>TOTAL FAR AREA OF A+B</b>		<b>= 13.344 sq.mts.</b>
<b>FLOORS FAR AREA + NON FAR AREA</b>		
STILT AREA	13.344 + 61.924	= 75.268 sq.mts.
FIRST FLOOR	65.313 + 9.955	= 75.268 sq.mts.
SECOND FLOOR	65.313 + 9.955	= 75.268 sq.mts.
THIRD FLOOR	65.313 + 9.955	= 75.268 sq.mts.
FOURTH FLOOR	65.313 + 9.955	= 75.268 sq.mts.
MUMMY AREA	13.344	= 13.344 sq.mts.
<b>TOTAL ALL FLOOR AREA (FAR AREA + NON FAR AREA)</b>		<b>= 389.684 sq.mts.</b>

**SECTION**

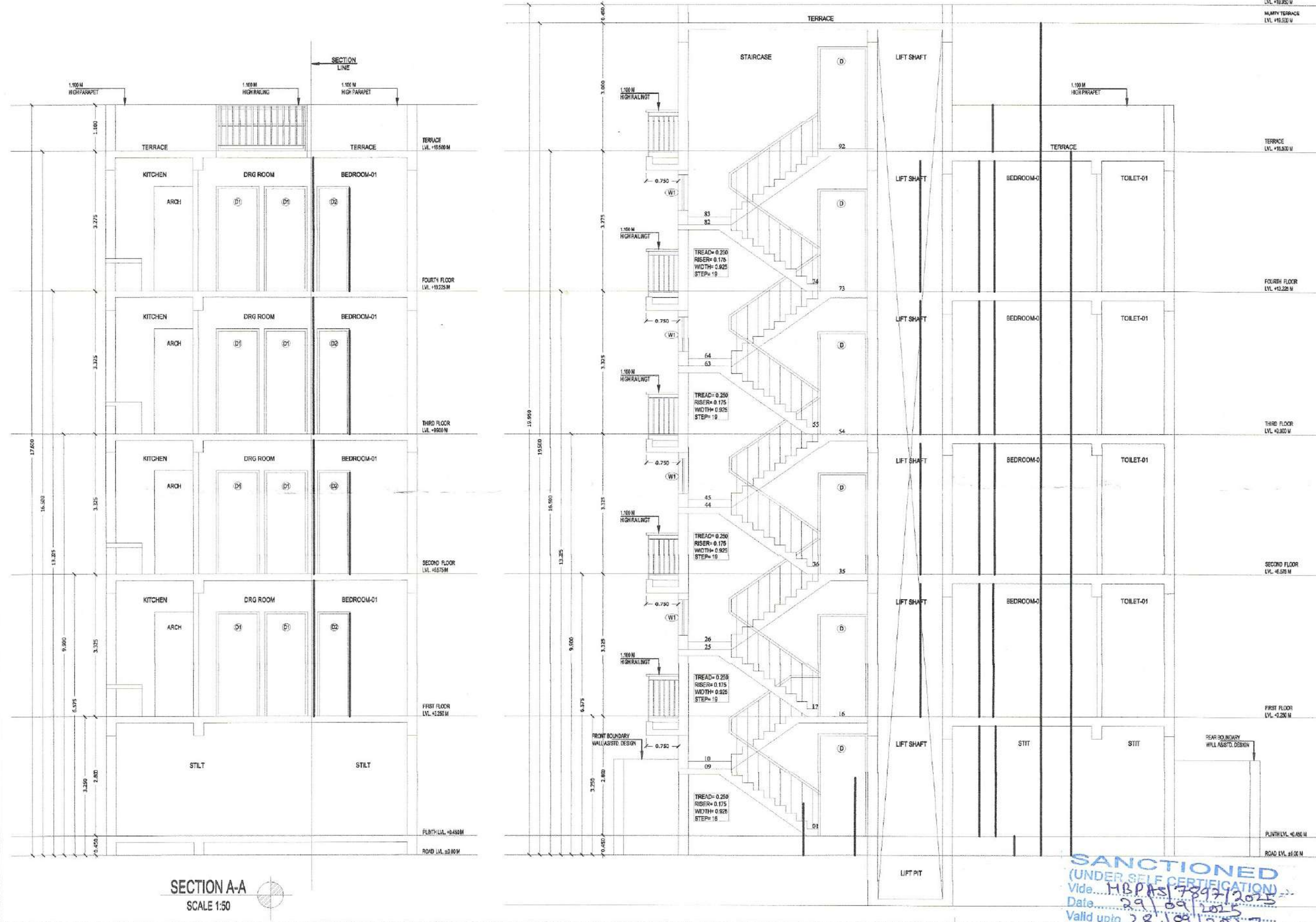

**OWNER NAME:- LION INFRADEVELOPERS LLP**  
 PLOT NO:- B-165  
 at Sector 06, Sohna, Haryana

**PROJECT NAME:- RESIDENTIAL PLOTTED COLONY UNDER DDJAY MERASURING 12.505 ACRES (LICENCE NO. 188 OF 2023 DATED 15.09.2023) IN SECTOR-06, SOHNA BEING DEVELOPED BY LION INFRADEVELOPERS LLP.**

STILT FLOOR PLAN, FIRST FLOOR PLAN, SECOND FLOOR PLAN, THIRD FLOOR PLAN, FOURTH FLOOR PLAN, TERRACE PLAN, MUMMY PLAN, D/W SCHEDULE, AREA CHART, ELEVATION & SECTION

Drp. No.- AR/PLOT NO=B-165/SHEET 01 OF 01 Scale 1:50

ARCHITECTS SIGN: **Signature of SEEMA RANI**  
 CA/2015/72259  
 Drawn by:- PANKAJ KAPOOR

OWNER'S SIGN: **Signature of PANKAJ KAPOOR**  
 FOR LION INFRADEVELOPERS LLP  
 Mob. No. - 8800093157

**SANCTIONED**  
 (UNDER THE  
 Vido...  
 Date...  
 Valid upto...  
 SEEMA RANI  
 (ARCHITECT) CA/2015/72259