

DOOR, WINDOW & VENTILATOR SCHEDULE

S.No.	TYPE	WIDTH	CILL	LINTEL
1	D	1.075	0	2.450
2	D1	1.000	0	2.450
3	D2	0.750	0	2.450
4	D3	0.995	0	2.450
5	DW1	1.750	0	2.450
6	W/EF	1.735	0	2.450
7	WI	1.525	900	2.450
8	V/PV	0.750	1.550	2.450

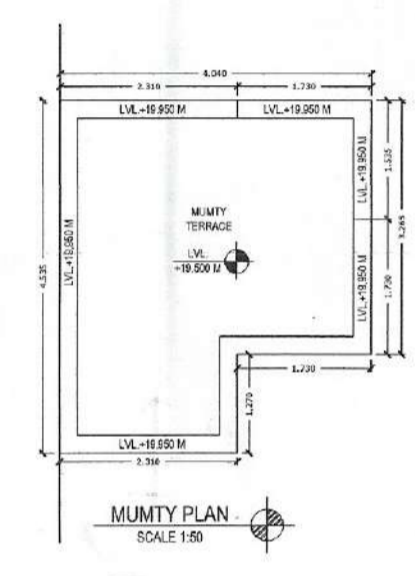

AREA STATEMENT

TOTAL PLOT AREA = 8.650 M X 15.000 M	129.750	sq.mts.		
PERMISSIBLE COVERED F.A.R. @ 200%	259.500	sq.mts.		
TOTAL PERMISSIBLE GROUND COVERAGE @ 75%	97.313	sq.mts.		
ACHIVED F.A.R. @ 64%	83.040	sq.mts.		
TOTAL FAR 264%	342.540	sq.mts.		
PROPOSED F.A.R. AREA OF STILT				
A	1.730 X 1.535	= 2.656 sq.mts.		
B	2.310 X 4.535	= 10.476 sq.mts.		
C	1.730 X 1.730	= 2.993 sq.mts.		
TOTAL FAR AREA OF A+B+C	= 16.125	sq.mts.		
NON F.A.R. AREA OF STILT				
AA	8.650 X 11.320	= 97.918 sq.mts.		
1+2+A+B+C	= 20.823	sq.mts.		
TOTAL AREA FAR + NON FAR (AA - 1+2)	= 77.095	sq.mts.		
PROPOSED F.A.R. ON FIRST FLOORS 854				
AA	8.650 X 11.320	= 97.918 sq.mts.		
1	2.485 X 1.565	= 3.889 sq.mts.		
2	6.225 X 0.130	= 0.809 sq.mts.		
3	1.850 X 4.075	= 7.539 sq.mts.		
4	0.230 X 1.075	= 0.247 sq.mts.		
5	1.500 X 1.075	= 1.613 sq.mts.		
6	1.500 X 1.500	= 2.250 sq.mts.		
TOTAL OF 1 TO 6	= 16.347	sq.mts.		
PROPOSED F.A.R. ON FIRST FLOOR	= 81.571	sq.mts.		
PROPOSED F.A.R. ON SECOND FLOOR	= 81.571	sq.mts.		
PROPOSED F.A.R. ON THIRD FLOOR	= 81.571	sq.mts.		
PROPOSED F.A.R. ON FOURTH FLOOR	= 81.571	sq.mts.		
TOTAL PROPOSED F.A.R. AREA ON ALL FLOORS (STILT + FF + SF + TF+ 4TH)	= 342.409	sq.mts.		
NON F.A.R. AREA OF MUMTY				
A	1.730 X 1.535	= 2.656 sq.mts.		
B	2.310 X 4.535	= 10.476 sq.mts.		
C	1.730 X 1.730	= 2.993 sq.mts.		
TOTAL AREA (A+B+C)	= 16.125	sq.mts.		
FLOORS	FAR AREA	+ NON FAR AREA	TOTAL	SQ.MTS.
STILT AREA	16.125	+ 77.095	= 93.220	sq.mts.
FIRST FLOOR	81.571	+ 11.649	= 93.220	sq.mts.
SECOND FLOOR	81.571	+ 11.649	= 93.220	sq.mts.
THIRD FLOOR	81.571	+ 11.649	= 93.220	sq.mts.
FOURTH FLOOR	81.571	+ 11.649	= 93.220	sq.mts.
MUMTY AREA		+ 16.125	= 16.125	sq.mts.
TOTAL ALL FLOOR AREA (FAR AREA + NON FAR AREA)	= 482.225	sq.mts.		

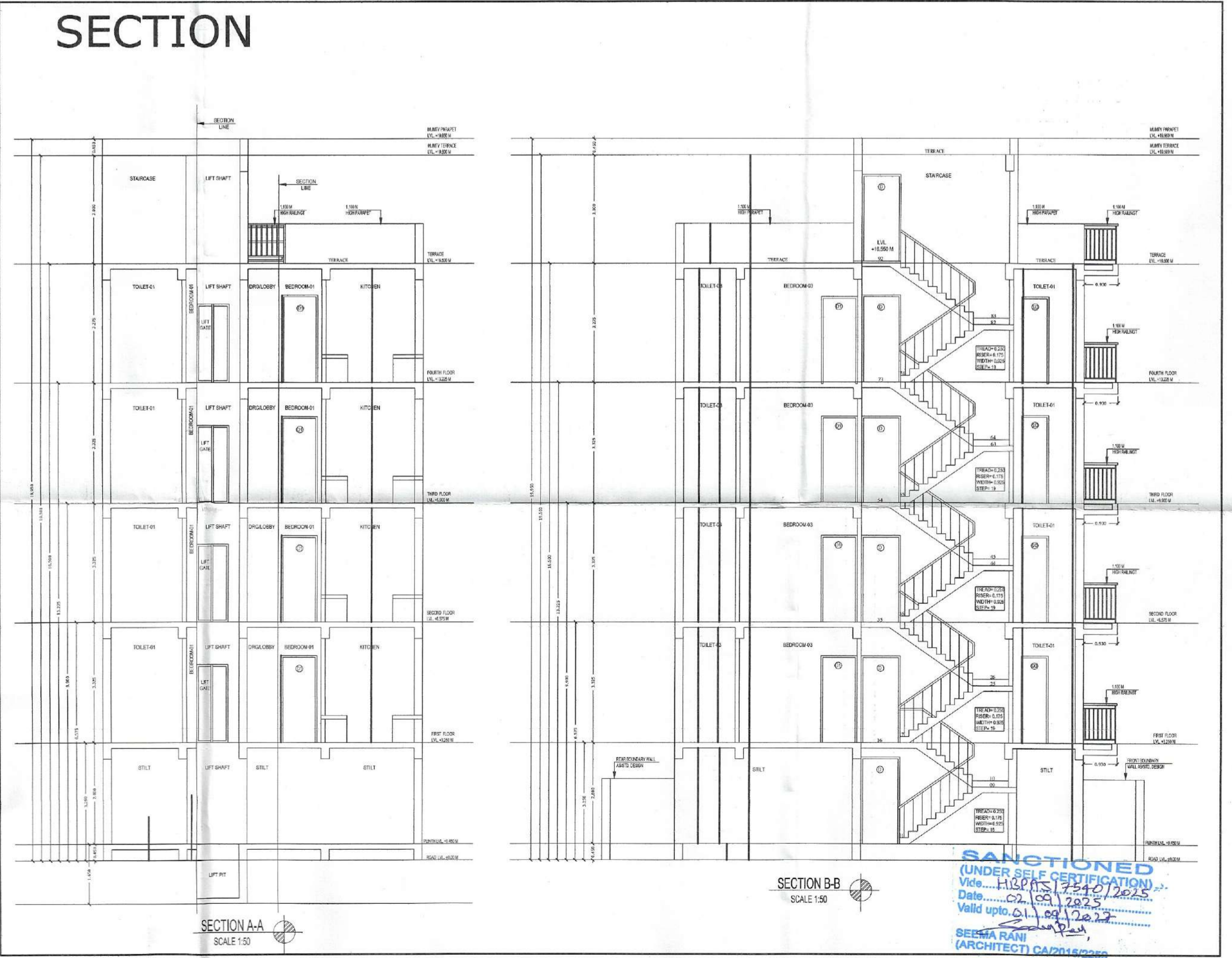

SANCTIONED
(UNDER SELF CERTIFICATION)
Vide H.O.P.S. 1746/2025
Date 01.08.2025
Valid upto 01.08.2027
SEEMA RANI
(ARCHITECT) CAP/15/2026

OWNER NAME:- LION INFRADEVELOPERS LLP
PLOT NO= A-25
at Sector 06, Sohna, Haryana

PROJECT NAME:- RESIDENTIAL PLOTTED COLONY UNDER DDJAY MERASURING 12.505 ACRES (LICENCE NO. 188 OF 2023 DATED 15.09.2023) IN SECTOR-06, SOHNA BEING DEVELOPED BY LION INFRADEVELOPERS LLP.

STILT FLOOR PLAN, FIRST FLOOR PLAN, SECOND FLOOR PLAN, THIRD FLOOR PLAN, FOURTH FLOOR PLAN, TERRACE PLAN, MUMTY PLAN, D/W SCHEDULE, AREA CHART, ELEVATION & SECTION

Dig. No. - AR/PLOT NO=A-25/SHEET 01 OF 01 Scale 1:50

ARCHITECT'S SIGN: *Seema Rani*
OWNER'S SIGN: *[Signature]*

Signature of Architect
SEEMA RANI
CA/2015/72259

FOR LION INFRADEVELOPERS LLP
[Signature]
AUTHORISED SIGNATORY

Drawn by:- PANKAJ KAPOOR Mob. No. - 8800093157