

DETAIL OF RESIDENTIAL PLOTS					
S.NO.	CATEGORY	SIZE(IN METERS)	AREA(IN SQMT)	NO. OF PLOTS	TOTAL(IN SQMT)
1	A	8.84 X 14.33	= 126.68	3	= 380.04
2	A1	8.65 X 14.33	= 123.95	1	= 123.95
3	A2	AS PER PLAN	= 114.63	1	= 114.63
4	A3	AS PER PLAN	= 121.45	1	= 121.45
5	A4	AS PER PLAN	= 125.80	1	= 125.80
6	A5	AS PER PLAN	= 130.30	1	= 130.30
7	B	7.93 X 16.46	= 130.53	6	= 783.18
8	B1	7.32 X 16.46	= 120.49	1	= 120.49
9	B2	AS PER PLAN	= 116.96	1	= 116.96
10	B3	AS PER PLAN	= 123.24	1	= 123.24
11	B4	AS PER PLAN	= 129.52	1	= 129.52
12	B5	AS PER PLAN	= 135.81	1	= 135.81
13	B6	AS PER PLAN	= 142.09	1	= 142.09
14	B7	AS PER PLAN	= 148.37	1	= 148.37
15	B8	AS PER PLAN	= 142.44	1	= 142.44
16	B9	AS PER PLAN	= 148.11	1	= 148.11
17	B10	AS PER PLAN	= 146.15	1	= 146.15
18	B11	AS PER PLAN	= 147.70	1	= 147.70
19	B12	AS PER PLAN	= 147.74	1	= 147.74
20	C	7.85 X 19.03	= 149.39	11	= 1643.29
21	C1	7.47 X 19.03	= 142.15	1	= 142.15
22	D	7.62 X 19.51	= 148.67	22	= 3270.74
23	E	7.62 X 19.35	= 147.45	14	= 2064.30
24	F	8.00 X 16.88	= 135.04	8	= 1080.32
25	F1	8.05 X 16.88	= 135.88	1	= 135.88
26	F2	7.00 X 16.88	= 118.16	2	= 236.32
27	F3	8.66 X 16.88	= 146.18	8	= 1169.44
28	F4	8.83 X 16.88	= 149.05	1	= 149.05
29	F5	7.64 X 16.88	= 128.96	1	= 128.96
30	G	7.17 X 19.35	= 138.74	6	= 832.44
31	G1	7.33 X 19.35	= 141.84	1	= 141.84
32	TOTAL		14422.70 SQMT	102	3.5639 ACRES 51.59%

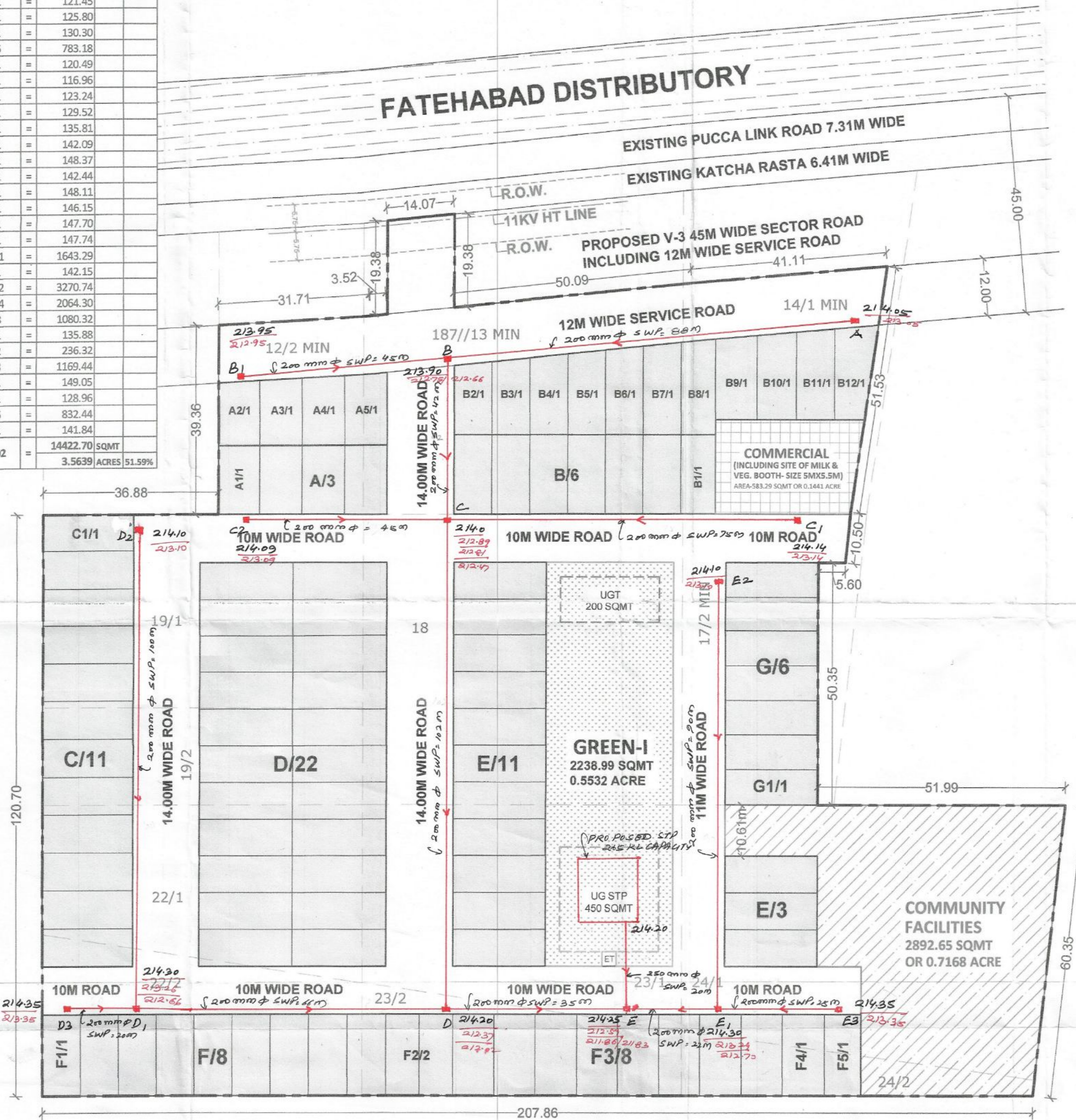

- To be read with Licence No. 221 of 2025 Dated 13-11-2025
- This layout plan for an area measuring 7.1479 acres (Drawing no. 1110 Dated 14-11-2025) comprised of license which is issued in respect of Affordable Residential Plotted Colony (Under Deen Dayal Jan Awas Yojna-2016) being developed by Kushal Kumar & Parveen Kumar falling in the revenue estate of village Basti Bhiwan, Sector-12, Tehsil and District, Fatehabad is hereby approved subject to the following conditions:-
- That this Layout Plan shall be read in conjunction with the clauses appearing on the agreement executed under Rule 11 and the bilateral agreement.
 - That the plotted area of the colony shall not exceed 65% of the net planned area of the colony. The entire area reserved for commercial purposes shall be taken as plotted for calculation of the area under plots.
 - That the demarcation plans as per site of all the Residential Plots and Commercial site shall be got approved from this Department and construction on these sites shall be governed by the Haryana Building Code, 2017 and the Zoning Plan approved by the Director, Town & Country Planning, Haryana.
 - That for proper planning and integration of services in the area adjacent to the colony, the colonizer shall abide by the directions of the DTCP for the modification of layout plans of the colony.
 - That the revenue rasta falling in the colony shall be kept free for circulation/movement as shown in the layout plan.
 - That the colonizer shall abide by the directions of the DTCP, Haryana and accordingly shall make necessary changes in the layout plan for making any adjustment in the alignment of the peripheral roads, internal road circulation or for proper integration of the planning proposals of the adjoining areas.
 - That no property/plot shall derive access directly from the carriage way of 30 metres or wider sector road if applicable.
 - All green belts provided in the layout plan within the licenced areas of the colony shall be developed by the colonizer. All other green belts outside the licenced area shall be developed by the Haryana Urban Development Authority/colonizer on the directions of the Director, Town and Country planning, Haryana or in accordance with terms and conditions of the agreements of the licence.
 - At the time of demarcation plan, if required percentage of organized open space is reduced, the same will be provided by the colonizer in the licenced area.
 - No plot will derive an access from less than 9 metres wide road would mean a minimum clear width of 9 metres between the plots.
 - Any excess area over and above the permissible 4% under commercial use shall be deemed to be open space.
 - The portion of the sector/development plan roads /green belts as provided in the Development Plan if applicable, which form part of the licenced area shall be transferred free of cost to the government on the lines of Section 3(3)(a)(ii) of the Act No.8 of 1975.
 - That the odd size plots are being approved subject to the conditions that these plots should not have a frontage of less than 75% of the standard frontage when demarcated.
 - That you will have no objection to the regularization of the boundaries of the licence through give and take with the land that HSP is finally able to acquire in the interest of planned development and integration of services. The decision of the competent authority shall be binding in this regard.
 - That the rain water harvesting system shall be provided as per Central Ground Water Authority norms/Haryana Govt. notification as applicable.
 - That the colonizer/owner shall use only Light-Emitting Diode lamps (LED) fitting for internal lighting as well as Campus lighting.
 - That the colonizer/owner shall ensure the installation of Solar Photovoltaic Power Plant as per the provisions of order No.22/52/2005-SPower dated 21.03.2016 issued by Haryana Government Renewable Energy Department.
 - That the colonizer/owner shall strictly comply with the directions issued vide Modification No. 19/16/2016-SP dated 31.03.2016 issued by Haryana Government Renewable Energy Department for enforcement of the Energy Conservation Building Codes.

(PRAYASONI) ATP(HQ)
 (SAVITA JINDAL) TTP(HQ)
 (VUENDER SINGH) STP(HQ)
 (BHUVNESH KUMAR) CTP(HR)
 (AMIT KHATRI, IAS) DTP(HR)
 (PARVEEN KUMAR) SD(HQ)

REFERENCE:

1. PROPOSED SW PIPE SEWER LINE SHOW AS	=	
2. PROPOSED SEWAGE TREATMENT PLANT SHOWN AS	=	ETP
3. PROPOSED FORMATION LEVELS OF ROADS SHOWN AS	=	2/3-90
4. PROPOSED BED LEVEL OF SEWER LINE SHOWN AS	=	2/2-66

PROPOSED LAYOUT PLAN OF AFFORDABLE RESIDENTIAL PLOTTED COLONY UNDER DEEN DAYAL JAN AWAS YOJANA-2016 OVER AN AREA MEASURING 7.1479 ACRES IN THE REVENUE ESTATE OF VILL. BASTI BHIWAN, SECTOR-12, DISTT. FATEHABAD - SH. KUSHAL KUMAR, SH. PARVEEN KUMAR CHARAIPOTRA S/O SH. HARDAYAL

AREA CALCULATIONS					
S.NO.	PARTICULARS	PROPOSAL (ACRE)	PROPOSAL (%)	PERMISSIBLE (ACRE)	PERMISSIBLE (%)
1	TOTAL AREA OF THE SCHEME	7.1479	-	-	-
2	AREA UNDER V-3 SECTOR ROAD 45M WIDE INCLUDING 12M WIDE SERVICE ROAD	0.4808	-	-	-
3	BALANCE AREA	6.6671	-	-	-
4	50% BENEFIT OF AREA UNDER V-3 SECTOR ROAD 45M WIDE INCLUDING 12M WIDE SERVICE ROAD	0.2404	-	-	-
5	NET PLANNED AREA	6.9075	-	-	-
6	AREA UNDER RESIDENTIAL PLOTS	3.5639	51.59%	4.2135	61.00%
7	AREA UNDER COMMERCIAL	0.1441	2.09%	0.2763	4.00%
8	TOTAL SALEABLE AREA(6 + 7)	3.7080	53.68%	4.4898	65.00%
9	OPEN SPACE/PARKS	0.5532	7.74%	0.5360	7.50%
10	COMMUNITY FACILITIES	0.7147	10.00%	0.7147	10.00%

DIVINE
ARCHITECTS & PLANNERS

ADDRESS : SCO 76-77, 1st FLOOR, SECTOR-8C, MACHHA MARG, CHANDIGARH-160009.
 CONTACT : +91-98138-00376, +91-172-4765000
 EMAIL : divinearchitects18@gmail.com

LEGEND:
 ET
 PARKS / OPEN SPACES
 COMMERCIAL AREA
 COMMUNITY FACILITIES
 KILLA LINE
 SCHEME BOUNDARY
 UGT
 UG STP

ABBREVIATIONS-
 ET = ELECTRIC TRANSFORMER
 UG = UNDERGROUND WATER TANK
 UG STP = UNDERGROUND SEWAGE TREATMENT PLANT

DENSITY CALCULATION(PPA)-
 NUMBER OF PLOTS = 102
 UNITS ALLOWED = 4
 POPULATION ALLOWED PER UNIT = 4.5
 DENSITY CALCULATION = 102 X 4 X 4.5
 = 1836.0 / 6.9075
 = 266.80, SAY 266 PPA

GREEN AREA CALCULATION:-
 = GREEN-I
 = 2238.99 SQMT OR 0.5532 ACRE



(SCALE-N.T.S.)

(PERMISSIBLE DENSITY: 240 PPA - 400 PPA)

SIGNATURE OF OWNER / APPLICANT

SIGNATURE OF ARCHITECT / TOWN PLANNER



DETAIL OF RESIDENTIAL PLOTS					
S.NO.	CATEGORY	SIZE(IN METERS)	AREA(IN SQMT)	NO. OF PLOTS	TOTAL(IN SQMT)
1	A	8.84 X 14.33	= 126.68	3	= 380.04
2	A1	8.65 X 14.33	= 123.95	1	= 123.95
3	A2	AS PER PLAN	= 114.63	1	= 114.63
4	A3	AS PER PLAN	= 121.45	1	= 121.45
5	A4	AS PER PLAN	= 125.80	1	= 125.80
6	A5	AS PER PLAN	= 130.30	1	= 130.30
7	B	7.93 X 16.46	= 130.53	6	= 783.18
8	B1	7.32 X 16.46	= 120.49	1	= 120.49
9	B2	AS PER PLAN	= 116.96	1	= 116.96
10	B3	AS PER PLAN	= 123.24	1	= 123.24
11	B4	AS PER PLAN	= 129.52	1	= 129.52
12	B5	AS PER PLAN	= 135.81	1	= 135.81
13	B6	AS PER PLAN	= 142.09	1	= 142.09
14	B7	AS PER PLAN	= 148.37	1	= 148.37
15	B8	AS PER PLAN	= 142.44	1	= 142.44
16	B9	AS PER PLAN	= 148.11	1	= 148.11
17	B10	AS PER PLAN	= 146.15	1	= 146.15
18	B11	AS PER PLAN	= 147.70	1	= 147.70
19	B12	AS PER PLAN	= 147.74	1	= 147.74
20	C	7.85 X 19.03	= 149.39	11	= 1643.29
21	C1	7.47 X 19.03	= 142.15	1	= 142.15
22	D	7.62 X 19.51	= 148.67	22	= 3270.74
23	E	7.62 X 19.35	= 147.45	14	= 2064.30
24	F	8.00 X 16.88	= 135.04	8	= 1080.32
25	F1	8.05 X 16.88	= 135.88	1	= 135.88
26	F2	7.00 X 16.88	= 118.16	2	= 236.32
27	F3	8.66 X 16.88	= 146.18	8	= 1169.44
28	F4	8.83 X 16.88	= 149.05	1	= 149.05
29	F5	7.64 X 16.88	= 128.96	1	= 128.96
30	G	7.17 X 19.35	= 138.74	6	= 832.44
31	G1	7.33 X 19.35	= 141.84	1	= 141.84
32	TOTAL			102	14422.70 SQMT 3.5639 ACRES @ 51.59%

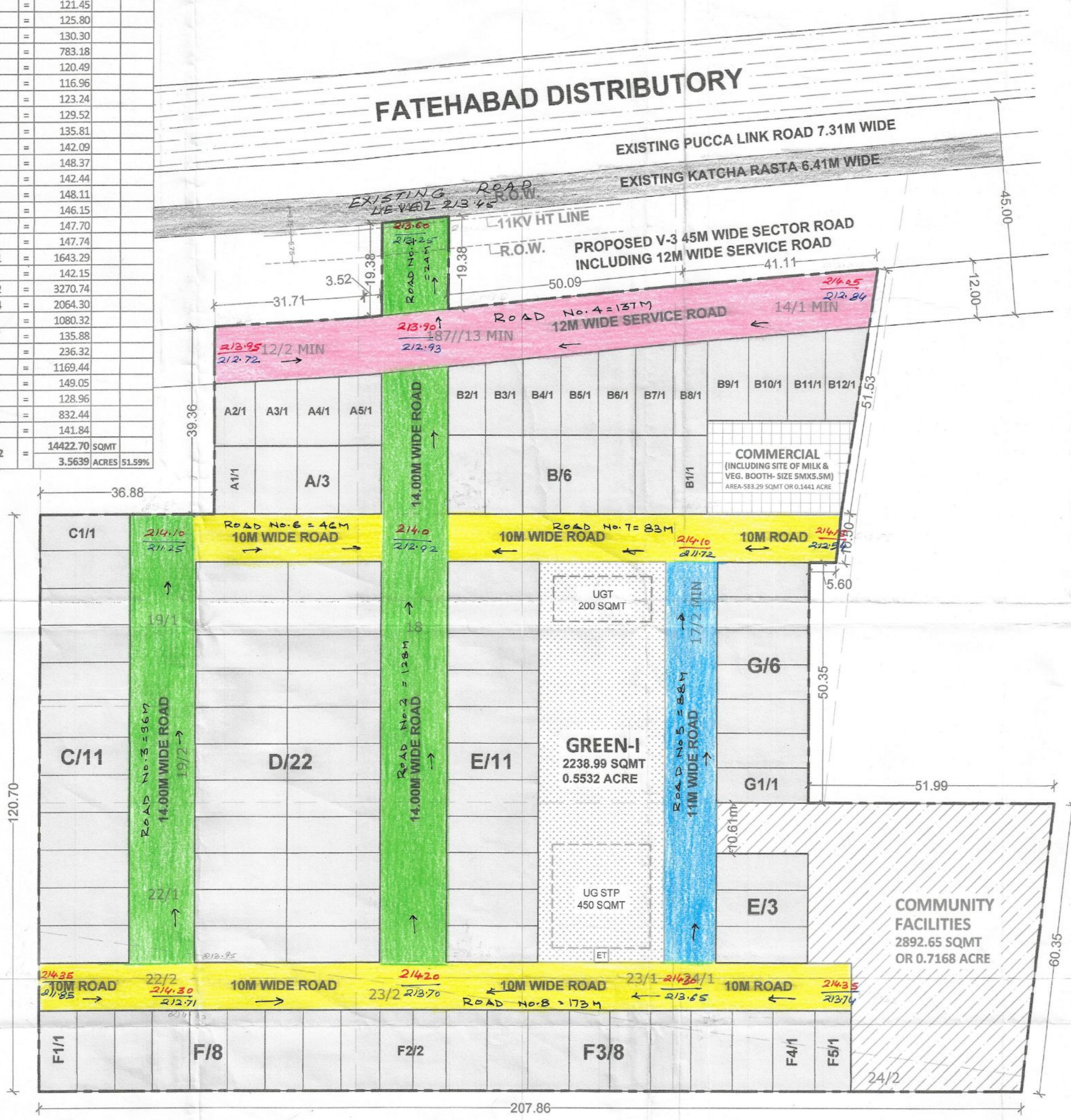

- To be read with Licence No. 221 of 2025 Dated 13-11-2025
- This layout plan for an area measuring 7.1479 acres (Drawing No. 11610 Dated 14-11-2025) comprised of license which is issued in respect of Affordable Residential Plotted Colony (Under Deen Dayal Jan Awas Yojna-2016) being developed by Kushal Kumar & Parveen Kumar falling in the revenue estate of village Basti Bhiwan, Sector-12, Tehsil and District Fatehabad is hereby approved subject to the following conditions:-
- That this Layout Plan shall be read in conjunction with the clauses appearing on the agreement executed under Rule 11 and the bilateral agreement.
 - That the plotted area of the colony shall not exceed 65% of the net planned area of the colony. The entire area reserved for commercial purposes shall be taken as plotted for calculation of the area under plots.
 - That the demarcation plans as per size of all the Residential Plots and Commercial site shall be got approved from this Department and construction on these sites shall be governed by the Haryana Building Code, 2017 and the Zoning Plan approved by the Director, Town & Country Planning, Haryana.
 - That for proper planning and integration of services in the area adjacent to the colony, the colonizer shall abide by the directions of the DTCP for the modification of layout plans of the colony.
 - That the revenue rasta falling in the colony shall be kept free for circulation/movement as shown in the layout plan.
 - That the colonizer shall abide by the directions of the DTCP, Haryana and accordingly shall make necessary changes in the layout plan for making any adjustment in the alignment of the peripheral roads, internal road circulation or for proper integration of the planning proposals of the adjoining areas.
 - That no property/plot shall derive access directly from the carriage way of 30 metres or wider sector road if applicable.
 - All green belts provided in the layout plan within the licensed areas of the colony shall be developed by the colonizer. All other green belts outside the licensed area shall be developed by the Haryana Urban Development Authority/colonizer on the directions of the Director, Town & Country planning, Haryana or in accordance with terms and conditions of the agreements of the license.
 - At the time of demarcation plan, if required percentage of organized open space is reduced, the same will be provided by the colonizer in the licensed area.
 - No plot will derive an access from less than 9 metres wide road would mean a minimum clear width of 9 metres between the plots.
 - Any excess area over and above the permissible 4% under commercial use shall be deemed to be open space.
 - The portion of the sector/development plan roads /green belts as provided in the Development Plan if applicable, which form part of the licensed area shall be transferred free of cost to the government on the lines of Section 3(3)(a)(iii) of U. Act No.8 of 1975.
 - That the odd size plots are being approved subject to the conditions that these plots should not have a frontage of less than 75% of the standard frontage when demarcated.
 - That you will have no objection to the regularization of the boundaries of the licence through give and take with the land that HSP is finally able to acquire in the interest of planned development and integration of services. The decision of the competent authority shall be binding in this regard.
 - That the rain water harvesting system shall be provided as per Central Ground Water Authority norms/Haryana Govt. notification as applicable.
 - That the colonizer/owner shall use only Light-Emitting Diode Lamps (LED) fitting for internal lighting as well as Campus lighting.
 - That the colonizer/owner shall ensure the installation of Solar Photovoltaic Power Plant as per the provisions of order No.22/52/2005-SPOwer dated 21.03.2016 issued by Haryana Government Renewable Energy Department.
 - That the colonizer/owner shall strictly comply with the directions issued vide Notification No. 19/16/2016-52 dated 31.03.2016 issued by Haryana Government Renewable Energy Department for enforcement of the Energy Conservation Building Codes.

(PRIYABONI) ATP(HQ)
 (SAVITA JAUHAR) TP(HQ)
 (VIJENDER SINGH) STP(HQ)
 (BHUVNESH KUMAR) CTP(HR)
 (AMIT KHATRI, IAS) DTCP(HR)
 (PARVEEN KUMAR) SD(HQ)

REFERENCE:

- PROPOSED 14 M WIDE ROAD SHOWN AS = [Green]
- PROPOSED 12 M WIDE ROAD SHOWN AS = [Pink]
- PROPOSED 11 M WIDE ROAD SHOWN AS = [Blue]
- PROPOSED 10 M WIDE ROAD SHOWN AS = [Yellow]
- PROPOSED FORMATION LEVEL OF ROADS SHOWN AS = 213.90
- EXISTING GROUND LEVEL OF ROADS SHOWN AS = 212.93

PROPOSED LAYOUT PLAN OF AFFORDABLE RESIDENTIAL PLOTTED COLONY UNDER DEEN DAYAL JAN AWAS YOJANA-2016 OVER AN AREA MEASURING 7.1479 ACRES IN THE REVENUE ESTATE OF VILL. BASTI BHIWAN, SECTOR-12, DISTT. FATEHABAD - SH. KUSHAL KUMAR, SH. PARVEEN KUMAR CHARAIPOTRA S/O SH. HARDAYAL

AREA CALCULATIONS					
S.NO.	PARTICULARS	PROPOSAL (ACRE)	PROPOSAL (%)	PERMISSIBLE (ACRE)	PERMISSIBLE (%)
1	TOTAL AREA OF THE SCHEME	7.1479	-	-	-
2	AREA UNDER V-3 SECTOR ROAD 45M WIDE INCLUDING 12M WIDE SERVICE ROAD	0.4808	-	-	-
3	BALANCE AREA	6.6671	-	-	-
4	50% BENEFIT OF AREA UNDER V-3 SECTOR ROAD 45M WIDE INCLUDING 12M WIDE SERVICE ROAD	0.2404	-	-	-
5	NET PLANNED AREA	6.9075	-	-	-
6	AREA UNDER RESIDENTIAL PLOTS	3.5639	51.59%	4.2135	61.00%
7	AREA UNDER COMMERCIAL	0.1441	2.09%	0.2763	4.00%
8	TOTAL SALEABLE AREA(6 + 7)	3.7080	53.68%	4.4898	65.00%
9	OPEN SPACE/PARKS	0.5532	7.74%	0.5380	7.50%
10	COMMUNITY FACILITIES	0.7147	10.00%	0.7147	10.00%

DIVINE ARCHITECTS & PLANNERS

ADDRESS : 800 76-77, 1st FLOOR, SECTOR-8C, MAHINDRA MARKET CHANDIGARH-160009.
 CONTACT : +91-98139-00375, +91-172-478522
 EMAIL : divinearchitects18@gmail.com

LEGEND:

ET PARKS / OPEN SPACES
 COMMERCIAL AREA
 COMMUNITY FACILITIES
 KILLA LINE
 SCHEME BOUNDARY
 UGT
 UG STP

ABBREVIATIONS-

ET = ELECTRIC TRANSFORMER
 UGT = UNDERGROUND WATER TANK
 UG STP = UNDERGROUND SEWAGE TREATMENT PLANT

DENSITY CALCULATION(PPA)-

NUMBER OF PLOTS = 102
 UNITS ALLOWED = 4
 POPULATION ALLOWED PER UNIT = 4.5
 DENSITY CALCULATION = 102 X 4 X 4.5
 = 1836.0 / 6.9075
 = 265.80, SAY 266 PPA

GREEN AREA CALCULATION:-

= GREEN-I
 = 2238.99 SQMT OR 0.5532 ACRE



(SCALE-N.T.S.)

(PERMISSIBLE DENSITY: 240 PPA - 400 PPA)

SIGNATURE OF OWNER / APPLICANT

SIGNATURE OF ARCHITECT / TOWN PLANNER

- To be read with Licence No. 221 of 2025 Dated 13-11-2025
- This layout plan for an area measuring 7.1479 acres (Drawing no. 1110 Dated 14-11-2025) comprised of license which is issued in respect of Affordable Residential Plotted Colony (Under Deen Dayal Jan Awas Yojana-2016) being developed by Kushal Kumar & Parveen Kumar falling in the revenue estate of village Basti Bhiwan, Sector-12, Tehsil and District Fatehabad is hereby approved subject to the following conditions:-
- That this Layout Plan shall be read in conjunction with the clauses appearing on the agreement executed under Rule 11 and the bilateral agreement.
 - That the plotted area of the colony shall not exceed 65% of the net planned area of the colony. The entire area reserved for commercial purposes shall be taken as plotted for calculation of the area under plots.
 - That the demarcation plans as per site of all the Residential Plots and Commercial site shall be got approved from this Department and construction on these sites shall be governed by the Haryana Building Code, 2017 and the Zoning Plan approved by the Director, Town & Country Planning, Haryana.
 - That for proper planning and integration of services in the area adjacent to the colony, the colonizer shall abide by the directions of the DTCP for the modification of layout plans of the colony.
 - That the revenue rasta falling in the colony shall be kept free for circulation/movement as shown in the layout plan.
 - That the colonizer shall abide by the directions of the DTCP, Haryana and accordingly shall make necessary changes in the layout plan for making any adjustment in the alignment of the peripheral roads, internal road circulation or for proper integration of the planning proposals of the adjoining areas.
 - That no property/plot shall derive access directly from the carriage way of 30 metres or wider sector road if applicable.
 - All green belts provided in the layout plan within the licensed areas of the colony shall be developed by the colonizer. All other green belts outside the licensed area shall be developed by the Haryana Urban Development Authority/colonizer on the directions of the Director, Town and Country planning, Haryana or in accordance with terms and conditions of the agreements of the licence.
 - At the time of demarcation plan, if required percentage of organized open space is reduced, the same will be provided by the colonizer in the licensed area.
 - No plot will derive an access from less than 9 metres wide road would mean a minimum clear width of 9 metres between the plots.
 - Any excess area over and above the permissible 4% under commercial use shall be deemed to be open space.
 - The portion of the sector/development plan roads /green belts as provided in the Development Plan if applicable, which form part of the licensed area shall be transferred free of cost to the government on the lines of Section 3(3)(a)(ii) of the Act No. 8 of 1975.
 - That the odd size plots are being approved subject to the conditions that these plots should not have a frontage of less than 75% of the standard frontage when demarcated.
 - That you will have no objection to the regularization of the boundaries of the licence through give and take with the land that HVP is finally able to acquire in the interest of planned development and integration of services. The decision of the competent authority shall be binding in this regard.
 - That the rain water harvesting system shall be provided as per Central Ground Water Authority norms/Haryana Govt. notification as applicable.
 - That the colonizer/owner shall use only Light-Emitting Diode lamps (LED) fitting for internal lighting as well as Campus lighting.
 - That the colonizer/owner shall ensure the installation of Solar Photovoltaic Power Plant as per the provisions of order No.22/52/2005-SPower dated 21.03.2016 issued by Haryana Government Renewable Energy Department.
 - That the colonizer/owner shall strictly comply with the directions issued vide Notification No. 19/6/2016-SP dated 31.03.2016 issued by Haryana Government Renewable Energy Department for enforcement of the Energy Conservation Building Codes.

DETAIL OF RESIDENTIAL PLOTS					
S.NO.	CATEGORY	SIZE(IN METERS)	AREA(IN SQMT)	NO. OF PLOTS	TOTAL(IN SQMT)
1	A	8.84 X 14.33	126.68	3	380.04
2	A1	8.65 X 14.33	123.95	1	123.95
3	A2	AS PER PLAN	114.63	1	114.63
4	A3	AS PER PLAN	121.45	1	121.45
5	A4	AS PER PLAN	125.80	1	125.80
6	A5	AS PER PLAN	130.30	1	130.30
7	B	7.93 X 16.46	130.53	6	783.18
8	B1	7.32 X 16.46	120.49	1	120.49
9	B2	AS PER PLAN	116.96	1	116.96
10	B3	AS PER PLAN	123.24	1	123.24
11	B4	AS PER PLAN	129.52	1	129.52
12	B5	AS PER PLAN	135.81	1	135.81
13	B6	AS PER PLAN	142.09	1	142.09
14	B7	AS PER PLAN	148.37	1	148.37
15	B8	AS PER PLAN	142.44	1	142.44
16	B9	AS PER PLAN	148.11	1	148.11
17	B10	AS PER PLAN	146.15	1	146.15
18	B11	AS PER PLAN	147.70	1	147.70
19	B12	AS PER PLAN	147.74	1	147.74
20	C	7.85 X 19.03	149.39	11	1643.29
21	C1	7.47 X 19.03	142.15	1	142.15
22	D	7.62 X 19.51	148.67	22	3270.74
23	E	7.62 X 19.35	147.45	14	2064.30
24	F	8.00 X 16.88	135.04	8	1080.32
25	F1	8.05 X 16.88	135.88	1	135.88
26	F2	7.00 X 16.88	118.16	2	236.32
27	F3	8.66 X 16.88	146.18	8	1169.44
28	F4	8.83 X 16.88	149.05	1	149.05
29	F5	7.64 X 16.88	128.96	1	128.96
30	G	7.17 X 19.35	138.74	6	832.44
31	G1	7.33 X 19.35	141.84	1	141.84
32	TOTAL		14422.70 SQMT	102	3.5639 ACRES 51.59%

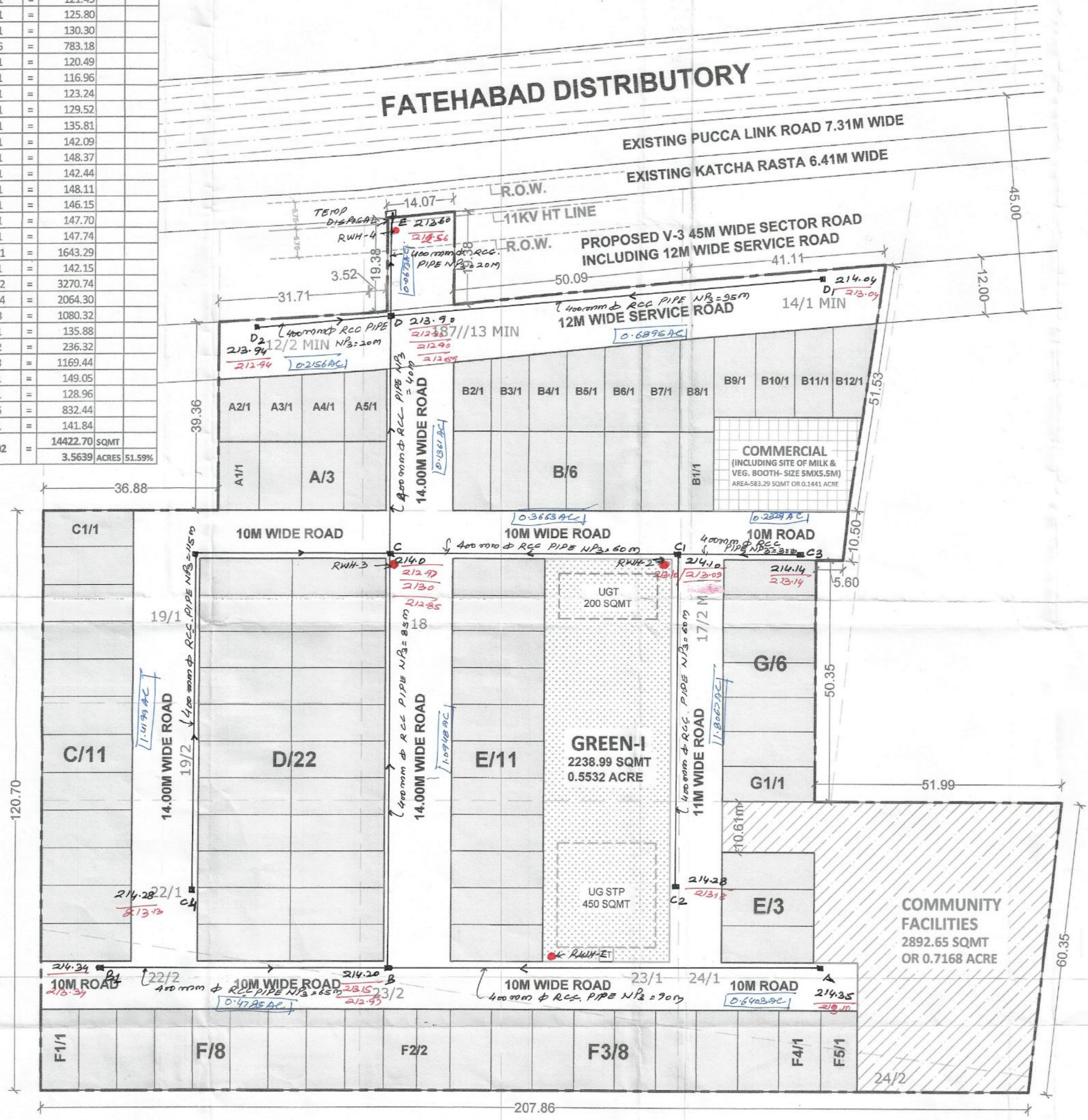

(PRAYAGSONI) ATP(HQ) (SAVITA) J(A)DAU (TP)(HQ) (VIJENDRA) SINGH (S)(HQ) (BHUVNESH KUMAR) CTP(HR) (AMIT KUMAR, IAS) DTP(HR) (PARVEEN KUMAR) SDP(HQ)

- REFERENCE:**
- PROPOSED STORM WATER DRAINAGE SHOWN AS =
 - PROPOSED RAIN WATER HARVESTING PITS SHOWN AS = ● RWH
 - PROPOSED FORMATION LEVELS OF ROADS SHOWN AS = 2/3/90
 - PROPOSED BED LEVEL OF STORM WATER DRAINAGE SHOWN AS = 2/2/90

PROPOSED LAYOUT PLAN OF AFFORDABLE RESIDENTIAL PLOTTED COLONY UNDER DEEN DAYAL JAN AWAS YOJANA-2016 OVER AN AREA MEASURING 7.1479 ACRES IN THE REVENUE ESTATE OF VILL. BASTI BHIWAN, SECTOR-12, DISTT. FATEHABAD - SH. KUSHAL KUMAR, SH. PARVEEN KUMAR CHARAIPOTRA S/O SH. HARDAYAL

AREA CALCULATIONS					
S.NO.	PARTICULARS	PROPOSAL (ACRE)	PROPOSAL (%)	PERMISSIBLE (ACRE)	PERMISSIBLE (%)
1	TOTAL AREA OF THE SCHEME	7.1479	-	-	-
2	AREA UNDER V-3 SECTOR ROAD 45M WIDE INCLUDING 12M WIDE SERVICE ROAD	0.4808	-	-	-
3	BALANCE AREA	6.6671	-	-	-
4	50% BENEFIT OF AREA UNDER V-3 SECTOR ROAD 45M WIDE INCLUDING 12M WIDE SERVICE ROAD	0.2404	-	-	-
5	NET PLANNED AREA	6.9075	-	-	-
6	AREA UNDER RESIDENTIAL PLOTS	3.5639	51.59%	4.2135	61.00%
7	AREA UNDER COMMERCIAL	0.1441	2.09%	0.2763	4.00%
8	TOTAL SALEABLE AREA(6 + 7)	3.7080	53.68%	4.4898	65.00%
9	OPEN SPACE/PARKS	0.5532	7.74%	0.5360	7.50%
10	COMMUNITY FACILITIES	0.7147	10.00%	0.7147	10.00%

DIVINE ARCHITECTS & PLANNERS

ADDRESS : SCO 76-77 1st FLOOR, SECTOR-04, MADHYA MARG, CHANDIGARH-160002
 CONTACT : +91-98139-00375, +91-172-4789520
 EMAIL : divinearchitects18@gmail.com

LEGEND:

ET PARKS / OPEN SPACES
 COMMERCIAL AREA
 COMMUNITY FACILITIES
 KILLA LINE
 SCHEME BOUNDARY
 UGT
 UG STP

ABBREVIATIONS-

ET = ELECTRIC TRANSFORMER
 UGT = UNDERGROUND WATER TANK
 UG STP = UNDERGROUND SEWAGE TREATMENT PLANT

DENSITY CALCULATION(PPA)-

NUMBER OF PLOTS = 102
 UNITS ALLOWED = 4
 POPULATION ALLOWED PER UNIT = 4.5
 DENSITY CALCULATION = 102 X 4 X 4.5
 = 1836.0 / 6.9075
 = 265.80, SAY 266 PPA

GREEN AREA CALCULATION:-

= GREEN-I
 = 2238.99 SQMT OR 0.5532 ACRE



(SCALE-N.T.S.)

(PERMISSIBLE DENSITY: 240 PPA - 400 PPA)

SIGNATURE OF OWNER / APPLICANT

SIGNATURE OF ARCHITECT / TOWN PLANNER



To be read with Licence No. 221 of 2025 Dated 13-11-2025

This layout plan for an area measuring 7.1479 acres (Drawing no. 11610 Dated 14-11-2025) comprised of license which is issued in respect of Affordable Residential Plotted Colony (Under Deen Dayal Jan Awas Yojana-2016) being developed by Kushal Kumar & Parveen Kumar falling in the revenue estate of village Basti Bhiwan, Sector-12, Tehsil and District Fatehabad is hereby approved subject to the following conditions:-

- That this Layout Plan shall be read in conjunction with the clauses appearing on the agreement executed under Rule 11 and the bilateral agreement.
- That the plotted area of the colony shall not exceed 65% of the net planned area of the colony. The entire area reserved for commercial purposes shall be taken as plotted for calculation of the area under plots.
- That the demarcation plans as per site of all the Residential Plots and Commercial site shall be got approved from this Department and construction on these sites shall be governed by the Haryana Building Code, 2017 and the Zoning Plan approved by the Director, Town & Country Planning, Haryana.
- That for proper planning and integration of services in the area adjacent to the colony, the colonizer shall abide by the directions of the DTCP for the modification of layout plans of the colony.
- That the revenue rasta falling in the colony shall be kept free for circulation/movement as shown in the layout plan.
- That the colonizer shall abide by the directions of the DTCP, Haryana and accordingly shall make necessary changes in the layout plan for making any adjustment in the alignment of the peripheral roads, internal road circulation or for proper integration of the planning proposals of the adjoining areas.
- That no property/plot shall derive access directly from the carriage way of 30 metres or wider sector road if applicable.
- All green belts provided in the layout plan within the licensed areas of the colony shall be developed by the colonizer. All other green belts outside the licensed area shall be developed by the Haryana Urban Development Authority/colonizer on the directions of the Director, Town and Country planning, Haryana or in accordance with terms and conditions of the agreements of the license.
- At the time of demarcation plan, if required percentage of organized open space is reduced, the same will be provided by the colonizer in the licensed area.
- No plot will derive an access from less than 9 metres wide road which means a minimum clear width of 9 metres between the plots.
- Any excess area over and above the permissible 4% under commercial use shall be deemed to be open space.
- The portion of the sector/development plan roads /green belts as provided in the Development Plan if applicable, which form part of the licensed area shall be transferred free of cost to the government on the lines of Section 3(3)(i)(iii) of U. Act No.8 of 1975.
- That the odd size plots are being approved subject to the conditions that these plots should not have a frontage of less than 75% of the standard frontage when demarcated.
- That you will have no objection to the regularization of the boundaries of the licence through give and take with the land that HSP is finally able to acquire in the interest of planned development and integration of services. The decision of the competent authority shall be binding in this regard.
- That the rain water harvesting system shall be provided as per Central Ground Water Authority norms/Haryana Govt. notification as applicable.
- That the colonizer/owner shall use only Light-Emitting Diode lamps (LED) fitting for internal lighting as well as Campus lighting.
- That the colonizer/owner shall ensure the installation of Solar Photovoltaic Power Plant as per the provisions of order No.22/52/2005-SPOwer dated 21.03.2016 issued by Haryana Government Renewable Energy Department.
- That the colonizer/owner shall strictly comply with the directions issued vide Notification No. 19/16/2016-5P dated 31.03.2016 issued by Haryana Government Renewable Energy Department for enforcement of the Energy Conservation Building Codes.

DETAIL OF RESIDENTIAL PLOTS					
S.NO.	CATEGORY	SIZE(IN METERS)	AREA(IN SQMT)	NO. OF PLOTS	TOTAL(IN SQMT)
1	A	8.84 X 14.33	= 126.68	3	= 380.04
2	A1	8.65 X 14.33	= 123.95	1	= 123.95
3	A2	AS PER PLAN	= 114.63	1	= 114.63
4	A3	AS PER PLAN	= 121.45	1	= 121.45
5	A4	AS PER PLAN	= 125.80	1	= 125.80
6	A5	AS PER PLAN	= 130.30	1	= 130.30
7	B	7.93 X 16.46	= 130.53	6	= 783.18
8	B1	7.32 X 16.46	= 120.49	1	= 120.49
9	B2	AS PER PLAN	= 116.96	1	= 116.96
10	B3	AS PER PLAN	= 123.24	1	= 123.24
11	B4	AS PER PLAN	= 129.52	1	= 129.52
12	B5	AS PER PLAN	= 135.81	1	= 135.81
13	B6	AS PER PLAN	= 142.09	1	= 142.09
14	B7	AS PER PLAN	= 148.37	1	= 148.37
15	B8	AS PER PLAN	= 142.44	1	= 142.44
16	B9	AS PER PLAN	= 148.11	1	= 148.11
17	B10	AS PER PLAN	= 146.15	1	= 146.15
18	B11	AS PER PLAN	= 147.70	1	= 147.70
19	B12	AS PER PLAN	= 147.74	1	= 147.74
20	C	7.85 X 19.03	= 149.39	11	= 1643.29
21	C1	7.47 X 19.03	= 142.15	1	= 142.15
22	D	7.62 X 19.51	= 148.67	22	= 3270.74
23	E	7.62 X 19.35	= 147.45	14	= 2064.30
24	F	8.00 X 16.88	= 135.04	8	= 1080.32
25	F1	8.05 X 16.88	= 135.88	1	= 135.88
26	F2	7.00 X 16.88	= 118.16	2	= 236.32
27	F3	8.66 X 16.88	= 146.18	8	= 1169.44
28	F4	8.83 X 16.88	= 149.05	1	= 149.05
29	F5	7.64 X 16.88	= 128.96	1	= 128.96
30	G	7.17 X 19.35	= 138.74	6	= 832.44
31	G1	7.33 X 19.35	= 141.84	1	= 141.84
32	TOTAL			102	14422.70 SQMT 3.5639 ACRES 51.59%

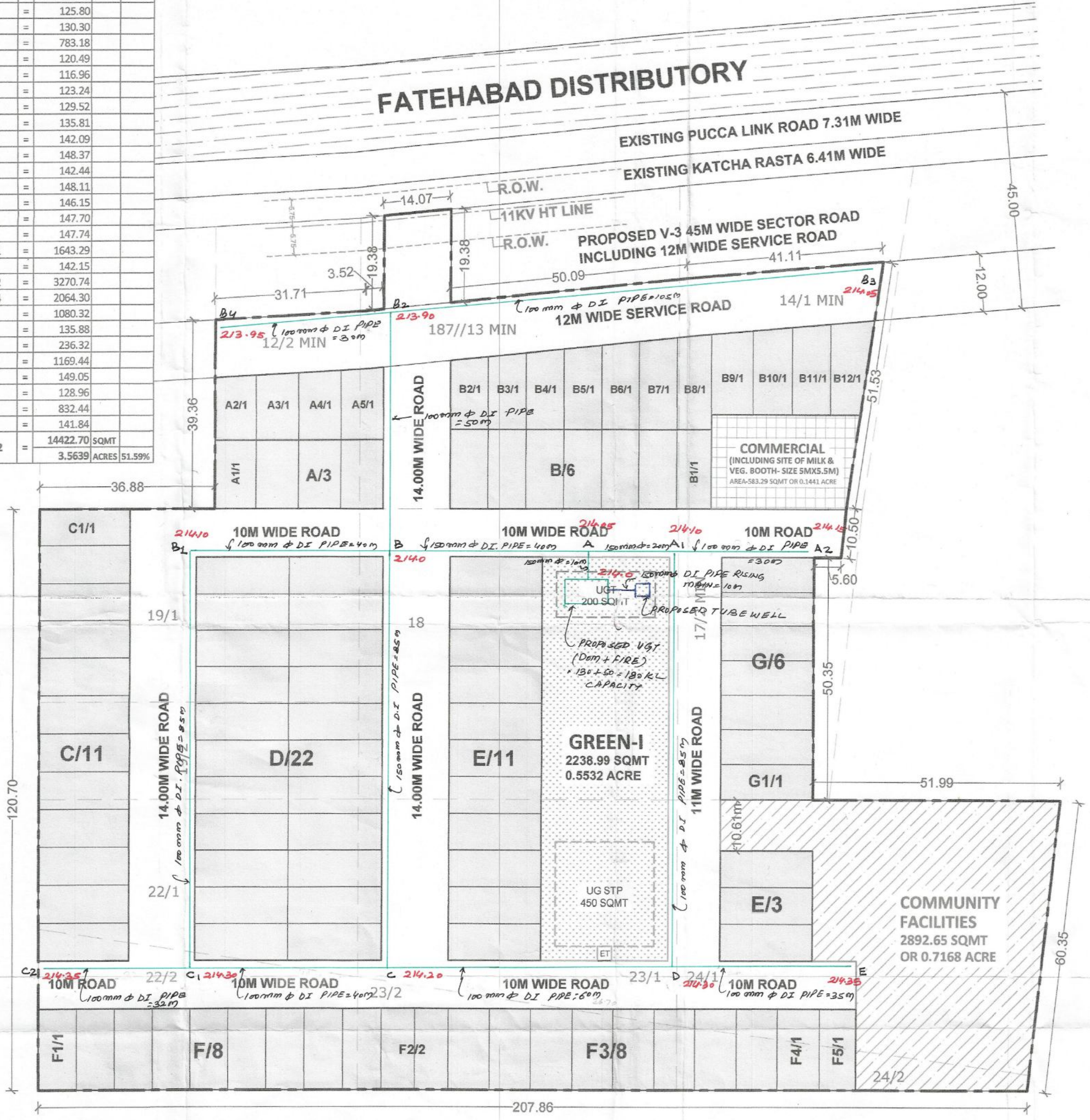

(PRIYANSONI) ATP(HQ) (SAVITA) ATP(HQ) (VIJENDER SINGH) STP(HQ) (BHUVNESH KUMAR) CTP(HR) (AMIT KHATRI, IAS) DTCP(HR)

(PARVEEN KUMAR) SD(HQ)

REFERENCE:

- PROPOSED FRESH WATER SUPPLY DISTRIBUTION LINE SHOWN AS =
- PROPOSED UNDER GROUND TANK (DOMESTIC + FIRE) SHOWN AS =
- PROPOSED TUBEWELL FOR FRESH WATER SUPPLY SHOWN AS =
- PROPOSED RISING MAIN FROM TUBEWELL SHOWN AS =
- PROPOSED FORMATION LEVEL'S OF ROADS SHOWN AS =

PROPOSED LAYOUT PLAN OF AFFORDABLE RESIDENTIAL PLOTTED COLONY UNDER DEEN DAYAL JAN AWAS YOJANA-2016 OVER AN AREA MEASURING 7.1479 ACRES IN THE REVENUE ESTATE OF VILL. BASTI BHIWAN, SECTOR-12, DISTT. FATEHABAD - SH. KUSHAL KUMAR, SH. PARVEEN KUMAR CHARAIPOTRA S/O SH. HARDAYAL

AREA CALCULATIONS					
S.NO.	PARTICULARS	PROPOSAL (ACRE)	PROPOSAL (%)	PERMISSIBLE (ACRE)	PERMISSIBLE (%)
1	TOTAL AREA OF THE SCHEME	7.1479	-	-	-
2	AREA UNDER V-3 SECTOR ROAD 45M WIDE INCLUDING 12M WIDE SERVICE ROAD	0.4808	-	-	-
3	BALANCE AREA	6.6671	-	-	-
4	50% BENEFIT OF AREA UNDER V-3 SECTOR ROAD 45M WIDE INCLUDING 12M WIDE SERVICE ROAD	0.2404	-	-	-
5	NET PLANNED AREA	6.9075	-	-	-
6	AREA UNDER RESIDENTIAL PLOTS	3.5639	51.59%	4.2135	61.00%
7	AREA UNDER COMMERCIAL	0.1441	2.09%	0.2763	4.00%
8	TOTAL SALEABLE AREA(6 + 7)	3.7080	53.68%	4.4898	65.00%
9	OPEN SPACE/PARKS	0.5532	7.74%	0.5360	7.50%
10	COMMUNITY FACILITIES	0.7147	10.00%	0.7147	10.00%

DIVINE ARCHITECTS & PLANNERS

ADDRESS : 302 76-77 1st FLOOR, SECTOR-06, MADHYA MARG, CHANDIGARH-160009.
CONTACT : +91-98139-00375, +91-172-478920
EMAIL : divinearchitects18@gmail.com

LEGEND:

ET PARKS / OPEN SPACES
COMMERCIAL AREA
COMMUNITY FACILITIES
KILLA LINE
SCHEME BOUNDARY
UGT
UG STP

ABBREVIATIONS-

ET = ELECTRIC TRANSFORMER
UGT = UNDERGROUND WATER TANK
UG STP = UNDERGROUND SEWAGE TREATMENT PLANT

DENSITY CALCULATION(PPA)-

NUMBER OF PLOTS = 102
UNITS ALLOWED = 4
POPULATION ALLOWED PER UNIT = 4.5
DENSITY CALCULATION = 102 X 4 X 4.5
= 1836.0 / 6.9075
= 265.80, SAY 266 PPA

GREEN AREA CALCULATION:-

= GREEN-I
= 2238.99 SQMT OR 0.5532 ACRE

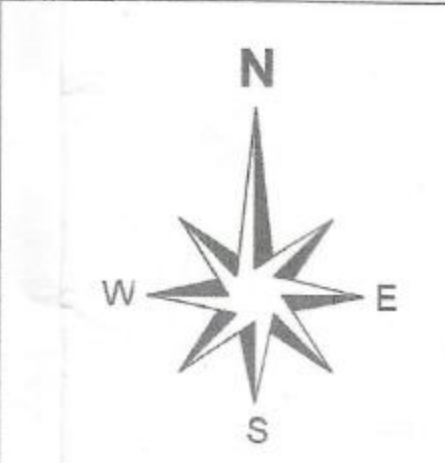

(SCALE-N.T.S.)

(PERMISSIBLE DENSITY: 240 PPA - 400 PPA)

SIGNATURE OF OWNER / APPLICANT

SIGNATURE OF ARCHITECT / TOWN PLANNER



DETAIL OF RESIDENTIAL PLOTS					
S.NO.	CATEGORY	SIZE(IN METERS)	AREA(IN SQMT)	NO. OF PLOTS	TOTAL(IN SQMT)
1	A	8.84 X 14.33	= 126.68	3	= 380.04
2	A1	8.65 X 14.33	= 123.95	1	= 123.95
3	A2	AS PER PLAN	= 114.63	1	= 114.63
4	A3	AS PER PLAN	= 121.45	1	= 121.45
5	A4	AS PER PLAN	= 125.80	1	= 125.80
6	A5	AS PER PLAN	= 130.30	1	= 130.30
7	B	7.93 X 16.46	= 130.53	6	= 783.18
8	B1	7.32 X 16.46	= 120.49	1	= 120.49
9	B2	AS PER PLAN	= 116.96	1	= 116.96
10	B3	AS PER PLAN	= 123.24	1	= 123.24
11	B4	AS PER PLAN	= 129.52	1	= 129.52
12	B5	AS PER PLAN	= 135.81	1	= 135.81
13	B6	AS PER PLAN	= 142.09	1	= 142.09
14	B7	AS PER PLAN	= 148.37	1	= 148.37
15	B8	AS PER PLAN	= 142.44	1	= 142.44
16	B9	AS PER PLAN	= 148.11	1	= 148.11
17	B10	AS PER PLAN	= 146.15	1	= 146.15
18	B11	AS PER PLAN	= 147.70	1	= 147.70
19	B12	AS PER PLAN	= 147.74	1	= 147.74
20	C	7.85 X 19.03	= 149.39	11	= 1643.29
21	C1	7.47 X 19.03	= 142.15	1	= 142.15
22	D	7.62 X 19.51	= 148.67	22	= 3270.74
23	E	7.62 X 19.35	= 147.45	14	= 2064.30
24	F	8.00 X 16.88	= 135.04	8	= 1080.32
25	F1	8.05 X 16.88	= 135.88	1	= 135.88
26	F2	7.00 X 16.88	= 118.16	2	= 236.32
27	F3	8.66 X 16.88	= 146.18	8	= 1169.44
28	F4	8.83 X 16.88	= 149.05	1	= 149.05
29	F5	7.64 X 16.88	= 128.96	1	= 128.96
30	G	7.17 X 19.35	= 138.74	6	= 832.44
31	G1	7.33 X 19.35	= 141.84	1	= 141.84
32	TOTAL		14422.70 SQMT	102	
			3.5639 ACRES	51.59%	

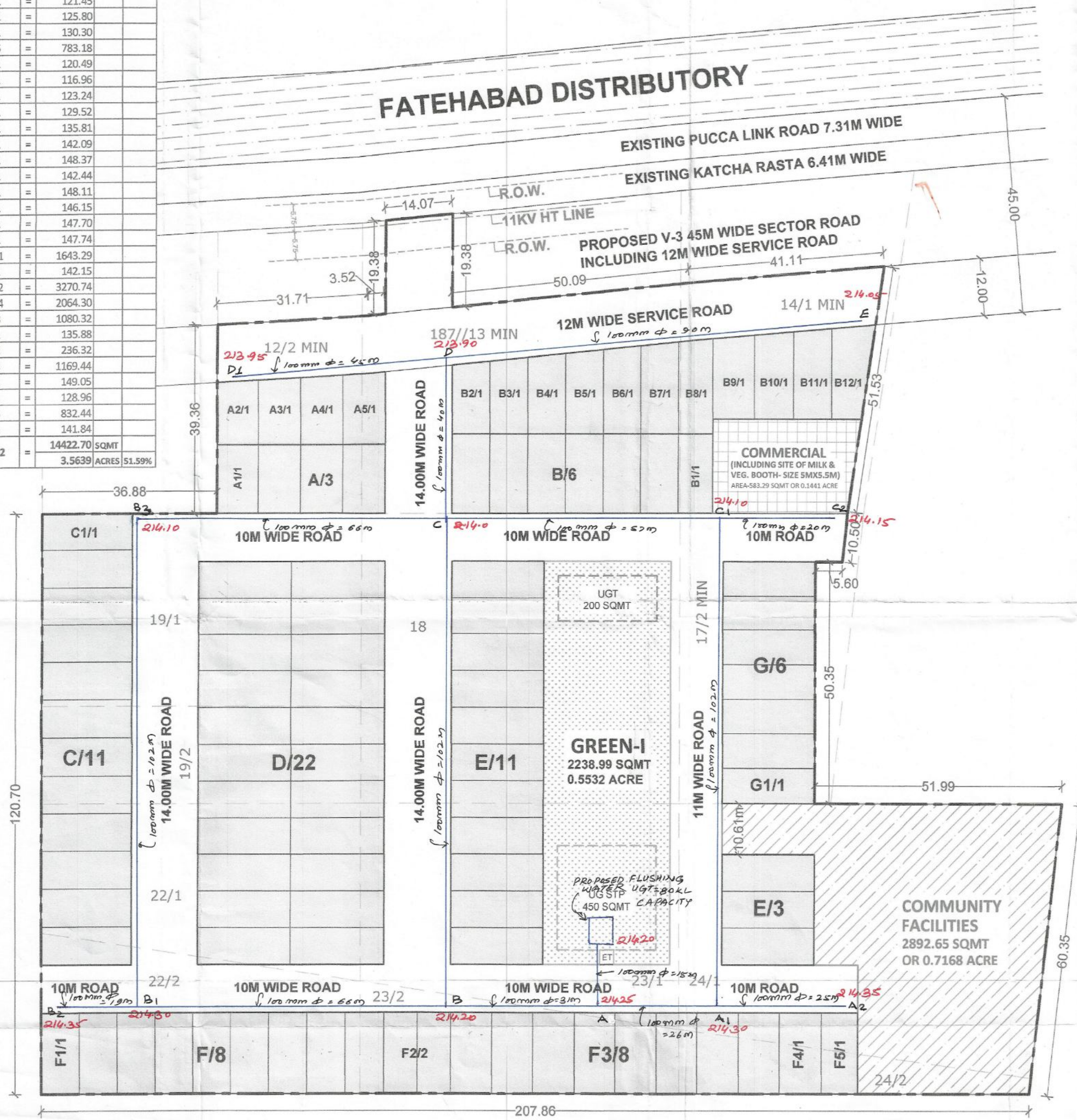

- To be read with Licence No. 221 of 2025 Dated 13-11-2025
- This layout plan for an area measuring 7.1479 acres (Drawing no. 11C10 Dated 14-11-2015) comprised of license which is issued in respect of Affordable Residential Plotted Colony (Under Deen Dayal Jan Awas Yojna-2016) being developed by Kushal Kumar & Parveen Kumar falling in the revenue estate of village Basti Bhiwan, Sector-12, Tehsil and District Fatehabad is hereby approved subject to the following conditions:-
- That this Layout Plan shall be read in conjunction with the clauses appearing on the agreement executed under Rule 11 and the bilateral agreement.
 - That the plotted area of the colony shall not exceed 65% of the net planned area of the colony. The entire area reserved for commercial purposes shall be taken as plotted for calculation of the area under plots.
 - That the demarcation plans as per site of all the Residential Plots and Commercial site shall be got approved from this Department and construction on these sites shall be governed by the Haryana Building Code, 2017 and the Zoning Plan approved by the Director, Town & Country Planning, Haryana.
 - That for proper planning and integration of services in the area adjacent to the colony, the colonizer shall abide by the directions of the DTCP for the modification of layout plans of the colony.
 - That the revenue rasta falling in the colony shall be kept free for circulation/movement as shown in the layout plan.
 - That the colonizer shall abide by the directions of the DTCP, Haryana and accordingly shall make necessary changes in the layout plan for making any adjustment in the alignment of the peripheral roads, internal road circulation or for proper integration of the planning proposals of the adjoining areas.
 - That no property/plot shall derive access directly from the carriage way of 30 metres or wider sector road if applicable.
 - All green belts provided in the layout plan within the licensed areas of the colony shall be developed by the colonizer. All other green belts outside the licensed area shall be developed by the Haryana Urban Development Authority/colonizer on the directions of the Director, Town and Country planning, Haryana or in accordance with terms and conditions of the agreements of the licence.
 - At the time of demarcation plan, if required percentage of organized open space is reduced, the same will be provided by the colonizer in the licensed area.
 - No plot will derive an access from less than 9 metres wide road would mean a minimum clear width of 9 metres between the plots.
 - Any excess area over and above the permissible 4% under commercial use shall be deemed to be open space.
 - The portion of the sector/development plan roads /green belts as provided in the Development Plan if applicable, which form part of the licensed area shall be transferred free of cost to the government on the lines of Section 3(3)(a)(ii) of the Act No.5 of 1975.
 - That the odd size plots are being approved subject to the conditions that these plots should not have a frontage of less than 75% of the standard frontage when demarcated.
 - That you will have no objection to the regularization of the boundaries of the licence through give and take with the land that HWP is finally able to acquire in the interest of planned development and integration of services. The decision of the competent authority shall be binding in this regard.
 - That the rain water harvesting system shall be provided as per Central Ground Water Authority norms/Haryana Govt. notification as applicable.
 - That the colonizer/owner shall use only Light-Emitting Diode Lamps (LED) fitting for internal lighting as well as Campus lighting.
 - That the colonizer/owner shall ensure the installation of Solar Photovoltaic Power Plant as per the provisions of order No.22/52/2005-SPower dated 21.03.2016 issued by Haryana Government Renewable Energy Department.
 - That the colonizer/owner shall strictly comply with the directions issued vide Notification No. 19/6/2016-SP dated 31.03.2016 issued by Haryana Government Renewable Energy Department for enforcement of the Energy Conservation Building Codes.

(PRIYANSONI) (P) (HQ)
 (SAVITA) (P) (HQ)
 (VIJENDRA) (P) (HQ)
 (SHIVNESH KUMAR) (P) (HQ)
 (AMIT KUMAR, IAS) (D) (HQ)
 (PARVEEN KUMAR) (S) (HQ)

REFERENCE:

1. PROPOSED FLUSHING WATER SUPPLY & IRRIGATION WATER SUPPLY DISTRIBUTION LINE SHOWN AS	=	
2. PROPOSED FLUSHING WATER UNDERGROUND TANK SHOWN AS	=	UGT
3. PROPOSED FORMATION LEVEL'S OF ROADS SHOWN AS	=	2/3.90

PROPOSED LAYOUT PLAN OF AFFORDABLE RESIDENTIAL PLOTTED COLONY UNDER DEEN DAYAL JAN AWAS YOJANA-2016 OVER AN AREA MEASURING 7.1479 ACRES IN THE REVENUE ESTATE OF VILL. BASTI BHIWAN, SECTOR-12, DISTT. FATEHABAD - SH. KUSHAL KUMAR, SH. PARVEEN KUMAR CHARAIPOTRA S/O SH. HARDAYAL

AREA CALCULATIONS					
S.NO.	PARTICULARS	PROPOSAL (ACRE)	PROPOSAL (%)	PERMISSIBLE (ACRE)	PERMISSIBLE (%)
1	TOTAL AREA OF THE SCHEME	7.1479	-	-	-
2	AREA UNDER V-3 SECTOR ROAD 45M WIDE INCLUDING 12M WIDE SERVICE ROAD	0.4808	-	-	-
3	BALANCE AREA	6.6671	-	-	-
4	50% BENEFIT OF AREA UNDER V-3 SECTOR ROAD 45M WIDE INCLUDING 12M WIDE SERVICE ROAD	0.2404	-	-	-
5	NET PLANNED AREA	6.9075	-	-	-
6	AREA UNDER RESIDENTIAL PLOTS	3.5639	51.59%	4.2135	61.00%
7	AREA UNDER COMMERCIAL	0.1441	2.09%	0.2763	4.00%
8	TOTAL SALEABLE AREA(6 + 7)	3.7080	53.68%	4.4898	65.00%
9	OPEN SPACE/PARKS	0.5632	7.74%	0.5360	7.50%
10	COMMUNITY FACILITIES	0.7147	10.00%	0.7147	10.00%

DIVINE
ARCHITECTS & PLANNERS

ADDRESS : SCO 76-77, 1st FLOOR, SECTOR-9C, MADHYA MARG, CHANDIGARH-160009
 CONTACT : +91-98158-00376, +91-172-766000
 EMAIL : divinearchitects16@gmail.com

LEGEND:

ET = PARKS / OPEN SPACES
 COMMERCIAL AREA
 COMMUNITY FACILITIES
 KILLA LINE
 SCHEME BOUNDARY
 UGT
 UG STP

ABBREVIATIONS-

ET = ELECTRIC TRANSFORMER
 UGT = UNDERGROUND WATER TANK
 UG STP = UNDERGROUND SEWAGE TREATMENT PLANT

DENSITY CALCULATION(PPA)-

NUMBER OF PLOTS = 102
 UNITS ALLOWED = 4
 POPULATION ALLOWED PER UNIT = 4.5
 DENSITY CALCULATION = 102 X 4 X 4.5
 = 1836.0 / 6.9075
 = 265.80, SAY 266 PPA

GREEN AREA CALCULATION:-

= GREEN-I
 = 2238.99 SQMT OR 0.5532 ACRE



(SCALE-N.T.S.)

(PERMISSIBLE DENSITY: 240 PPA - 400 PPA)

SIGNATURE OF OWNER / APPLICANT

SIGNATURE OF ARCHITECT / TOWN PLANNER