

Phase No.	Land Area	Shows	BUILDING IN EACH PHASE
Start	Area		
Phase-1	2,033,559	0.971	TOWER-A
Phase-2	2,183,951	0.536	TOWER-B
Phase-3	6,016,467	1.487	TOWER-C
Phase-4	4,520,811	1.102	TOURER-D
Phase-5	4,520,823	1.075	TOWER-E
Phase-6	3,347,827	0.827	TOWER-F
Phase-7	4,749,153	1.174	TOWER-G
Phase-8	4,212,760	1.041	PRNG & DMG
Phase-9	26,485,887	7.008	COMMERCIAL & LG
Total	98,968,216	14.81875	

GROUND PARKING	NO. OF PARKING SPACES
HANDICAPPED PARKING	12
EV PARKING	18
TOTAL PARKING	30

AREA CALCULATION OF SURFACE PARKING	
GRASS - A	311,500
DRIVEWAY	21,000
WALKWAY	21,000
TOTAL	353,500 SQM
TOTAL SURFACE CAR PARKING AREA	353,500 SQM
NO OF CAR AVAILABLE	75
TOTAL PROPOSED NO OF CAR BAYS	18

AREA CALCULATION OF SURFACE PARKING	
GRASS - A	311,500
DRIVEWAY	21,000
WALKWAY	21,000
TOTAL	353,500 SQM
TOTAL SURFACE CAR PARKING AREA	353,500 SQM
NO OF CAR AVAILABLE	75
TOTAL PROPOSED NO OF CAR BAYS	18

AREA CALCULATION OF SURFACE PARKING	
GRASS - A	311,500
DRIVEWAY	21,000
WALKWAY	21,000
TOTAL	353,500 SQM
TOTAL SURFACE CAR PARKING AREA	353,500 SQM
NO OF CAR AVAILABLE	75
TOTAL PROPOSED NO OF CAR BAYS	18

AREA CALCULATION OF SURFACE PARKING	
GRASS - A	311,500
DRIVEWAY	21,000
WALKWAY	21,000
TOTAL	353,500 SQM
TOTAL SURFACE CAR PARKING AREA	353,500 SQM
NO OF CAR AVAILABLE	75
TOTAL PROPOSED NO OF CAR BAYS	18

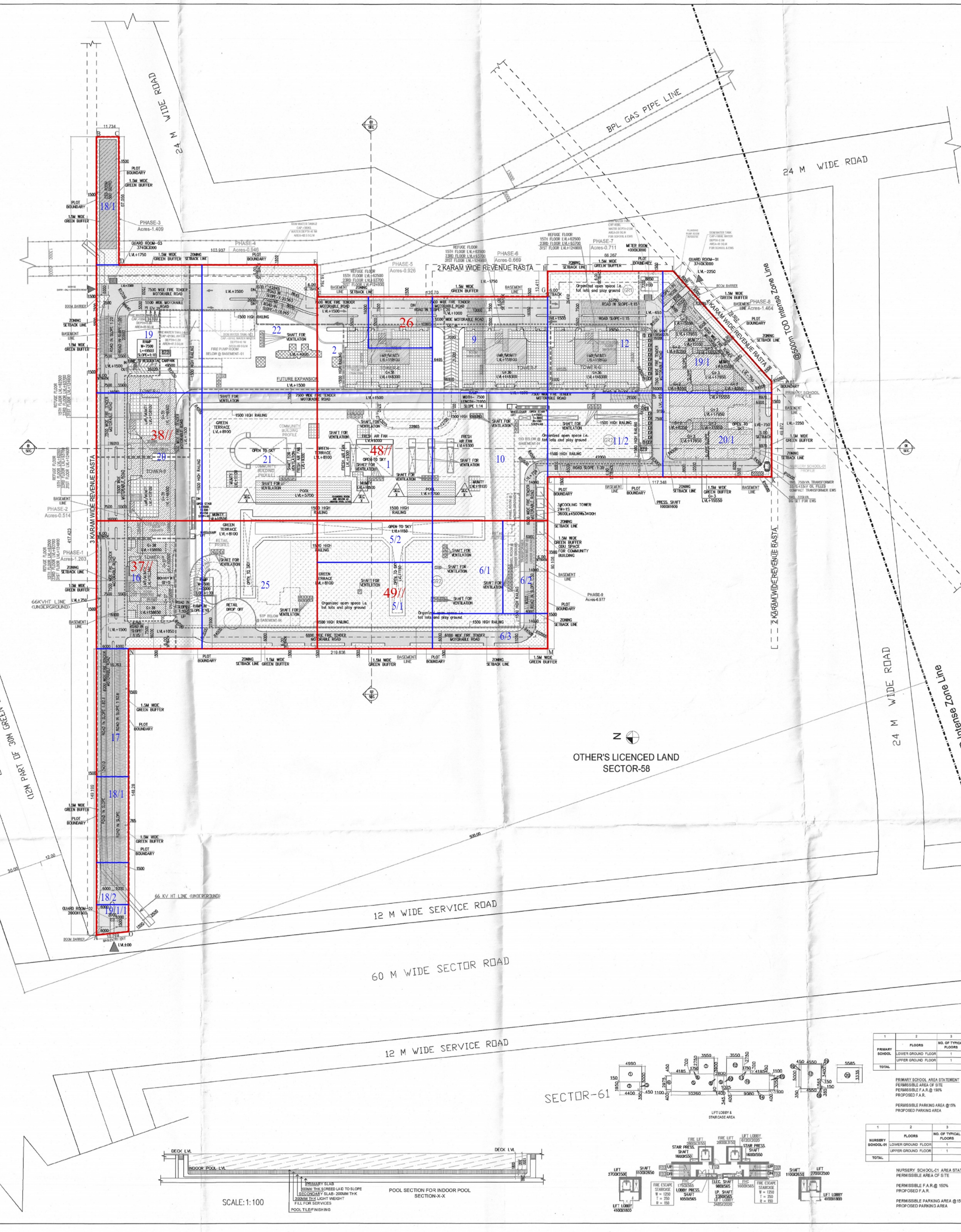

TOWER	FLOOR	NO. OF FLOORS	FAR AREA BY FLOOR	TOTAL FAR OF ALL FLOORS	TOTAL FAR OF ONE TOWER	NO. OF P.A.R. FLOOR	TOTAL NO. OF P.A.R. FLOOR	TOTAL NO. OF NON-P.A.R. FLOOR	BUILD UP AREA	BUILD UP AREA OF ONE TOWER	TOTAL BUILD UP AREA	TOTAL NO. OF TOWER	TOTAL NO. OF FLOORS	TOTAL NO. OF P.A.R. FLOOR	TOTAL NO. OF NON-P.A.R. FLOOR	TOTAL NO. OF TOWER	TOTAL NO. OF FLOORS
TOWER-A	TYPICAL FLOOR	1	250,379	250,379	142,888	142,888	107,995	107,995	300,283	300,283	300,283	10	10	107,995	107,995	10	10
	GROUND FLOOR	1	733,532	1,483,911	733,532	733,532	45,840	45,840	1,438,071	1,438,071	1,438,071	1	1	45,840	45,840	1	1
	TYPICAL FLOOR TO 15TH FLOOR	15	728,168	10,922,520	728,168	10,922,520	45,840	687,600	10,434,920	10,434,920	10,434,920	15	15	687,600	687,600	15	15
	15TH FLOOR	1	728,168	10,922,520	728,168	10,922,520	45,840	687,600	10,434,920	10,434,920	10,434,920	1	1	687,600	687,600	1	1
	16TH FLOOR	1	728,168	10,922,520	728,168	10,922,520	45,840	687,600	10,434,920	10,434,920	10,434,920	1	1	687,600	687,600	1	1
	17TH FLOOR	1	728,168	10,922,520	728,168	10,922,520	45,840	687,600	10,434,920	10,434,920	10,434,920	1	1	687,600	687,600	1	1
	18TH FLOOR	1	728,168	10,922,520	728,168	10,922,520	45,840	687,600	10,434,920	10,434,920	10,434,920	1	1	687,600	687,600	1	1
	19TH FLOOR	1	728,168	10,922,520	728,168	10,922,520	45,840	687,600	10,434,920	10,434,920	10,434,920	1	1	687,600	687,600	1	1
	20TH FLOOR	1	728,168	10,922,520	728,168	10,922,520	45,840	687,600	10,434,920	10,434,920	10,434,920	1	1	687,600	687,600	1	1
	21ST FLOOR	1	728,168	10,922,520	728,168	10,922,520	45,840	687,600	10,434,920	10,434,920	10,434,920	1	1	687,600	687,600	1	1
22ND FLOOR	1	728,168	10,922,520	728,168	10,922,520	45,840	687,600	10,434,920	10,434,920	10,434,920	1	1	687,600	687,600	1	1	
TOTAL																	

TABLE-1

Sl. No.	Description	Area (Sq. M)	Remarks
1	Plot Area	14,81,875	AS PER APPROVED
2	Area of Residential Component @ 50% of Plot Area	7,40,937.5	AS PER APPROVED
3	Area of Commercial Component @ 50% of Plot Area	7,40,937.5	AS PER APPROVED
4	Area of Residential Component @ 30% of Plot Area	4,44,562.5	AS PER APPROVED
5	Area of Commercial Component @ 30% of Plot Area	4,44,562.5	AS PER APPROVED
6	Area of Residential Component @ 20% of Plot Area	2,96,375	AS PER APPROVED
7	Area of Commercial Component @ 20% of Plot Area	2,96,375	AS PER APPROVED
8	Area of Residential Component @ 10% of Plot Area	1,48,187.5	AS PER APPROVED
9	Area of Commercial Component @ 10% of Plot Area	1,48,187.5	AS PER APPROVED
10	Area of Residential Component @ 5% of Plot Area	74,093.75	AS PER APPROVED
11	Area of Commercial Component @ 5% of Plot Area	74,093.75	AS PER APPROVED
12	Area of Residential Component @ 2.5% of Plot Area	37,046.875	AS PER APPROVED
13	Area of Commercial Component @ 2.5% of Plot Area	37,046.875	AS PER APPROVED
14	Area of Residential Component @ 1.25% of Plot Area	18,523.4375	AS PER APPROVED
15	Area of Commercial Component @ 1.25% of Plot Area	18,523.4375	AS PER APPROVED
16	Area of Residential Component @ 0.625% of Plot Area	9,261.71875	AS PER APPROVED
17	Area of Commercial Component @ 0.625% of Plot Area	9,261.71875	AS PER APPROVED
18	Area of Residential Component @ 0.3125% of Plot Area	4,630.859375	AS PER APPROVED
19	Area of Commercial Component @ 0.3125% of Plot Area	4,630.859375	AS PER APPROVED
20	Area of Residential Component @ 0.15625% of Plot Area	2,315.4296875	AS PER APPROVED
21	Area of Commercial Component @ 0.15625% of Plot Area	2,315.4296875	AS PER APPROVED
22	Area of Residential Component @ 0.078125% of Plot Area	1,157.71484375	AS PER APPROVED
23	Area of Commercial Component @ 0.078125% of Plot Area	1,157.71484375	AS PER APPROVED
24	Area of Residential Component @ 0.0390625% of Plot Area	578.857421875	AS PER APPROVED
25	Area of Commercial Component @ 0.0390625% of Plot Area	578.857421875	AS PER APPROVED
26	Area of Residential Component @ 0.01953125% of Plot Area	289.4287109375	AS PER APPROVED
27	Area of Commercial Component @ 0.01953125% of Plot Area	289.4287109375	AS PER APPROVED
28	Area of Residential Component @ 0.009765625% of Plot Area	144.71435546875	AS PER APPROVED
29	Area of Commercial Component @ 0.009765625% of Plot Area	144.71435546875	AS PER APPROVED
30	Area of Residential Component @ 0.0048828125% of Plot Area	72.357177734375	AS PER APPROVED
31	Area of Commercial Component @ 0.0048828125% of Plot Area	72.357177734375	AS PER APPROVED
32	Area of Residential Component @ 0.00244140625% of Plot Area	36.1785888671875	AS PER APPROVED
33	Area of Commercial Component @ 0.00244140625% of Plot Area	36.1785888671875	AS PER APPROVED
34	Area of Residential Component @ 0.001220703125% of Plot Area	18.08929443359375	AS PER APPROVED
35	Area of Commercial Component @ 0.001220703125% of Plot Area	18.08929443359375	AS PER APPROVED
36	Area of Residential Component @ 0.0006103515625% of Plot Area	9.044647216796875	AS PER APPROVED
37	Area of Commercial Component @ 0.0006103515625% of Plot Area	9.044647216796875	AS PER APPROVED
38	Area of Residential Component @ 0.00030517578125% of Plot Area	4.5223236083984375	AS PER APPROVED
39	Area of Commercial Component @ 0.00030517578125% of Plot Area	4.5223236083984375	AS PER APPROVED
40	Area of Residential Component @ 0.000152587890625% of Plot Area	2.26116180419921875	AS PER APPROVED
41	Area of Commercial Component @ 0.000152587890625% of Plot Area	2.26116180419921875	AS PER APPROVED
42	Area of Residential Component @ 0.0000762939453125% of Plot Area	1.130580902099609375	AS PER APPROVED
43	Area of Commercial Component @ 0.0000762939453125% of Plot Area	1.130580902099609375	AS PER APPROVED
44	Area of Residential Component @ 0.00003814697265625% of Plot Area	0.5652904510498046875	AS PER APPROVED
45	Area of Commercial Component @ 0.00003814697265625% of Plot Area	0.5652904510498046875	AS PER APPROVED
46	Area of Residential Component @ 0.000019073486328125% of Plot Area	0.28264522552490234375	AS PER APPROVED
47	Area of Commercial Component @ 0.000019073486328125% of Plot Area	0.28264522552490234375	AS PER APPROVED
48	Area of Residential Component @ 0.0000095367431640625% of Plot Area	0.141322612762451171875	AS PER APPROVED
49	Area of Commercial Component @ 0.0000095367431640625% of Plot Area	0.141322612762451171875	AS PER APPROVED
50	Area of Residential Component @ 0.00000476837158203125% of Plot Area	0.0706613063812255859375	AS PER APPROVED
51	Area of Commercial Component @ 0.00000476837158203125% of Plot Area	0.0706613063812255859375	AS PER APPROVED
52	Area of Residential Component @ 0.000002384185791015625% of Plot Area	0.03533065319061279296875	AS PER APPROVED
53	Area of Commercial Component @ 0.000002384185791015625% of Plot Area	0.03533065319061279296875	AS PER APPROVED
54	Area of Residential Component @ 0.0000011920928955078125% of Plot Area	0.017665326595306396484375	AS PER APPROVED
55	Area of Commercial Component @ 0.0000011920928955078125% of Plot Area	0.017665326595306396484375	AS PER APPROVED
56	Area of Residential Component @ 0.00000059604644775390625% of Plot Area	0.0088326632976531982421875	AS PER APPROVED
57	Area of Commercial Component @ 0.00000059604644775390625% of Plot Area	0.0088326632976531982421875	AS PER APPROVED
58	Area of Residential Component @ 0.000000298023223876953125% of Plot Area	0.00441633164882659912109375	AS PER APPROVED
59	Area of Commercial Component @ 0.000000298023223876953125% of Plot Area	0.00441633164882659912109375	AS PER APPROVED
60	Area of Residential Component @ 0.0000001490116119384765625% of Plot Area	0.002208165824413299560546875	AS PER APPROVED
61	Area of Commercial Component @ 0.0000001490116119384765625% of Plot Area	0.002208165824413299560546875	AS PER APPROVED
62	Area of Residential Component @ 0.00000007450580596923828125% of Plot Area	0.0011040829122066497802734375	AS PER APPROVED
63	Area of Commercial Component @ 0.00000007450580596923828125% of Plot Area	0.0011040829122066497802734375	AS PER APPROVED
64	Area of Residential Component @ 0.000000037252902984619140625% of Plot Area	0.00055204145610332489013671875	AS PER APPROVED
65	Area of Commercial Component @ 0.000000037252902984619140625% of Plot Area	0.00055204145610332489013671875	AS PER APPROVED
66	Area of Residential Component @ 0.0000000186264514923095703125% of Plot Area	0.000276020728051662445068359375	AS PER APPROVED
67	Area of Commercial Component @ 0.0000000186264514923095703125% of Plot Area	0.000276020728051662445068359375	AS PER APPROVED
68	Area of Residential Component @ 0.00000000931322574615478515625% of Plot Area	0.0001380103640258312225291796875	AS PER APPROVED
69	Area of Commercial Component @ 0.00000000931322574615478515625% of Plot Area	0.0001380103640258312225291796875	AS PER APPROVED
70	Area of Residential Component @ 0.0000000046566128730773928125% of Plot Area	0.000069005182012915611458959375	AS PER APPROVED
71	Area of Commercial Component @ 0.0000000046566128730773928125% of Plot Area	0.000069005182012915611458959375	AS PER APPROVED
72	Area of Residential Component @ 0.00000000232830643653869640625% of Plot Area	0.0000345025910064578057479296875	AS PER APPROVED
73	Area of Commercial Component @ 0.00000000232830643653869640625% of Plot Area	0.0000345025910064578057479296875	AS PER APPROVED
74	Area of Residential Component @ 0.000000001164153218269348203125% of Plot Area	0.00001725129550322890289596484375	AS PER APPROVED
75	Area of Commercial Component @ 0.000000001164153218269348203125% of Plot Area	0.00001725129550322890289596484375	AS PER APPROVED
76	Area of Residential Component @ 0.0000000005820766091346966015625% of Plot Area	0.0000086256477516144514479796875	AS PER APPROVED
77	Area of Commercial Component @ 0.0000000005820766091346966015625% of Plot Area	0.0000086256477516144514479796875	AS PER APPROVED
78	Area of Residential Component @ 0.00000000029103830456732330078125% of Plot Area	0.00000431282387580722574898984375	AS PER APPROVED
79	Area of Commercial Component @ 0.00000000029103830456732330078125% of Plot Area	0.00000431282387580722574898984375	AS PER APPROVED
80	Area of Residential Component @ 0.000000000145519152283661650390625% of Plot Area	0.000002156411937903612899494921875	AS PER APPROVED
81	Area of Commercial Component @ 0.000000000145519152283661650390625% of Plot Area	0.000002156411937903612899494921875	AS PER APPROVED
82	Area of Residential Component @ 0.0000000000727595761418308251953125% of Plot Area	0.00000107820596895180644974748984375	AS PER APPROVED
83	Area of Commercial Component @ 0.0000000000727595761418308251953125% of Plot Area	0.00000107820596895180644974748984375	AS PER APPROVED
84	Area of Residential Component @ 0.0000000000363797880709154126269640625% of Plot Area	0.000000539102984475703224873748984375	AS PER APPROVED
85	Area of Commercial Component @ 0.0000000000363797880709154126269640625% of Plot Area	0.000000539102984475703224873748984375	AS PER APPROVED
86	Area of Residential Component @ 0.00000000001818989403545770631313230078125% of Plot Area	0.000000269551492237851612	