

**TOWER - A3, A4 & A5  
TYPICAL FLOOR PLAN  
(1st -17th, 19th- 27th , 29th-36th & 38th FLOOR)**

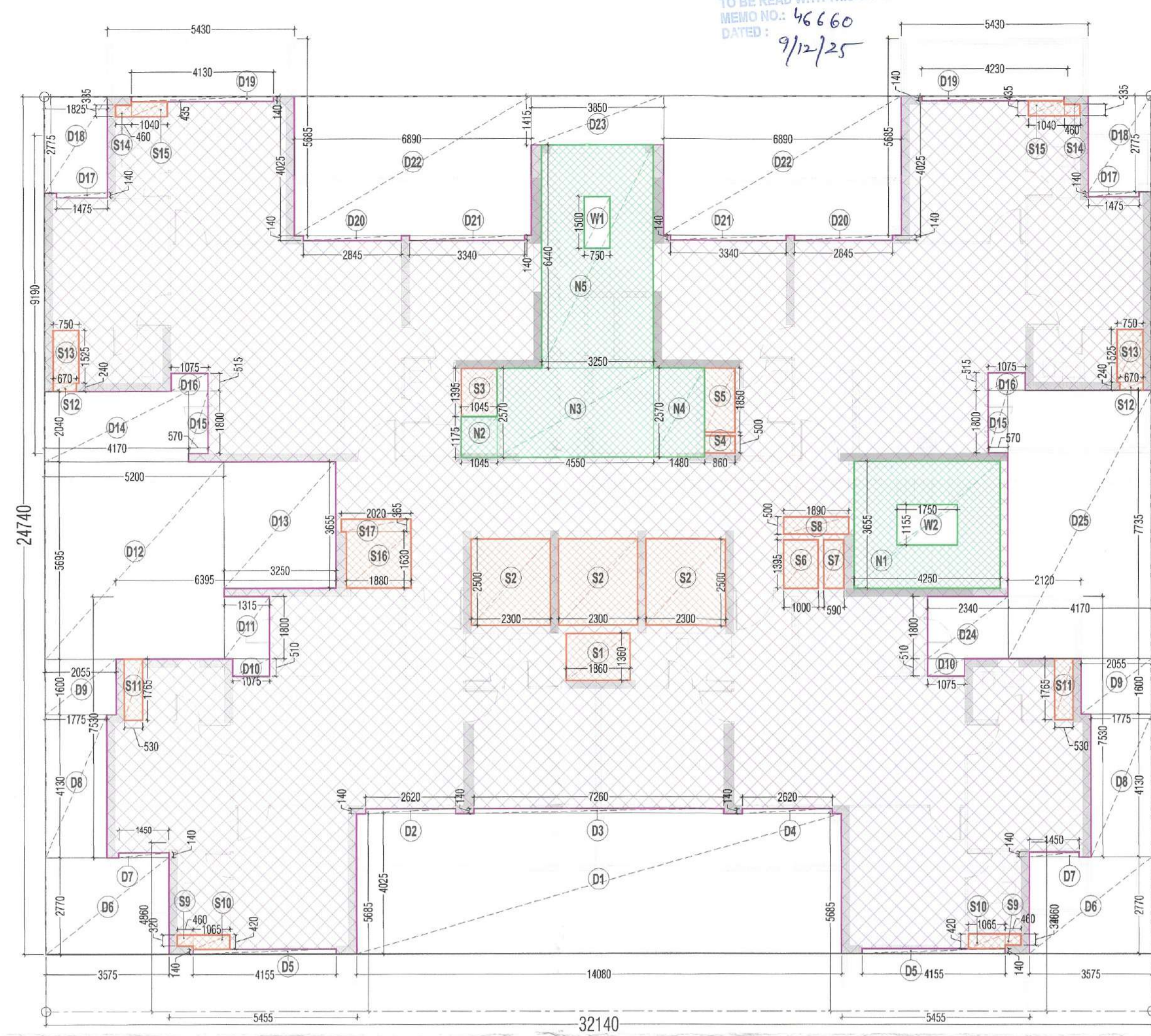

**TOWER - A3, A4 & A5  
TYPICAL FLOOR PLAN  
AREA DIAGRAM**

**LEGEND:-**

SIB.	TITLE	W	H	SILL	NOTES
801	SLIDING DOOR	3500	2500	± 00	
802	SLIDING DOOR	3540	2500	± 00	
803	SLIDING DOOR	3440	2500	± 00	
804	SLIDING DOOR	3410	2500	± 00	
805	SLIDING DOOR	3338	2500	± 00	
806	SLIDING DOOR	2990	2500	± 00	
807	SLIDING DOOR	2850	2500	± 00	
808	SLIDING DOOR	2700	2500	± 00	
809	SLIDING DOOR	2620	2500	± 00	
810	SLIDING DOOR	2440	2500	± 00	
811	SLIDING DOOR	1825	2500	± 00	
812	SLIDING DOOR	1475	2500	± 00	
813	SLIDING DOOR	1450	2500	± 00	
814	SLIDING DOOR	1200	2500	± 00	1 HR FIRE RATED
815	FLUSH DOOR	1000	2250	± 00	
816	FLUSH DOOR	1200	2250	± 00	
817	FLUSH DOOR	800	2250	± 00	
818	FIRE DOOR	1800	2250	± 00	2 HR FIRE RATED
819	FIRE DOOR	1500	2250	± 00	2 HR FIRE RATED
820	FIRE DOOR	1500	2250	+100	2 HR FIRE RATED
821	FIRE DOOR	1750	2250	± 00	2 HR FIRE RATED
822	FIRE DOOR	900	2150	+100	2 HR FIRE RATED
823	FIRE DOOR	700	2150	+100	2 HR FIRE RATED
824	FIRE DOOR	1000	2150	+100	2 HR FIRE RATED
825	DOOR WINDOW	800	2250	± 00	
826	GLASS DOOR	2000	2500	± 00	
827	WINDOW	1500	1350	+900	
828	WINDOW	1075	1350	+900	
829	VENTILATOR	600	1200	+1050	

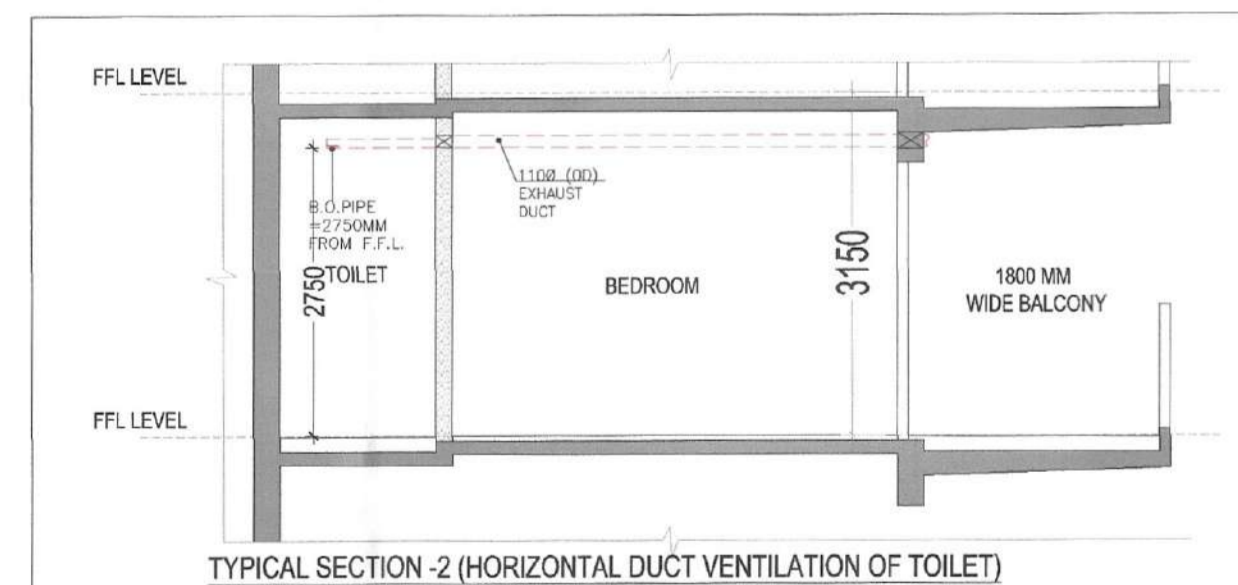

**SUMMARY OF MECHANICAL VENTILATION**

S/N	Floor	Area SFT	Effective HT FT	Volume CFT	Air Change Per Hour	Calculated CFM	Installed CFM	Application	No. of Fans & Capacity CFM	Type of Fan	Remark
1	General Ventilation										
1	Toilet For Bedroom 3 - Typical	42	9	378	10	63	100	Exhaust	1x100 CFM	Inline Fan	Normal Mode
2	Common Toilet For Bedroom 3 - Typical	46	9	405	10	66	100	Exhaust	1x100 CFM	Inline Fan	Normal Mode

- PLUMBING LEGEND**
- | S.NO. | DESCRIPTION  |
|-------|--|
| ①     | 100Ø SOIL & VENT PIPE                                      |
| ②     | 100Ø WASTE & VENT PIPE                                     |
| ③     | 100Ø ANTISYPHONAGE PIPE                                    |
| ④     | 110 OD RAIN WATER PIPE                                     |
| ⑤     | 160 OD RAIN WATER PIPE                                     |
| ⑥     | DOMESTIC WATER SUPPLY DOWN TAKE FOR TOP FOUR FLOOR (35-32) |
| ⑦     | DOMESTIC WATER SUPPLY DOWN TAKE FOR (31-17) FLOOR          |
| ⑧     | DOMESTIC WATER SUPPLY DOWN TAKE FOR (16-GRO.) FLOOR        |
| ⑨     | FLUSHING WATER SUPPLY DOWN TAKE FOR (35-24) FLOOR          |
| ⑩     | FLUSHING WATER SUPPLY DOWN TAKE FOR (23-12) FLOOR          |
| ⑪     | FLUSHING WATER SUPPLY DOWN TAKE FOR (11-GROUND) FLOOR      |
| ⑫     | DOMESTIC WATER RISER PIPE TO OHT                           |
| ⑬     | FLUSHING WATER RISER PIPE TO OHT                           |

- PLUMBING LEGEND**
- | S.NO. | DESCRIPTION   |
|-------|---|
| (A)   | 150Ø FIRE PIPE LOWE ZONE BASEMENT TO 9th FLOOR                |
| (B)   | 150Ø FIRE PIPE MIDDLE ZONE 10th TO 23rd FLOOR                 |
| (C)   | 150Ø FIRE PIPE HIGH ZONE 24th TO TERRACE LVL.                 |
| (D)   | 150Ø SPRINKLER PIPE LOWE ZONE BASEMENT TO 9th FLOOR           |
| (E)   | 150Ø SPRINKLER PIPE MIDDLE ZONE 10th TO 23rd FLOOR            |
| (F)   | 150Ø SPRINKLER PIPE HIGH ZONE 24th TO TERRACE LVL.            |
| (G)   | 150Ø ALTERNATE SPRINKLER PIPE LOWE ZONE BASEMENT TO 9th FLOOR |
| (H)   | 150Ø ALTERNATE SPRINKLER PIPE MIDDLE ZONE 10th TO 23rd FLOOR  |
| (J)   | 150Ø ALTERNATE SPRINKLER PIPE HIGH ZONE 24th TO TERRACE LVL.  |
| (K)   | 150Ø FIRE DOWN COMER PIPE                                     |
| (L)   | 80Ø DRAIN PIPE  |

- LEGEND**
- FAR AREA
  - NON FAR AREA
  - SERVICE AREA
  - SHAFT AREA UNDER DEDUCTION
  - FIRE TENDER PATH
  - TOWER LINE
- HORIZONTAL PIPE CONNECTIONS SHALL BE AS FOLLOWS.**
- FROM WASH BASIN TO FT 32Ø PIPE
  - FROM SINK TO FT 40Ø PIPE
  - FROM FD TO FT 50Ø PIPE
  - FROM FT TO VERTICAL STACK 100Ø PIPE
  - FROM WC TO VERTICAL STACK 40Ø PIPE

**FAR AREA AT TYPICAL FLOOR LEVEL**

TAG	LENGTH (L) in Mts	WIDTH (W) in Mts	NO.S (N)	AREA (L x W x N)
A	32.140	24.740	1	795.14
TOTAL (A)				795.14

**DEDUCTIONS**

TAG	LENGTH (L) in Mts	WIDTH (W) in Mts	NO.S (N)	AREA (L x W x N)
D1	14.080	4.025	1	56.67
D2	2.620	0.140	1	0.37
D3	7.260	0.140	1	1.02
D4	2.620	0.140	1	0.37
D5	4.155	0.140	2	1.16
D6	3.575	2.770	2	19.81
D7	1.450	0.140	2	0.41
D8	1.775	4.130	2	14.66
D9	2.055	1.600	2	6.58
D10	1.075	0.510	2	1.10
D11	1.315	1.800	1	2.37
D12	5.200	5.695	1	29.61
D13	3.250	3.655	1	11.88
D14	4.170	2.040	1	8.51
D15	0.570	1.800	2	2.05
D16	1.075	0.515	2	1.11
D17	1.475	0.140	2	0.41
D18	1.825	2.775	2	10.13
D19	4.130	0.140	2	1.16
D20	2.845	0.140	2	0.80
D21	3.340	0.140	2	0.94
D22	6.890	4.025	2	55.46
D23	3.850	1.415	1	5.45
D24	2.340	1.800	1	4.21
D25	4.170	7.735	1	32.25
TOTAL (D)				268.47

**LIFT & SERVICES SHAFTS**

TAG	LENGTH (L) in Mts	WIDTH (W) in Mts	NO.S (N)	AREA (L x W x N)
S1	1.860	1.360	1	2.53
S2	2.300	2.500	3	17.25
S3	1.045	1.395	1	1.46
S4	0.860	0.500	1	0.43
S5	0.860	1.850	1	1.59
S6	1.000	1.395	1	1.40
S7	0.590	1.395	1	0.82
S8	1.890	0.500	1	0.95
S9	0.460	0.320	2	0.29
S10	1.065	0.420	2	0.89
S11	0.530	1.765	2	1.87
S12	0.670	0.240	2	0.32
S13	0.750	1.525	2	2.29
S14	0.460	0.335	2	0.31
S15	1.040	0.435	2	0.90
S16	1.880	1.630	1	3.06
S17	2.020	0.365	1	0.74
TOTAL (S)				37.11

**FIRE STAIRCASE & NON FAR AREA**

TAG	LENGTH (L) in Mts	WIDTH (W) in Mts	NO.S (N)	AREA (L x W x N)
N1	4.250	3.655	1	15.53
N2	1.045	1.175	1	1.23
N3	4.550	2.570	1	11.69
N4	1.480	2.570	1	3.80
N5	3.250	6.440	1	20.93
TOTAL (N)				53.19

**FIRE STAIRCASE WELL**

TAG	LENGTH (L) in Mts	WIDTH (W) in Mts	NO.S (N)	AREA (L x W x N)
W1	0.750	1.500	1	1.13
W2	1.750	1.155	1	2.02
TOTAL (W)				3.15
TOTAL NON FAR AREA (NF) = (N - W)				50.04
TOTAL FAR AREA (F) = (A - D - S - N)				436.38
TOTAL COVERED AREA = (F + NF)				486.43

- NOTE:**
- BUILDING HAS AUTOMATIC SPRINKLER SYSTEM WHEREVER REQUIRED BY NBC.
  - BUILDING WILL BE DESIGNED (STRUCTURES) AS PER RELEVANT IS CODES FOR EARTH QUAKE RESISTANCE.
  - 100% POWER BACKUP MECHANICAL VENTILATED SHAFTS.
  - ALL RESIDENTIAL UNITS ENTRANCE DOOR-1HR FIRE RATED.

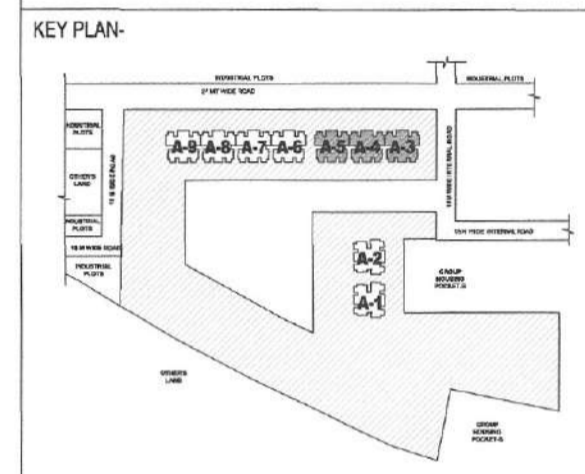

**PROJECT**  
PROPOSED BUILDING PLAN FOR AFFORDABLE GROUP HOUSING-1 (POCKET-A) OVER AN AREA MEASURING 16.4738 ACRES, PART OF INDUSTRIAL PLOTTED COLONY OVER AN AREA MEASURING 139.7355 ACRES (LICENCE NO.168 OF 2025 DATED 08.09.2025) IN THE REVENUE ESTATE OF VILLAGE BAS HARA AND HINDI SARAI ABAD, IN SECTOR NO. M10 AND M11 GURUGRAM MANESAR URBAN COMPLEX.

**OWNER**  
M3M INDIA INFRASTRUCTURES PVT. LTD.

**ARCHITECTS**  
**STUDIO SYMBIOSIS**  
INDIA | GERMANY | UK  
INDIA  
1301, TOWER-E, SKYMARK ONE  
SECTOR 96, NOIDA, U.P. 201301, NOIDA  
TEL: +91 0120 4228919  
E-MAIL: INFO@STUDIOSYMBIOSIS.COM  
WWW.STUDIOSYMBIOSIS.COM

**OWNERS SEAL & SIGNATURE**  
For M3M India Infrastructures Pvt. Ltd.  
*(Signature)*  
(Author's Signatory)

**ARCHITECTS SEAL & SIGNATURE**  
*(Signature)*  
AMIT GUPTA  
Architect  
04/2004 / 33147

**DATE:** SCALE: 1:100 **DWG NO:** FP-A3A4A5-TY-01

**DWG TITLE:**  
TYPICAL FLOOR PLAN & AREA DIAGRAM  
(TOWER - A3, A4 & A5)

SANCTIONED  
TO BE READ WITH THIS OFFICE  
MEMO NO.: 46660  
DATED: 9/12/25

*(Signatures)*  
S.T.P.(HQ) S.T.P.(G) C.T.P.(HR)  
Member Secretary Member Chairman  
B.P.A.C. B.P.A.C. B.P.A.C.

*(Signatures)*  
DTP(HQ) ATP(HQ)

*(Signatures)*  
DINESH KUMAR  
and found ok for Public Health  
(Internal) Service only subject to comments in  
In forwarding letter No. 366.511.DV. 26/11/25  
Sudhakar Engineer (HQ)  
for Chief Engineer-I  
HSVP, Panchkula

*(Signatures)*