

PHASING PLAN

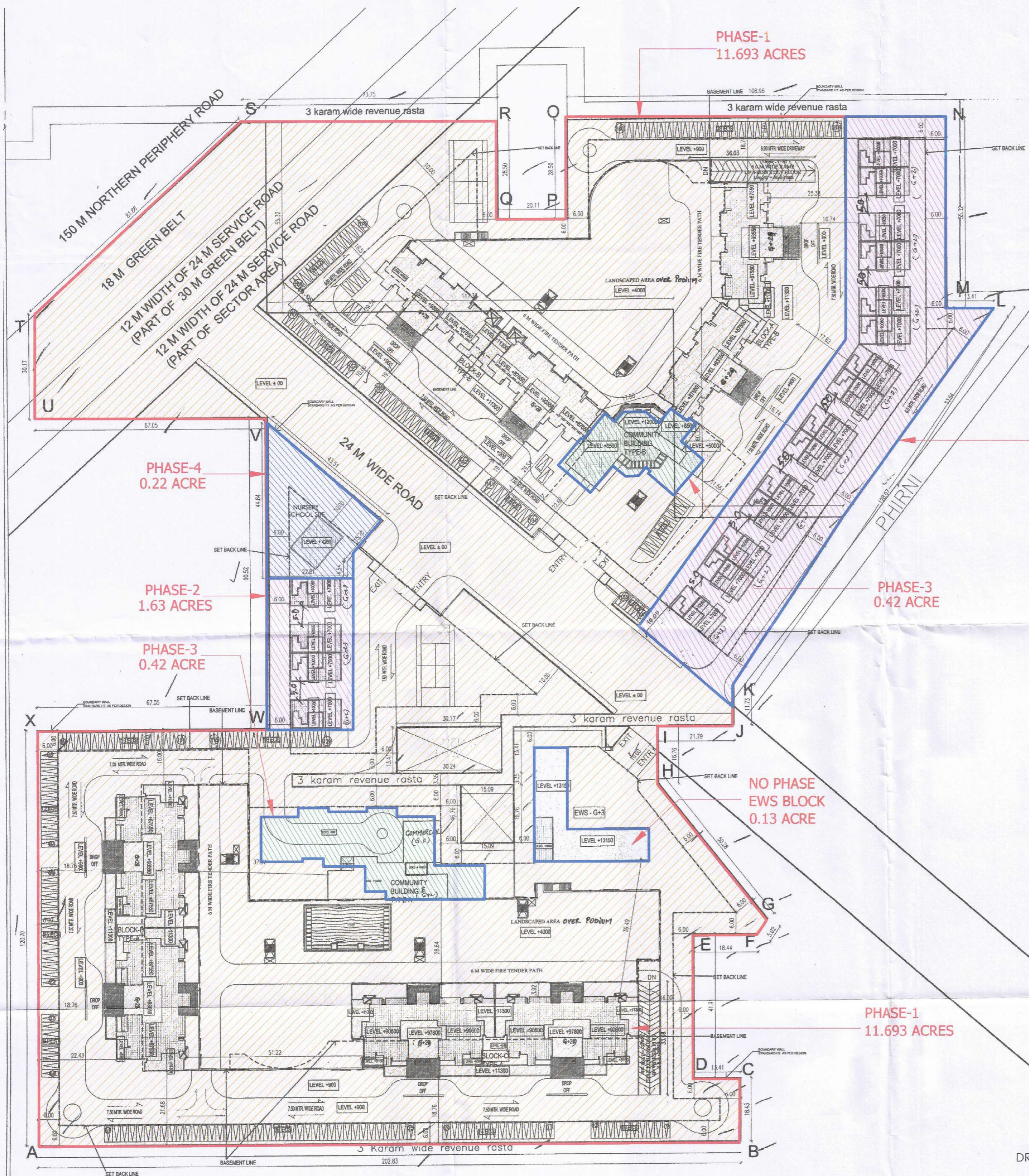

PHASE WISE AREA SUMMARY		
	ACRES	SQM.
TOTAL SITE AREA	14.093	57032.257
NET PLANNED AREA OF SITE	13.6875	55391.259
FAR		
PERMISSIBLE FAR 175%		96934.703

SR. NO.	COLOR	PHASE NO.	PLOT AREA		OC GRANTED FAR IN SQM.	TENTATIVE PROPOSED FAR IN SQM.	GRAND TOTAL	STATUS OF O.C.	STATUS OF HRERA NO.
			ACRES	SQM.					
1	[Red]	Phase-1 (BP Approved)	11.693	47319.817	83806.62	87395.38	87395.38	Granted	Not Registered
2	[Purple]	Phase-2 (BP Approved)	1.63	6596.365	Not Granted	5670.16	5670.16	Not Granted	Not Registered
3	[Green]	Phase-3 (BP Approved)	0.42	1699.677	1618.06	1924.22	1924.22	Granted	Not Registered
4	[Blue]	Phase-4 (BP Approved)	0.22	890.307	Not Granted	1214.055	1214.055	Not Granted	Not Registered
5	[White]	No Phase (BP Approved) (Ews Block)	0.13	526.091	1814.79	1814.79	1814.79	Granted	Not Registered
Total Area			14.093	57032.257	87239.47	98018.605	98018.605	-	-

- [Red] PHASE-1 = 11.693 ACRES
 - [Purple] PHASE-2 = 1.63 ACRES
 - [Green] PHASE-3 = 0.42 ACRES (COMMUNITY & CONVENIENT SHOPPING BLOCK)
 - [Blue] PHASE-4 = 0.22 ACRES (NURSERY SCHOOL BLOCK)
 - [White] NO PHASE AREA = 0.13 ACRE (EWS BLOCK)
- TOTAL LAND = 14.093 ACRES**

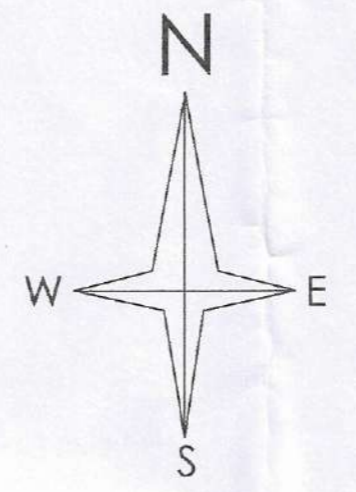

The above is indicative and tentative FAR to be utilized in phases, out of the component of permissible FAR and/or through applicable / future schemes and / or policies / norms, including but not limited to TOD, PDR, TDR, GRIHA, LEED, IGBC etc. and / or any lawful FAR that may be availed through re-development or reconstruction of amalgamation / inclusion of additional land or through any other means.

In each of the phases tentative FAR is subject to change based on future design

DRG. NO. DTCP 11426 DATED 08-09-25

PHASING PLAN OF GROUP HOUSING COLONY FOR THE AREA MEASURING 14.093 ACRES (LICENSE NO. 63 OF 2011 DATED 16-07-2011 & 10 OF 2012 DATED 03-02-2012) IN SECTOR-104 BEING DEVELOPED BY GREAT VALUE HPL INFRATECH PVT. LTD. AND OTHERS

ARCHITECT

AR. PRADEEP KUMAR
 CA/2017/84030
 Ria House 301, Second Floor
 Opp Huda Office, Sector-14, Gurugram
 Mob. 8700172670

OWNER
 Greatvalue HPL Infratech Pvt. Ltd.

 Authorized Signatory

(RAJESH DUTT) SD(HQ) (JAHANVI) ATP(HQ) (ASHISH SHARMA) DTP(HQ) (Hitesh Sharma) STP(HQ) (L0) (BHUVNESH KUMAR) CTP(HQ) (AMIT KHATRI, IAS) DTCP(HQ)