

**DOOR, WINDOW & VENTILATOR SCHEDULE**

| S.No. | TYPE | WIDTH | CILL  | LINTEL |
|-------|------|-------|-------|--------|
| 1     | D    | 1.075 | 0     | 2.450  |
| 2     | D1   | 1.000 | 0     | 2.450  |
| 3     | D2   | 0.750 | 0     | 2.450  |
| 4     | D3   | 0.995 | 0     | 2.450  |
| 5     | DW1  | 1.750 | 0     | 2.450  |
| 6     | W/EF | 1.850 | 0     | 2.450  |
| 7     | W1   | 1.525 | 900   | 2.450  |
| 8     | V/PV | 0.750 | 1.550 | 2.450  |

**AREA STATEMENT**

|                                                                              |                  |                       |              |                |
|------------------------------------------------------------------------------|------------------|-----------------------|--------------|----------------|
| TOTAL PLOT AREA = 8.650 M X 15.000 M                                         | 129.750          | sq.mts.               |              |                |
| PERMISSIBLE COVERED F.A.R. @ 200%                                            | 259.500          | sq.mts.               |              |                |
| TOTAL PERMISSIBLE GROUND COVERAGE @ 75%                                      | 97.313           | sq.mts.               |              |                |
| ACHIEVED F.A.R. @ 64%                                                        | 83.040           | sq.mts.               |              |                |
| <b>TOTAL FAR 264%</b>                                                        | <b>342.540</b>   | <b>sq.mts.</b>        |              |                |
| <b>PROPOSED F.A.R. AREA OF STILT</b>                                         |                  |                       |              |                |
| A                                                                            | 1.730 X 1.535    | = 2.656 sq.mts.       |              |                |
| B                                                                            | 2.195 X 4.535    | = 9.954 sq.mts.       |              |                |
| C                                                                            | 1.730 X 1.730    | = 2.993 sq.mts.       |              |                |
| <b>TOTAL FAR AREA OF A+B+C</b>                                               | <b>= 15.603</b>  | <b>sq.mts.</b>        |              |                |
| <b>NON F.A.R. AREA OF STILT</b>                                              |                  |                       |              |                |
| AA                                                                           | 8.650 X 11.320   | = 97.918 sq.mts.      |              |                |
| <b>1+2+A+B+C</b>                                                             | <b>= 20.316</b>  | <b>sq.mts.</b>        |              |                |
| <b>TOTAL AREA FAR + NON FAR (AA - 1+2)</b>                                   | <b>= 77.602</b>  | <b>sq.mts.</b>        |              |                |
| <b>PROPOSED F.A.R. ON FIRST FLOOR 854</b>                                    |                  |                       |              |                |
| AA                                                                           | 8.650 X 11.320   | = 97.918 sq.mts.      |              |                |
| 1                                                                            | 2.485 X 1.685    | = 4.186 sq.mts.       |              |                |
| 2                                                                            | 6.340 X 0.130    | = 0.824 sq.mts.       |              |                |
| 3                                                                            | 1.850 X 4.075    | = 7.539 sq.mts.       |              |                |
| 4                                                                            | 0.230 X 1.075    | = 0.247 sq.mts.       |              |                |
| 5                                                                            | 1.500 X 1.075    | = 1.613 sq.mts.       |              |                |
| 6                                                                            | 1.500 X 1.500    | = 2.250 sq.mts.       |              |                |
| <b>TOTAL OF 1 TO 6</b>                                                       | <b>= 16.362</b>  | <b>sq.mts.</b>        |              |                |
| <b>PROPOSED F.A.R. ON FIRST FLOOR</b>                                        | <b>= 81.556</b>  | <b>sq.mts.</b>        |              |                |
| <b>PROPOSED F.A.R. ON SECOND FLOOR</b>                                       | <b>= 81.556</b>  | <b>sq.mts.</b>        |              |                |
| <b>PROPOSED F.A.R. ON THIRD FLOOR</b>                                        | <b>= 81.556</b>  | <b>sq.mts.</b>        |              |                |
| <b>PROPOSED F.A.R. ON FOURTH FLOOR</b>                                       | <b>= 81.556</b>  | <b>sq.mts.</b>        |              |                |
| <b>TOTAL PROPOSED F.A.R. AREA ON ALL FLOORS (STILT + FF + SF + TF + 4TH)</b> | <b>= 341.827</b> | <b>sq.mts.</b>        |              |                |
| <b>NON F.A.R. AREA OF MUMTY</b>                                              |                  |                       |              |                |
| A                                                                            | 1.730 X 1.535    | = 2.656 sq.mts.       |              |                |
| B                                                                            | 2.195 X 4.535    | = 9.954 sq.mts.       |              |                |
| C                                                                            | 1.730 X 1.730    | = 2.993 sq.mts.       |              |                |
| <b>TOTAL AREA (A+B+C)</b>                                                    | <b>= 15.603</b>  | <b>sq.mts.</b>        |              |                |
| <b>FLOORS</b>                                                                | <b>FAR AREA</b>  | <b>+ NON FAR AREA</b> | <b>TOTAL</b> | <b>SQ.MTS.</b> |
| STILT AREA                                                                   | 15.603           | + 77.602              | = 93.205     | sq.mts.        |
| FIRST FLOOR                                                                  | 81.556           | + 11.649              | = 93.205     | sq.mts.        |
| SECOND FLOOR                                                                 | 81.556           | + 11.649              | = 93.205     | sq.mts.        |
| THIRD FLOOR                                                                  | 81.556           | + 11.649              | = 93.205     | sq.mts.        |
| FOURTH FLOOR                                                                 | 81.556           | + 11.649              | = 93.205     | sq.mts.        |
| MUMTY AREA                                                                   |                  | + 15.603              | = 15.603     | sq.mts.        |
| <b>TOTAL ALL FLOOR AREA (FAR AREA + NON FAR AREA)</b>                        | <b>= 481.628</b> | <b>sq.mts.</b>        |              |                |

**ELEVATION**



**SECTION**

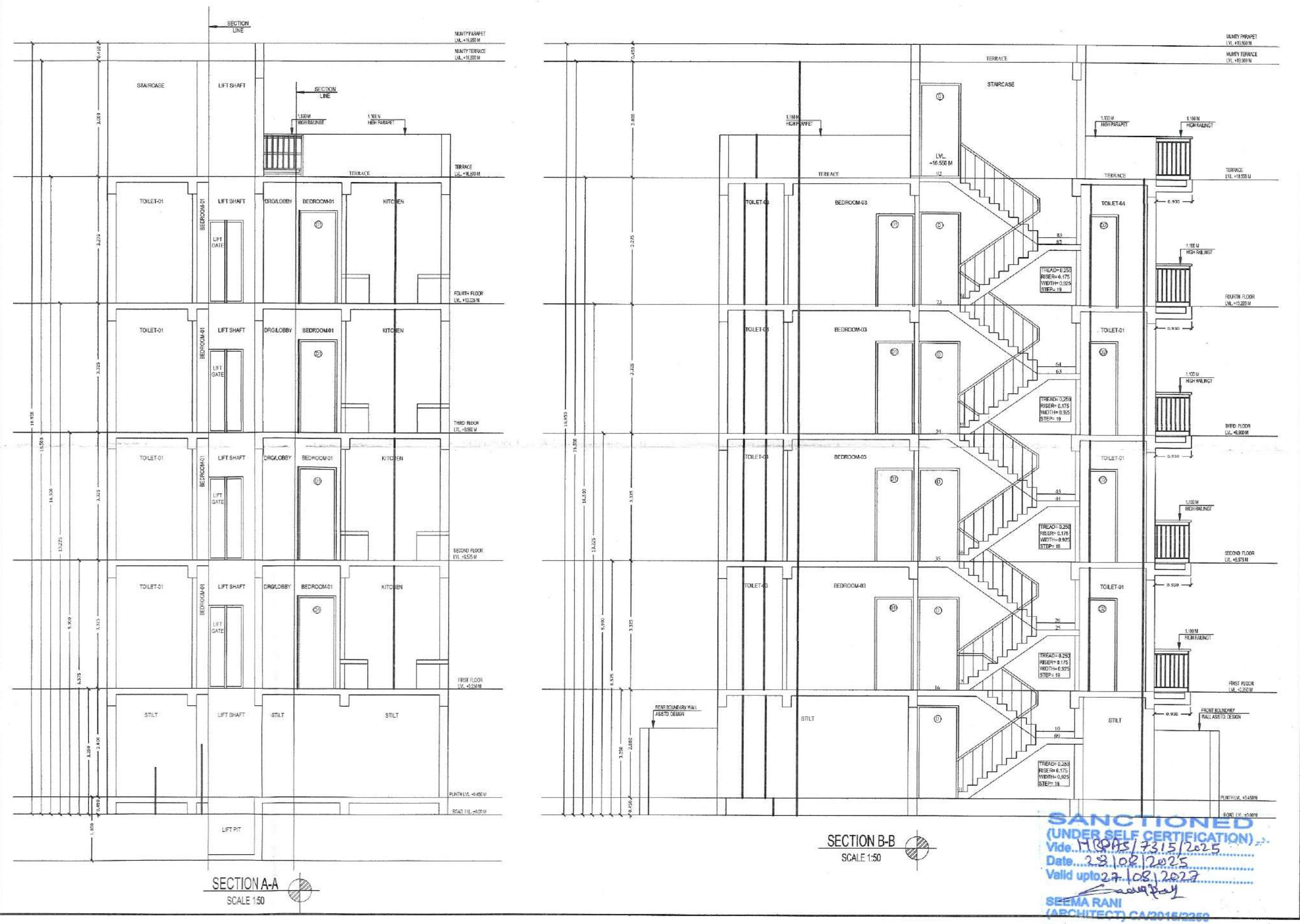

**SANCTIONED**  
(UNDER SELF CERTIFICATION)  
Vide... 23/08/2025  
Date... 23/08/2025  
Valid upto 27/08/2027  
SEEMA RANI  
(ARCHITECT) CA/2015/2259

**OWNER NAME:-** LION INFRADEVELOPERS LLP  
PLOT NO= A-09  
at Sector 06, Sohna, Haryana

**PROJECT NAME:-** RESIDENTIAL PLOTTED COLONY UNDER DDJAY MERASURING 12.505 ACRES (LICENCE NO. 188 OF 2023 DATED 15.09.2023) IN SECTOR-06, SOHNA BEING DEVELOPED BY LION INFRADEVELOPERS LLP.

STILT FLOOR PLAN, FIRST FLOOR PLAN, SECOND FLOOR PLAN, THIRD FLOOR PLAN, FOURTH FLOOR PLAN, TERRACE PLAN, MUMTY PLAN, D/W SCHEDULE, AREA CHART, ELEVATION & SECTION

Dwg. No.- AR/PLOT NO-A/09/SHEET 01 OF 01 Scale 1:50

ARCHITECTS SIGN: *Seema Rani*  
OWNER'S SIGN: *[Signature]*

Signature of Architect  
**SEEMA RANI**  
CA/2015/2259

FOR LION INFRADEVELOPERS LLP  
AUTHORISED SIGNATORY

Drawn by:- PANKAJ KAPOOR Mob. No. - 8800093157