

6 KARAM WIDE REVENUE RASTA/ PROPOSED 24M WIDE ROAD

COMMERCIAL
0.599 ACRE

NALLAH

EXISTING 8 KARAM WIDE REVENUE RASTA SOHNA / BALUDA

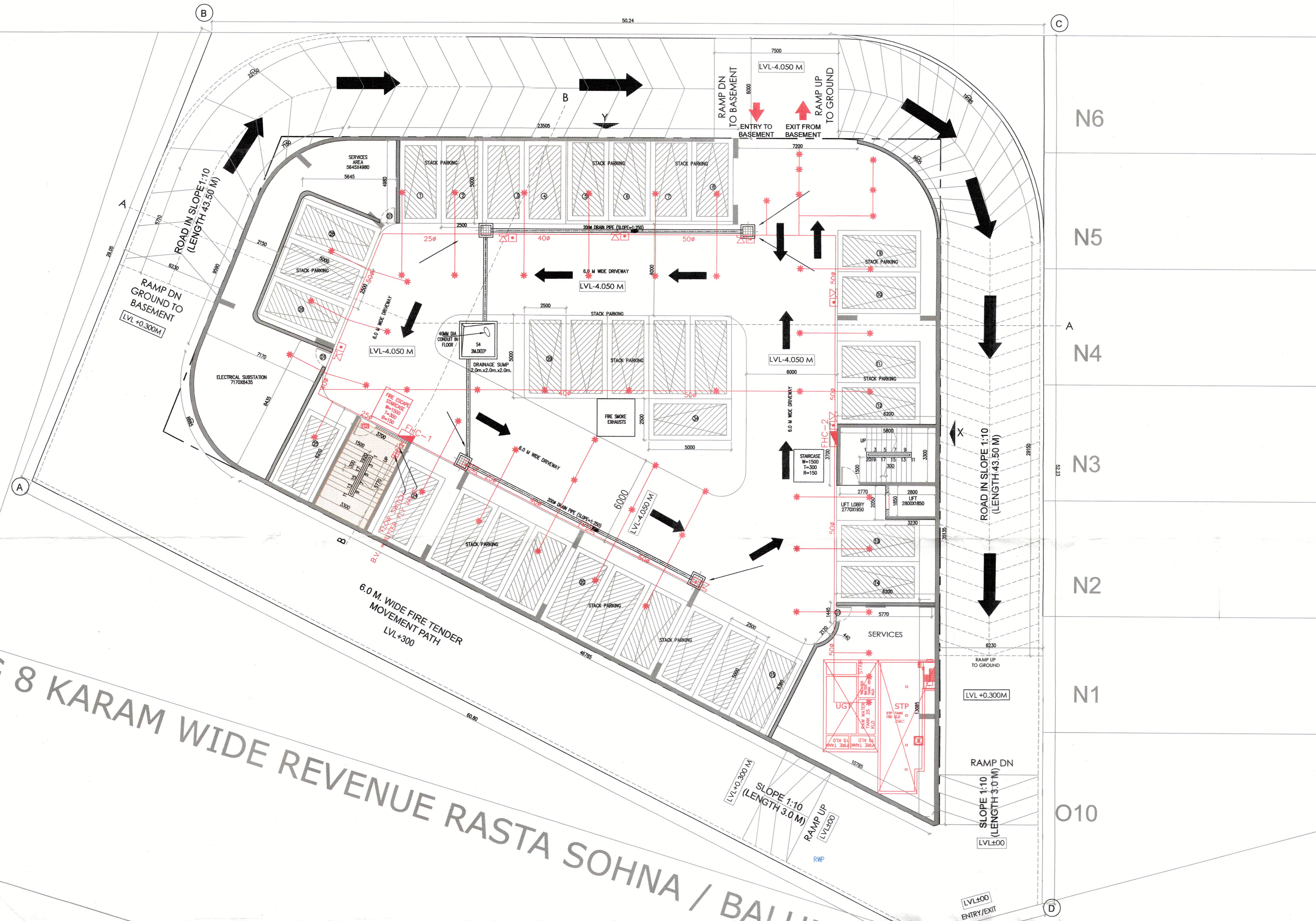

LEGEND

	PENDENT SPRINKLER
	SPRINKLER PIPE
	SMOKE DETECTOR
	4KG ABC FIRE EXTINGUISHER
	4.5KG CO2 FIRE EXTINGUISHER
	MANUAL CALL POINT
	HOOTER
	100mm DOWN COMER WITH SINGLE HYDRANT VALVE, BRANCH PIPE, 2 NOS RRL HOSE (15M LENGTH), 30M LENGTH HOSE REEL (25M DIA) AND FIRE MAN AXES
	FD = FIRE SMOKE CHECK DOOR SIZE = 1.2X2.15M HT. (FOR L.V. SHAFT & ELEC. SHAFT)
	B.V. = BUTTER FLY VALVE
	FLOW SWITCH

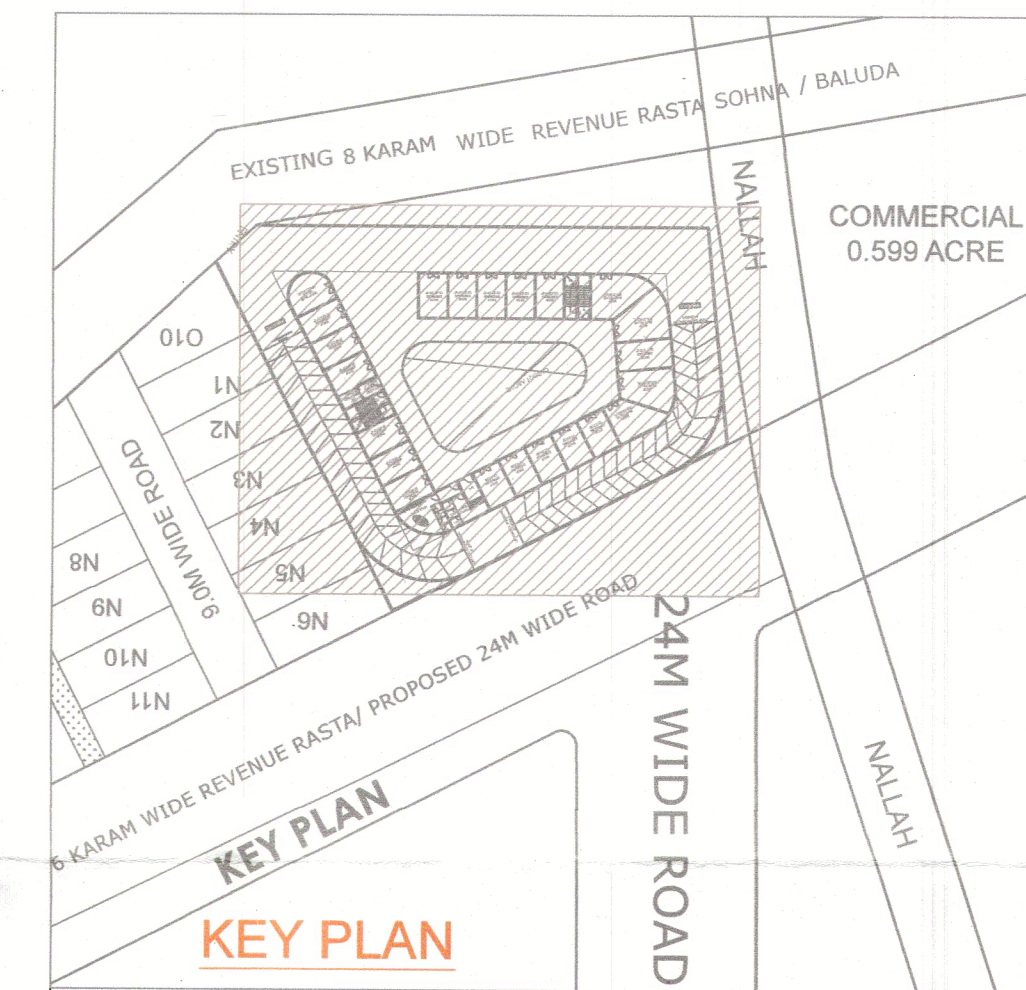

PROJECT :
COMMERCIAL SITE FOR AN AREA MEASURING 2424.0631 SQ MT (0.599 ACRES) FALLING IN AFFORDABLE RESIDENTIAL PLOTTED COLONY (UNDER DEEN DAYAL JAN AWAS YOJNA-2016) MEASURING 15.00 ACRES (LICENSE NO. 65 OF 2019 DATED 08.03.2019) IN SECTOR-5, SOHNA BEING DEVELOPED BY REGIONAL CONSTRUCTION PVT LTD.

ARCHITECT'S SIGNATURE :
OWNER'S SIGNATURE :

ARCHITECT VIKKEY
CA/2017-862/6
Off. No. 313, AKD Tower, Sec-14, Gurgaon, Haryana

DRAWING TITLE : COMMERCIAL

BASEMENT PLAN

SHEET NO.- 02

SCALE :- 1:100

DATE : MAY 2025

COMMERCIAL

NOTE :- THE BUILDING FULL MECHANICAL VENTILATION SYSTEM SHALL BE INSTALLED ON VENTILATION SHAFT WITH 100 % POWER BACK UP.