

ZONING PLAN OF GROUP HOUSING COLONY AREA MEASURING 18.744 ACRES (LICENSE NO. 01. OF 2017 DATED 03/01/2014.) IN SECTOR-33, SOHNA BEING DEVELOPED BY AUM SHRI HOTELS & RESORTS PVT. LTD.
 LC 280a

FOR THE PURPOSE OF RULE 38(xiii) AND 48 (2) OF THE PUNJAB SCHEDULED ROADS AND CONTROLLED AREAS RESTRICTION OF UNREGULATED DEVELOPMENT RULES, 1965.

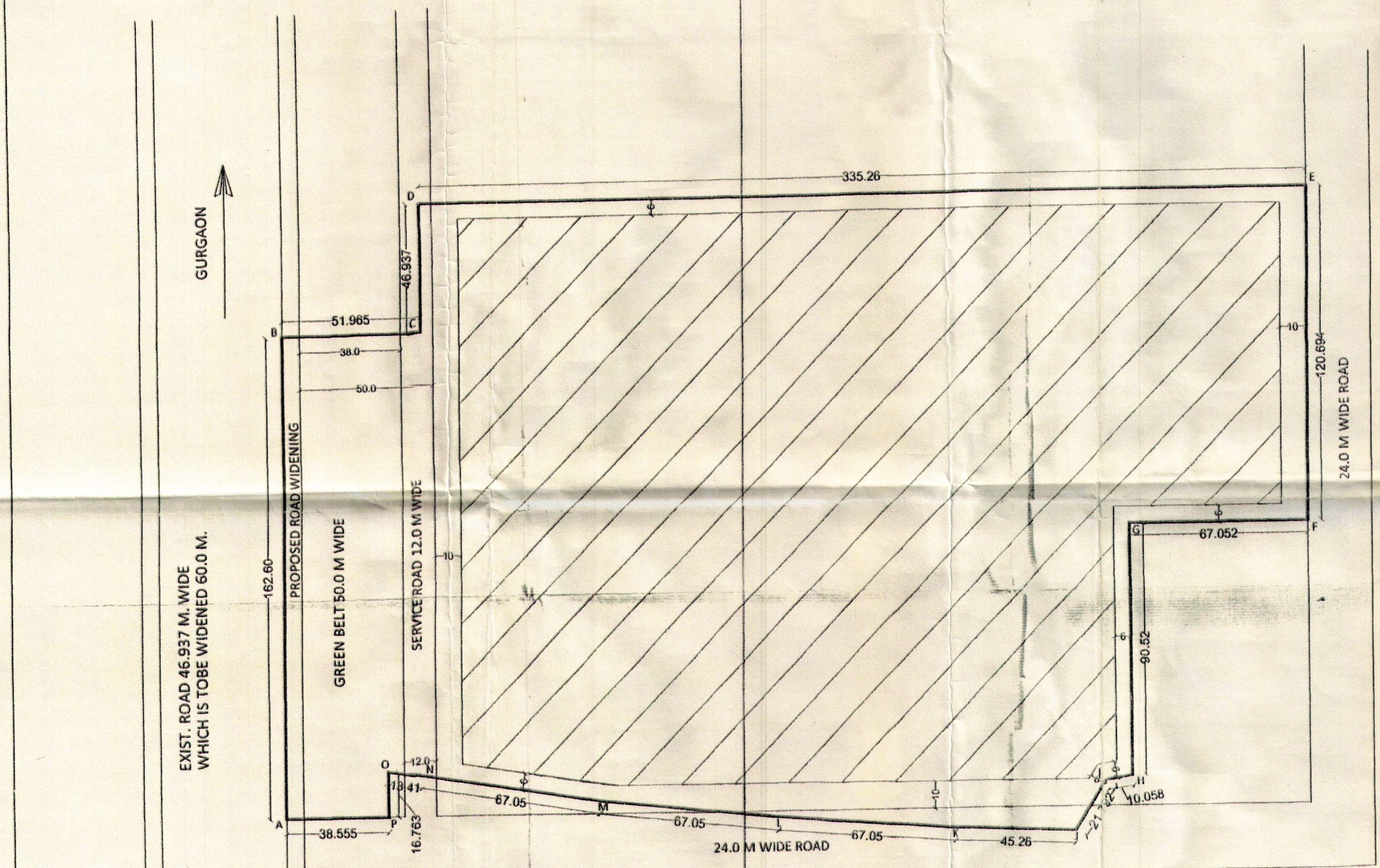

ZONED AREA= 14.2604 ACRES
ALL DIMENSIONS ARE IN METERS

- 1. SHAPE OF SITE**
The shape and size of the Group Housing Colony is in accordance with the demarcation plan shown as A to P as confirmed by DTP, Gurgaon vide L.O. No. 3209 Dated 16.07.2013.
- 2. TYPE OF BUILDING PERMITTED**
The type of building permitted on this site shall be buildings designated in the form of flat development for residential purpose or any ancillary or appurtenant building including community facilities, public amenities and public utility as may be prescribed and approved by the Director General, Town and Country Planning, Haryana.
- 3. GROUND COVERAGE AND FAR**
 - a. Building shall only be permitted within the portion of the site marked as buildable zone and no where else.
 - b. The maximum coverage on ground floor shall be 35% and that on subsequent floors shall be 30% on the area of 17.6175 acres.
 - c. The maximum FAR shall not exceed 1.75 on the area of 17.6175 acres. However, it shall not include community building which shall be as per the prescribed norms, the building plan of which shall have to be got approved from the Director General, Town and Country Planning, Haryana.
- 4. HEIGHT OF BUILDING**
The height of the building block, subject of course to the provisions of the FAR, shall be governed by the following:
 - a. The maximum height of the buildings shall not be more than as allowed by Airport Authority of India and shall not exceed 1.5 times (the width of the road abutting) plus the front open space.
 - b. If a building abuts on two or more streets of different widths, the building shall be deemed to face upon the street that has the greater width and the height of the building shall be regulated by the width of that street and may be continued to its height to a depth of 24M, along the narrow street.
 - c. Building/structure which rise to 30 meters or more in height shall be constructed if no objection certificate has been obtained from the Airport Authority of India.
 - d. All building block(s) shall be constructed so as to maintain an inter-structure set back required for each building according to the table below:

S.No.	HEIGHT OF BUILDING (in meters)	SET BACK / OPEN SPACE TO BE LEFT AROUND BUILDING (in meters)
1	10	3
2	15	5
3	18	6
4	21	7
5	24	8
6	27	9
7	30	10
8	35	11
9	40	12
10	45	13
11	50	14
12	55 & above	16
 - e. To ensure fire safety and structural stability of the buildings of more than 60 meters in height, the developer shall submit the structural drawings duly vetted from reputed Institute like IIT Delhi, IIT Roorkee, PEC Chandigarh or IIT Kanpur etc. Fire Fighting Scheme needs to be vetted by the Institute of Fire Engineers at Gurgaon. These certifications are to be obtained prior to starting the construction work at site.
- 5. SUB-DIVISION OF SITE**
 - a. The site of the Group Housing Colony shall be governed by the Haryana Apartment Ownership Act.
 - b. The site shall not be sub-divided or fragmented in any manner whatsoever.
- 6. GATE POST AND BOUNDARY WALL**
Such boundary wall, settings or their combination, hedges or fences along with gates and gate posts shall be constructed as per design approved by DG, TCP, Haryana. In addition to the gate/gates an additional wicket gate not exceeding 1.25 meters width may be allowed in the front and side boundary wall provided that no main gate shall be allowed to open on the sector road/public open space.
- 7. DENSITY**
 - a. The minimum density of the population provided in the colony shall be 100 PPA and the maximum be 400 PPA on the area of 17.6175 acres.
 - b. For computing the density, the occupancy per main dwelling unit shall be taken as five persons and for service dwelling unit two persons per person per one person per 60 sq. feet of living area whichever is more.
- 8. ACCOMMODATION FOR SERVICE POPULATION**
Adequate accommodation shall be provided for domestic servants and other service population of EWS. The number of such dwelling units for domestic servants shall not be less than 10% of the number of main dwelling units and the carpet area of such a unit if attached to the main units shall not be less than 300 sq. ft. In addition 15% of the total number of dwelling units having a minimum area of 200 sq. ft. shall be reserved for L-1 category.
- 9. PARKING**
 - a. Parking space shall be provided @ 1.5 Equivalent Car Space for each dwelling unit. These parking spaces shall be allotted only to the flat holders and shall not be allotted, leased, sold or transferred in any manner to the third party. The area for parking per car shall be as under:
 - i) Basement. 35 sqm.
 - ii) Stills. 30 sqm.
 - iii) Open. 25 sqm.
 - b. At least 75% of the equivalent car spaces shall be provided in the form of covered parking. Further minimum 5% of the total parking will be made available to the EWS category flats.
 - c. The covered parking in the basement or in the form of multi level parking above ground level shall not be counted towards FAR. However, in case of multi level parking above the ground level the foot print of separate parking building block shall be counted towards ground coverage. In case of provision of mechanical parking in the basement floor/upper stories, the floor to ceiling height of the basement / upper floor may be maximum of 4.5 meter. Other than the mechanical parking the floor to ceiling height in upper floor shall not be more than 2.4mtr. below the hanging level.
- 10. LIFTS AND RAMPS**
Ramps would be optimal in Group Housing building in case of 100% stored by generator, along with automatic switchovers are provided for running of lifts along with stairs. However, in case of buildings having more than four storey lifts with 100% stored by generators along with automatic switchover would be essential. At least one lift shall be provided with minimum size of 1.80 M X 3.00 M. The clear width of the ramp leading to the basement shall be 4.00 meters with an adequate slope not steeper than 1:10. The entry and exit shall be separate preferably at opposite ends.
- 11. OPEN SPACES**
While all the open spaces including those between the blocks and wings of buildings shall be developed, equipped and landscaped according to the plan approved by the DG, TCP, Haryana. At least 15% of the total site area shall be developed as organized open space i.e. for kids and play ground.
- 12. APPROVAL OF BUILDING PLANS**
The building plans of the buildings to be constructed at site shall have to be got approved from the DG, TCP, Haryana (under Section 8(2) of the Act No.41 of 1963), before taking up the construction.
- 13. BUILDING BYE-LAWS**
The construction of the building/buildings shall be governed by the building rules provided in part VII of the Punjab Scheduled Areas, Restriction of Unregulated Development Rules, 1965 and G. Code No. 4863/1987 regarding provisions for Physically Handicapped Persons. The owner shall also follow the provisions of Section 46 of The Persons With Disabilities (Equal Opportunities, Protection of Rights and Full Participation) Act, 1995 which includes construction of ramps in public buildings, eligibility of toilets for wheel chair user, Braille symbols and auditory signals in elevators or lifts and other relevant measures for hospitals, primary health centres and other medical care and rehabilitation units. On the points where such rules are silent and stipulate no condition or norm, the model building bye-law issued by the Haryana Government shall be followed as may be approved by DG, TCP, Haryana.
- 14. CONVENIENT SHOPPING**
0.5% of the area of 17.6175 acres area shall be reserved to cater for essential convenient shopping with the following conditions:
 - a. The ground coverage of 100% with FAR of 100 will be permissible. However this will be a part of the permissible ground coverage and FAR of the Group Housing Colony.
 - b. The size of Kiosk & Shops shall not be more than 2.75 meter x 2.75 meter and 2.75 meter x 8.25 meter is respectively.
 - c. The height of Kiosk/Shop/Commercial Store shall not exceed 4.00 meter.
- 15. PROVISION OF COMMUNITY BUILDINGS**
The community buildings shall be provided as per the composite norms in the Group Housing Colony.
- 16. BASEMENT**
Four level basements within the building zone of the site provided it flushes with the ground and is properly landscaped may be allowed. The basement may in addition to parking could be utilized for generator room, lift room, fire fighting pumps, water reservoir, electric sub-station, air conditioning plant and other utility services. They shall not be used for any other purposes. Area under utility (only for parking) and basement shall not be counted towards FAR. Basement shall not be used for storage/commercial purposes but will be used only for parking and ancillary services of the main building and it is further stipulated that no other partitions of basement will be permissible for uses other than those specified above.
- 17. APPROACH TO SITE**
The vehicular approach to the site and parking lots shall be planned and provided giving due consideration to the junction of and the junction with the surrounding roads to the satisfaction of the DG, TCP, Haryana.
- 18. FIRE SAFETY MEASURES**
 - a. The owner will ensure the provision of proper fire safety measures in the multi storey buildings conforming to the provisions of Rules 136/ NBC and the same should be got certified from the competent authority.
 - b. Electric sub station/generator room if provided should be on solid ground near DGAT. Control panel on ground floor or in upper basement and it should be located on outer periphery of the building, the same should be got approved from the competent authority.
- 19. SOLAR WATER HEATING SYSTEM**
The provision of solar water heating system shall be as per norms specified by HAREDA and shall be made operational at each building block before applying for an occupation certificate.
- 20. RAIN WATER HARVESTING SYSTEM**
The rain water harvesting system shall be provided as per Central Ground Water Authority/Haryana Govt. notification as applicable.
- 21.** The colonizer shall obtain the clearance/NOC as per the provisions of the Notification No. S.O. 1531(E) Dated 14.9.2006 issued by Ministry of Environment and Forest, Government of India before starting the construction/ occupation of the building.
- 22.** The colonizer/owner shall use only Compact Fluorescent Lamps fittings for internal lighting as well as campus lighting.
- 23.** That no separate zoning plan is approved for community sites earmarked within a Group Housing Colony. The community building/buildings shall be constructed by the colonizer/owner as per provision of The Haryana Development and Regulation of Urban Areas (Amendment and Validation) Act No. 4 of 2012, insofar as the said site shall vest with the Government.
- 24.** That the eligibility criteria, guidelines for scrutiny of application and construction/occupation of EWS flats shall be governed by the EWS policy of the Department dated 08.07.2013. Accordingly, the complete scheme for allotment of EWS flats shall be finalised within 4 months from issuance of part occupation certificate of the EWS flats.
- 25.** The colonizer shall ensure the ultimate power load requirement to connected power utility within two months to enable the provision of site for transformer/switching station/electric sub-station as per the norms prescribed by the power utility in your project, site at the time of approval of building plans.

DRG. NO. DG, TCP, 45410 DATED: 06-01-2014
 (KARANDEEP SINGH) (HITENDER BHAG) (J. S. REDHU) (ANURAG KASTOJI, IAS)
 DTP (HQ) STP (H & V) CTP (HR) DG, TCP (HR)

For Three C Properties Private Limited
 Director/Authorized Signatory

PRODUCED BY AN AUTODESK EDUCATIONAL PRODUCT