

RESIDENTIAL COLONY AT FATEHABAD (FORMING PART OF SECTOR-4)

BEING DEVELOPED BY :- M/S AMBROSE REAL ESTATE PVT. Ltd.

1: DETAIL OF LAND :-

TOTAL AREA OF LAND = 51.744 ACS. AREA UNDER DEVELOPMENT PLAN ROAD AND GREEN BELT = 4.408 ACS. TOTAL PLANNED AREA (6 LESS 50% AREA OF UNDER DEV. PLAN ROAD/GREEN BELT) = 49.54 ACS. NEW PLANNED AREA = 24.04 ACS. AREA UNDER PLOTS (NURSING HOMES-23.51) = 1.97 ACS. AREA UNDER COMMERCIAL USE = 26.01 ACS. TOTAL SALEABLE AREA = 52.50 %

DETAIL OF PLOTS :-

Table with 4 columns: TYPE, NOS. OF PLOTS, MAIN UNITS, and %. Rows include A, A1, B, C, D, E, F, and TOTAL.

DENSITY = 301 X 13.5 + 77 X 9 = 4756.5 PERSONS

DENSITY = 4756 / 49.606 = 95.87 P.P.A.

DENSITY = 4756 / 52.50 = 90.68 P.P.A.

INFRASTRUCTURE :-

Table with 2 columns: REQUIRED and PROVIDED. Rows include PRIMARY SCHOOL, NURSERY SCHOOL, TAN STAND, and VEG. & MILK BOOTH.

ARCHITECT: SUDHIR VERMA, 6/11/1972

JOB TITLE: RESIDENTIAL COLONY AT FATEHABAD.

BEING DEVELOPED BY :- M/S AMBROSE REAL ESTATE PVT. Ltd.

SCALE: 1: 1000 DATE: 03-10-2008

DRAWN: L. JOSHI

CHECKED: L. JOSHI

ARCHITECTS & PLANNERS: ECO BASE LAND PROJECTS PVT. LTD. # 288, SECTOR 21-A, CHANDIGARH. TELEPHONE 0172-2701839 FAX. 0172-2706483 e-mail-sudhirverma27@gmail.com

SHEET TITLE: LAYOUT CUM DEMARCATION PLAN DRG NO 02 R

Large table titled '1.DETAILED AREA CALCULATION OF RESIDENTIAL PLOTS' with columns for S.No, Category, Plot Nos, Area, and Total Area.

Table titled 'GREEN AREA :-' listing 21 items with their respective areas and calculations.

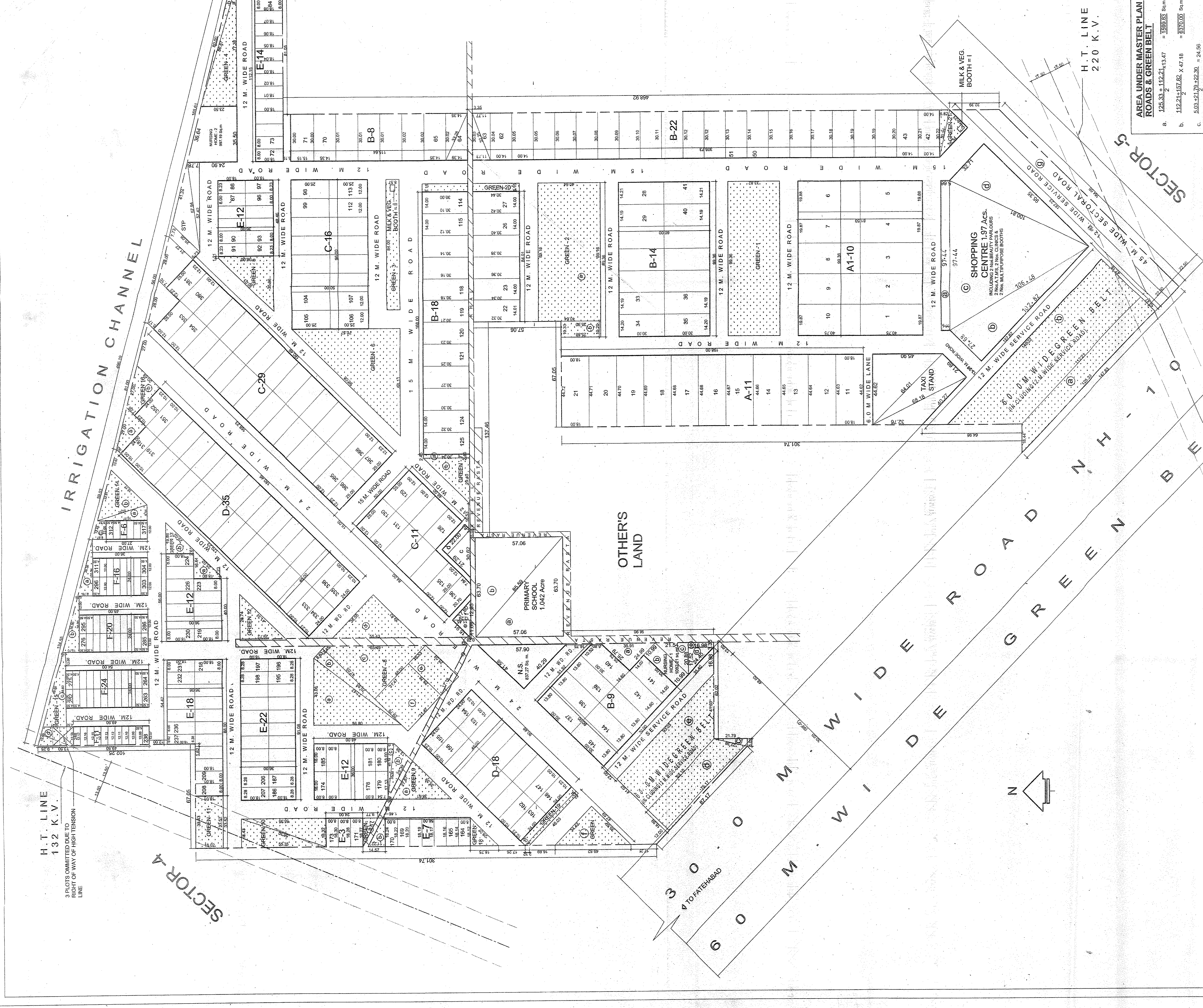

Summary tables and calculations including 'SHOPPING CENTRE', 'NURSING HOME - 1', 'NURSING HOME - 2', 'PRIMARY SCHOOL', and 'NURSERY SCHOOL' with their respective areas and dimensions.