

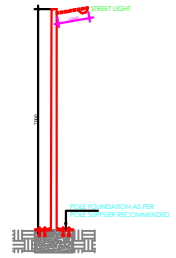

NAME OF PROJECT- **M2K SWASTIK AFFORDABLE PLOTTING HOUSING COLONY UNDER "DDJAY 2016" SECTOR-1, DARUHERA, OWNED BY AVANCER PROPERTIES PVT. LTD.**

NAME OF DRAWING- **PROPOSED - ELECTRICITY SUPPLY PLAN**

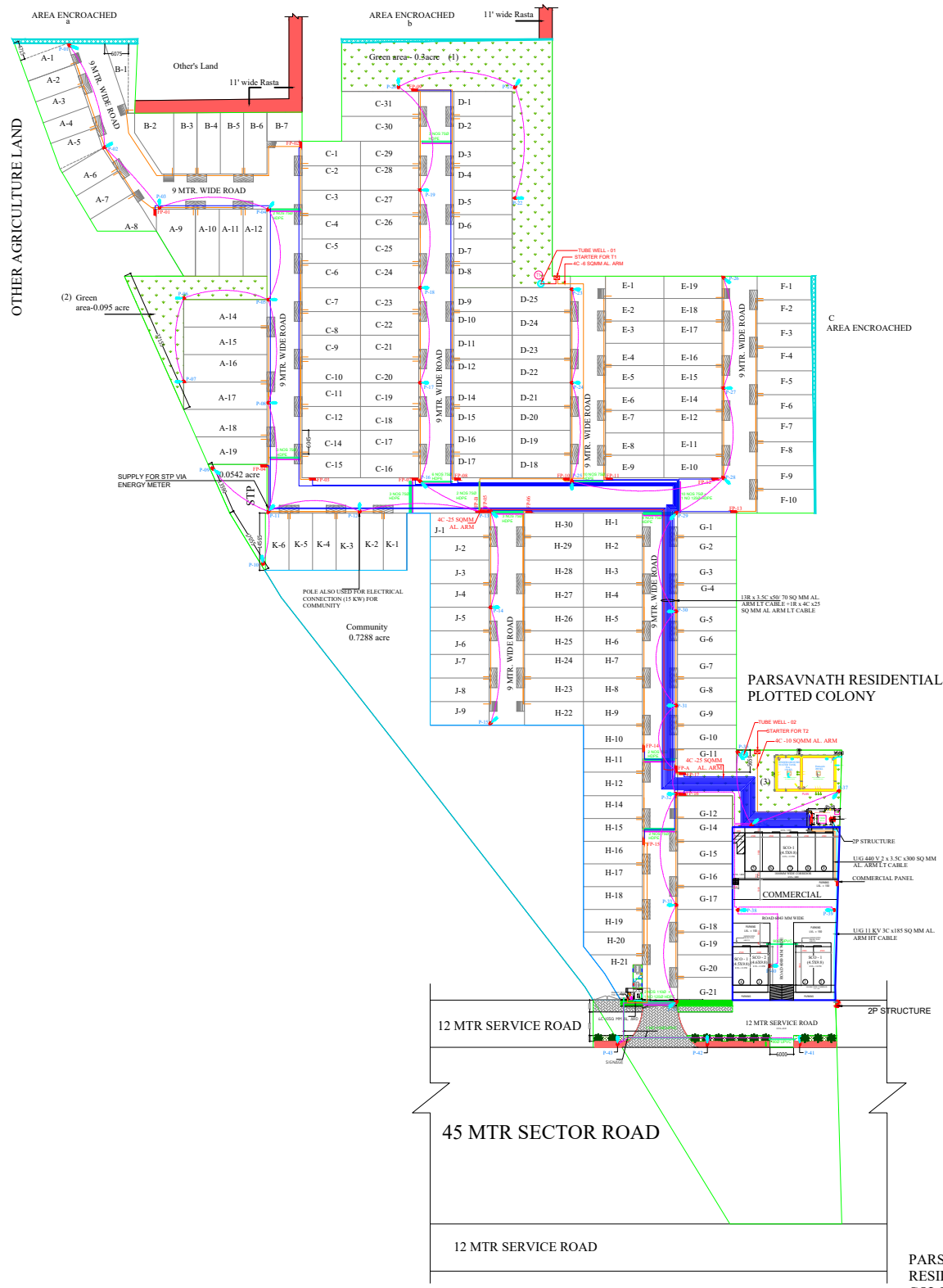

**LEGEND:**

SYM.	DESCRIPTION
	2P STRUCTURE
	7 MTR. MS TUBULAR POLE
	11 KV HT CABLE UNDER GROUND
	LT CABLE
	LT UNDER GROUND CABLE / SERVICE CABLE TO EACH PLOTS
	LT CABLE POLE TO PLOE
	PIPE FOR ELEC. & LV

PARSAVNATH RESIDENTIAL PLOTTED COLONY



NAME OF PROJECT- **M2K SWASTIK AFFORDABLE PLOTTING HOUSING COLONY UNDER "DDJAY 2016" SECTOR-1, DARUHERA, OWNED BY AVANCER PROPERTIES PVT. LTD.**

NAME OF DRAWING- **PROPOSED -WATER SUPPLY PLAN**

AREA STATEMENT			
TOTAL AREA OF THE SCHEME	7.6060	ACRE	.....(A)
AREA FALLING UNDER SECTOR ROAD	0.6360	ACRE	.....(B)
50% AREA FALLING UNDER SECTOR ROAD (B/2)	0.3180	ACRE	.....(C)
ENCROACHMENT AREA	0.024	ACRE	.....(D)
<b>NET PLANNED AREA (NPA) (A-C-D)</b>	<b>7.264</b>	<b>ACRE</b>	
AREA UNDER COMMERCIAL	0.290	ACRE	3.992%
AREA UNDER RESIDENTIAL PLOTS	3.848	ACRE	52.974%
<b>TOTAL SALEABLE AREA</b>	<b>4.138</b>	<b>ACRE</b>	<b>56.966%</b>

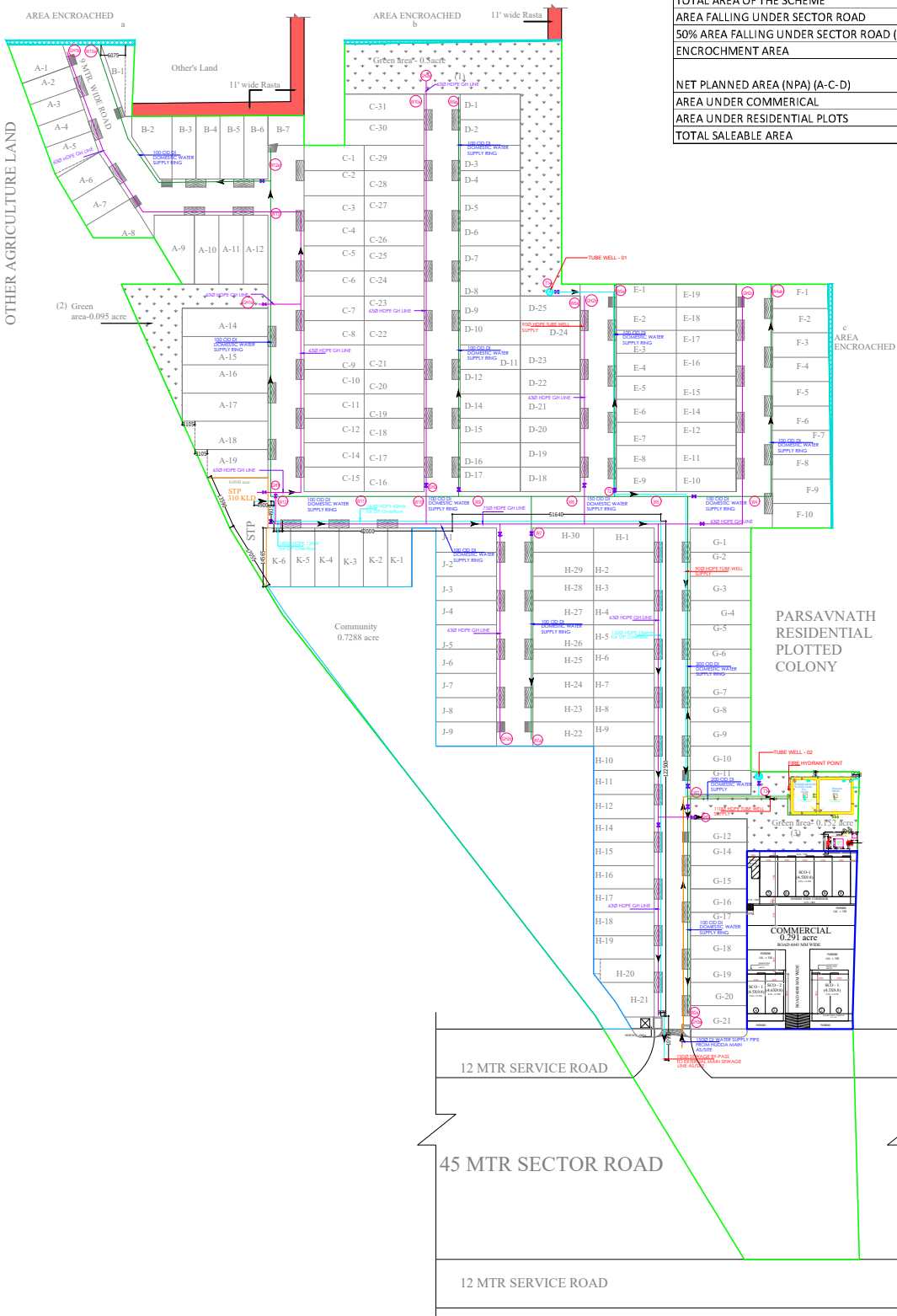

LEGEND	
	DOMESTIC WATER SUPPLY DI
	FLUSHING & IRRIGATION PIPE
	VALVE
	TUBE WELL SUPPLY LINE
	TUBE WELL
	HUIDA SUPPLY
	FIRE HYDRANT POINT

NAME OF PROJECT- **M2K SWASTIK AFFORDABLE PLOTTING HOUSING COLONY UNDER "DDJAY 2016" SECTOR-1, DARUHERA, OWNED BY AVANCER PROPERTIES PVT. LTD.**

NAME OF DRAWING- **PROPOSED - SEWERAGE AND GARBAGE DISPOSAL PLAN**

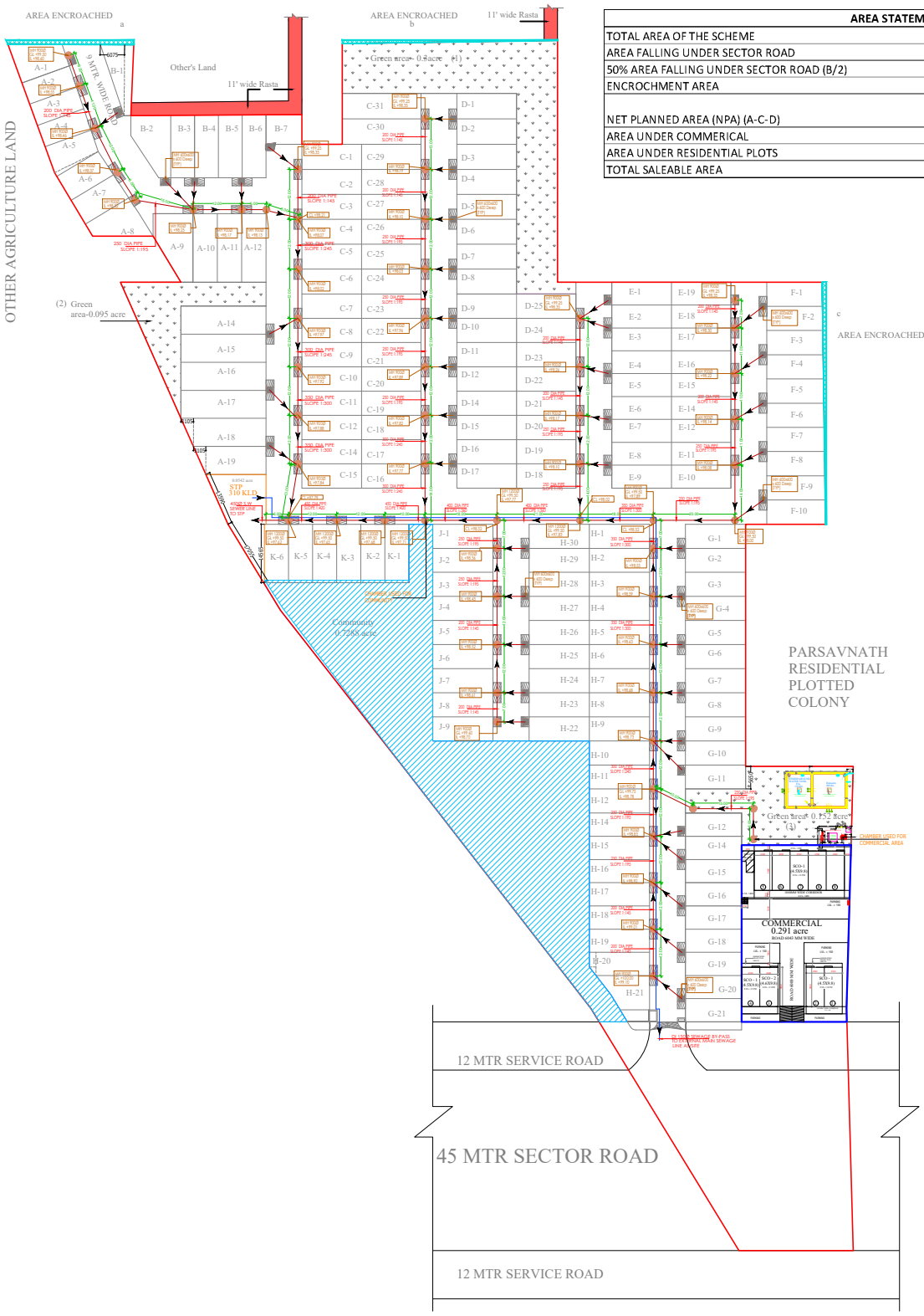

AREA STATEMENT			
TOTAL AREA OF THE SCHEME	7.6060	ACRE	.....(A)
AREA FALLING UNDER SECTOR ROAD	0.6360	ACRE	.....(B)
50% AREA FALLING UNDER SECTOR ROAD (B/2)	0.3180	ACRE	.....(C)
ENCROCHMENT AREA	0.024	ACRE	.....(D)
<b>NET PLANNED AREA (NPA) (A-C-D)</b>			
AREA UNDER COMMERCIAL	0.290	ACRE	3.992%
AREA UNDER RESIDENTIAL PLOTS	3.848	ACRE	52.974%
TOTAL SALEABLE AREA	4.138	ACRE	56.966%

LEGEND	
	SEWERAGE LINE
	MANHOLE
GL	GROUND LEVEL
EL	RIVER LEVEL
CL	CONNECTION LEVEL
	OVER FLOW LINE

NAME OF PROJECT- **M2K SWASTIK AFFORDABLE PLOTTING HOUSING COLONY UNDER "DDJAY 2016" SECTOR-1, DARUHERA, OWNED BY AVANCER PROPERTIES PVT. LTD.**

NAME OF DRAWING- **PROPOSED - STORM WATER DRAINAGE**

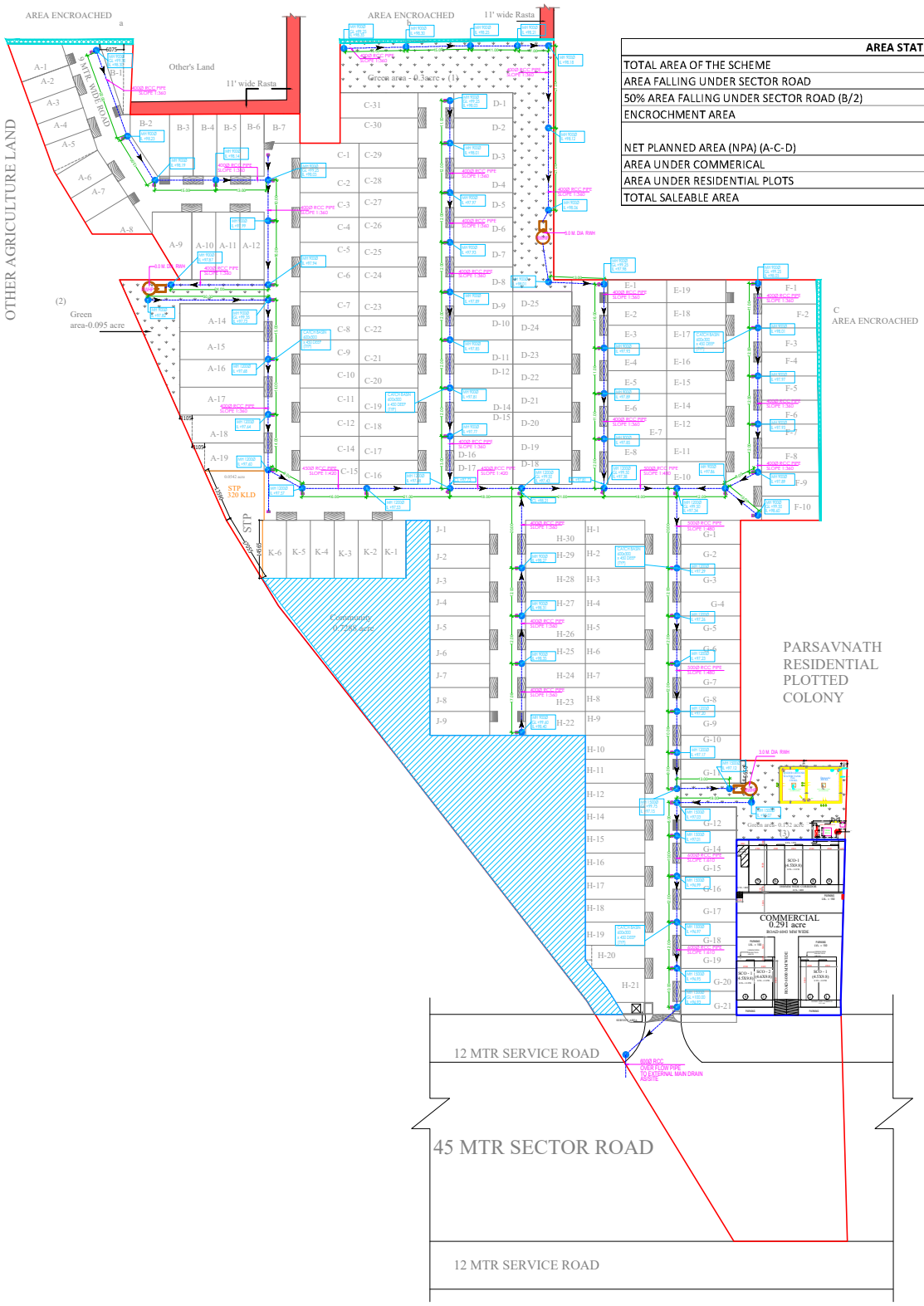

AREA STATEMENT			
TOTAL AREA OF THE SCHEME	7.6060	ACRE	.....(A)
AREA FALLING UNDER SECTOR ROAD	0.6360	ACRE	.....(B)
50% AREA FALLING UNDER SECTOR ROAD (B/2)	0.3180	ACRE	.....(C)
ENCROCHMENT AREA	0.024	ACRE	.....(D)
<b>NET PLANNED AREA (NPA) (A-C-D)</b>	<b>7.264</b>	<b>ACRE</b>	
AREA UNDER COMMERCIAL	0.290	ACRE	3.992%
AREA UNDER RESIDENTIAL PLOTS	3.848	ACRE	52.974%
<b>TOTAL SALEABLE AREA</b>	<b>4.138</b>	<b>ACRE</b>	<b>56.966%</b>

LEGEND	
	STORM WATER LINE
	MANHOLE
	RAIN WATER HARVESTING PIT
	GROUND LEVEL
	INVERT LEVEL
	CONNECTION LEVEL
	CATCH BASIN



NAME OF PROJECT- **M2K SWASTIK AFFORDABLE PLOTTING HOUSING COLONY UNDER "DDJAY 2016" SECTOR-1, DARUHERA, OWNED BY AVANCER PROPERTIES PVT. LTD.**

NAME OF DRAWING- **PROPOSED - 10% LAND TO BE TRANSFERRED TO THE GOVT. FOR COMMUNITY FACILITY**

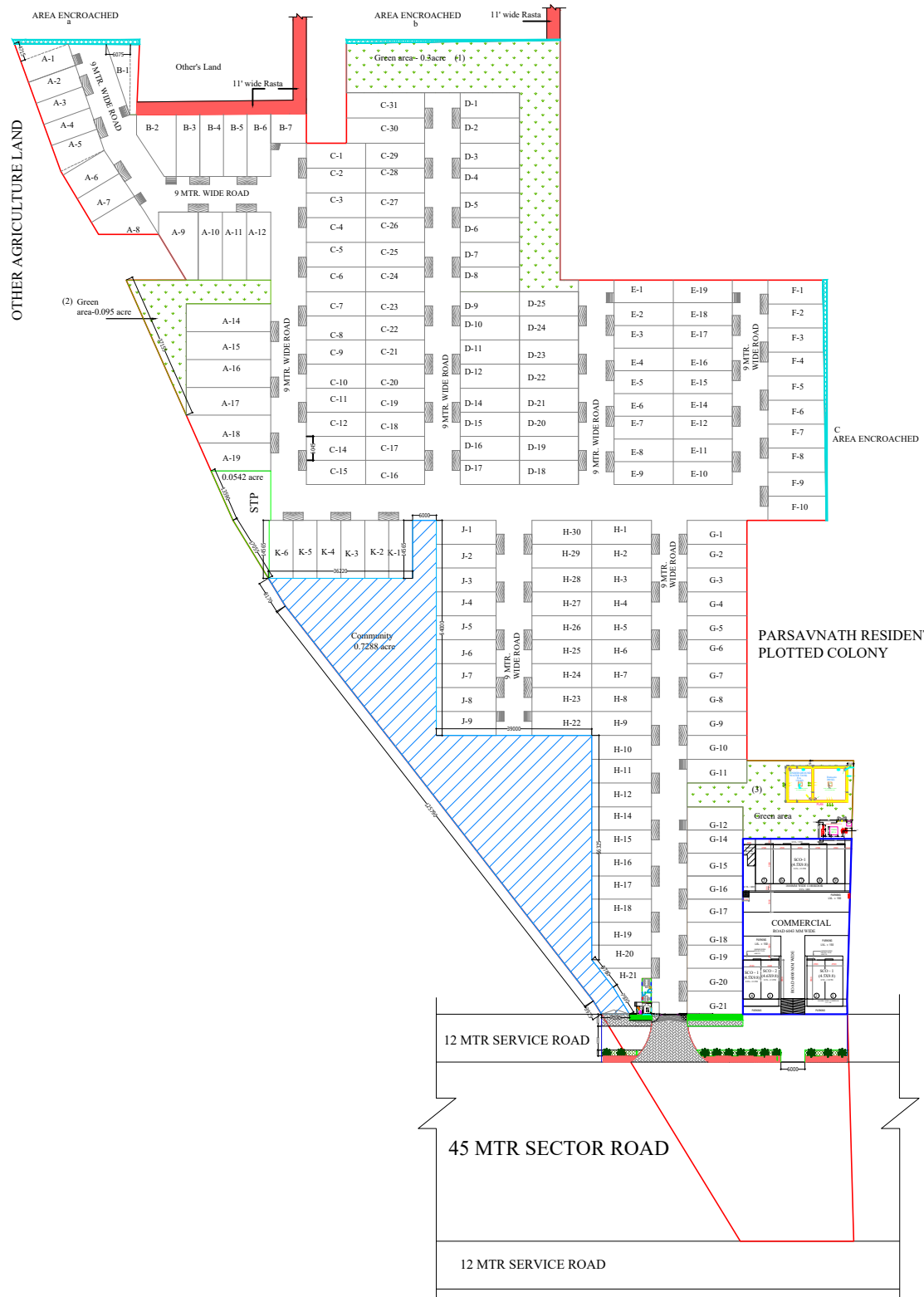

LEGEND :-  
 Community area (0.7288 acre)

10% LAND TO BE TRANSFERRED TO THE GOVT. FOR COMMUNITY FACILITY



NAME OF PROJECT- **M2K SWASTIK AFFORDABLE PLOTTING HOUSING COLONY UNDER "DDJAY 2016" SECTOR-1, DARUHERA, OWNED BY AVANCER PROPERTIES PVT. LTD.**

NAME OF DRAWING- **PROPOSED - STREET LIGHTING PLAN**

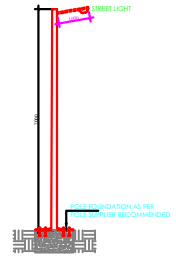
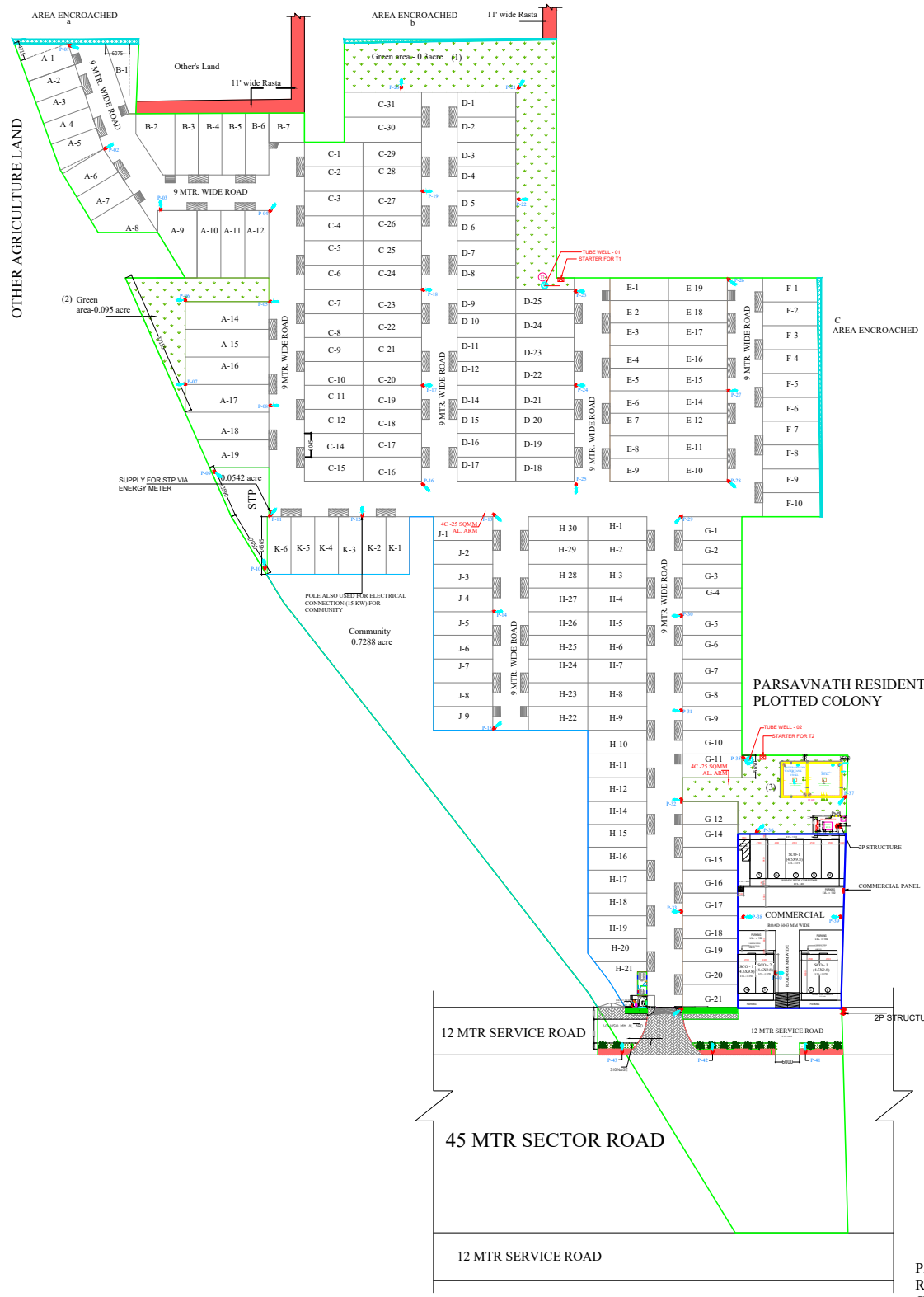

**LEGEND:**

SYM.	DESCRIPTION
	2P STRUCTURE
	MS TUBULAR POLE

PARSAVNATH RESIDENTIAL PLOTTED COLONY

