

NOTES:

1. AUTOMATIC DETECTOR SYSTEM SHALL BE PROVIDED AS PER N.B.C.
2. FIRE ALARM SYSTEM SHALL BE AS PER N.B.C.
3. SEPARATE DUCT SHALL BE PROVIDED FOR ELECTRICAL FITTING AND FIRE FIGHTING INSULATION.
4. FIRE ESCAPE STAIRCASE SHALL BE 2 HOURS.
5. ENTIRE BUILDING SHALL BE AUTOMATIC SPRINKLERED.
6. 1/2" WATER TANK OF 20000 LITERS.
7. DIESEL GENERATOR SHALL BE PROVIDED AS PER N.B.C.
8. DIESEL PUMP AND ONE DIESEL PUMP OF 180 L.P.M.
9. DIESEL PUMP AND ONE DIESEL PUMP OF 180 L.P.M.
10. REFUGEE AREA SHALL BE PROVIDED AS PER N.B.C.
11. ALL FIRE PROTECTION SYSTEM SHALL BE AS PER N.B.C. AND FIRE FIGHTING EQUIPMENT SHALL BE OF U.S. MAKE.

BLOCK	A	B	C	D	TOTAL
THIRD FLS	2851.171	1852.573	1874.428		6578.172
SECOND FLS	2851.171	1852.573	1874.428		6578.172
FIRST FLS	2851.171	1852.573	1874.428		6578.172
TOTAL	15122.261	11611.40	3888.888		29622.55

AREA CALCULATION:

Plot Area = 8.24 Acres (35316.01 SQ.M.)

PERM. GROUND COVERAGE @ 4% = 1333.056 SQ.M.

COMMERCIAL @ 4% = 1333.056 SQ.M.

F.A.R. FOR COMMERCIAL @ 150 = 2000.983 SQ.M.

F.A.R. FOR RESID. = 800.000 SQ.M.

TOTAL PERMISSIBLE F.A.R. = 2800.983 SQ.M.

TOTAL PERMISSIBLE F.A.R. = 2800.983 SQ.M.

PROPOSED GROUND COVERAGE (SQ.M.) (STILT VL.)

BLOCK	A	B	C	D	TOTAL
STILT FLOOR-1	178.961	224.928	163.971		567.860
GROUND FLOOR	2862.453	3071.008	2771.84		8705.305
FIRST FLOOR	2862.453	3071.008	2771.84		8705.305
SECOND FLOOR	2862.453	3071.008	2771.84		8705.305
THIRD FLOOR	2862.453	3071.008	2771.84		8705.305
FOURTH FLOOR	2862.453	3071.008	2771.84		8705.305
FIFTH FLOOR	2862.453	3071.008	2771.84		8705.305
SIXTH FLOOR	2862.453	3071.008	2771.84		8705.305
SEVENTH FLOOR	2862.453	3071.008	2771.84		8705.305
EIGHTH FLOOR	2862.453	3071.008	2771.84		8705.305
NINTH FLOOR	2862.453	3071.008	2771.84		8705.305
TENTH FLOOR	2862.453	3071.008	2771.84		8705.305
ELEVENTH FLOOR	2862.453	3071.008	2771.84		8705.305
TWELFTH FLOOR	2862.453	3071.008	2771.84		8705.305
THIRTEENTH FLOOR	2862.453	3071.008	2771.84		8705.305
FOURTEENTH FLOOR	2862.453	3071.008	2771.84		8705.305
FIFTEENTH FLOOR	2862.453	3071.008	2771.84		8705.305
TOTAL F.A.R.	46159.17	32798.231	3066.462		82077.553

PARKING CALCULATION

1. TOTAL F.A.R. = 82077.553 SQ.M.

REQUIRED PARKING @ 40 SQ.M. OF COVD. AREA = 2051.939

PROPOSED CAR PARKING THIRD FLOOR = 252.335 SQ.M. = 64.56 OR 65 NOS.

SECOND BASEMENT AREA = 1702.847 (MINUS 15% AREA FOR SERVICES) = 1448.864 SQ.M. = 413.52 OR 413 NOS.

FIRST BASEMENT AREA = 1702.847 (MINUS 15% AREA FOR SERVICES) = 1448.864 SQ.M. = 413.52 OR 413 NOS.

STILT LEVEL = 2212.018 SQ.M. = 758.90 OR 759 NOS.

MULTI LEVEL PARKING = 11238.80 SQ.M. = 374.56 OR 375 NOS.

SURFACE PAR. = 80.30 SQ.M. = 80.30 NOS.

TOTAL PROPOSED PARKING = 6541.413 (759+413+375+80.30) = 2167.113

OWNERS SEAL & SIGNATURE

ARCHITECTS SEAL & SIGNATURE

PROJECT:
IT PARK MEASURING 8.5 ACES IN REVENUE ESTATE OF VILLAGE ANANGPUR TEHSIL AND DISTRICT FARIDABAD HARYANA BELONGS TO 'MIS DOVE INFRASTRUCTURE PVT.LTD.

FOR: MIS DOVE INFRASTRUCTURE PVT.LTD.

DRAWING TITLE: SITE PLAN

DATE: APRIL-2009

SCALE: 1:400

DRAWING NO: O1

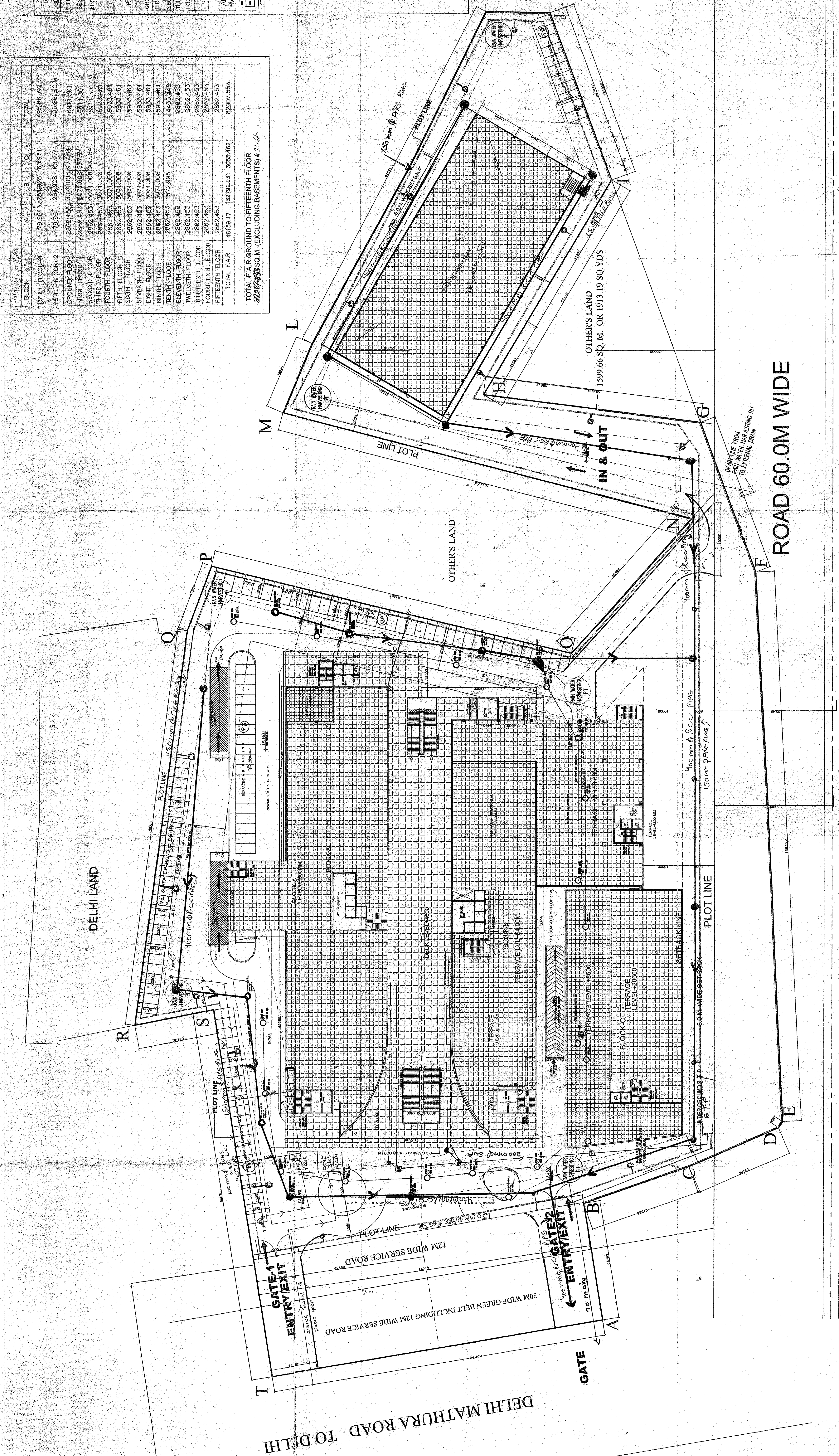

DELHI LAND

DELHI MATHURA ROAD TO DELHI

MATHURA ROAD

ROAD 60.0M WIDE

OTHERS LAND

1599.66 SQ. M. OR 1913.19 SQ. YDS

IN & OUT

150mm dia fire line

100mm dia R.C.C. pipe

8.0M WATER-SUPPLY

GATE-1 ENTRY EXIT

GATE-2 ENTRY EXIT

BLOCK C

BLOCK D

150mm dia fire line

100mm dia R.C.C. pipe

8.0M WATER-SUPPLY