

REVISED AND ADDITIONAL LAYOUT PLAN OF RESIDENTIAL COLONY MEASURING 26.218 + 4.975 = 31.193 ACRES AT RATIA DISTT. FATEHABAD BEING DEVELOPED BY M/S AKASH GANGA TOWNSHIP PVT. LTD.

Area	Area	No's	Total Area	Total No's
AREA UNDER COMMERCIAL	1.019 Acres	26	10192.00 Sq.mt	26
AREA UNDER PLOTS	15.611 Acres	28	6300.00 Sq.mt	100
AREA UNDER NURSING HOME	0.495 Acres	1	2700.00 Sq.mt	1
TOTAL SALEABLE AREA	17.295 Acres	55	19592.00 Sq.mt	127
NEW PROPOSED PLOTS & AREA	14.901 Acres	10	500.00 Sq.mt	60
ALREADY APPROVED	2.394 Acres	12	4271.88 Sq.mt	12
TOTAL PLOTS & AREA	20.196 Acres	65	24563.88 Sq.mt	187

Category	Area	No's	Total Area	Total No's
ALREADY APPROVED	2.394 Acres	12	4271.88 Sq.mt	12
NEW PROPOSED	14.901 Acres	10	500.00 Sq.mt	60
TOTAL	17.295 Acres	22	4771.88 Sq.mt	72

OWNER:
For Akashganga Township Pvt Ltd
Auth. Sign: [Signature]

ARCHITECT:
AR. ANITA SHARMA
CA No. 30575/2003
Ph. No. 9417350590

Category	Area	No's	Total Area	Total No's
ALREADY APPROVED	1.43 Acres	22.97%	1.143 Acres	22.97%
NEW PROPOSED	5.45%	1.143 Acres	22.97%	8.25%
TOTAL	6.88%	2.2874%	2.2874 Acres	8.25%

COMMUNITY SITES IN PLOTTED:

COMMUNITY SITES	REQUIRED	PROVIDED
1. NURSERY SCHOOL	1	1
2. TAXI STAND	1	1
3. CLINIC 250 Sq.m each	2	2
4. A.T.M 12 Sq.m each	2	2
5. BEAUTY PARLOUR 12 Sq.m each	2	2
6. MULTI PURPOSE BOOTH 5.0 M x 5.50 M	2	2
7. MILK & VEG BOOTH 1000 sq. m each	2	2

DENSITY CALCULATION
= (240 X 13.50) + (60 X 9) = 3240.00 + 540 = 3780.00 + 31.193 = 121.181 PPA
OR 298.438 PPH against 300 PPH permissible

AREAS UNDER GREEN
ALREADY APPROVED 1.43 ACRES MORE THEN 1%
NEW PROPOSED 5.45% MORE THEN 1%
TOTAL GREEN 6.88% MORE THEN 1%

LEGEND:

- NEW ADDITIONAL LAND
- AREA ALREADY APPROVED
- PROPOSED / REVISED PLOTS
- WATER COURSE
- REVENUE RASTA

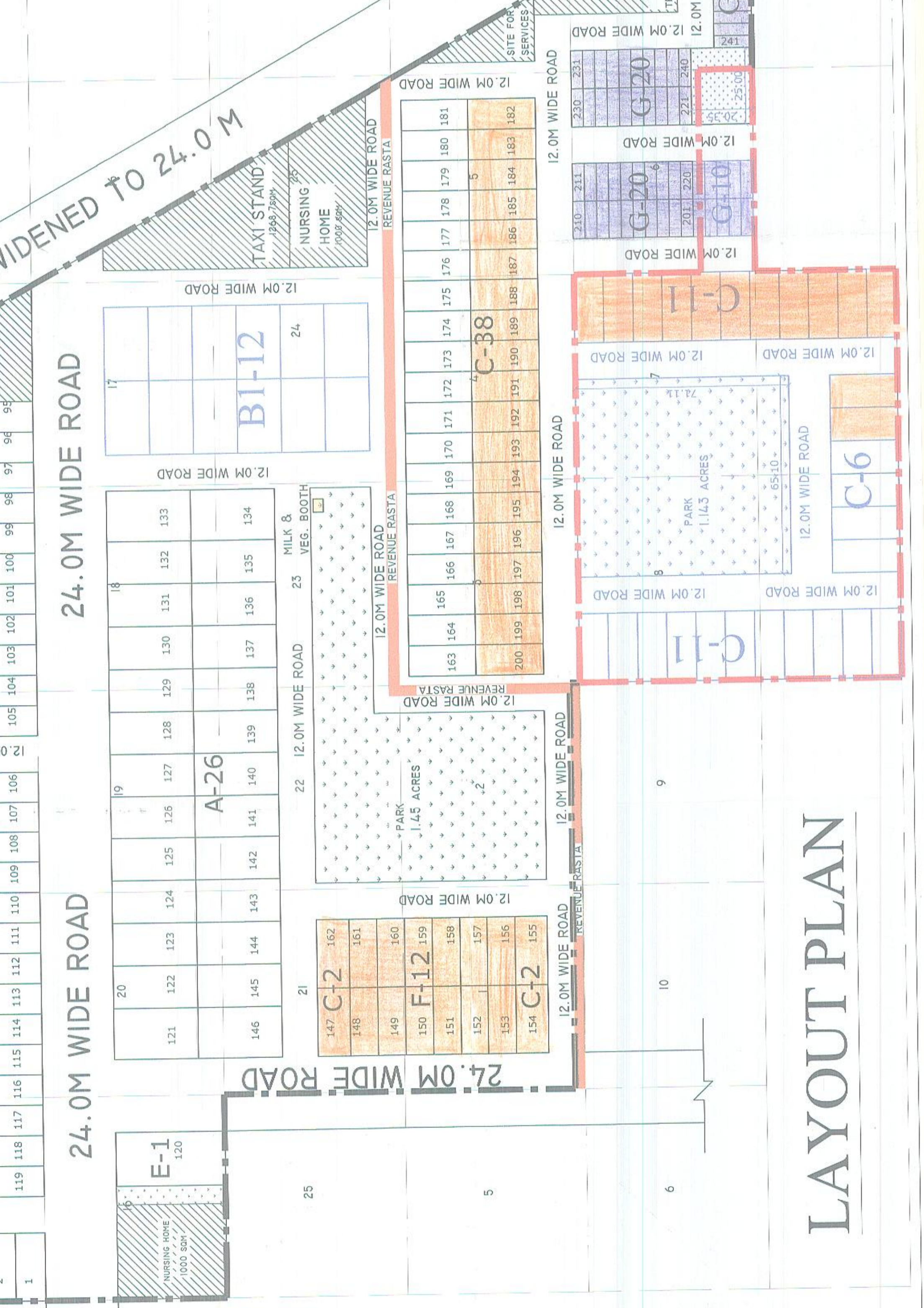

LAYOUT PLAN

APPROVED BY:

(Sanjay Kumar) DTP (HD)
(Rajendra Kumar) AIP (HD)
(Rajendra Kumar) AIP (HD)
(Rajendra Kumar) AIP (HD)
(Rajendra Kumar) AIP (HD)

DATE: 11/11/2016

PROJECT NO.: 19/10/2016-59