

NORTH

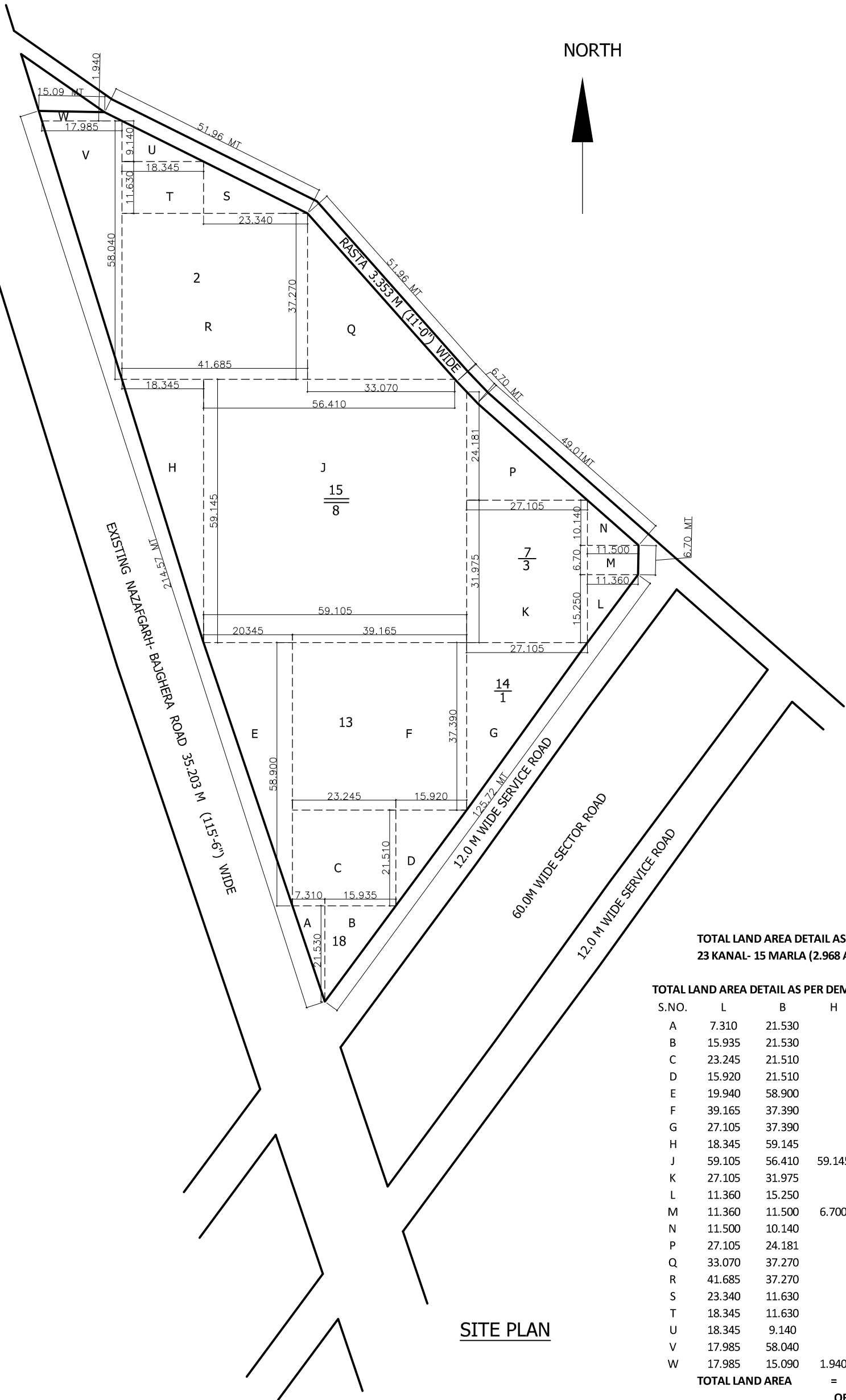

TOTAL LAND AREA DETAIL AS PER L.O.I =  
23 KANAL- 15 MARLA (2.968 ACRES)

TOTAL LAND AREA DETAIL AS PER DEMARCATION

S.NO.	L	B	H	AREA	FORMULA
A	7.310	21.530		78.69	(LXB)/2
B	15.935	21.530		171.54	(LXB)/2
C	23.245	21.510		500.00	LXB
D	15.920	21.510		171.22	(LXB)/2
E	19.940	58.900		587.23	(LXB)/2
F	39.165	37.390		1464.38	LXB
G	27.105	37.390		506.73	(LXB)/2
H	18.345	59.145		542.51	(LXB)/2
J	59.105	56.410	59.145	3416.07	(L+B)/2XH
K	27.105	31.975		866.68	LXB
L	11.360	15.250		86.62	(LXB)/2
M	11.360	11.500	6.700	76.58	(L+B)/2XH
N	11.500	10.140		58.31	(LXB)/2
P	27.105	24.181		327.71	(LXB)/2
Q	33.070	37.270		616.26	(LXB)/2
R	41.685	37.270		1553.60	LXB
S	23.340	11.630		135.72	(LXB)/2
T	18.345	11.630		213.35	LXB
U	18.345	9.140		83.84	(LXB)/2
V	17.985	58.040		521.92	(LXB)/2
W	17.985	15.090	1.940	32.08	(L+B)/2XH
<b>TOTAL LAND AREA</b>				<b>=</b>	<b>12011.05 SQ. MTS</b>
				<b>OR</b>	<b>2.968 ACRES</b>

**SITE PLAN**

DEMARICATION PLAN FOR PORPOSED COMMERCIAL COLONY  
ON LAND BEARING MUSTIL No. 15, KHASRA NO. 2, 7/3, 8, 13,  
14/1, 18 VILLAGE BAJGHARA, SECTOR- 114, TEHSIL & DISTT.  
GURGAON.  
BEING DEVELOPED BY  
M/S AMD ESTATE & DEVELOPERS (P) LTD.