

(RAM AVATAR BASSI) A.D.
 (BALWANT SINGH) S.D.
 Checked and found ok for Public Health (Internal) Service only subject to the conditions in Form No. 39801 dated 28/11/18
 Superintending Engineer (HO)
 28/11/18
 A.D.F.O. (HQ) DFS PKL Member B.P.C.

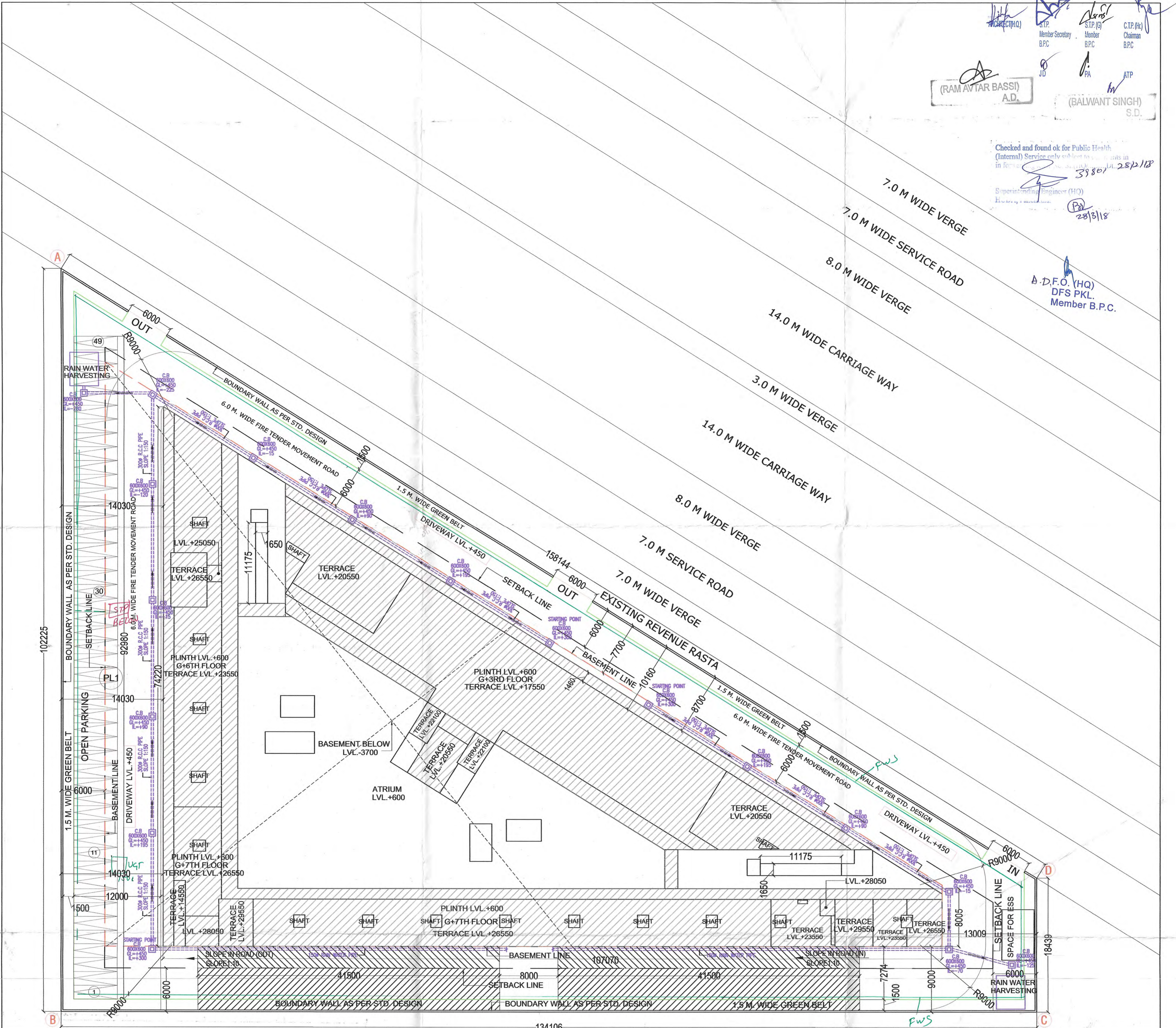

AREA STATEMENT
 TOTAL PLOT AREA = (2.0 ACRES) = 8093.700 SQMT.
 PERM. GROUND COVERAGE @ 60% = 4856.220 SQMT.
 PERM. F.A.R @ 150% = 12140.550 SQMT.

S. NO.	FLOOR LVL.	FAR AREA	NON FAR AREA	TOTAL PROJECT /BUILTUP AREA
1	GROUND FLOOR	2975.503	1182.36	4157.863
2	FIRST FLOOR	2384.832	128.867	2513.699
3	SECOND FLOOR	1123.644	1116.285	2239.929
4	THIRD FLOOR	1946.564	128.867	2075.431
5	FOURTH FLOOR	936.507	96.235	1032.742
6	FIFTH FLOOR	1268.297	96.235	1364.532
7	SIXTH FLOOR	936.507	96.235	1032.742
8	SEVENTH FLOOR	567.161	63.362	630.523
9	BASEMENT FLOOR		5116.368	5116.368
10	MUMTY & MACHINE ROOM		209.482	202.898
11	TOTAL FAR AREA	12139.015		
12	TOTAL NON FAR AREA		8234.296	20366.727

PROP. COVD. AREA UNDER GROUND COVERAGE = 4157.863 SQMT.
 GROUND COVERAGE ACHIVED = 51.37 %
 PROP. COVD. AREA UNDER FAR = 12139.015 SQMT.
 F.A.R ACHIVED 149.98 %
 NON FAR AREA = 8234.296 SQMT.
 TOTAL BUILTUP AREA = 20366.727 SQMT.

PARKING REQ. @ 1 CAR PARKING ON EVERY 50 SQMT. OF FAR AREA = 12140.550/50 = 242.81 SAY 243 NOS.
 SURFACE PARKING REQ. @ 15% OF TOTAL PARKING = 36.45 SAY = 36 NOS
 PARKING PROVIDED IN BASEMENT = 5116.368 - 1079.864(SERVICES AREA) = 4036.503/33= 122.31 SAYS 122 NOS
 ACTUAL PARKING PROVIDED = 102 NOS
 MACHINICA PARKING PROVIDED IN BASEMENT = 102 NOS
 OPEN PARKING PROVIDED = 1115.760/23= 48.5 SAYS 49 NOS
 TOTAL CAR PROVIDED = 102+102+49 = 253 NOS

S. NO.	S.NO	NO.S	LENGTH(L)	WIDTH(W)	HEIGHT(H)	POLYLINE	FORMULA	AREA (SQM.)
1	PL1	1	12.000	92.980		RECTANGLE	LXW	1115.760
	TOTAL							1115.760

SANITARY REQUIREMENT CALCULATION
 TOTAL COMMERCIAL AREA = 6349.858
 GROUND FLOOR AREA = 2975.503
 POPULATION @ 3 PERSON PER SQMT. = 982
 FIRST FLOOR AREA = 2384.832
 POPULATION @ 6 PERSON PER SQMT. = 397
 SECOND FLOOR AREA = 1123.644
 POPULATION @ 6 PERSON PER SQMT. = 187
 TOTAL POPULATION = 1576
 MEN @ 60% = 946
 WOMEN @ 40% = 630

GENTS			
W.C	1 Per 200 up to 400 Over	W.B.	1 Per 200 up to 400 Over
REQUIREMENT AS PER NBC	400 add 1 per over 250 or part thereof	REQUIREMENT AS PER NBC	400 add 1 per over 250 or part thereof
5 Nos.		5 Nos.	
PROPOSED	9 Nos.	PROPOSED	9 Nos.
URINALS			
REQUIREMENT AS PER NBC		1 Per 50	
19 Nos.		36 Nos.	
LADIES			
W.C	1 Per 100 up to 200 Over	W.B.	1 Per 100 up to 200 Over
REQUIREMENT AS PER NBC	200 Add 1 per over 150 or part thereof	REQUIREMENT AS PER NBC	200 Add 1 per over 150 or part thereof
5 Nos.		5 Nos.	
PROPOSED	12 Nos.	PROPOSED	15 Nos.
URINALS			
REQUIREMENT AS PER NBC		N.A.	
N.A.		N.A.	

C.B 600x600

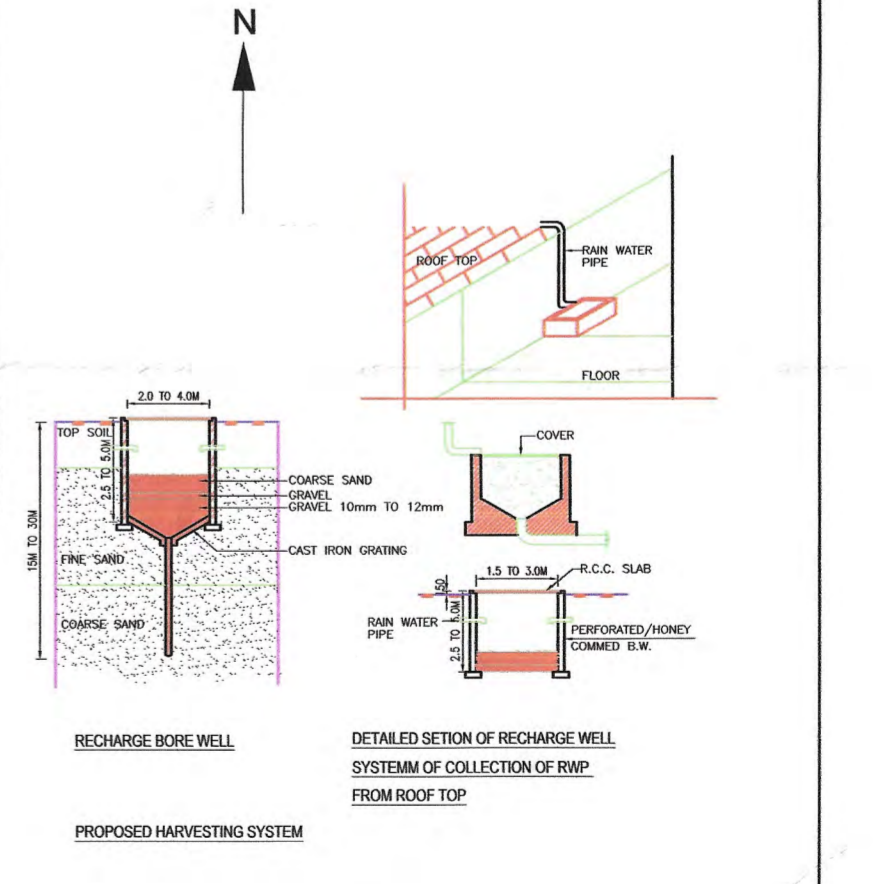

PROJECT:-
 REVISED BUILDING PLANS OF COMMERCIAL SITE MEASURING 2.0 ACRE (LICENCE NO. 56 OF 2007 DATED 23.01.2007) IN SECTOR-24, DHARUHERA, BEING DEVELOPED BY M/S DWARKADHISH PROJECTS PVT. LTD.
 DWG. TITLE
 SITE PLAN
 SCALE 1:300
 DRG. NO. A-01
 DWARKADHISH PROJECTS PVT. LTD.
 U. Jain
 Authorised Signatory
 SIG. OF OWNER
 SATYA PRAKASH SHARMA
 ARCHITECT
 CA/2008/28278
 SIG. OF ARCHITECT