

BASIC AREA DETAIL			
S.NO.	CONTENT	AREA IN SQ.MT.	AREA IN ACRES
1	TOTAL AREA AS PER ZONING PLAN	=	23087.279
2	PERMISSIBLE LAND FOR COMMERCIAL 4% OF TOTAL LAND	=	923.49
	PERMISSIBLE F.A.R FOR COMMERCIAL 175%	=	1616.110
3	PERMISSIBLE LAND FOR FLATS (1-2)	=	22163.788
	PERMISSIBLE F.A.R FOR FLATS 225%	=	49868.523
4	MAXIMUM DENSITY ALLOWED PER ACRE (900X 5.4768)	4929.12	
5	MINIMUM DENSITY ALLOWED PER ACRE (850X 5.4768)	4655.28	
A	MAXIMUM D.U.(4929.12/5 PERSON)	985.82	
B	MINIMUM D.U.(4655.28/5 PERSON)	931.06	

SUMMARY SHEET				SQ.MTR.	ACRS	REFER.
1	TOTAL PLOT AREA AS PER LICENCE NO. 73 OF 2014 DATED 01-08-2014			24179.929	5.975	
2	TOTAL PLOT AREA AS PER ZONING			23087.279	5.706	
3	MAXIMUM GROUND COVERAGE @50%			11543.64	2.8625	
1	GROUND COVERAGE AREA	PERMISSIBLE (sq.mt.)	PROPOSED	3345.33(14.489%)		CHART NO. C
2	F.A.R	49868.215	49867.25(2.248%)			CHART NO. A
3	HEIGHT OF BUILDING	120 mt.	75.450 mt.			
4	PARKING	466 ECS (REQUIRED)	465 ECS			CHART NO. B
			536 Two Wheeler			
5	COMMERCIAL BUILDING	1616.10(175%)	1616.08(175%)			CHART NO. 2a+2b
6	COMMUNITY BUILDING	185.8	211.55			CHART NO. 4a
7	ANGANWADI	185.8	218.80			CHART NO. 4a
8	BASEMENT AREA		9844.71			CHART NO. G
9	GREEN AREA	3463.07 (15%)	3483.39 (15.08%)			CHART NO. E
10	STILT AREA		1699.44			CHART NO. F
11	DENSITY PER ACRE	850 MINIMUM	900 MAXIMUM	850.86		CHART NO. A
12	REGULER DU	931.06 MINIMUM	985.62 MAXIMUM	932		CHART NO. A

PROPOSED DU. DETAIL						
S.NO	TOWER NO.	FLOORS	DU. /FLOOR	NOS. OF FLOOR	DU. IN TOWER	TYPE NOS. OF DU/ FLOOR
1	TOWER P-01	GROUND FLOOR	10	1	10	2 BHK 1 BHK
		TYPICAL FLOOR (1st - 23rd)	12	23	276	10 2
		24th FLOOR	11	1	11	9 2
		TOTAL		25	297	
2	TOWER P-02	COMMERCIAL				
3	TOWER P-03	GROUND FLOOR	8	1	8	2 BHK 1 BHK
		TYPICAL FLOOR (1st - 22nd)	12	22	264	10 2
		23rd FLOOR	11	1	11	9 2
4	TOWER P-04	TYPICAL FLOOR (1st - 11th)	32			2 BHK 1 BHK
TOTAL					932	

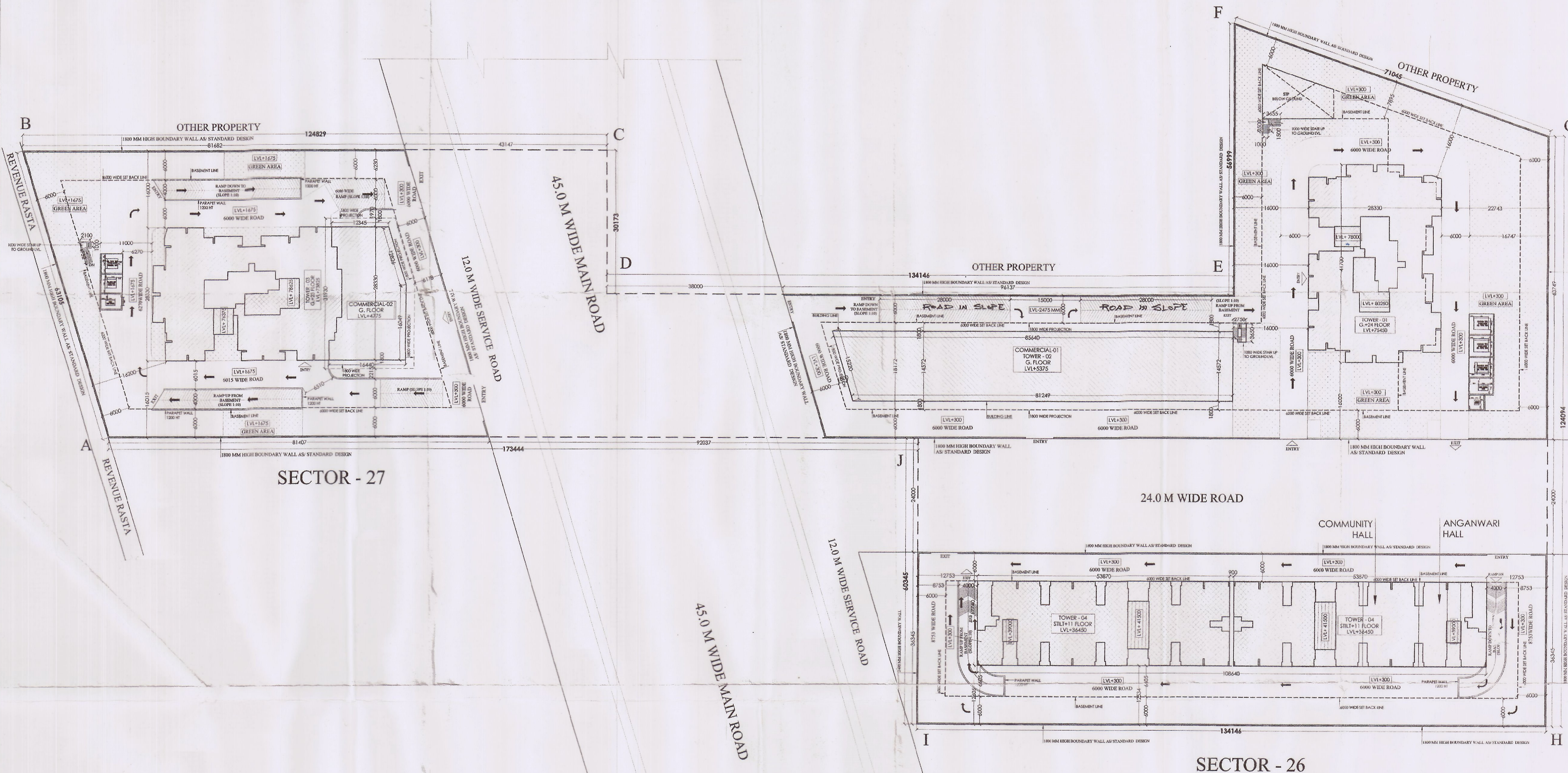

D.T.P. (HQ) Member Secretary B.P.C.
 S.T.P. (G) Member B.P.C.
 C.T.F. (Hr) C. Shrivastava
 AD JD SD JPA ATP
 KARISHAN KUMAR DEV KUMAR PREM KUMAR PREM SHARMA
 Checked and found ok for Public Health (Internal) Services only subject to comments in forwarding letter No. SE/HQ/...
 Superintending Engineer NUPA, Panchkula
 12/11/15

FAS FINE ARCH STUDIO (P) LTD
 ARCHITECTS ENGINEERS & INTERIOR DESIGNERS
 K-7/34, DLF, PH-II, GURGAON (HARYANA), PIN-122001
 PH-0124-4296622, CELL-91-9810630218, 91-9810880280

CLIENT:-
 B.M. GUPTA DEVELOPERS PVT. LTD.
 Regd. Office: No. 2, 1st Floor, 5948 & 5949
 Basti Harphool Singh, Sadar Thana Road
 Delhi - 110006

DWG. TITLE:-
 SITE PLAN & MASTER AREA DETAIL

PROJECT:-
 PROPOSED BUILDING PLAN OF AFFORDABLE
 GROUP HOUSING SCHEME MEASURING 5.975
 ACRES (LICENSE NO. 73 OF 14 DATED 01.08.2014)
 IN SECTOR 26 & 27, REWARI BEING DEVELOPED BY
 B. M. GUPTA DEVELOPERS PVT LTD
 C/O. GUPTA METAL SHEETS LTD

SCALE:- 1:500
 DATE:- 20-09-2014
 DRG. NO. 01a

OWNER SIGN.
 For B.M. Gupta Developers Pvt. Ltd.
 Director

ARCHITECT SIGN.
 ARCHITECT
 J.B. SINGH CA NO. J2008/42258
 K-7/34, G.F. DLF PH-II
 GURGAON-122001
 CELL :9810630218

NOTE:- ALL DIM. ARE IN MM.