

NOTE:-ALL DIMENSION ARE IN METERS

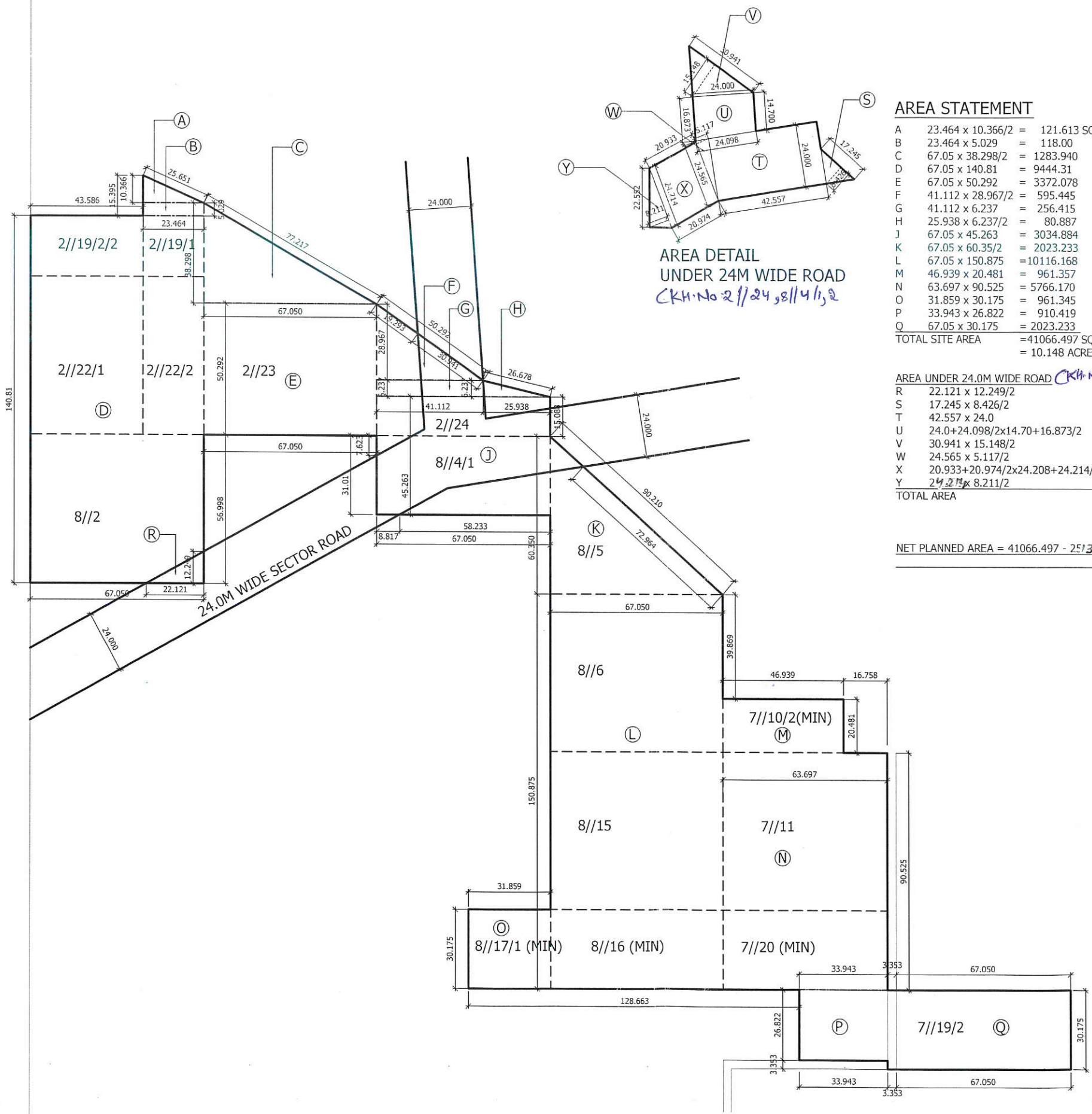

AREA STATEMENT

A	23.464 x 10.366/2	=	121.613 SQM.
B	23.464 x 5.029	=	118.00
C	67.05 x 38.298/2	=	1283.940
D	67.05 x 140.81	=	9444.31
E	67.05 x 50.292	=	3372.078
F	41.112 x 28.967/2	=	595.445
G	41.112 x 6.237	=	256.415
H	25.938 x 6.237/2	=	80.887
J	67.05 x 45.263	=	3034.884
K	67.05 x 60.35/2	=	2023.233
L	67.05 x 150.875	=	10116.168
M	46.939 x 20.481	=	961.357
N	63.697 x 90.525	=	5766.170
O	31.859 x 30.175	=	961.345
P	33.943 x 26.822	=	910.419
Q	67.05 x 30.175	=	2023.233
TOTAL SITE AREA		=	41066.497 SQM.
		=	10.148 ACRES

AREA UNDER 24.0M WIDE ROAD

R	22.121 x 12.249/2	=	135.480 SQM.
S	17.245 x 8.426/2	=	72.653
T	42.557 x 24.0	=	1021.368
U	24.0+24.098/2x14.70+16.873/2	=	379.649
V	30.941 x 15.148/2	=	234.347
W	24.565 x 5.117/2	=	62.849
X	20.933+20.974/2x24.208+24.214/2	=	507.305
Y	24.214 x 8.211/2	=	98.541
TOTAL AREA		=	2513.061 SQM.
		=	0.620 ACRE

NET PLANNED AREA = 41066.497 - 2513.061 = 38553.436 SQM. = 9.527 ACRES

Supra P.M.L. Day
AD SD ATP DTP

PROJECT NAME & ADDRESS:

Demarcation Plan of Group Housing

(Memo. No.LC-2278-JE(B)-2011/16621 Date 11/11/2011)

Site Measuring = 10.148 Acres

[Rect/Killa No:- 2//19/2/2, 2//19/1, 2//22/1, 2//22/2, 2//23, 2//24, 8//2, 8//4/1, 8//5, 8//6, 8//15, 8//16 (MIN), 8//17/1 (MIN), 7//10/2(MIN), 7//11, 7//20 (MIN), 7//19/2

Belonging to M/s Prime IT Solutions Pvt. Ltd.,

M/s Apex Buildwell Pvt. Ltd., M/s Phonix Datatech

Pvt.Ltd. falling in the

Revenue Estate of Village Gadoli Khurd,

Sector-37C, Teh. & Distt. - GURGAON (HR.)

OWNER NAME:-

/s Prime IT Solutions Pvt. Ltd.

M/s Apex Buildwell Pvt. Ltd.

M/s Phonix Datatech Pvt.Ltd.

Office: B-33, 1st Floor, Shivalik, Near Malviya Nagar

New Delhi-17

DRAWING TITLE: DEMARCATION PLAN

REVISION

DRAWN BY:

CHKD BY:

DATE:

SCALE: 1:1000

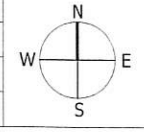

OWNER'S SIGNATURE

For PRIME IT SOLUTIONS PVT. LTD.
[Signature]

AD JE ATP DTP DIRECTOR

ARCHITECT'S SIGNATURE

[Signature]
Architect
PRADEEP SHARMA
CA 91/13854

PROJECT ARCHITECT:

PRADEEP SHARMA

ARCHITECTS PVT.LTD.

64,POORVI MARG,VASANT VIHAR NEW DELHI-110057

email-pradeep@psa.co.in