

PROPOSED LAY-OUT PLAN OF AFFORDABLE PLOTTED COLONY UNDER DEEN DAYAL JAN AWAS YOJNA SCHEME -2016 IN RENEVE ESTATE SOHNA, SECTOR- 35, SOHNA, DISTT. GURUGRAM (HR) LAND MEASURING 9.0625 ACRES. BELONGING TO LION INFRA DEVELOPERS LLP IN COLLABORATION WITH VIBHOR HOME DEVELOPERS PVT. LTD

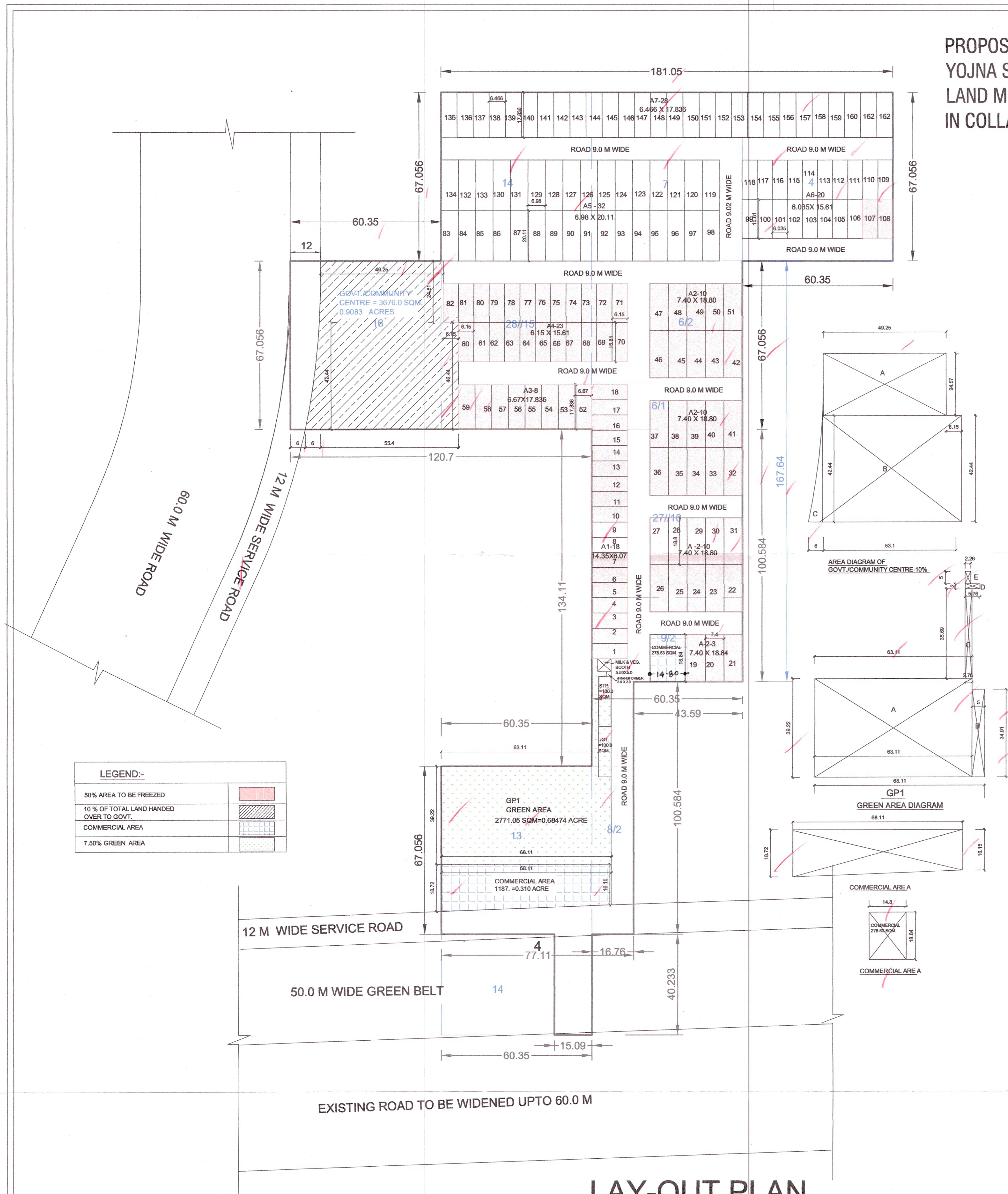

S. NO.	Type of Plot	WIDTH (IN M)	PL + R (IN M)	LENGTH (IN M)	AREA (SQM)	TOTAL NO. OF PLOTS	AREA (SQM)
1	A1	6.07	4 7/8	14.35	87.105	18	1567.881
2	A2	7.4	1/4	18.84	139.416	33	4600.728
3	A3	6.67	5/8	17.836	118.966	8	951.729
4	A4	6.15	6/8	15.61	96.002	23	2208.035
5	A5	6.98	7/8	20.11	140.368	32	4491.770
6	A6	6.05	1/2	15.61	94.206	20	1884.127
7	A7	6.466	1/2	17.836	115.328	28	3229.172
						TOTAL	791.390 162 18933.441

S. NO.	Type of Plot	Nos. of Plot	PLOT AREA (SQM)	Total area (sqm)	TOTAL NO. OF PLOTS	Rectangle / Killa No.
1	A1	18	x	87.105	1567.881	1 to 18
2	A2	33	x	139.416	4600.728	19 to 51
3	A3	8	x	118.966	951.729	52 to 59
4	A4	23	x	96.002	2208.035	60 to 82
5	A6	2	x	94.206	188.413	107 to 108
					TOTAL	9516.785 4

Description	Area in Acres	Area in Sqm.
Total Plot Area	9.0625	36674.578
Area under Sector Road & Green Belt	0.53	2117.5
Balance Area	8.5325	A
50% Benefit of area falling under sector road & Green Belt	0.265	B
Net Plan Area	8.2775	35662.16
Required Green Area (7.50%)	0.62	2476.98
Proposed Green Area (7.556%)	0.68474	2771.050
10% Area to be transferred free of cost to the Government for Community Site	0.90625	3667.458
Proposed Area to be transferred free of cost to the Government for Community Site (10.02%)	0.90836	3676.000
Permissible Area Under Plots (61%)	5.52813	22371.493
Proposed Area Under Plots (51.63%)	4.67856	18933.441
Permissible Commercial Area (4%)	0.36250	1466.983
Proposed Commercial Area (3.997%)	0.36222	1465.83
Area for STP (0.272%)	0.0247	100.00
Area for UGT (0.272%)	0.0247	100
Area for Milk & Vegetable booth (0.075%)	0.0068	27.50
Area for Transformer (0.01%)	0.0010	4.00
Total area for other services (0.629%)	0.0572	231.5
Proposed Plots	162	
Permissible Density	240-400 PPA	
Total Population (@ 13.5 Persons per Plot	2187	
Proposed Density	250.57	
50% Area to be Freed of Area under Plotted Development required	2.33928	9466.721
Proposed 50% Area to be Freed of Area under Plotted Development	2.3517	9516.785
Total saleable area (51.63+3.997=55.627 %)	5.04078	20399.271

CATEGORY	WIDTH	DEPTH	AREA IN SQM	
GREEN GP1 (A)	63.11	X	39.22	2475.17
B	5	X	34.91	174.55
C	2.76	X	35.69	98.50
D	5.76	X	2	11.52
E	2.26	X	5	11.30
TOTAL				2771.05
MILK & VEG BOOTH	5.5	X	5	27.50
TRANSF.	2	X	2	4.00
UGT	5	X	20	100.00
STP	5	X	20	100.00

DEMARICATION PLAN OF AFFORDABLE PLOTTED COLONY UNDER DEEN DAYAL JAN AWAS YOJNA -2016 BELONGING TO IN COLLABORATION WITH VIBHOR HOME DEVELOPERS PVT. LTD (LOI No. LC-3852-JE (SK)-2019/1733. Dated. 21.01.2019) IN RENEVE ESTATE SOHNA, SECTOR- 35 SOHNA, DISTT. GURUGRAM (HR)

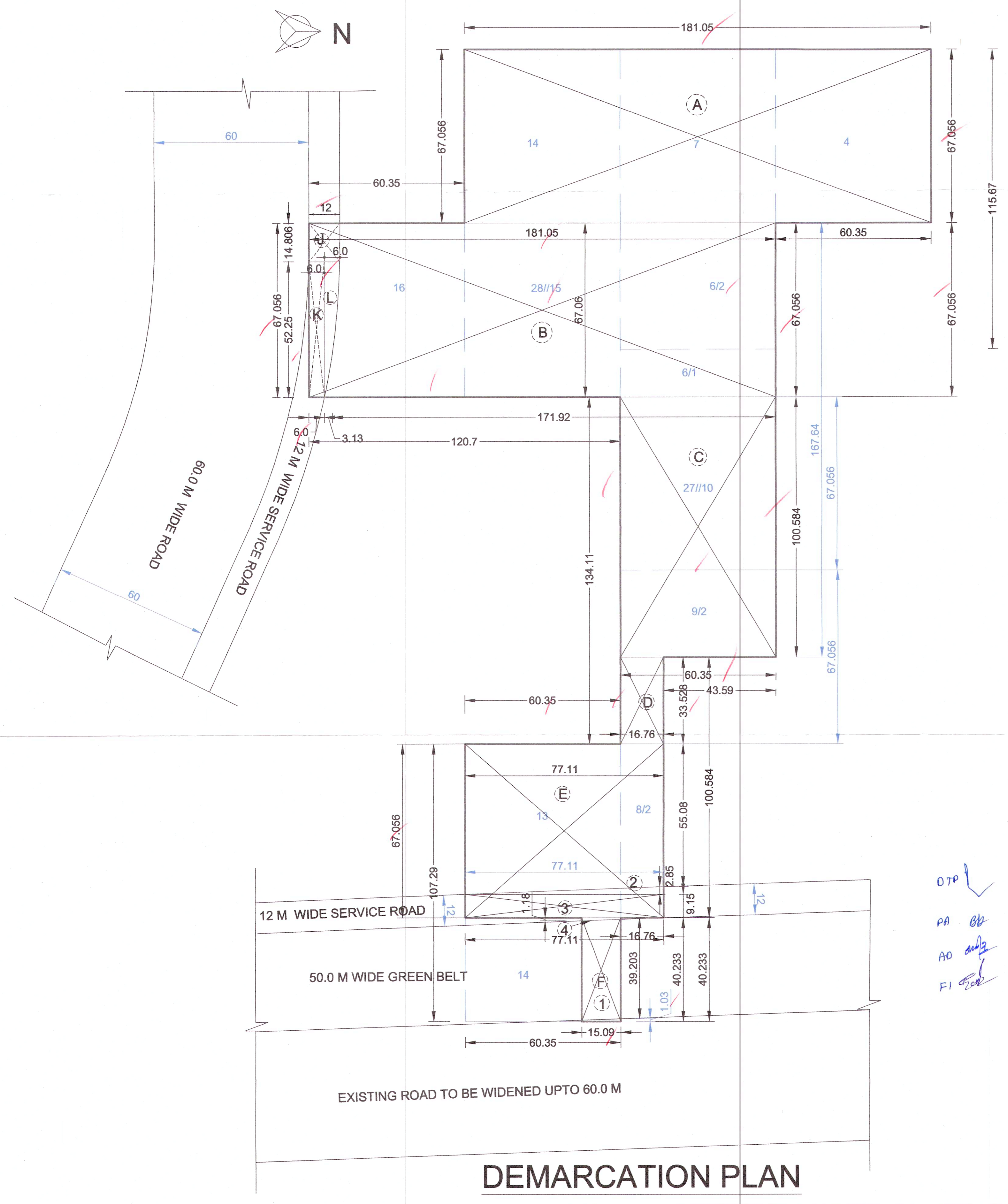

NAME OF VILLAGE	RECT. NO	KHASRA NO.	KANAL	MARLA
SOHNA	28	15	8	0
		16	8	0
		7	8	0
		14	8	0
		6/2-	5	16
		4	8	0
		13	8	0
		14 min	1	4
		8/2-	2	4
		9/2-	5	2
		10	8	0
		6/1-	2	4
			71	30
			72	10
				OR 9.0625 ACRES

SL. NOS.	REC	L	B	AREA IN SQM.	AREA IN ACRE	
1	A	1	181.050	X	67.056	12140.489
2	B	1	181.050	X	67.056	12140.489
3	C	1	60.350	X	100.584	6070.244
4	D	1	16.760	X	33.528	561.929
5	E	1	77.110	X	67.056	5170.688
6	F	1	15.090	X	40.233	607.116
				TOTAL	36690.955	9.06250

SL. NOS.	REC	L	B	AREA IN SQM.	ACRE	
1	J	1	12.000	X	18.806	225.672
2	K	1	6.000	X	52.250	313.500
3	L	0.5	6.000	X	52.250	156.750
				TOTAL	695.922	0.17197

NOS.	REC	L	B	AREA IN SQM.	AREA IN ACRE	
1	1	1	15.090	X	39.203	591.573
				TOTAL	591.573	0.14618

SL. NOS.	REC	L	B	AREA IN SQM.	AREA IN ACRE	
1	2	0.5	77.110	X	2.850	109.884
2	3	1	9.150	X	77.110	705.557
3	4	0.5	15.090	X	1.180	8.903
				TOTAL	824.341	0.20370

NOS.	REC	L	B	AREA IN SQM.	AREA IN ACRE	
1	1	0.5	15.090	X	1.030	7.771
				TOTAL	7.771	0.0019

DESCRIPTION	AREA
TOTAL PLOT AREA = 72 KANAL 10 MARLA	9.0625
AREA FOR LICENCE	0.17197
AREA UNDER 12 M SERVICE ROAD	0.14618
AREA UNDER 38.0 M WIDE PART OF 50 M GREEN BELT ROAD	0.20370
AREA UNDER 12.0 M WIDE PART OF 50 M GREEN BELT ROAD	0.0019
AREA UNDER 60.0 M WIDENED ROAD	0.52375
TOTAL	8.53875
NET TOTAL	ACRES

DRG. TITLE
LAY-OUT PLAN
DEMARICATION PLAN

OWNER'S SIGNATURE

ARCHITECT'S SIGNATURE

PROJECT NO. RA-5018
DRG. NO. A-1
SCALE 1:500
DATE
DRAWN BY -R.B. CKD BY - V.S. RAO

ARCHITECTS
RAO AND ASSOCIATE

ARCHITECTS PLANNERS ENGINEERS INTERIORS VALUERS
374,UDYOG VIHAR, PHASE-4, SEC-18 GURGAON, HARYANA (INDIA)
PH. (0124) - 2347706

THIS DRAWING IS THE PROPERTY OF RAO & ASSO. IT SHALL NOT BE PRODUCED, COPIED, USED, IN ANY MANNER OR HANDED OVER TO ANY OTHER PERSON OR PARTY WITHOUT THE PRIOR PERMISSION OF RAO & ASSOCIATE.