

ALREADY SANCTIONED & REVISED SUMMARY				
DESCRIPTION	ALREADY OCCUPATION GRANTED	PROPOSED	ALREADY OCCUPATION GRANTED & PROPOSED	
F.A.R.	87567.651	7144.516	9532.197	SQMT.
GROUND COVERAGE	9214.722	1674.654	11279.376	SQMT.
STILT AREA	3623.802	248.247	3872.049	SQMT.
BASEMENT -1 AREA	17250.098	1688.301	18938.399	SQMT.
SHOPPING AREA	239.36	27.173	266.533	SQMT.
MAIN DWELLING UNITS	740	64	804	UNITS
EWS UNITS	132	12	144	UNITS
EWS AREA	3330.839	233.564	3564.403	SQMT.
POPULATION (MUMTY + M.R + EWS + SERVANTS)	4114	356	4470	PERSONS
BASEMENT CAR PARKING	370	48	418	CARS
OPEN CAR PARKING	323	32	355	CARS
STILT PARKING	116	16	132	CARS
COVERED PARKING ON SURFACE	-	32	32	CARS

PROPOSED AREA CHART			
DESCRIPTION	G. COVERAGE	AREA IN F.A.R. (FOR ALL FLOOR)	
TOWER - E	742.459	5105.055	SQMT.
TOWER - F1	476.794	1777.396	SQMT.
CONVENIENT SHOPPING-1	-	27.173	SQMT.
EWS	58.391	233.564	SQMT.
PARKING SHED	397.000	-	SQMT.
TOTAL	1676.554	7844.174	SQMT.

AREA STATEMENT FOR HOUSING (Already Occupation Granted & Proposed)											
S.L. NO.	TOWER NO.	HEIGHT	NO. OF TOWER	NO. OF FLOOR PER TOWER	TOTAL NO. OF FLOOR	NO. OF DOMESTIC SERVANTS	TOTAL GROUND COVERAGE	GROUND FLOOR FAR	TYPICAL FLOOR FAR	TOTAL FAR OF ALL TOWER	REMARKS
1	A, B, C, D	St+12	4	60	240	0	3623.802	428.65	1994.754	1994.754	Already Occupation Granted
2	EWS	G+3	1	12	12	0	58.391	58.391	233.564	233.564	Proposed (Ref. Area Details EWS Dwg.)
	TOTAL				252		3682.193	487.041	2228.318	2228.318	Already Occupation Granted & Proposed
3	T1, T2, T3	G+14	3	45	135	0	1112.823				Already Occupation Granted
4	T4, T5, T6, T7	G+14	5	45	225	75	1999.675				Already Occupation Granted
5	T8, T9	G+14	2	28	56	0	612.374				Already Occupation Granted
6	T10, T11, T12	G+13	2	42	84	0	741.882				Already Occupation Granted
7	T13	G+12	1	48	48	6	742.459	5223.010	5176.538	5176.538	Proposed Tower (Ref. Area Details Tower Dwg.)
8	T14	G+12	1	16	16	6	476.794	476.794	1777.396	1777.396	Proposed Tower (Ref. Area Details T1 Tower Dwg.)
9	COMBINATION BUILDING	G+1	1	1	1	0	446.220				Already Occupation Granted
10	SHOPPING	G	1	1	1	0	239.360				Proposed Area
	TOTAL AREA OF SHOPPING						239.360				
	PARKING						27.173				
	TOTAL AREA OF SHOPPING PARKING						266.533				
	PARKING						397.000				
	TOTAL AREA OF SHOPPING PARKING						663.533				

PARKING DETAIL (FOR ALREADY OCCUPATION GRANTED & PROPOSED AREA)		
PARTICULARS	REQUIRED NO. OF CARS	PROVIDED NO. OF CARS
REQUIRED 1 PCU PER ALREADY SANCTION DU'S	740	809
ALREADY SANCTIONED TOTAL CAR PARKING		370
50% COVERED PARKING OF TOTAL NO. OF CAR PARKING OF ALREADY SANCTION CAR PARKING		185
ALREADY SANCTIONED CAR PARKING		370
BASEMENT		116
STILT		116
TOTAL COVERED CAR PARKING		486
ALREADY SANCTIONED SURFACE CAR PARKING		323
REQUIRED 2 PCU PER PROPOSED DU'S	128	
TOTAL PROPOSED CAR PARKING		128
REQUIRED 75% COVERED CAR PARKING ON PROPOSED DU'S		96
PROPOSED COVER CAR PARKING		48
BASEMENT		16
STILT		32
COVERED CAR PARKING ON SURFACE		96
TOTAL COVERED CAR PARKING		132
SURFACE CAR PARKING		32
TOTAL (ALREADY OCCUPATION GRANTED + PROPOSED)	868	937

TOTAL PROPOSED BUILT - UP AREA		
DESCRIPTION	AREA (SQ.M)	
TOWER - E (FAR)	5105.055	
TOWER-E (STILT)	248.247	
TOWER - F1 (FAR)	1777.396	
CONVENIENT SHOPPING	27.173	
EWS	233.564	
BASEMENT	1688.301	
MUMTY & M.R (TOWER-E)	68.978	
MUMTY & M.R (TOWER-F1)	48.082	
TOTAL BUILTUP AREA	9918.102	

Required Parking for EWS @ 5% of total No. of Parking Provided	
Required Public Amenities	42.70 Cars says 43 cars
NURSERY SCHOOL	43 Cars (No. 45 to 87 near)
PROPOSED PUBLIC AMENITIES	1 NOS. OF 0.200 ACRE
NURSERY SCHOOL	899.38 TO SAY 0.200 ACRES

DENSITY CALCULATION			
S. NO.	PARTICULARS	UNITS	PERSONS IN 1 UNIT
1	ALREADY OCCUPATION GRANTED TOTAL MAIN DU'S	740	5
2	PROPOSED MAIN DU'S	64	5
3	PROPOSED EWS UNITS	132	2
4	PROPOSED EWS UNITS	12	2
5	ALREADY SANCTIONED SERVANT UNITS	75	2
6	PROPOSED SERVANT UNITS	6	2
	TOTAL POPULATION		4470
	DENSITY ACHIEVED		332.058

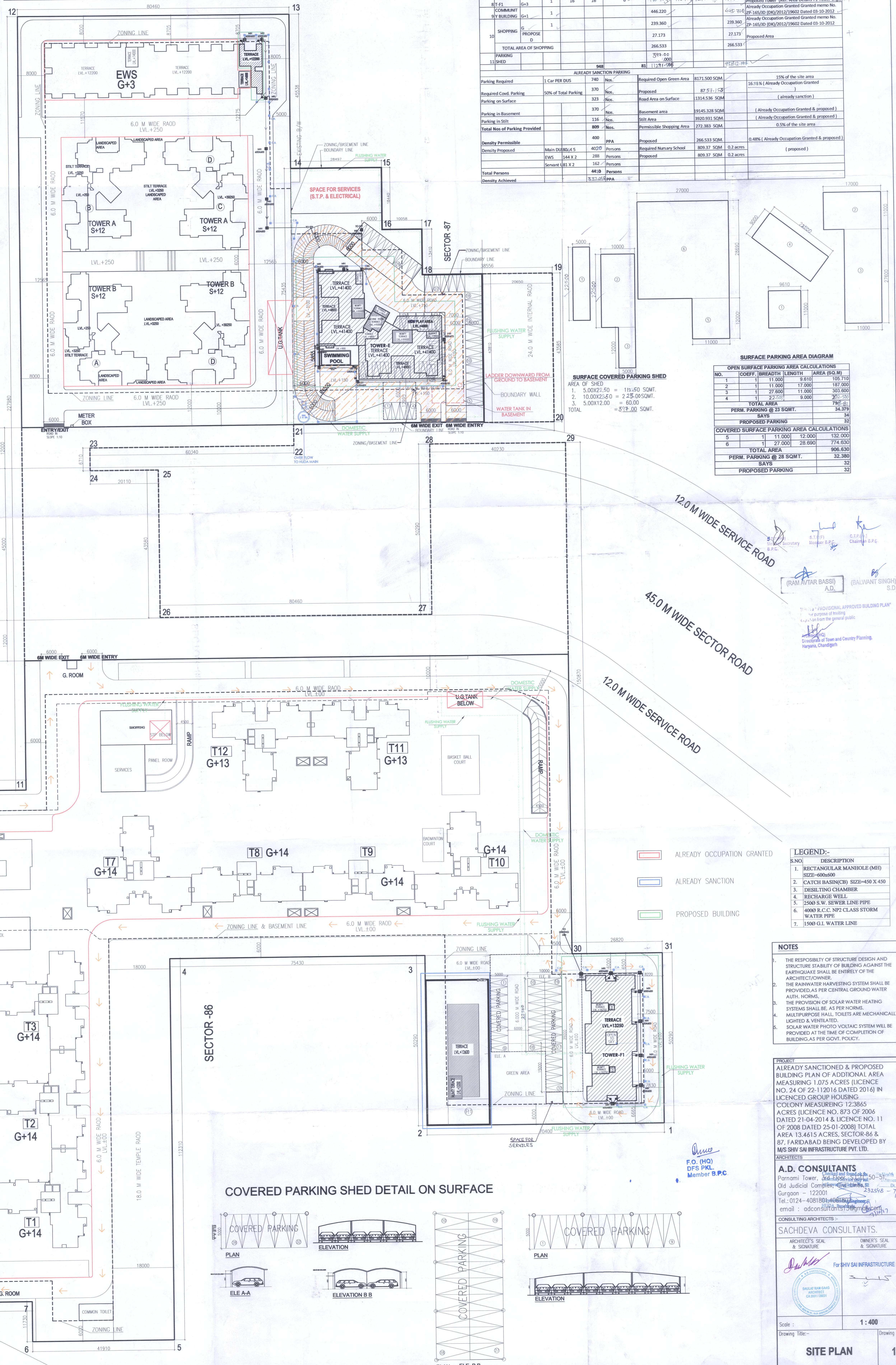

OPEN SURFACE PARKING AREA CALCULATIONS		
NO.	COEFF. (BREADTH LENGTH)	AREA (SQ.M)
1	11.0000	6.610
2	11.0000	17.000
3	27.5000	11.000
4	27.5000	9.000
	TOTAL AREA	43.610
	PERM. PARKING @ 23 SQ.M.	1.90
	SAVES	34
	PROPOSED PARKING	32

COVERED SURFACE PARKING AREA CALCULATIONS		
NO.	COEFF. (BREADTH LENGTH)	AREA (SQ.M)
1	11.0000	12.000
2	11.0000	12.000
3	27.5000	28.690
4	27.5000	28.690
	TOTAL AREA	81.380
	PERM. PARKING @ 28 SQ.M.	2.91
	SAVES	32
	PROPOSED PARKING	32

- LEGEND:-**
- RECTANGULAR MANHOLE (MID) SIZE-600x600
 - CATCH BASIN(S) SIZE-450 X 450
 - DEBRIDING CHAMBER
 - RECHARGE WELL
 - 2500 S.W. SEWER LINE PIPE
 - 4000 R.C.C. NP2 CLASS STORM WATER PIPE
 - 15000 GL. WATER LINE

- NOTES**
- THE RESPONSIBILITY OF STRUCTURE DESIGN AND STRUCTURE STABILITY OF BUILDING AGAINST THE EARTHQUAKE SHALL BE ENTIRELY OF THE ARCHITECT/OWNER.
 - THE RAINWATER HARVESTING SYSTEM SHALL BE PROVIDED AS PER CENTRAL GROUND WATER AUTH. NORMS.
 - THE PROVISION OF SOLAR WATER HEATING SYSTEMS SHALL BE AS PER NORMS.
 - MULTIPURPOSE HALL TOILETS ARE MECHANICALLY LIGHTED & VENTILATED.
 - SOLAR WATER PHOTO VOLTAGE SYSTEM WILL BE PROVIDED AT THE TIME OF COMPLETION OF BUILDING AS PER GOVT. POLICY.

PROJECT
 ALREADY SANCTIONED & PROPOSED BUILDING PLAN OF ADDITIONAL AREA MEASURING 1.075 ACRES (LICENCE NO. 24 OF 22-112016 DATED 2016) IN LICENCED GROUP HOUSING COLONY MEASURING 12.3865 ACRES (LICENCE NO. 873 OF 2006 DATED 21-04-2014 & LICENCE NO. 11 OF 2008 DATED 25-01-2008) TOTAL AREA 13.4615 ACRES. SECTOR-86 & 87, FARIDABAD BEING DEVELOPED BY M/S SHIV SAI INFRASTRUCTURE PVT. LTD.

ARCHITECTS
 A.D. CONSULTANTS
 Paromita Tower, Sector-86 & 87, Faridabad
 Old Judicial Complex, Sector-86 & 87, Faridabad
 Gurgaon - 122001
 Tel.: 0124-4081801
 Email: adconsultants@gmail.com

CONSULTING ARCHITECTS:-
 SACHDEVA CONSULTANTS.
 ARCHITECT'S SEAL & SIGNATURE
 OWNER'S SEAL & SIGNATURE
 For SHIV SAI INFRASTRUCTURE PVT. LTD.
 Director

Scale: 1:400
 Drawing Title: SITE PLAN
 Drawing No.: 1