

ZONING PLAN OF GROUP HOUSING SCHEME MEASURING 18.05 ACRES (LICENCE NO. 226 OF 2007 DATED 18-9-2007) IN SECTOR-80, FARIDABAD BEING DEVELOPED BY M/S CROWN INFRABUILD PVT. LTD

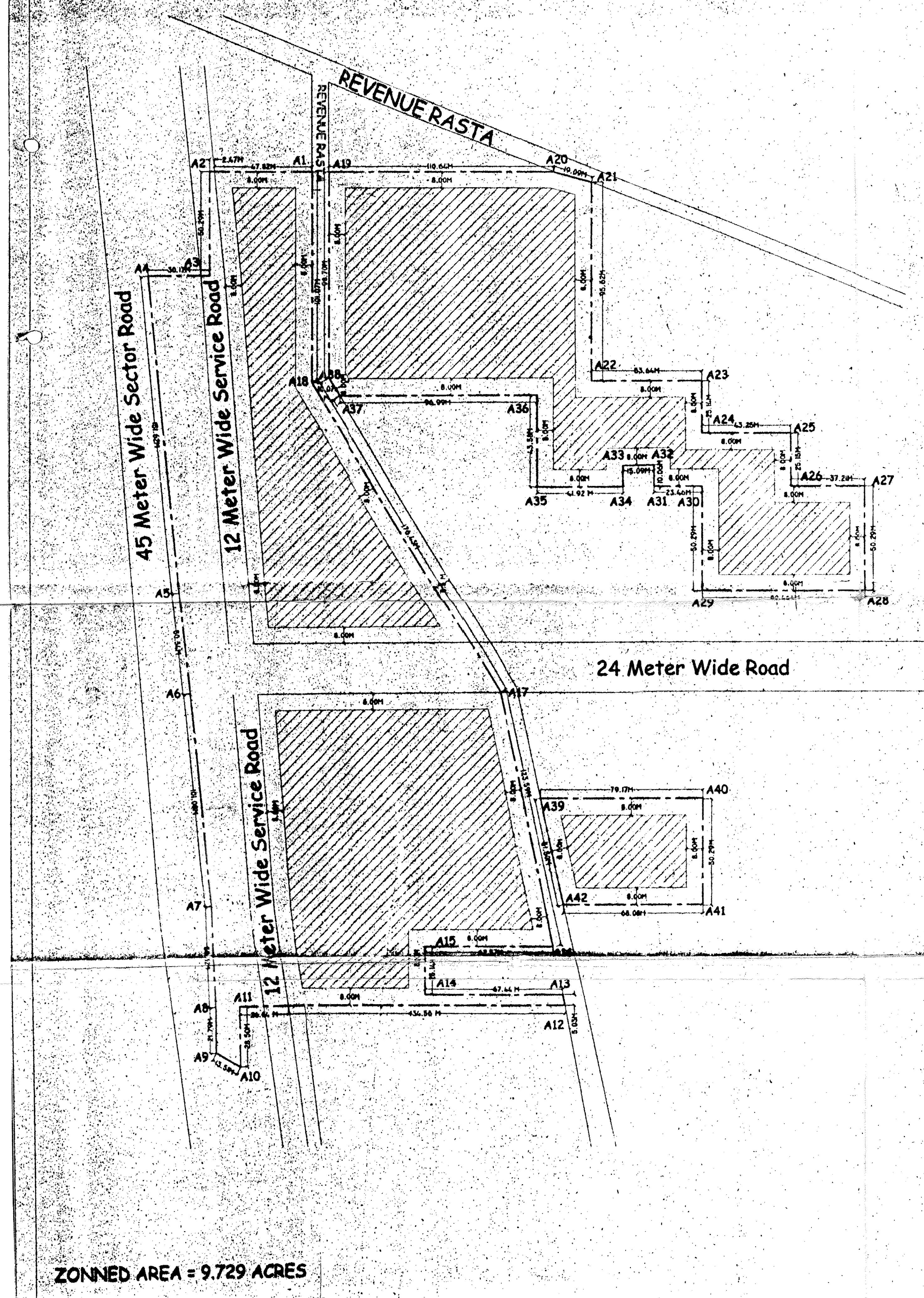

ZONED AREA = 9.729 ACRES

FOR THE PURPOSE OF RULE 38(4)(i) AND 48 (2) OF THE PUNJAB SCHEDULED ROADS AND CONTROLLED AREAS RESTRICTION OF UNREGULATED DEVELOPMENT RULES, 1965.

1. SHAPE & SIZE OF SITE:

The shape and size of the Group Housing Colony is in accordance with the approved demarcation plan shown as A1 To A42, as confirmed by D.T.P Faridabad vide Endst. No 7452 dated 20-11-2007.

2. TYPE OF BUILDING PERMITTED:

The type of building permitted on this site shall be buildings designated in the form of flatted development for residential purpose or any ancillary or appurtenant building including community facilities, public amenities and public utility as may be prescribed and approved by the Director, Town and Country Planning, Haryana.

3. GROUND COVERAGE AND FAR:

- a) Building shall only be permitted within the portion of the site marked as buildable zone and no where else.
- b) The maximum coverage on ground floor shall be 35% and that on subsequent floors shall be 30% of the area 16.8529 acres.
- c) The maximum FAR shall not exceed 175 on the area of 16.8529 acres. However, it shall not include community buildings which shall be as per the prescribed norms, the building plan of which shall have to be approved from the Director, Town and Country Planning, Haryana.

4. HEIGHT OF BUILDING:

The height of the building block, subject of course to the provisions of the site coverage and FAR, shall be governed by the following:-

- a) The maximum height of the buildings shall not be more than 60 meters and shall not exceed 1.5 times (the width of the roads abutting) plus the front open space. This clause shall be read in conjunction of clause no. 13 mentioned below.
- b) If a building abuts on two or more streets of different widths, the building shall be deemed to face upon the street that has the greater width and the height of the building shall be regulated by the width of that street and may be continued to this height to a depth of 24M, along the narrow street.
- c) Buildings/Structures which rise to 30 meters or more in height shall be constructed if no objection certificate has been obtained from the National Airport Authority.
- d) All building block(s) shall be constructed so as to maintain an adequate distance not less than the set back required for each building according to the table below:-

S.No.	HEIGHT OF BUILDING (in meters)	SET BACK / OPEN SPACE TO BE LEFT AROUND BUILDINGS, (in meters)
1	10	3
2	15	5
3	18	6
4	21	7
5	24	8
6	27	9
7	30	10
8	35	11
9	40	12
10	45	13
11	50	14
12	55 & above	16

- e) If such interior or exterior open space is intended to be used for the benefit of more than one building belonging to the same owner, then the width of such open air space shall be the one specified for the tallest building as specified above.

5. SUB-DIVISION OF SITE:

- a) The site of the Group Housing Colony shall be governed by the Haryana Apartment Ownership Act.
- b) The site shall not be sub divided or fragmented in any manner whatsoever.

6. GATE POST AND BOUNDARY WALL:

Such Boundary wall, railings or their combination, hedges or fences along with gates and gate posts shall be constructed as per design approved by D.T.P Haryana. In addition to the gate/gates an additional widest gate not exceeding 125 meters width may be allowed in the front and side boundary wall provided that no main gate shall be allowed to open on the sector road/public open space.

The minimum density of the population provided in the colony shall be 100 P/A and the maximum be 400 P/A of the area 16.8529 acres. For computing the density, the occupancy per main dwelling unit shall be taken as five persons and for service dwelling unit two persons per room or one person per 80 sq. feet of living area, whichever is more.

8. ACCOMMODATION FOR SERVICE POPULATION:

Adequate accommodation shall be provided for domestic servants and other service population of EWS. The number of such dwelling units for domestic servants shall not be less than 10 for the number of main dwelling units and the carpet area of such a unit if attached to the main units shall not be less than 140 sq.ft. In addition 15% of the total number of dwelling units having a minimum area of 200 sq.ft shall be reserved for E.W.S category.

9. PARKING:

Parking spaces shall be provided at the rate of one car park per flat excluding EWS flats. These parking spaces shall be allotted only to the flat holders and shall not be allotted, leased, sold or transferred in any manner to the third party. The area for parking per car shall be as under:-

- a) Basement. 35 sqm.
- b) Stilt. 30 sqm.
- c) Open. 25 sqm.

At least 50% of the equivalent car spaces shall be provided in the form of covered parking.

10. LIFTS AND RAMPS:

Ramps would be optional in Group Housing building in case of 100% stand by generators along with automatic switchover are provided for running of lifts along with stairs. However, in case of buildings having more than four storeys lifts with 100% stand by generators along with automatic switchover would be essential. At least one lift shall be provided with minimum size of 1.80 M X 3.00 M. The clear width of the ramp leading to the basement shall be 4.00 metres with an adequate slope not steeper than 1:10. The entry and exit shall be separate preferably at opposite ends.

11. OPEN SPACES:

While all the open spaces including those between the blocks and wings of buildings shall be developed, equipped and landscaped according to the plan approved by the D.T.C.P. Haryana. At least 15% of the total site area shall be developed as organised open space i.e. for lawns and play ground.

12. APPROVAL OF BUILDING PLANS:

The building plans of the buildings to be constructed at site shall have to be got approved from the D.T.C.P. Haryana (under section 8(2) of the Act No.41 of 1963), before taking up the construction.

13. BUILDING BYE-LAWS:

The construction of the building/buildings shall be governed by the building rules provided in the part VII of the Punjab Scheduled Roads and Controlled Areas, Restriction of Unregulated Development Rules, 1965. On the points where such rules are silent and stipulate no condition or norm, the model building bye-laws issued by the I.S.I and as given in the NIC shall be followed as may be approved by D.T.C.P. Haryana.

14. CONVENIENT SHOPPING:

0.5% of the total area shall be reserved to cater for essential convenient shopping with the following conditions.

- a) The ground coverage of 100% with FAR of 100 will be permissible. However this will be a part of the permissible ground coverage and FAR of the Group Housing Colony.
- b) The size of Kiosk/Shop shall not be more than 2.75 m x 2.75 m and 2.75 m x 8.25 m.
- c) The height of Kiosk/Shop/Departmental Store shall not exceed 4.00 meters.

15. PROVISION OF COMMUNITY BUILDINGS:

The community buildings shall be provided as per the composite norms in the Group Housing Scheme.

16. BASEMENT:

Two level basement within the building zone of the site provided it flushes with the ground and is properly landscaped may be allowed. The basement may in addition to parking space be utilized for generator room, lift room, fire fighting pump, water reservoir, electric sub-station, air conditioning plants and vaults, if they satisfy the public health requirements and for no other purposes. Area under stilts (only for parking) and basement shall not be counted towards FAR. Basement shall not be used for storage purposes but will be used only for ancillary services of the main building and it is further stipulated that no other partitions of basement will be permissible for uses other than those specified above.

17. APPROACH TO SITE:

The vehicular approach to the site and parking lots shall be planned and provided giving due consideration to the junctions and the junctions with the surrounding roads to the satisfaction of the D.T.C.P. Haryana.

18. FIRE SAFETY MEASURES:

- a) The owner will ensure the provision of proper fire safety measures in the multi storeyed buildings conforming to the provisions of Rules 1965/ NBC and the same should be got certified from the competent authority.
- b) Electric Sub Station / generator room if provided should be on solid ground near D6/LT. Control panel on ground floor or in upper basement and it should be located on outer periphery of the building, the same should be got approved from the Chief Electrical Inspector Haryana.

19. SOLAR WATER HEATING SYSTEM:

The provision of solar water heating system shall be as per norms specified by HAREDA and shall be made operational in each building block before applying for an occupation certificate.

20. RAIN WATER HARVESTING SYSTEM:

The rain water harvesting system shall be provided as per Central Ground Water Authority norms as per the provisions of the Act No. 1963.

21. The coloniser shall obtain the clearance/NOC as per the provisions of the Notification No. S.O. 1533 (E) Dated 14.9.2006 issued by Ministry of Environment and Forest, Government of India before starting the construction/ execution of development works at site.

22. The coloniser/owner shall use only Compact Fluorescent Lamp fittings for internal lighting as well as campus lighting.

DWG NO. D.T.C.P. 149-DATED 22-2-08

(V.K. GOYAL) DTP(HQ)

 (DHARE SINGH) CTP(HQ)

 (S.S. DHILLON) D.T.C.P.(HR)