

**HARYANA STATE INDUSTRIAL AND INFRASTRUCTURE DEVELOPMENT
CORPORATION LTD.**

REGD. & CORPORATE OFFICE: C-13 -14, SECTOR -6, PANCHKULA, HARYANA

Phone : 0172-2590481-83, Fax: 0172-2590474

Email : info@hsiidc.org.in also visit us at : <http://hsiidcesewa.org.in>

CIN No:U29199HR1967SGC034545

POSSESSION CERTIFICATE

This is to certify that physical possession of Residential Plot no. GH-3, Sector -80, Phase-I, Residential Estate, Manesar measuring 22501 Sq. Mtr. has been handed over to M/s Conscient Infrastructure Private Limited on dated 18-Oct-2024.

Sketch of Plot
(Not to scale)

GH-3 (5.56 Acre)
22501 Sq. Mtr.

Detail drawing enclosed
herewith as Annexure-I

Handed Over

AM (Engg.)

Mgr. (Engg.)

Taken Over

Authorized representative

A copy is forwarded to:

- ✓ M/s. Conscient Infrastructure Private Limited, Gurugram-122002.
- Estate Manager, HSIIDC, IMT Manesar w.r.t. his letter No.
Est/Manesar/PAL/2024/00033 dated 24.09.2024.

Reference

No.: Est/Manesar/PSC/2024/00020

Dated 18-Oct-2024

No HSIIDC IMT Engg -3053
Dated 18/10/2024

AGM (Engg.)
HSIIDC, IMT Manesar

ANNEXURE - I

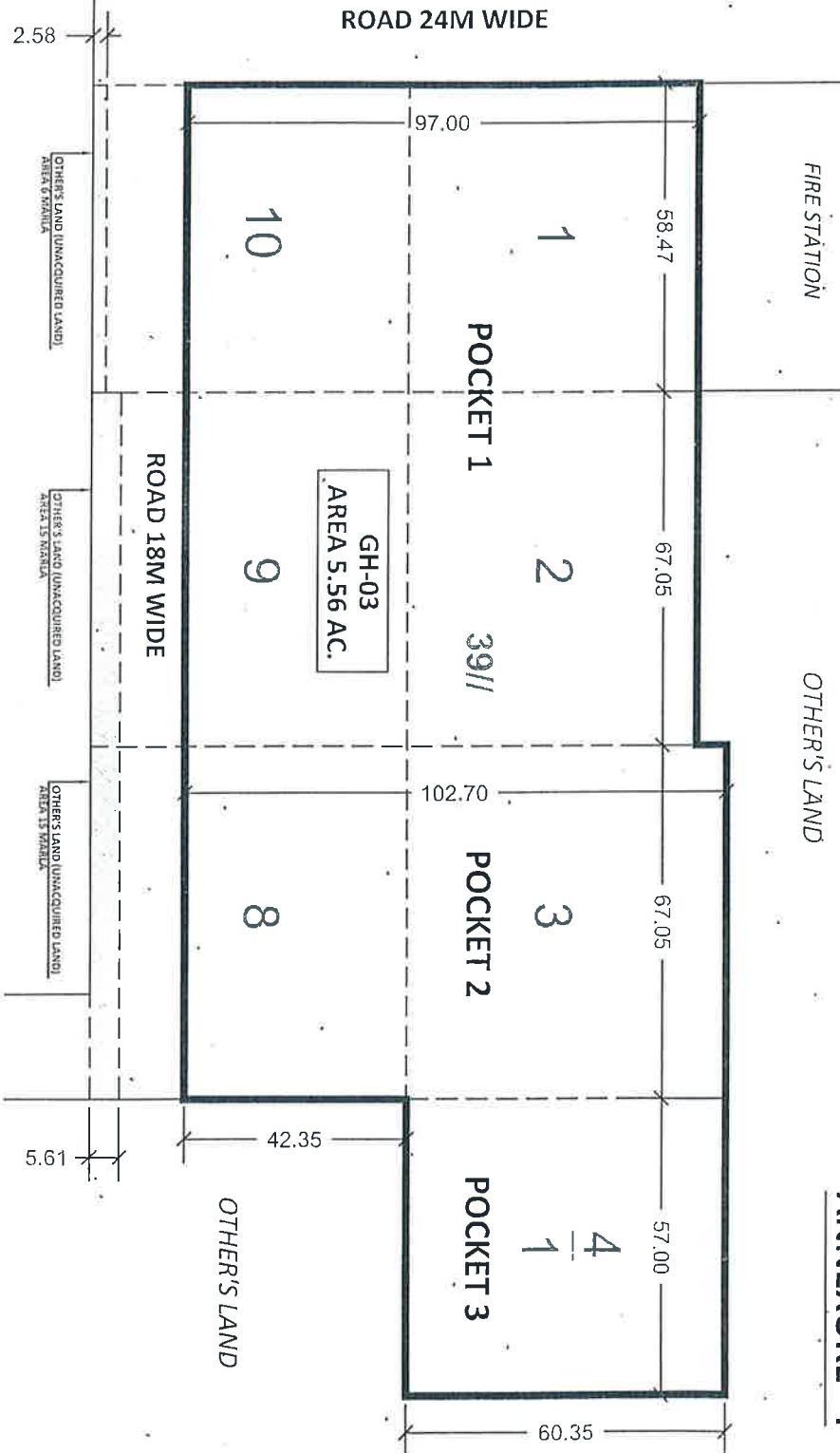

AREA DETAILS

- A. POCKET 1 AREA = $125.52 \times 97.00 = 12175.44$ SQM
 - B. POCKET 2 AREA = $67.05 \times 102.70 = 6886.03$ SQM
 - C. POCKET 3 AREA = $57.00 \times 60.35 = 3439.95$ SQM
- TOTAL PLOT AREA OF GH-03 = $(12175.44 + 6886.03 + 3439.95)$
= 22501.42 SQM OR SAY 22501 SQM (5.56 ACRES)

DEMARICATION PLAN OF GH NO. - 3 MEASURING 22501 SQMT (5.56 ACRES), IN RESIDENTIAL ESTATE SECTOR-80 MANESAR,
REVENUE ESTATE VILLAGE NAURANGPUR, GURUGRAM
ALLOTTED TO CONSCIENT INFRASTRUCTURE PVT LTD

