

24M WIDE ROAD  
LVL. ±00

18M WIDE ROAD  
LVL. ±00

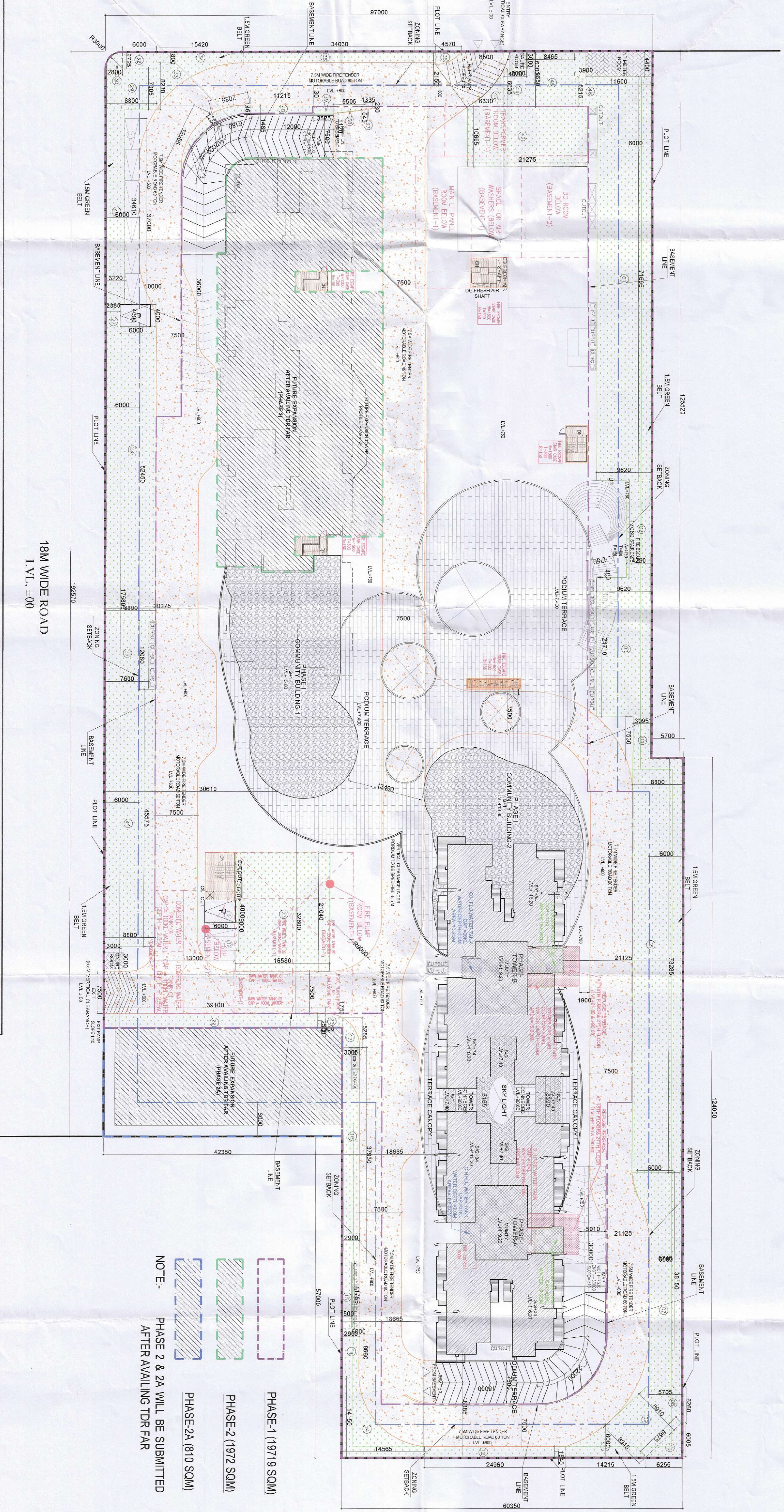

NOTE:  
PHASE 2 & 2A WILL BE SUBMITTED  
AFTER AVALUING TOR FAR

FUEL  
FILLING  
STATION  
1.00AC.

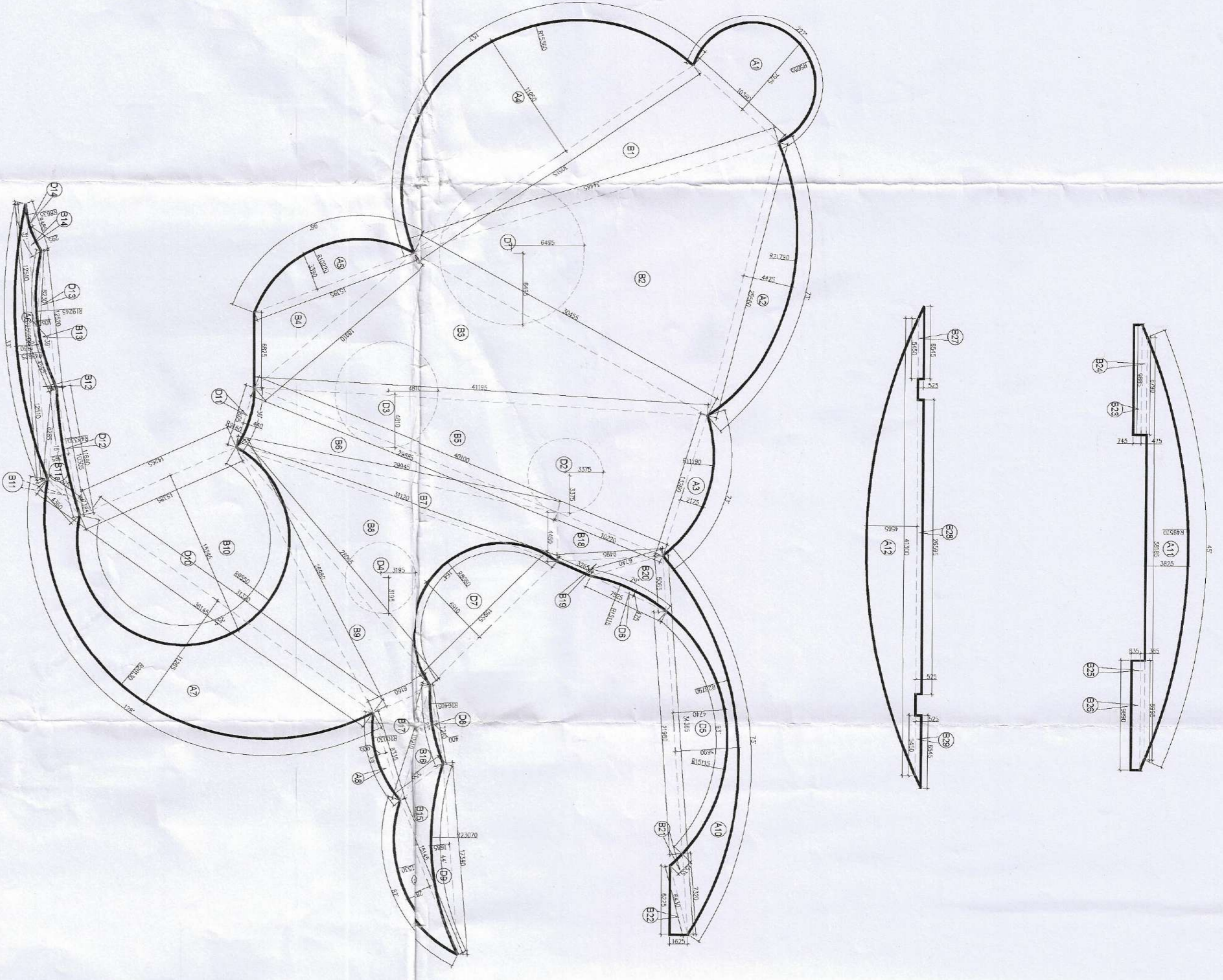
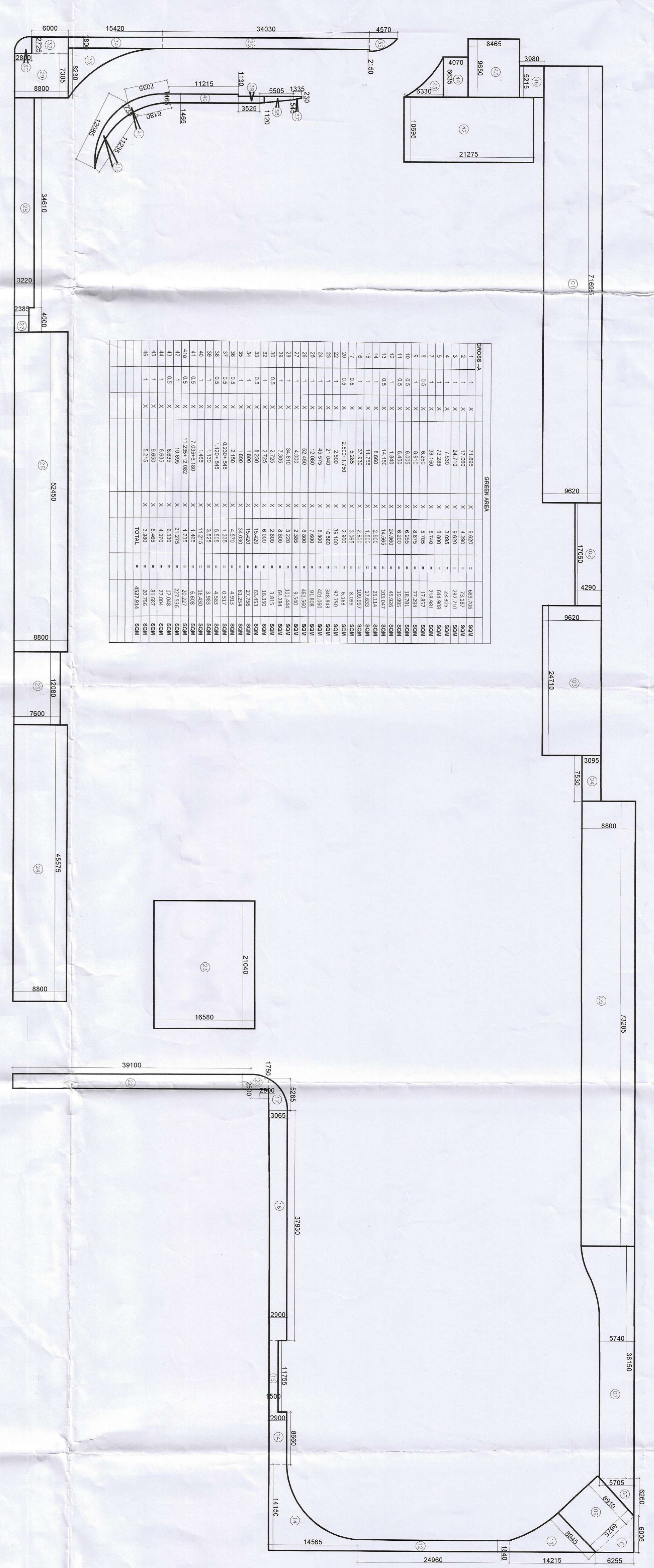

NO.	DESCRIPTION	AREA (SQM)	VOLUME (CU M)	REMARKS
1	PHASE 1	19719	25735	
2	PHASE 2	1972	25735	
3	PHASE 2A	810	25735	
4	TOTAL	22501	25735	

**Building Planning and Design**  
By: **Ar. Hassan Khamar**  
Date: **11/11/2024**

Building Plans Approved by:  
Sponsoring Committee (P.O.)  
Member

**Recommended for Sanction**  
By: **Ar. Hassan Khamar**  
Date: **11/11/2024**

- Note:
1. ALL LIFTS SHALL HAVE 0.2% POWER BACK-UP
  2. ALL ELECTRICAL INSTALLATIONS SHALL BE AS PER PROVISION OF IEC
  3. INSTALLATION BASES SHALL BE AS PER RELEVANT TOR
  4. ALL CONDUITS SHALL BE AS PER RELEVANT TOR
  5. BUILDING STRUCTURE DESIGNED BY ARCHITECT
  6. ROOF SHALL BE UPPER BAKKAWI DESIGNED TO TAKE LOAD OF RELEVANT
  7. MAIN INTERIATE AND BOUNDARY WALL AS PER STANDARD DESIGN
  8. ALL MATERIALS IN TO SPEC SPEC CASE AT 10% HANDED OVER WITH ANALYSIS SPECIFIED
  9. ALL EXTERNAL WALLS WILL BE STROBE COAT FINISH
  10. ALL EXTERNAL WALLS SHALL BE STROBE COAT FINISH
  11. ALL EXTERNAL WALLS SHALL BE STROBE COAT FINISH
  12. ALL EXTERNAL WALLS SHALL BE STROBE COAT FINISH
  13. ALL EXTERNAL WALLS SHALL BE STROBE COAT FINISH
  14. ALL EXTERNAL WALLS SHALL BE STROBE COAT FINISH
  15. ALL EXTERNAL WALLS SHALL BE STROBE COAT FINISH

PROJECT:  
PROPOSED BUILDING PLAN OF  
GROUP HOUSING AT SITE NO. GH-03  
SITUATED AT SECTOR-80 (RESIDENTIAL),  
MAHESAR MEHSISING ZONE 19 SQM.

ASSOCIATE ARCHITECTS

**ASSOCIA TES**  
PLOT NO.-408 SEC.-77C QUADRON (711-956079/79/4)  
OWNER'S SEAL & SIGNATURE

Ar. Hassan Khamar  
C.No. 2828/87  
No. 57/14/8/73

Scale: 1:300

Drawing No.:

DATE: 2024

Ar. Hassan Khamar