

PROPOSED PHASING PLAN OF MIXED LAND USE COLONY (96% RESIDENTIAL & 4% COMMERCIAL) UNDER TOD POLICY DATED 09/02/2016 FOR AN AREA MEASURING 6.26406 ACRES (LICENCE NO. 120 OF 2024 DATED 14.08.2024) IN SECTOR-37D, GURUGRAM BEING DEVELOPED BY RAMPRASTHA BUILDTech PRIVATE LIMITED AND OTHERS IN COLLABORATION WITH NAVRAJ TOWNSHIP PRIVATE LIMITED

TENTATIVE / INDICATIVE FAR INTENDED TO BE UTILIZED IN FUTURE

Below is the indicative and tentative FAR proposed to be utilized through balance component of permissible FAR and / or through applicable / future scheme(s) and / or policies / norms, including but not limited to TOD, TDR, GRIHA, LEED, IGBC etc. and / or any lawful FAR that may be availed through re-development or reconstruction or amalgamation / inclusion of additional land or through any other means.

| S.NO. | PHASE NO. | AREA (ACRE) | FAR TO BE UTILIZED | | TENTATIVE FAR TO BE UTILIZED UNDER TDR FAR (1.5) | | TENTATIVE FAR TO BE UTILIZED UNDER GREEN FAR (0.12) | |
|-------|-----------------------|-------------|--------------------|-------|--|------|---|------|
| | | | SQM | % | SQM | % | SQM | % |
| 1 | PHASE-I | 2.76643 | 18587.52 | 0.733 | 38030.37 | 1.50 | 3042.43 | 0.12 |
| 2 | PHASE-II | 2.42758 | 66489.67 | 2.623 | --- | --- | --- | --- |
| 3 | PHASE-III (EWS+NS+CB) | 1.070 | 3646.80 | 0.144 | --- | --- | --- | --- |
| TOTAL | | 6.26406 | 88723.990 | 3.50 | 38030.37 | 1.50 | 3042.43 | 0.12 |

PHASE - I ---
PHASE - II ---
PHASE - III ---

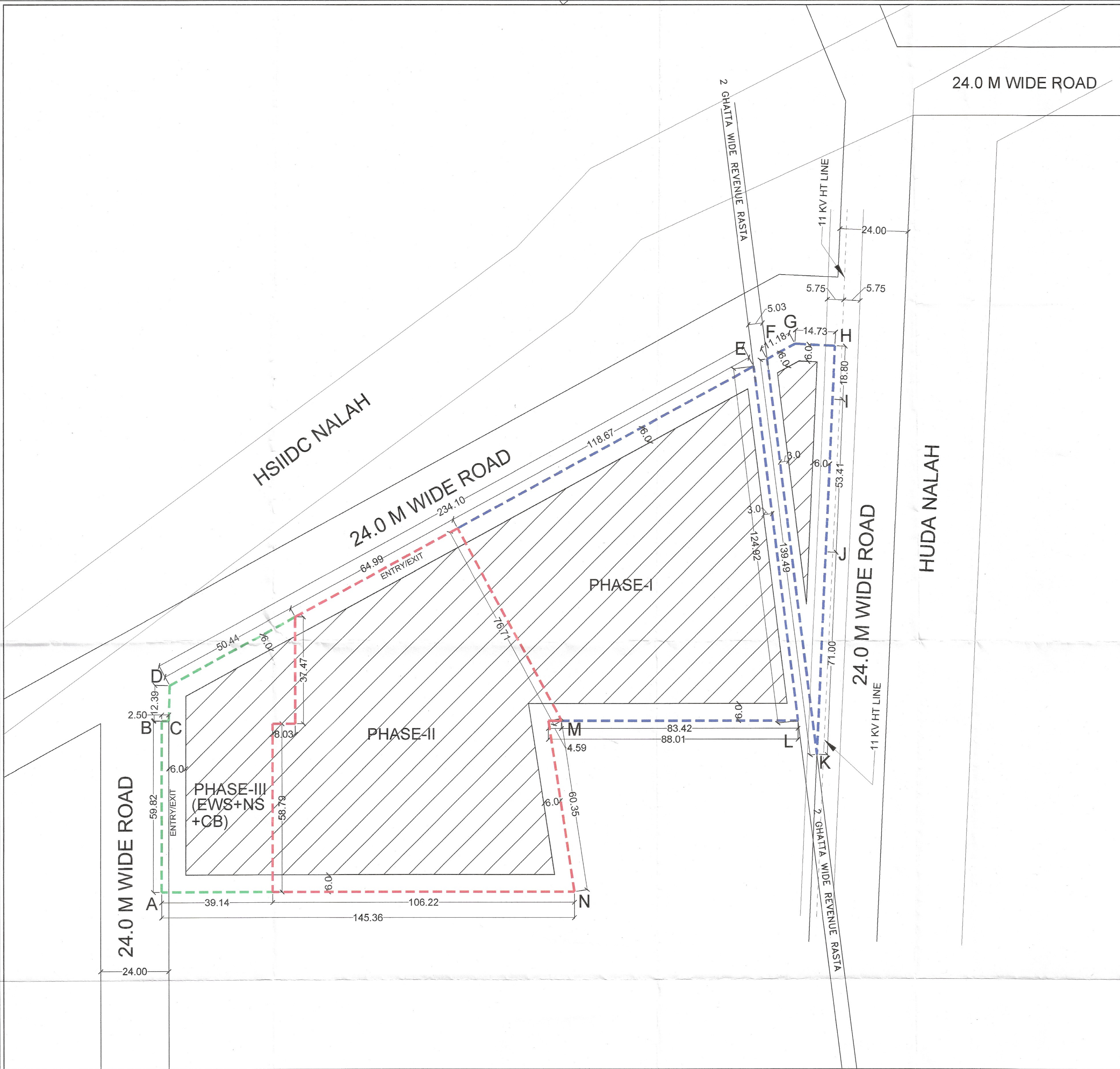

OWNER'S SIGN

ARCHITECT'S SIGN

For NAVRAJ TOWNSHIP PVT. LTD.
[Signature]
Authorised Signatory

[Signature]
VISHAL SHARMA
ARCHITECT
CA-8022301
8010164665
NEW DELHI

DRAWING TITLE

PHASING PLAN

NORTH :

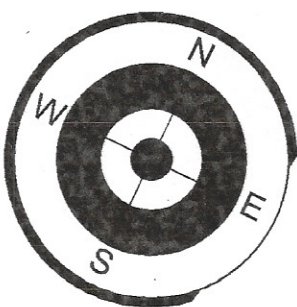

DRG. NO:- DTP 10683 DATED:- 10.12.24

[Signature]
(RAM AVTAR BASSI)
JD (HQ)

[Signature]
(YAJAN CHAUDHARY)
ATP(HQ)

[Signature]
(SUNENA)
DTP (HQ)

[Signature]
(HITESH SHARMA)
STP (HQ)

[Signature]
(JITENDER SIHAG)
CTP (HR)

[Signature]
(AMIT KHATRI, IAS)
DTP (HR)