

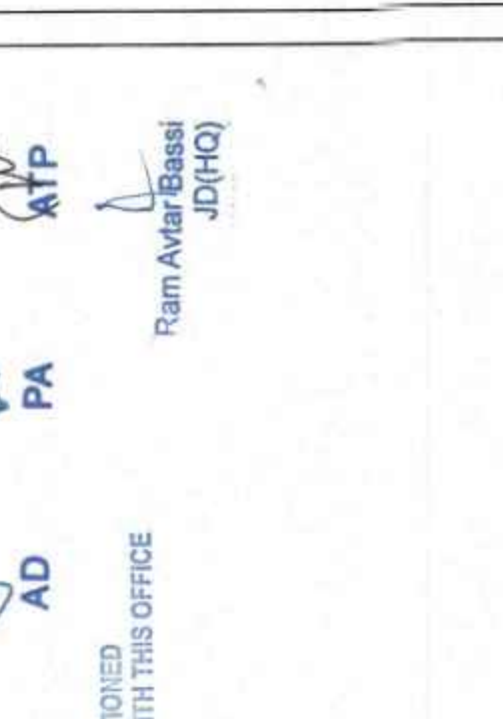

 Rami Al-Nasser, P.E.
 License No. 12554
 State of California
 Structural Engineering



 DTP/H/O



 AD



 V/A

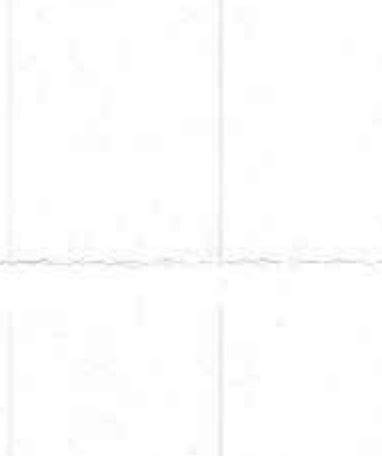

 MTP

Ram Al-Nasser
 J.D.P.H.O.

THIS DEVELOPMENT HAS BEEN CONCEIVED, DESIGNED AND DRAFTED ON THE BASIS OF THE FOLLOWING OFFICE SPACES/RETAIL SPACES (LIKE SHOP/COMMERCIAL OFFICES) WHICH WILL BE MECHANICALLY VENTILATED. THERE IS NO PROVISION HAS BEEN MADE FOR NATURAL VENTILATION OF SPACES. NO ALL TOILETS/KITCHENS WILL BE MECHANICALLY VENTILATED. CONDITIONED AIR VENTED OUT THROUGH A VENT SHAFT.

1. ALL SPACES (OFFICE SPACES/RETAIL SPACES) SERVICE AREAS, PARKING AREAS, TOILETS/KITCHENS SHALL BE MECHANICALLY VENTILATED. THE ENTIRE TOILETS/KITCHENS SERVICE AREAS, PARKING AREAS, TOILETS/KITCHENS SHALL BE MECHANICALLY VENTILATED. THE ENTIRE TOILETS/KITCHENS SERVICE AREAS, PARKING AREAS, TOILETS/KITCHENS SHALL BE MECHANICALLY VENTILATED. THE ENTIRE TOILETS/KITCHENS SERVICE AREAS, PARKING AREAS, TOILETS/KITCHENS SHALL BE MECHANICALLY VENTILATED.

2. THIS BUILDING WILL BE SPRINKLED AS PER NBC NORMS. THE SPRINKLING SYSTEM SHALL BE PROVIDED AS PER NBC NORMS. THE SPRINKLING SYSTEM SHALL BE PROVIDED AS PER NBC NORMS. THE SPRINKLING SYSTEM SHALL BE PROVIDED AS PER NBC NORMS.

3. THIS BUILDING IS NOT MORE THAN 45 METER, AND PROVIDED IS MAX. 44 METER.

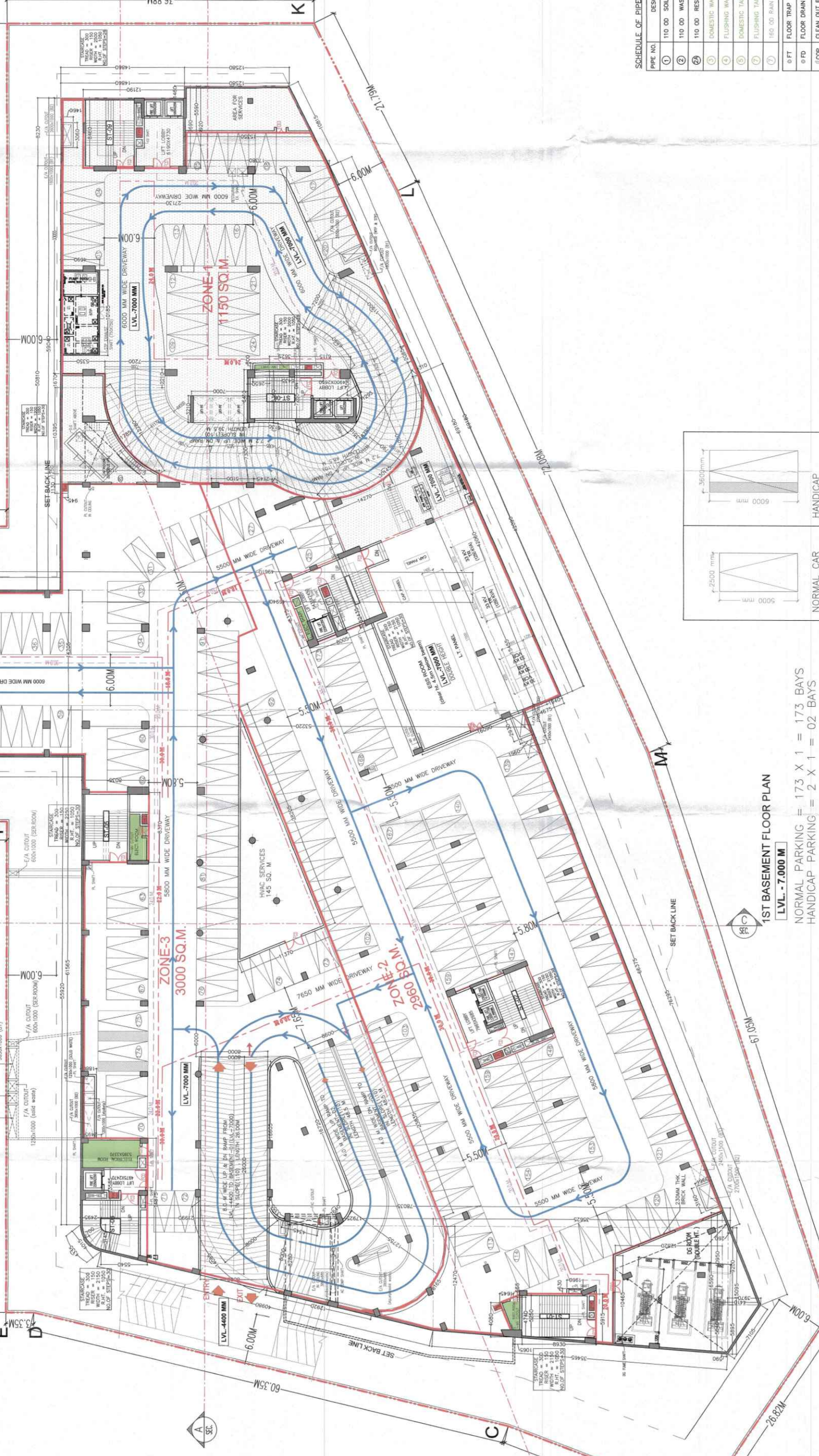
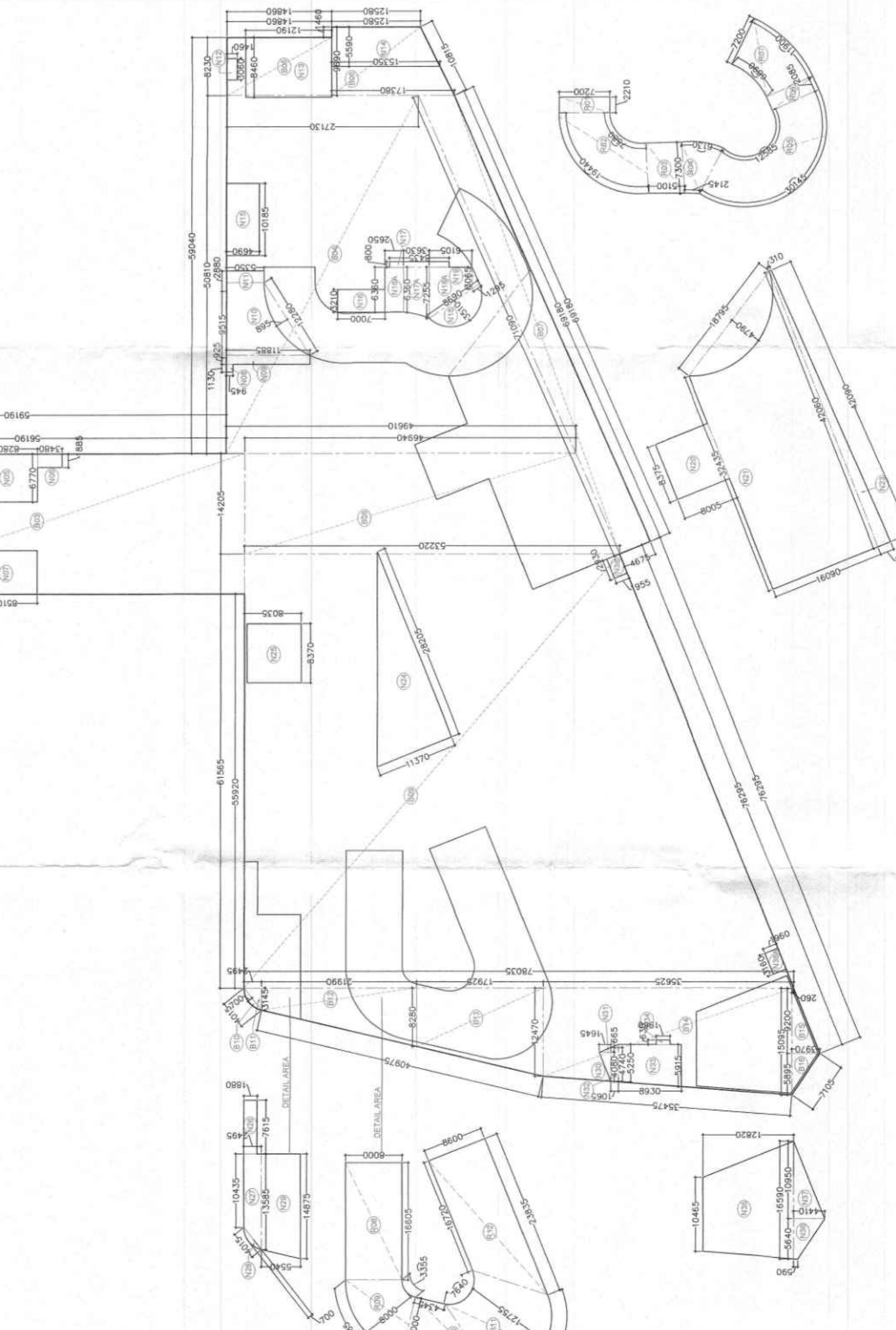

SCHEDULE OF PIPES

PIPE NO.	DESCRIPTION
01	110 OD SOIL PIPE
02	110 OD WASTE PIPE
03	110 OD RESTAURANT WASTE PIPE
04	110 OD RESTAURANT WASTE PIPE
05	FLUSHING WATER SUPPLY
06	FLUSHING WATER SUPPLY
07	DOMESTIC TRUNK FLOORING PIPE
08	FLUSHING TRUNK FLOORING PIPE
09	160 OD RAIN WATER PIPE
10	160 OD RAIN WATER PIPE
11	875 FLOOR TRAP
12	875 FLOOR DRAIN
13	CLEAN OUT FLUSH
14	OUTER DIA. OF PIPE

Basement Calculation For 1st Basement floor

Floors	Average no. of people	No. of people (person)	Stack case Required	Stack case Provided
Basement	90	311.86	10	3118.56
Basement	100	3118.56	10	3118.56
TOTAL				6237.12

181 BASEMENT FLOOR PLAN

GIAN P. MATHUR
 ARCHITECT
 CA No. 13038

ARCHITECT'S SIGN
 OWNER'S SIGN

PROJECT: -
 PROPOSED BUILDING PLAN OF COMMERCIAL OFFICES AND RETAIL SPACES ON THE AREA MEASURING ~3.48875 ACRES (LICENSE NO. 268 OF 2023 DATED 27/11/2023) IN THE CITY OF DUBLIN, COUNTY OF DUBLIN, IRELAND. PREPARED BY DTA REALTECH PVT.LTD. IN COLLABORATION WITH ARCHITECT GIAN P. MATHUR AND CIVIL ENGINEER BUILDWELL LLP.

TITLE: - 1ST BASEMENT FLOOR PLAN
 DATE: - 06/09/2024

Scale: 1:250
 Date: 06/09/2024

TOTAL PARKING AREA AT BASEMENT LEVEL (LVL. -7.000 M)
 NORMAL PARKING = 173 X 1 = 173 BAYS
 HANDICAP PARKING = 2 X 1 = 02 BAYS
 TOTAL PARKING = 173 + 02 = 175 BAYS

