

**REVISED & ADDITIONAL ZONING PLAN OF RESIDENTIAL PLOTTED COLONY MEASURING 110.2075 ACRES IN 300.262 (LICENSE NO. 119 OF 2011 DATED 28.12.2011) + 7.8625 (LICENSE NO. 71 OF 2014 DATED 07.07.2014) + 2.0815 (LICENSE NO. 108 OF 2010 DATED 07.09.2010) AT SECTOR-63 & 63A, GULSHAN MANEER URBAN COMPLEX BEING DEVELOPED BY ANANT RAJ INDUSTRIES LIMITED AND OTHERS.**

For purpose of Code 1.2 (a) & 6.1 (1) of the Haryana Building Code, 2017, as amended from time to time.

**1. USE ZONE:-**

Number	Permissible use of land on the portions of the plot, indicated in column 2	Type of building permissible on the portion indicated in column 2
1	Road	Roof Terrace of apartment flats.
2	Public open space	To be used only for landscape features.
3	Residential Buildable Zone	Residential building.
4	Commercial	As per supplementary zoning plan to the approved master plan for each site.
5	Community building	As per supplementary zoning plan to the approved master plan for each site.

**2. MAXIMUM PERMISSIBLE GROUND COVERAGE, FLOOR AREA AND MAXIMUM PERMISSIBLE HEIGHT / INCLUDING STILL PARKING**

Plot Area (sq. m)	Ground Coverage (%)	Floor Area Ratio (%)	Maximum Permissible Height (m)	Maximum Permissible Height (ft)
Upto 1000	30%	100%	12.00	39.37
1000 to 2000	30%	100%	12.00	39.37
2000 to 3000	30%	100%	12.00	39.37
3000 to 4000	30%	100%	12.00	39.37
4000 to 5000	30%	100%	12.00	39.37
5000 to 6000	30%	100%	12.00	39.37
6000 to 7000	30%	100%	12.00	39.37
7000 to 8000	30%	100%	12.00	39.37
8000 to 9000	30%	100%	12.00	39.37
9000 to 10000	30%	100%	12.00	39.37

The proportion to which a site may be covered with building shall be in accordance with the provisions of Haryana Building Code, 2017.

3. In case of permissible ground coverage as permitted in the rules is not possible to achieve on the ground the same may be achieved to the extent of 10% of the plot area.

4. The maximum height of building shall be as per the provisions of Haryana Building Code, 2017. The maximum height of building shall be as per the provisions of Haryana Building Code, 2017. The maximum height of building shall be as per the provisions of Haryana Building Code, 2017.

5. GENERAL AND NOTES: The building shall be constructed in accordance with the provisions of Haryana Building Code, 2017. The building shall be constructed in accordance with the provisions of Haryana Building Code, 2017. The building shall be constructed in accordance with the provisions of Haryana Building Code, 2017.

6. HEIGHT OF BUILDING AND MINIMUM NUMBER OF STOREY: The maximum height and number of storey shall be as per the provisions of Haryana Building Code, 2017. The maximum height and number of storey shall be as per the provisions of Haryana Building Code, 2017. The maximum height and number of storey shall be as per the provisions of Haryana Building Code, 2017.

7. STILL PARKERS: The provision for still parking shall be as per the provisions of Haryana Building Code, 2017. The provision for still parking shall be as per the provisions of Haryana Building Code, 2017. The provision for still parking shall be as per the provisions of Haryana Building Code, 2017.

8. BUILDING TRACK: The building track shall be as per the provisions of Haryana Building Code, 2017. The building track shall be as per the provisions of Haryana Building Code, 2017. The building track shall be as per the provisions of Haryana Building Code, 2017.

9. MINIMUM HEIGHT: The minimum height of building shall be as per the provisions of Haryana Building Code, 2017. The minimum height of building shall be as per the provisions of Haryana Building Code, 2017. The minimum height of building shall be as per the provisions of Haryana Building Code, 2017.

10. BARRIERS: The provision for barriers shall be as per the provisions of Haryana Building Code, 2017. The provision for barriers shall be as per the provisions of Haryana Building Code, 2017. The provision for barriers shall be as per the provisions of Haryana Building Code, 2017.

11. RETENTION OF ACCESS DRIVE OR PATH: The provision for retention of access drive or path shall be as per the provisions of Haryana Building Code, 2017. The provision for retention of access drive or path shall be as per the provisions of Haryana Building Code, 2017. The provision for retention of access drive or path shall be as per the provisions of Haryana Building Code, 2017.

12. GATE AND GATE POST: The provision for gate and gate post shall be as per the provisions of Haryana Building Code, 2017. The provision for gate and gate post shall be as per the provisions of Haryana Building Code, 2017. The provision for gate and gate post shall be as per the provisions of Haryana Building Code, 2017.

13. GATE AND GATE POST: The provision for gate and gate post shall be as per the provisions of Haryana Building Code, 2017. The provision for gate and gate post shall be as per the provisions of Haryana Building Code, 2017. The provision for gate and gate post shall be as per the provisions of Haryana Building Code, 2017.

14. GATE AND GATE POST: The provision for gate and gate post shall be as per the provisions of Haryana Building Code, 2017. The provision for gate and gate post shall be as per the provisions of Haryana Building Code, 2017. The provision for gate and gate post shall be as per the provisions of Haryana Building Code, 2017.

15. GATE AND GATE POST: The provision for gate and gate post shall be as per the provisions of Haryana Building Code, 2017. The provision for gate and gate post shall be as per the provisions of Haryana Building Code, 2017. The provision for gate and gate post shall be as per the provisions of Haryana Building Code, 2017.

16. GATE AND GATE POST: The provision for gate and gate post shall be as per the provisions of Haryana Building Code, 2017. The provision for gate and gate post shall be as per the provisions of Haryana Building Code, 2017. The provision for gate and gate post shall be as per the provisions of Haryana Building Code, 2017.

17. GATE AND GATE POST: The provision for gate and gate post shall be as per the provisions of Haryana Building Code, 2017. The provision for gate and gate post shall be as per the provisions of Haryana Building Code, 2017. The provision for gate and gate post shall be as per the provisions of Haryana Building Code, 2017.

18. GATE AND GATE POST: The provision for gate and gate post shall be as per the provisions of Haryana Building Code, 2017. The provision for gate and gate post shall be as per the provisions of Haryana Building Code, 2017. The provision for gate and gate post shall be as per the provisions of Haryana Building Code, 2017.

19. GATE AND GATE POST: The provision for gate and gate post shall be as per the provisions of Haryana Building Code, 2017. The provision for gate and gate post shall be as per the provisions of Haryana Building Code, 2017. The provision for gate and gate post shall be as per the provisions of Haryana Building Code, 2017.

20. GATE AND GATE POST: The provision for gate and gate post shall be as per the provisions of Haryana Building Code, 2017. The provision for gate and gate post shall be as per the provisions of Haryana Building Code, 2017. The provision for gate and gate post shall be as per the provisions of Haryana Building Code, 2017.

21. GATE AND GATE POST: The provision for gate and gate post shall be as per the provisions of Haryana Building Code, 2017. The provision for gate and gate post shall be as per the provisions of Haryana Building Code, 2017. The provision for gate and gate post shall be as per the provisions of Haryana Building Code, 2017.

22. GATE AND GATE POST: The provision for gate and gate post shall be as per the provisions of Haryana Building Code, 2017. The provision for gate and gate post shall be as per the provisions of Haryana Building Code, 2017. The provision for gate and gate post shall be as per the provisions of Haryana Building Code, 2017.

23. GATE AND GATE POST: The provision for gate and gate post shall be as per the provisions of Haryana Building Code, 2017. The provision for gate and gate post shall be as per the provisions of Haryana Building Code, 2017. The provision for gate and gate post shall be as per the provisions of Haryana Building Code, 2017.

24. GATE AND GATE POST: The provision for gate and gate post shall be as per the provisions of Haryana Building Code, 2017. The provision for gate and gate post shall be as per the provisions of Haryana Building Code, 2017. The provision for gate and gate post shall be as per the provisions of Haryana Building Code, 2017.

25. GATE AND GATE POST: The provision for gate and gate post shall be as per the provisions of Haryana Building Code, 2017. The provision for gate and gate post shall be as per the provisions of Haryana Building Code, 2017. The provision for gate and gate post shall be as per the provisions of Haryana Building Code, 2017.

26. GATE AND GATE POST: The provision for gate and gate post shall be as per the provisions of Haryana Building Code, 2017. The provision for gate and gate post shall be as per the provisions of Haryana Building Code, 2017. The provision for gate and gate post shall be as per the provisions of Haryana Building Code, 2017.

27. GATE AND GATE POST: The provision for gate and gate post shall be as per the provisions of Haryana Building Code, 2017. The provision for gate and gate post shall be as per the provisions of Haryana Building Code, 2017. The provision for gate and gate post shall be as per the provisions of Haryana Building Code, 2017.

28. GATE AND GATE POST: The provision for gate and gate post shall be as per the provisions of Haryana Building Code, 2017. The provision for gate and gate post shall be as per the provisions of Haryana Building Code, 2017. The provision for gate and gate post shall be as per the provisions of Haryana Building Code, 2017.

29. GATE AND GATE POST: The provision for gate and gate post shall be as per the provisions of Haryana Building Code, 2017. The provision for gate and gate post shall be as per the provisions of Haryana Building Code, 2017. The provision for gate and gate post shall be as per the provisions of Haryana Building Code, 2017.

30. GATE AND GATE POST: The provision for gate and gate post shall be as per the provisions of Haryana Building Code, 2017. The provision for gate and gate post shall be as per the provisions of Haryana Building Code, 2017. The provision for gate and gate post shall be as per the provisions of Haryana Building Code, 2017.

31. GATE AND GATE POST: The provision for gate and gate post shall be as per the provisions of Haryana Building Code, 2017. The provision for gate and gate post shall be as per the provisions of Haryana Building Code, 2017. The provision for gate and gate post shall be as per the provisions of Haryana Building Code, 2017.

32. GATE AND GATE POST: The provision for gate and gate post shall be as per the provisions of Haryana Building Code, 2017. The provision for gate and gate post shall be as per the provisions of Haryana Building Code, 2017. The provision for gate and gate post shall be as per the provisions of Haryana Building Code, 2017.

33. GATE AND GATE POST: The provision for gate and gate post shall be as per the provisions of Haryana Building Code, 2017. The provision for gate and gate post shall be as per the provisions of Haryana Building Code, 2017. The provision for gate and gate post shall be as per the provisions of Haryana Building Code, 2017.

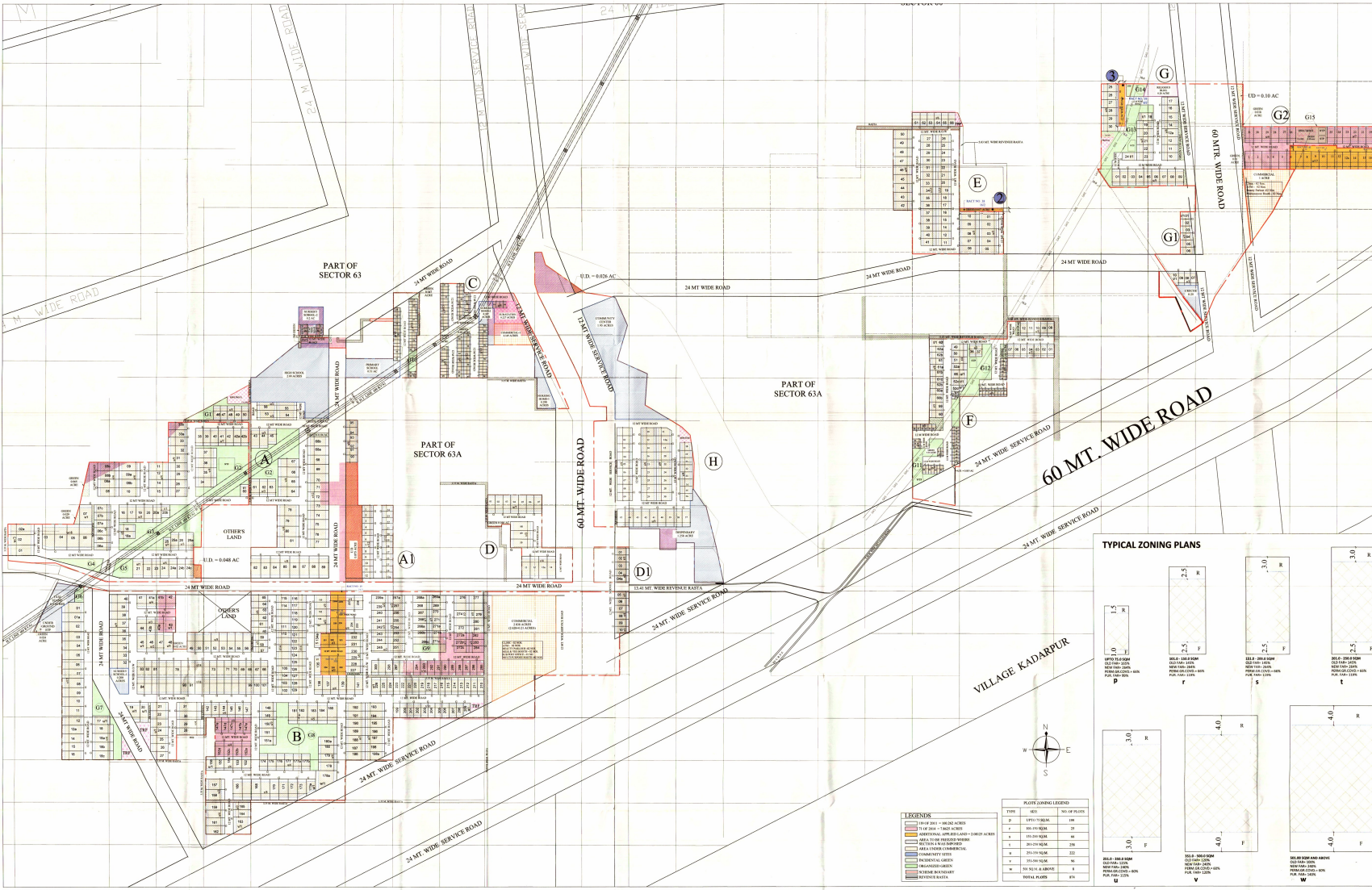

**LEGENDS**

TYPE	WIDTH	NO. OF LANE
1	1.50 M	1
2	2.00 M	2
3	2.50 M	3
4	3.00 M	4
5	3.50 M	5
6	4.00 M	6
7	4.50 M	7
8	5.00 M	8
9	5.50 M	9
10	6.00 M	10
11	6.50 M	11
12	7.00 M	12
13	7.50 M	13
14	8.00 M	14
15	8.50 M	15
16	9.00 M	16
17	9.50 M	17
18	10.00 M	18
19	10.50 M	19
20	11.00 M	20
21	11.50 M	21
22	12.00 M	22
23	12.50 M	23
24	13.00 M	24
25	13.50 M	25
26	14.00 M	26
27	14.50 M	27
28	15.00 M	28
29	15.50 M	29
30	16.00 M	30
31	16.50 M	31
32	17.00 M	32
33	17.50 M	33
34	18.00 M	34
35	18.50 M	35
36	19.00 M	36
37	19.50 M	37
38	20.00 M	38
39	20.50 M	39
40	21.00 M	40
41	21.50 M	41
42	22.00 M	42
43	22.50 M	43
44	23.00 M	44
45	23.50 M	45
46	24.00 M	46
47	24.50 M	47
48	25.00 M	48
49	25.50 M	49
50	26.00 M	50
51	26.50 M	51
52	27.00 M	52
53	27.50 M	53
54	28.00 M	54
55	28.50 M	55
56	29.00 M	56
57	29.50 M	57
58	30.00 M	58
59	30.50 M	59
60	31.00 M	60
61	31.50 M	61
62	32.00 M	62
63	32.50 M	63
64	33.00 M	64
65	33.50 M	65
66	34.00 M	66
67	34.50 M	67
68	35.00 M	68
69	35.50 M	69
70	36.00 M	70
71	36.50 M	71
72	37.00 M	72
73	37.50 M	73
74	38.00 M	74
75	38.50 M	75
76	39.00 M	76
77	39.50 M	77
78	40.00 M	78
79	40.50 M	79
80	41.00 M	80
81	41.50 M	81
82	42.00 M	82
83	42.50 M	83
84	43.00 M	84
85	43.50 M	85
86	44.00 M	86
87	44.50 M	87
88	45.00 M	88
89	45.50 M	89
90	46.00 M	90
91	46.50 M	91
92	47.00 M	92
93	47.50 M	93
94	48.00 M	94
95	48.50 M	95
96	49.00 M	96
97	49.50 M	97
98	50.00 M	98
99	50.50 M	99
100	51.00 M	100

**TYPICAL ZONING PLANS**

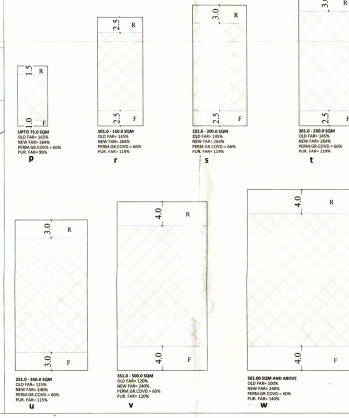

Read this drawing in conjunction with the nomenclature plan as per G.P., Gurugram, Haryana, India in 2017, dated 20.03.2015.

DATE: 01.10.2017

SCALE: 1:1000

PROJECT: GULSHAN MANEER URBAN COMPLEX

CLIENT: ANANT RAJ INDUSTRIES LIMITED

DESIGNER: [Signature]

CHECKER: [Signature]

APPROVER: [Signature]

DATE: 01.10.2017