

Authority Stamp

Architect's Sign & Stamp

For S.S. Group Pvt. Ltd.  
 Registered Professional  
 Registration No. M/2013/19818

- NOTES**
- Dimensions are not to be scaled
  - All dimensions are in mm.
  - All windows and ventilators are operable
  - Lift well are mechanically Pressurized

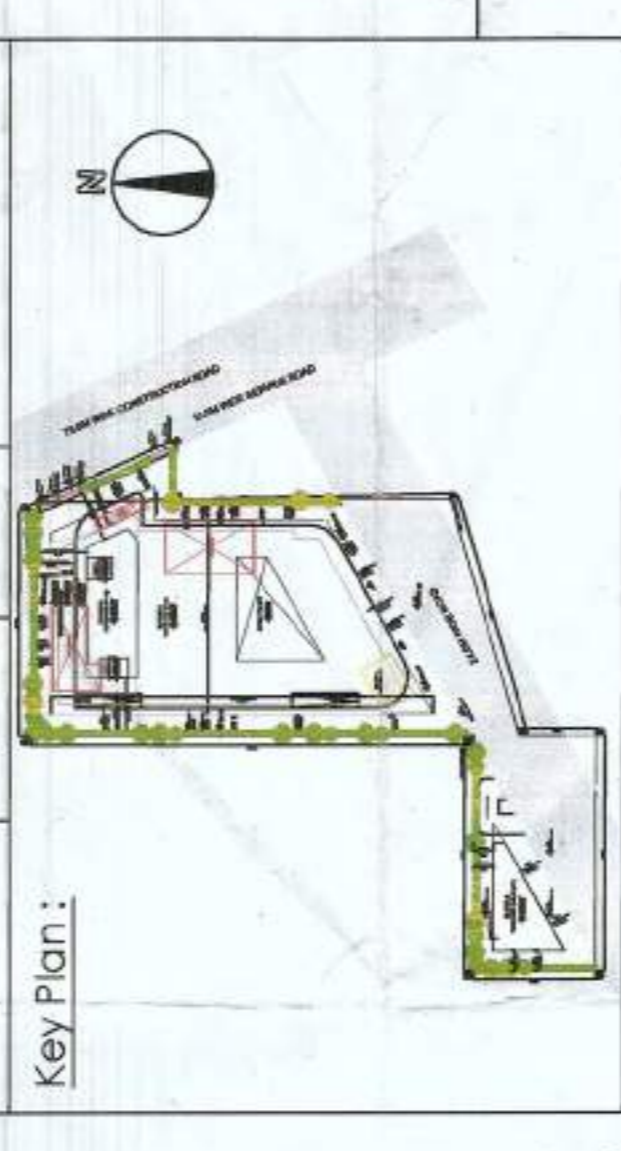

**CLIENTS:**  
**SS GROUP**  
 77, SS House  
 Sector 44, Gurgaon 122003

**ARCHITECTS:**  
**Arcop Associates Pvt. Ltd.**  
 A-15 Parnash Enclave-1, New Delhi-110048, India.  
 Ph.: 26242050  
 Email: virender@arcop.co.in

**STRUCTURES:**  
**DESMAN**  
 A-53 Second Floor, East of Kalkaji  
 New Delhi 110045  
 Tel.: 26834405; Fax: 26834405  
 Email: desman.moadhav@gmail.com

**HVAC:**  
**Envirotech Design Pvt. Ltd.**  
 G-53 Abdul Fasal Enclave Part-II, Janak Nagar  
 New Delhi, India  
 Ph.: 29748091 Email: projects@envirotech.in

**PLUMBING / Fire Fighting:**  
**ARK CONSULTANTS**  
 1/30, Roshan garden-II  
 Kakrola Road, Noida/Gurgaon  
 New Delhi-110043

**PROJECT TITLE:**  
 PROPOSED BUILDING PLAN UNDER TRANSIT ORIENTED DEVELOPMENT (TOD) POLICY DATED 09.02.2016 FALLING IN THE COMMERCIAL COLONY AREA MEASURING 2.806 ACRES (LICENCE NO.04 DATED:17.01.2019) IN SECTOR-86, GURUGRAM BEING DEVELOPED BY SHIVA PROFILES PVT. LTD. AND OTHERS IN COLLABORATION WITH SS GROUP PVT. LTD.

**DRAWING TITLE:**  
**MASTER SITE LAYOUT PLAN (PLUMBING)**

Scale: 1:200  
 Project No:  
 Drawing No: SUB-MP-01  
 Ref:  
 Date: FEB 2019  
 Drawn By: SHANKAR  
 Checked By: MAHENDRA  
 Sheet Size: A0  
 Drawing Status: Submission drawing

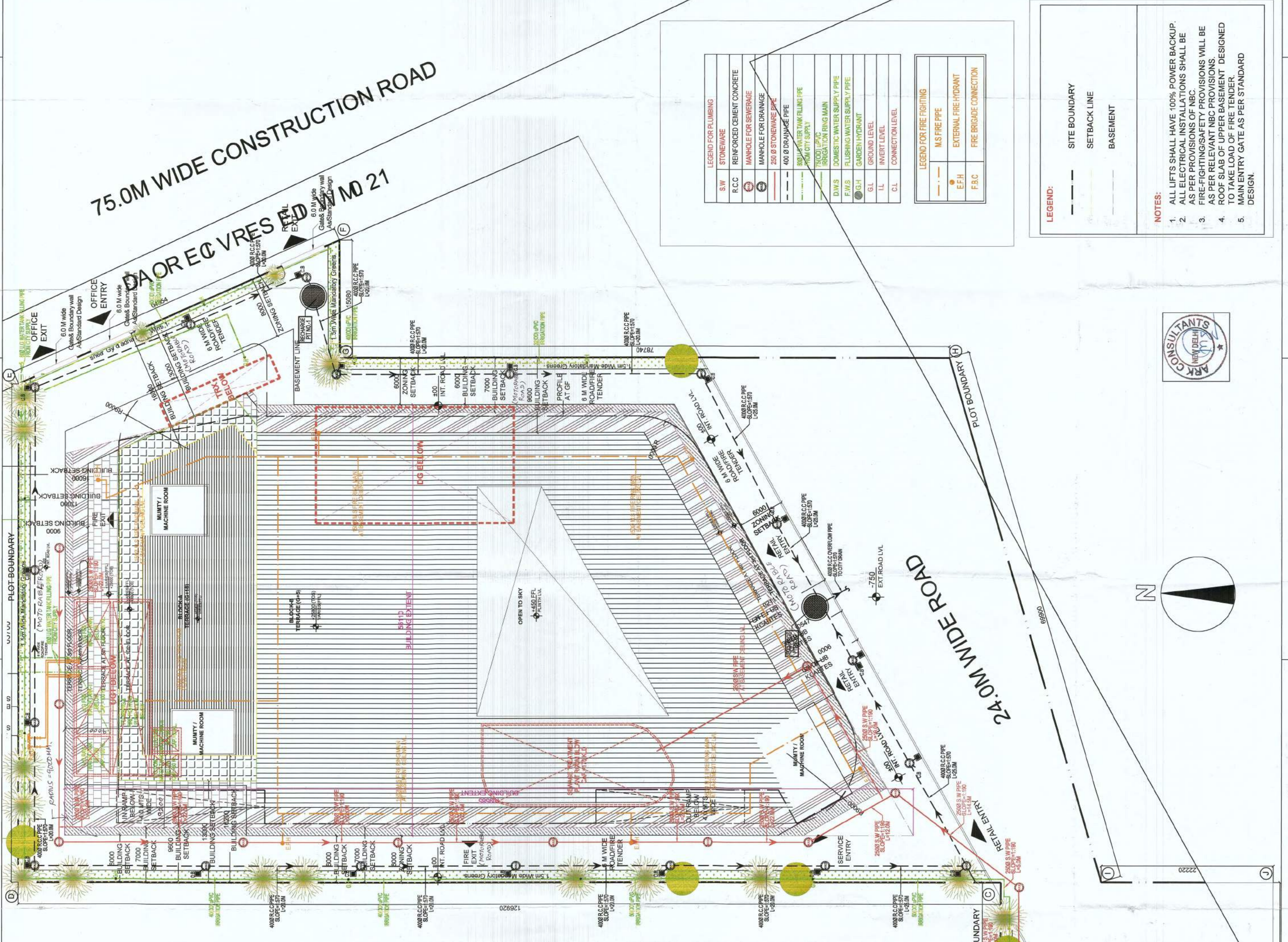

**LEGEND FOR PLUMBING**

S.W	STONEWARE	
R.C.C	REINFORCED CEMENT CONCRETE	
∅	MANHOLE FOR SEWERAGE	
∅	MANHOLE FOR DRAINAGE	
∅	200 Ø STONEWARE PIPE	
---	400 Ø DRAINAGE PIPE	
---	800 Ø WATER MAIN DRAINING PIPE	
---	800 Ø WATER SUPPLY PIPE	
---	1000 Ø WATER MAIN	
---	1500 Ø WATER MAIN	
---	1500 Ø WATER SUPPLY PIPE	
---	1500 Ø PLUMBING WATER SUPPLY PIPE	
---	G.L	GROUND LEVEL
---	I.L	INVERT LEVEL
---	C.L	CONNECTION LEVEL

**LEGEND FOR FIRE FIGHTING**

---	M.S FIRE PIPE	
---	EXTERNAL FIRE HYDRANT	
---	F.B.C	FIRE BRIGADE CONNECTION

**LEGEND:**

- SITE BOUNDARY
- SETBACK LINE
- BASEMENT

- NOTES:**
- ALL LIFTS SHALL HAVE 100% POWER BACKUP.
  - ALL ELECTRICAL INSTALLATIONS SHALL BE AS PER PROVISIONS OF NBC.
  - AS PER RELEVANT NBC PROVISIONS, DESIGNED TO TAKE LOAD OF FIRE TENDER.
  - MAIN ENTRY GATE AS PER STANDARD DESIGN.

**AREA ABSTRACT FOR SITE**

Licensed Site area	2.8060 Acres
Site area for FAR calculation	2.8060 Acres
Permissible FAR @ 250% (Under TOD Policy)	11,355.46 Sq. mts.
Total permissible FAR on 2.8060 @ 2.5 FSU (=11355.48*2.5 SQ.MTS)	28,388.65 Sq. mts.

**FAR STATEMENT**

PERMISSIBLE (in sq.mt.)	PROPOSED (in sq.mt.)
FAR	27,600.368
Balance FAR	788.28
FAR Ratio	2.50

**GROUND COVERAGE STATEMENT**

PERMISSIBLE (in sq.mt.)	PROPOSED (in sq.mt.)
Ground coverage	4,964.783
Ground coverage(%)	43.7%

**PARKING STATEMENT**

Norm	Required	Proposed
1 ECS / 50 Sq.mts for Offices, Retail, F&B, Restaurants and Multiplex on Carpet Area	403	429
<b>TOTAL</b>	<b>403</b>	<b>429</b>

**BASEMENTS PARKING**

ZONE	PROPOSED	TOTAL PROPOSED (With Stack Parking)
Upper Basement Level	78	156
Lower Basement Level-1	80	160
Lower Basement Level-2	113	113
<b>TOTAL NO. OF CARS IN BASEMENTS</b>	<b>271</b>	<b>429</b>

**OVERALL PARKING STATEMENT**

ZONE	NORM	PERMISSIBLE	PROPOSED
1	PARKING IN BASEMENTS @325 SQ.MTS/ECS	318	271
<b>TOTAL PARKING PROPOSED FOR THE DEVELOPMENT</b>		<b>318</b>	<b>429</b>

**AREA STATEMENT AND POPULATION CHART**

SNO.	BLDG. TYPE	FLOOR NAME	NO. OF FLOORS	FARI FLOOR (In sq.mt)	TOTAL FAR (In sq.mt)	Carpet Area-Retail (In sq.mt)
1	BLOCK-A	GF	1	879.307	879.307	620.181
		FF	1	1297.347	1297.347	1039.419
		FF	1	1280.950	1280.950	1039.405
		3F	1	1110.254	1110.254	1029.349
		4F	1	982.524	982.524	770.123
		5F	1	711.760	711.760	602.784
		6F-7F-8F	3	753.480	2260.440	1808.467
		8F	1	711.760	711.760	602.784
		10F: 11F: 13F: 14F: 15F: 17F: 18F	7	503.883	3525.783	2877.678
		12F	1	481.449	481.449	392.401
		16F	1	481.449	481.449	392.401
		<b>TOTAL AREA (BLOCK-A)</b>	<b>13</b>	<b>10939.022</b>	<b>13,858.895</b>	<b>11,355.463</b>
2	BLOCK-B	GF	1	2973.85	2973.846	1358.317
		FF	1	2578.19	2578.19	1855.817
		FF	1	2584.68	2584.68	1855.817
		3F	1	2916.98	2916.98	1976.134
		4F	1	2034.61	2034.609	1510.725
		<b>TOTAL AREA (BLOCK-B)</b>	<b>5</b>	<b>10988.265</b>	<b>10,988.265</b>	<b>8,127.646</b>
3	BLOCK-C	LOWER GF	1	287.68	287.684	192.595
		GF	1	282.21	282.214	190.454
		FF	1	299.01	299.007	200.484
		<b>TOTAL AREA (BLOCK-C)</b>	<b>3</b>	<b>849.084</b>	<b>849.084</b>	<b>648.673</b>
<b>TOTAL FAR ACHIEVED (A+B+C)</b>		<b>27,600.37</b>	<b>27,600.37</b>	<b>20,129.31</b>		

