



JMS GROUP
PREMIER
FLOORS II
SECTOR 95, GURUGRAM



*Artistic Impression

DISCOVER YOUR
FAMILY'S FOREVER HOME

For You and
Your Family

Welcome to JMS Group Premier Floors II, nestled within the expansive and vibrant community of The Nation. Situated amidst 22.34 acres of beautifully designed landscapes of The Nation, our JMS Group Premier Floors II are crafted keeping you and your family's needs in mind. At JMS Group Premier Floors II, we understand the importance of a comfortable and luxurious living space, and we've gone above and beyond to create homes that cater to your everyday need.



*Artistic Impression

LIFE DESIGNED AROUND YOU

Prepare to be dazzled by awe-inspiring amenities, designed to elevate your lifestyle to new heights.



Perennial Garden



Fitness Trail



Plumeria Garden



Meditation Area



*Artistic Impression

BRIGHT HOME FOR YOUR CHILD'S BRIGHT FUTURE

A place where your children can enjoy themselves to the fullest. Let your young ones play freely.



Cricket Practice Net



Tot-Lots



Cycling Track



Half Basketball Court



*Artistic Impression

A LUXURIOUS HOME FOR YOUR PARENTS' GOLDEN YEARS

At JMS Group Premier Floors II, our spacious living areas are designed for unforgettable family moments while also providing amenities for the best life for parents and seniors.



Planters



Rejuvenating Zone



Ladies Alcove



Bosque of Trees





AMENITIES FOR UNMATCHED LAVISHNESS

With The Nation providing a happy environment for your family, JMS Group Premier Floors II offers you a taste of urban life just outside your door through well-maintained amenities.



Gated Community



Meditation Area



Cycling Track



Fitness Trail



Rejuvenating Zone



Cricket Practice Net



Seating Enclave



Reflexology Path



Art Works



Aroma Garden



Sculpture Garden



Bosque of Trees



Yoga Lawn



Plumeria Garden



Skating Rink



Tot-Lots



Half Basketball Court



Palm Garden



Ladies Alcove



Perennial Garden



Open-Air
Amphitheatre



Badminton Court



Mound



Stambh



Planters



Celebration Greens



Butterfly Garden



Outdoor
Gathering Area



Skating Rink



Aroma Garden



Reflexology Path

*Artistic Impression



Open-Air Amphitheatre

*Artistic Impression



Badminton Court



Seating Enclave



Yoga Lawn

*Artistic Impression



Sculpture Garden

*Artistic Impression



SPECIFICATIONS



LIVING / DINING / LOBBY / PASSAGE

- Split AC : LG / Samsung / Voltas or Equivalent brand
- Flooring : Vitrified Tiles
- Walls : Acrylic Emulsion / OBD
- Ceiling : Acrylic Emulsion / OBD



MASTER BEDROOM

- Split AC : LG/ Samsung/ Voltas or Equivalent brand
- Flooring : Laminated Wooden Flooring / Vitrified Tiles
- Walls : Acrylic Emulsion / OBD
- Ceiling : Acrylic Emulsion / OBD



BEDROOM

- Split AC : LG / Samsung / Voltas or Equivalent brand
- Flooring : Laminated Wooden Flooring / Vitrified Tiles
- Walls : Acrylic Emulsion / OBD
- Ceiling : Acrylic Emulsion / OBD



KITCHEN

- Modular Kitchen with Hob and Chimney
- CP Fittings: Hindware/ Cera/ Parryware or Equivalent brand & SS Sink
- Countertop with Granite Stone
- Flooring : Anti-Skid Tiles
- Walls : Tiles up-to 2' feet & Acrylic Emulsion Paint
- Ceiling : OBD



EXTERNAL GLAZINGS

- Windows / External Glazings: UPVC



BALCONY

- Glass railing
- Flooring : Anti-skid Tiles
- Doors : UPVC
- Ceiling : OBD

SPECIFICATIONS



DOORS

- Internal Doors : Flush Panel Doors
- Entrance Doors : Painted Frame with Laminated Flush Door
- Digital Door Lock For The Main Door



TOILETS

- Flooring: Anti-skid Tiles
- Walls: Combination of Tiles / Acrylic Emulsion Paint
- Mirror
- Ceiling: OBD
- Geysers
- CP Fittings, WC & Wash Basin with Granite Counter
- Wall tiles till 7 feet
- Fittings / Fixtures: Exhaust Fan, Towel Rail, Ring of Standard make



ELECTRICAL FIXTURES / FITTINGS

Electrical Copper Wiring in Concealed Conduits for all Light and Power Points with Modular Switches



SECURITY SYSTEM

CCTV in Driveway of Parking & Entrance Lobby



ELEVATORS

Elevator – Johnson/ Kone or Equivalent Brand



STAIRCASES FLOORING

Kota Stone / Granite Walls: Acrylic Emulsion / OBD

FLOOR PLAN

2.5 BHK+2T



Basement Plan

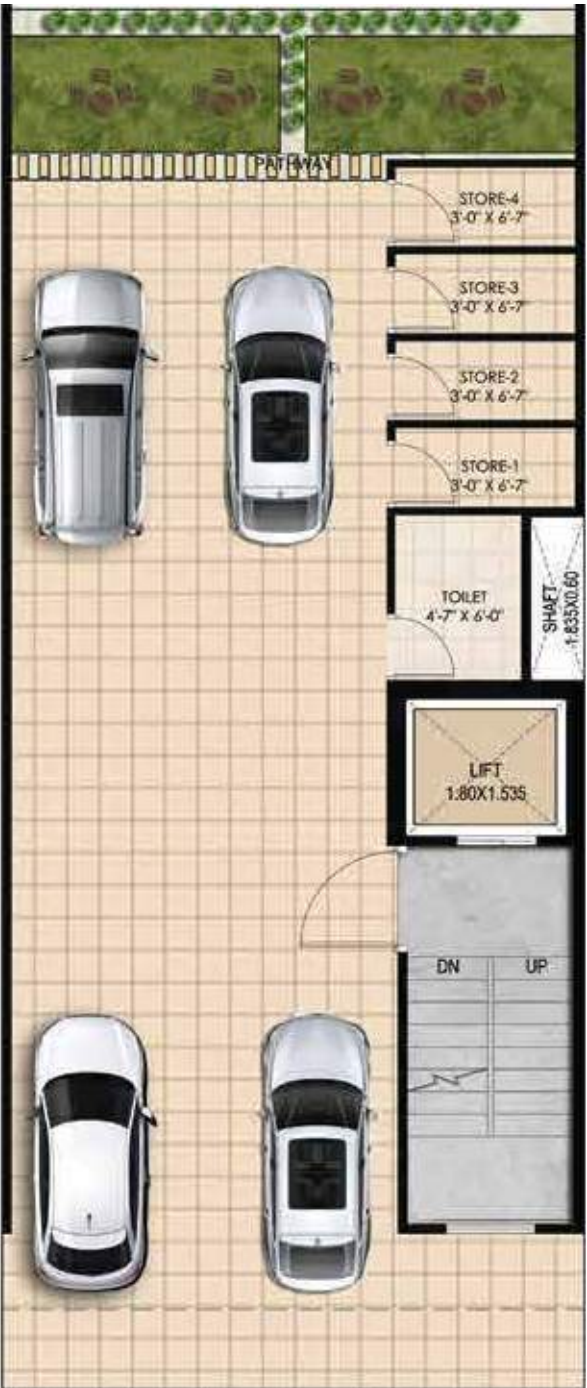

Stilt Plan

PLOT AREA

100.75 Sq. Mtr.



Typical Plan



Terrace Plan

FLOOR PLAN

3.5 BHK+3T



Basement Plan

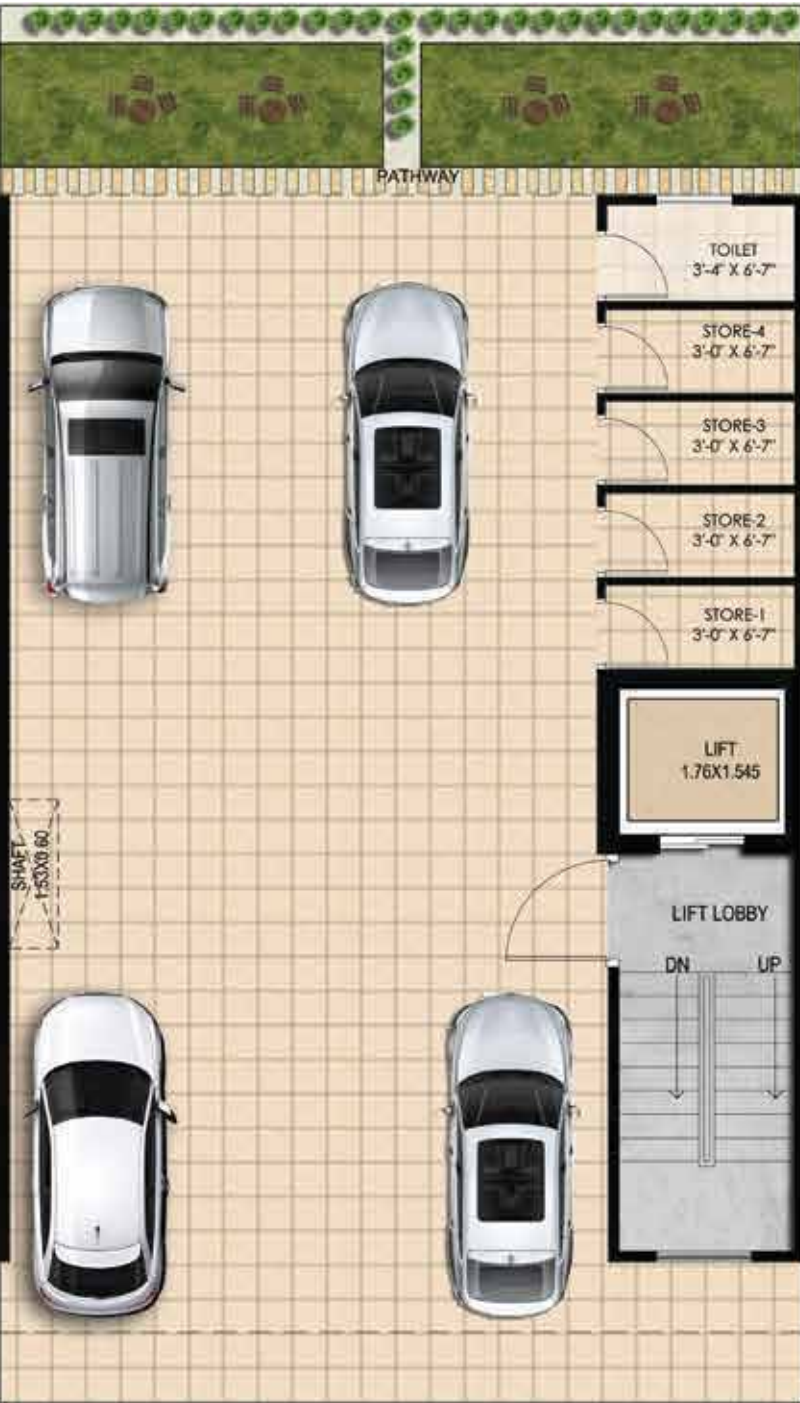

Stilt Plan

PLOT AREA

125.375 Sq. Mtr.



Typical Plan



Terrace Plan

LOCATION ADVANTAGES

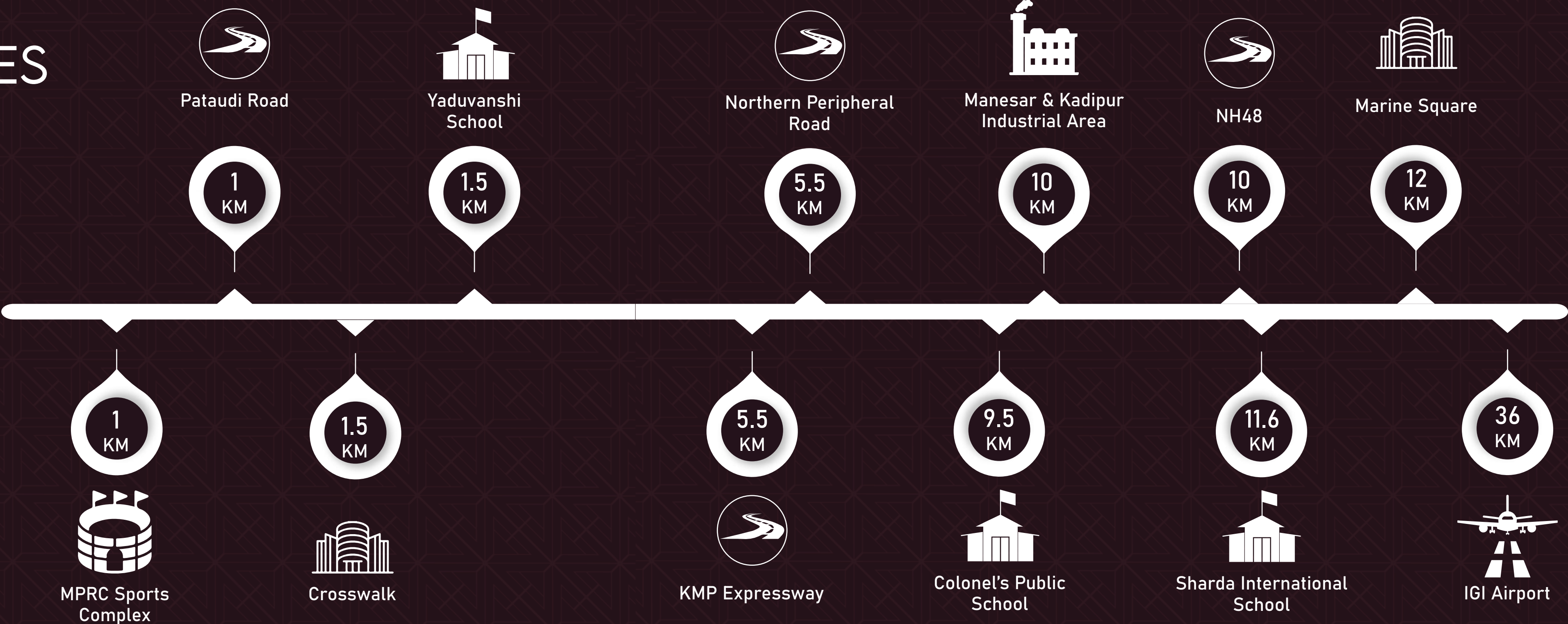

Disclaimer:- *Promoter/Company has registered the Project- "JMS GROUP PREMIER FLOORS II" situated at Sector 95, Gurugram, Haryana under RERA vide Registration No. XXXXXXXXXXXXXXXXXXXXXXXXXXXXXXXX
This map and the data contained in it, are for assessment and depicting purposes only. The Promoter/Company makes no representation or warranty regarding the accuracy or completeness of the information presented and assumes no responsibility for any damage, loss or injury resulting from the use of this map. The Pictures, images, designs, specifications, information, contents and other details herein are merely an indication for the purpose of depicting the appearance of the project's location and is for general information only.

LAYOUT PLAN



*Artistic Impression

LOCATION MAP



*Not to scale

OUR PROJECTS



Situated at Sector 93, Gurugram, Crosswalk is a marvel of craftsmanship and luxury. With its intricate, Spanish-style architecture and serene ambiance, it is the perfect destination for discerning customers who want to experience luxury retail at its best. Spanning over two acres, Crosswalk offers a unique shopping experience unlike any other.

HARERA No. RC/REP/HARERA/GGM/313/45/2019/07 DATED 18/02/2019



Marine Square is an epitome of fine craftsmanship and luxurious indulgence. With its exquisite Spanish-style architecture and tranquil ambiance, it serves as an ideal destination for discerning customers who seek an unparalleled experience of luxury retail. Spanning over two acres, Marine Square offers a shopping experience that is truly distinctive and unmatched.

HARERA No. 22 of 2018 DATED 02/02/2018



Mega City, exquisite residential plots, offers a magnificent living experience. Equipped with a modern clubhouse, and top-notch amenities, residents can indulge in a luxurious mega lifestyle. Enjoy the perfect blend of urban convenience and opulent comfort at Mega City.

HARERA No. RC/REP/HARERA/GGM/720/452/2023/64 DATED 23/05/2023



Primeland exemplifies the pinnacle of upscale living. With meticulous design, a serene ambiance, and unwavering attention to every detail, it stands as the ultimate choice for those in pursuit of an extraordinary residential lifestyle. Primeland provides an exceptional living environment unmatched in every way.

HARERA No. RC/REP/HARERA/GGM/435/167/2021/03 DATED 18/01/2021



The Nation is a masterpiece of opulence and artistry. With its captivating architecture and tranquil surroundings, it presents an idyllic haven for individuals seeking the epitome of residential plots. Expanding over expansive acres, The Nation offers an unparalleled living experience beyond compare.

HARERA No. RC/REP/HARERA/GGM/745/477/2023/89 DATED 11/09/2023



The Pride epitomizes the artistry of fine design and unparalleled extravagance. Its intricate architectural mastery and tranquil surroundings provide an idyllic sanctuary for those in pursuit of residential magnificence. Encompassing expansive grounds, The Pride crafts an extraordinary living journey that transcends every expectation.

HARERA No. RC/REP/HARERA/GGM/643/375/2022/118 DATED 13/12/2022



Step into a world where every moment with your family is precious. Our celebration of joy, love, and togetherness is woven seamlessly into the fabric of each day. Nestled in Sector 95, Gurugram, The Pearl offers excellent connectivity to the vibrant city life while providing an oasis of peace, serenity, and tranquility for a truly peaceful residence.

HARERA No. RC/REP/HARERA/GGM/779/511/2024/06 DATED 30/01/2024



*Artistic Impression





*Artistic Impression

We are JMS Group

We stand as a forward-thinking force in the real estate realm, reshaping the NCR with unwavering commitment, honesty, and clarity. Our dedication to fulfilling promises and nurturing unity forms the bedrock of enduring relationships. Infused with unmatched professionalism, we transform the real estate landscape through innovations. Embark on a journey with us to witness unparalleled experience and forge enduring connections as we propel forward with unwavering dedication to excellence.

BUILDING TOMORROW, TOGETHER



 JMS Group, M3M Tee Point, 7th Floor, North Block, Sector 65, Gurugram, Haryana -122018

 8010000777  www.jmsgroup.co.in

Disclaimer: *Promoter/Company has registered the Project- "**JMS GROUP PREMIER FLOORS II**" under RERA vide Registration No. XXXXXXXXXXXXXXXXXXXXXXXXXXXXXXXXXXXX
The Pictures, images, designs, specifications, information, contents and other details herein are merely an indication for the purpose of depicting the appearance of the project "**JMS GROUP PREMIER FLOORS II**" of the Company/Promoter M/s JMS Infra Reality Pvt. Ltd. and is for general information only. The said information etc. provided herein is only for guidance and must not be relied on as such and shall not be construed as an advertisement for marketing purposes, offer for sale, assurance, invitation to offer, contract of any nature whatsoever or gives warranty of any kind, implied express or statutory and shall have no binding effect on the Company/Promoter. The said information etc. is subject to change without any notice or intimation whatsoever. Any decision of buying or investing in the project of Company/Promoter should be upon complete verification of all the details including area, specifications, services, approvals, permissions and other relevant terms independently with the authorized sales team of the company/Promoter, at the company's/promoter's offices/site offices. Company/Promoter, their affiliates, nor any of their respective directors, officers, employees, agents or representatives shall not be liable for any loss, expenses or damage including, without limitation, indirect or consequential loss or damage or any expense, loss or damage etc. whatsoever arising from use, or loss of use, of data/information etc. and shall also not be liable for any expenses, loss or damages of any kind arising from the information etc. or any inaccuracy in the information etc. mentioned herein **T&C Apply.