

GROUND COVERAGE AREA CALCULATION

Description	Length (m)	Breadth (m)	BASE (m)	HEIGHT (m)	Area (sqm)	No. of Figures	Total Area (sqm)
Area of Trapezoid A	7.98	20.00	21.535	—	31.64	1.00	261.64
Area of Rectangle B	116.90	—	—	—	2001.20	1.00	2207.20
Area of Triangle C	24.340	0.565	0.565	—	6.69	2.00	0.18
Area of Triangle D	—	—	—	—	12.17	1.00	12.17
Area of Triangle E	17.785	3.280	20.000	—	16.95	1.00	16.95
Area of Rectangle F	21.000	36.810	—	—	773.61	1.00	210.66
Area of Rectangle G	6.100	23.340	—	—	142.37	1.00	142.37
Area of Triangle H	—	—	—	—	18.73	2.00	18.73
Area of Triangle I	11.780	28.880	—	—	180.38	1.00	180.38
Area of Triangle J	14.000	39.780	—	—	255.80	1.00	555.80
Area of Trapezoid K	7.200	12.005	—	—	43.22	1.00	43.22
Area of Trapezoid L	4.015	12.225	—	—	109.33	1.00	109.33
Area of Triangle M	—	—	—	—	3.66	1.00	3.66
Area of Rectangle N	3.000	8.000	—	—	24.00	1.00	24.00
Total of all additions A'							4847.78
Subtractions B'							
Area of Triangle 1	—	—	3.010	18.185	27.29	1.00	27.29
Area of Triangle 2	—	—	3.000	17.810	26.81	1.00	26.81
Area of Parallelogram 3	—	—	7.410	12.615	78.68	1.00	78.68
Area of Parallelogram 4	—	—	7.410	11.910	22.01	1.00	22.01
Total of all deductions B'							136.79
Total ground coverage area = (A' - B')							4681.42

Total Plot Area (Sq. M.)	130,11.05	2.968 Acres
Permissible FAR @ 1.75 (Sq. M.)	22769.34	
Permissible Ground Coverage @ 40% (Sq. M.)	4521.42	
Ground	4681.42	
Total (%)	35.06	

Floor	Area (Sq. M.)	Area (Sq. Ft.)
Lower Ground Floor	2903.45	31181.00
Upper Ground Floor	2008.20	21648.00
1st Floor	2223.715	23948.00
2nd Floor	194.586	2108.00
3rd Floor	1879.833	20388.00
4th Floor	1471.980	15888.00
5th Floor	1381.192	14848.00
6th Floor	1242.511	13448.00
7th Floor	1242.511	13448.00
8th Floor	1242.511	13448.00
Total	21016.236	226488.00
Lower Ground Floor @ -1.50 m	1136.13	12248.00

ECS required @ 1.0 ECS / 50 sq. mt. of covered area	420	Basement 1 = 166 ECS
Required street level parking @ 15% of total	51	Basement 2 = 143 ECS
ECS Provided	420	Surface = 71 ECS

Basement 1 @ -1.500 m	Basement 2 @ -2.500 m
Area under Basement Level 1 (1:12000 N.J.)	8160.41
Area provided under services	1787.50
Area Under parking	6453.12
Permissible car parking	183
Provided car parking	183
Basement 2 @ -2.500 m	8160.41
Area provided under services	1787.50
Area Under parking	6453.12
Permissible car parking	183
Provided car parking	183

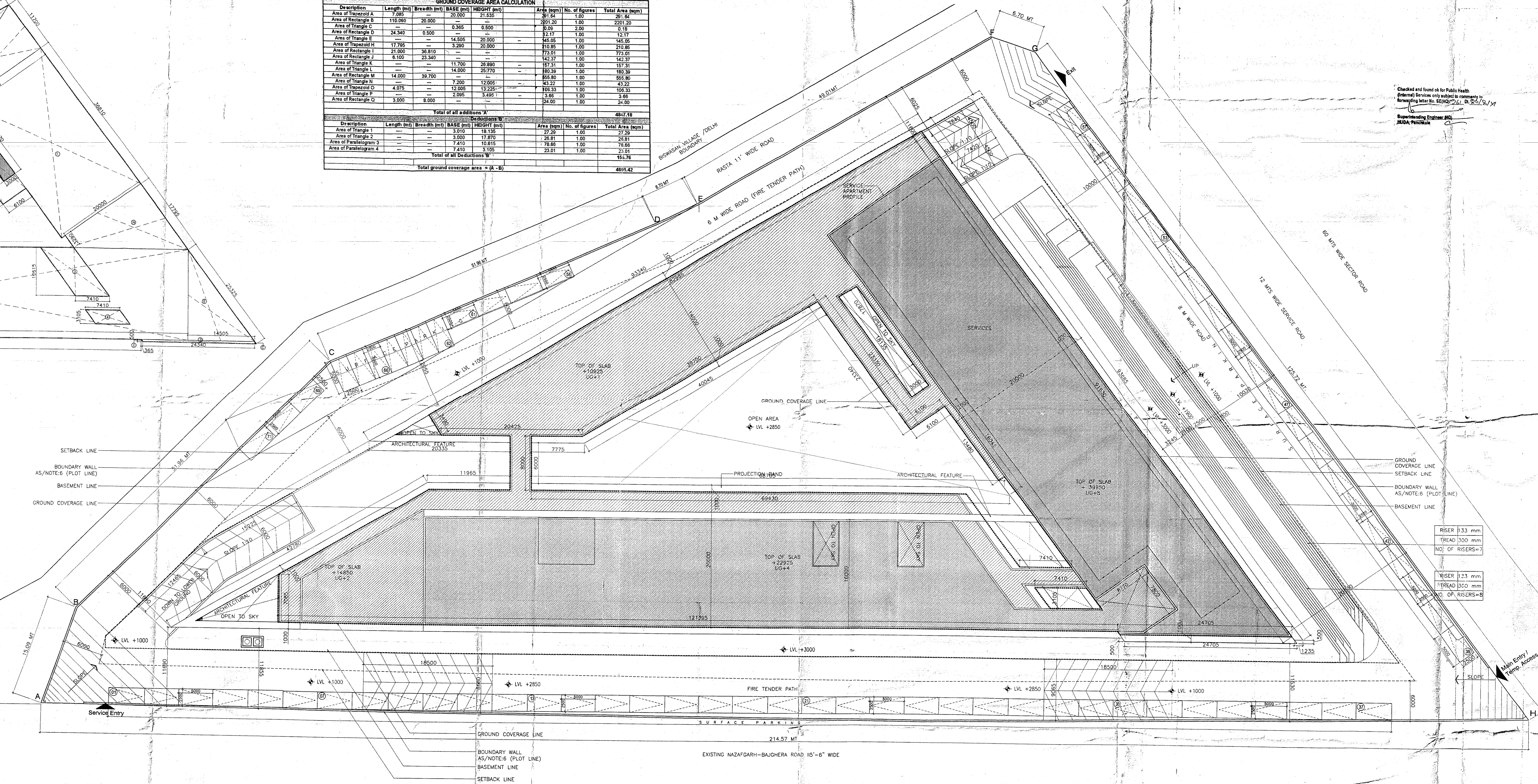

- NOTES:**
- 1) ALL FIXTURE PROVIDED IN TOILETS ARE AS PER N.B.C.
 - 2) BASEMENT WILL BE ARTIFICIALLY VENTILATED. ALL SPACES (OFFICE, PARKING, BASEMENT, SERVICES BASEMENT ETC.) WILL BE ARTIFICIALLY LIGHT. ANY NATURAL LIGHT WHICH IS AVAILABLE IN THE OFFICE SPACES IS ONLY INCIDENTAL IN THE AND NOT ESSENTIAL TO THE FUNCTIONALITY OF THE BUILDINGS.
 - 3) STANDBY GENERATING CAPACITY WILL BE PROVIDED FOR THE ELECTRICAL REQUIREMENT OF THE TOTAL SCHEME. THIS THEREFORE INCLUDES STANDBY GENERATION FOR ALL COMMON SERVICES, FIRE SERVICES, LIFTS ETC AND ALSO THE ENTIRE ELECTRICAL LOAD FOR THE VENTILATION. THIS BUILDING SHALL BE SPRINKLERED.
 - 4) AS/NBC.
 - 5) FIRE SAFETY MEASURES AS/NBC INCLUDES: SMOKE DETECTOR - EAT C/C (WHEREVER REQUIRED), SPRINKLER 3MT C/C HEAT DETECTOR - EAT C/C (WHEREVER REQUIRED).
 - 6) THE HEIGHT OF BOUNDARY WALL OR FENCE AND GATE SHALL BE IN ACCORDANCE WITH THE PROVISIONS OF THE ZONING PLAN. IF IT IS NOT AVAILABLE IN ZONING PLAN IT WILL BE TAKEN AS 5.0 FT.

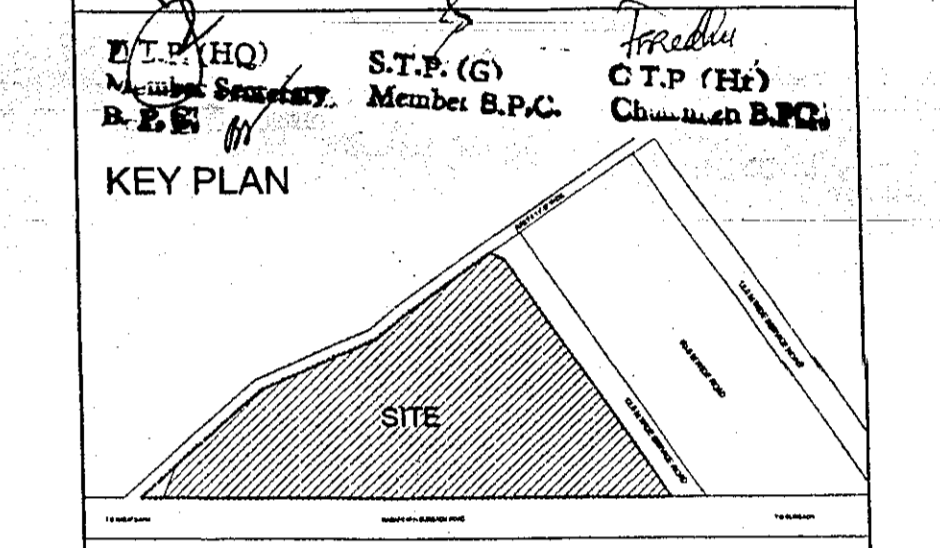

Project: **AD ID PA ATP**

Proposed Commercial Colony measuring 2.968 acres in Sector 114, Gurgaon
Mansarovar Urban Complex being developed by M/S AND ESTATE AND DEVELOPERS PVT LTD.

Owner's Sign: *[Signature]*

For: M/S AND ESTATE AND DEVELOPERS PVT. LTD.
c/o VSR Infotech Pvt. Ltd.
A-22, Hill View Apartments
Vasant Vihar, New Delhi 110057

Architect's Sign: *[Signature]*

Morphogenesis
No-208, Panchsheel Park, New Delhi, 110017, India.
TELEPHONE: 41252510 Fax: 91 11 26490351
E-Mail: studio@morphogenesis.org

Drawing Title: **SITE LAYOUT**

Sanction: **S-01/01**

Drawing No. **S-01/01**

Scale: **1:200**

Date: **NOV '11**