

M
(CHANDER SHEKHAR KHARE, IAS)
C.A., HSVP, PANCHKULA

(RAVI PARKASH SIHAG)
CTP, HSVP, PANCHKULA

(LATA HOODA)
STP, HSVP (HQ) PANCHKULA

(ANIL KUMAR)
SE, HSVP (HQ) PANCHKULA

(ANIL MALIK)
DTP, HSVP (HQ) PANCHKULA

G-32

G-33

G-34A

G-27

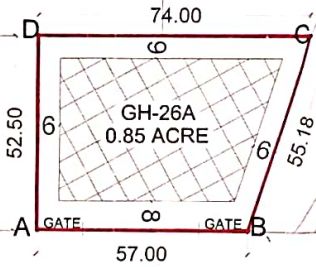

30.0 Mtr wide Road

HOSPITAL

SITE FOR

G.H.-26A SECTOR-56

TOTAL SITE AREA = 3438.7462 SQM

ZONED AREA = 2060.4048 SQM OR 59.91%

PERMISSIBLE F.A.R. 2.50 AS PER TOD POLICY = 3438.7462 x 2.50 = 8596.8655 SQMT

PERMISSIBLE F.A.R. 1.50 AS PER TDR POLICY = 3438.7462 x 1.50 = 5158.1193 SQMT

GRIHA FOUR STAR PRE-CERTIFICATION F.A.R. 12% = 3438.7462 x $\frac{12}{100}$ = 412.649 SQMT.

TOTAL MAXIMUM PERMISSIBLE F.A.R.

(8596.8655 + 5158.1193 + 412.649)

= 14167.6338 SQMT (4.12)