

PLOT AREA = 20335.42 SQ. MT.
= (5.025 ACRES)
ALL DIMENSIONS ARE IN METERS

AUTHORITY SIGNATURE

NOTES
1. ALL DIMENSIONS ARE IN MILLIMETER UNLESS STATED OTHERWISE.
2. THE CONSTRUCTION OF THE BUILDINGS SHALL BE GOVERNED BY PROVISIONS OF HARYANA BUILDING CODE, 2011 WHERE HARYANA BUILDING CODE, 2011 IS SILENT THE NATIONAL BUILDING CODE OF INDIA, 2016 SHALL BE FOLLOWED.
3. THE GATE AND BOUNDARY WALL BE CONSTRUCTED AS/ACCORD.
4. THE CONSTRUCTION OF BASEMENT BE EXECUTED AS/ACCORD.
5. LIFTS & RAMPS IN BUILDING AS/ACCORD.
6. PROPER FIRE SAFETY MEASURES PROVISIONS AS PER CODES.
7. INSTALLATION OF SOLAR POWER PLANT AS/ACCORD.
8. ADEQUATE PARKING SPACES - COVERED, OPEN OR IN THE BASEMENT AS/ACCORD.
9. PROVISION OF SEWAGE TREATMENT PLANT AS/ACCORD.

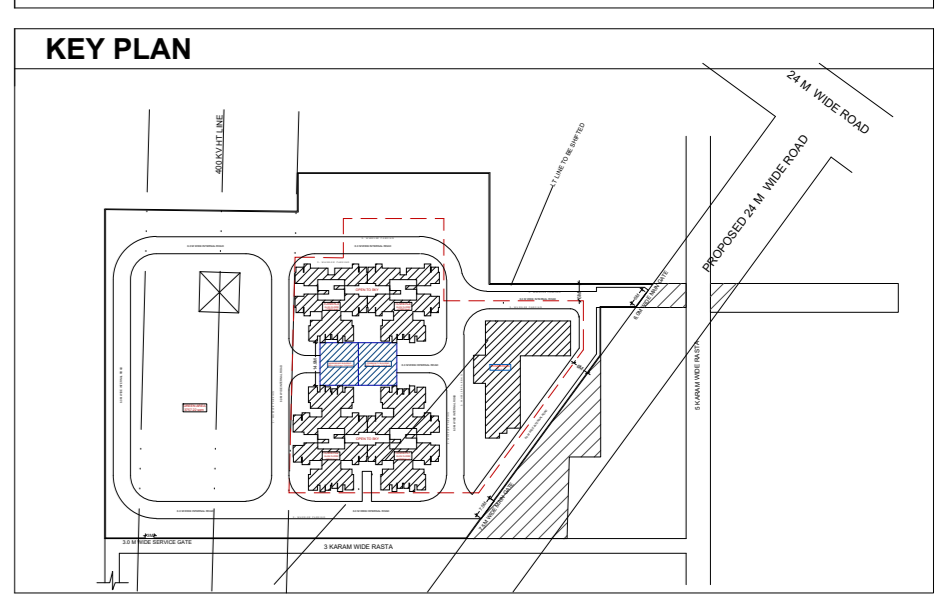
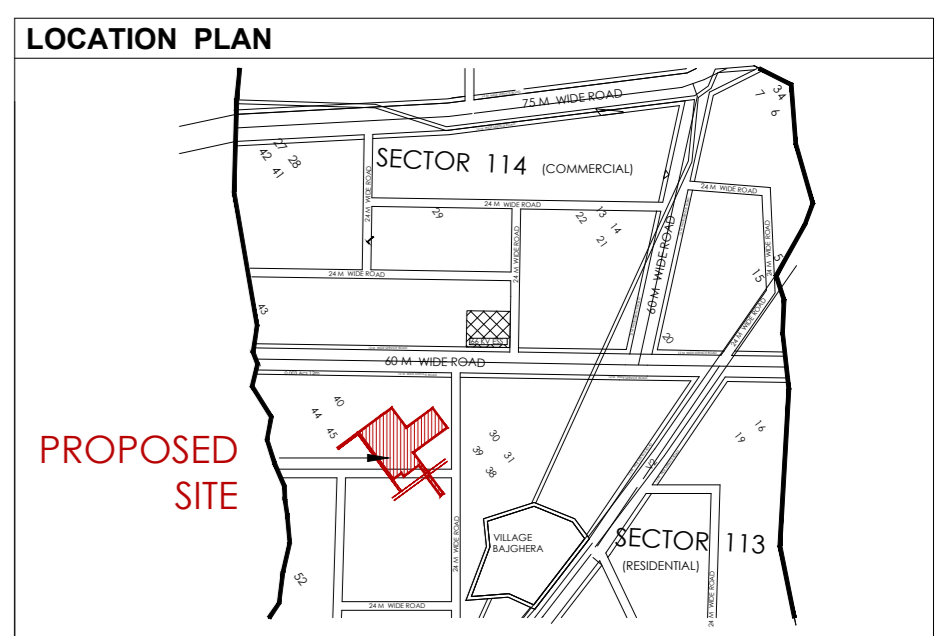

JOB TITLE
PROPOSED BUILDING PLAN OF AFFORDABLE GROUP HOUSING COLONY FOR AN AREA MEASURING 5.025 ACRES (LICENCE NO. 49 OF 2019 DATED 07.03.2019) IN VILLAGE BAJGERA, SECTOR-112, GURUGRAM MANESAR URBAN COMPLEX BEING DEVELOPED BY PAREENA BUILDERS AND PROMOTERS PVT. LTD.

OWNER
PAREENA BUILDERS & PROMOTERS PVT. LTD.

PROJECT
PROPOSED HOUSING SECTOR 112, GURUGRAM

MEP CONSULTANTS
KAMBO DESIGN STUDIO
209/1, STREET No. 03, VIRENDER NAGAR, NEW DELHI - 110058
EMAIL - kambostudio@gmail.com

ARCHITECT
LINEAR CONCEPTS
407 A09 GD I/TL NORTH EX TOWERS, NETAJI SUBHASH PLACE, NEW DELHI - 110034, INDIA
EMAIL: INFO@LINEARCONCEPTS.IN, TEL: +91 11 2735 4056

DESCRIPTION
SUBMISSION DRAWING

SCALE 1 : 500 @ A1
SHEET NO.
DATE ISSUED 12.03.2019
DRAWN BY
CHECKED BY

ARCHITECT'S SIGNATURE AND SEAL OWNER'S SIGNATURE AND SEAL

BUILDING
SITE PLAN
PLUMBING LAYOUT PLAN

DRAWING NO. EF-PL-01

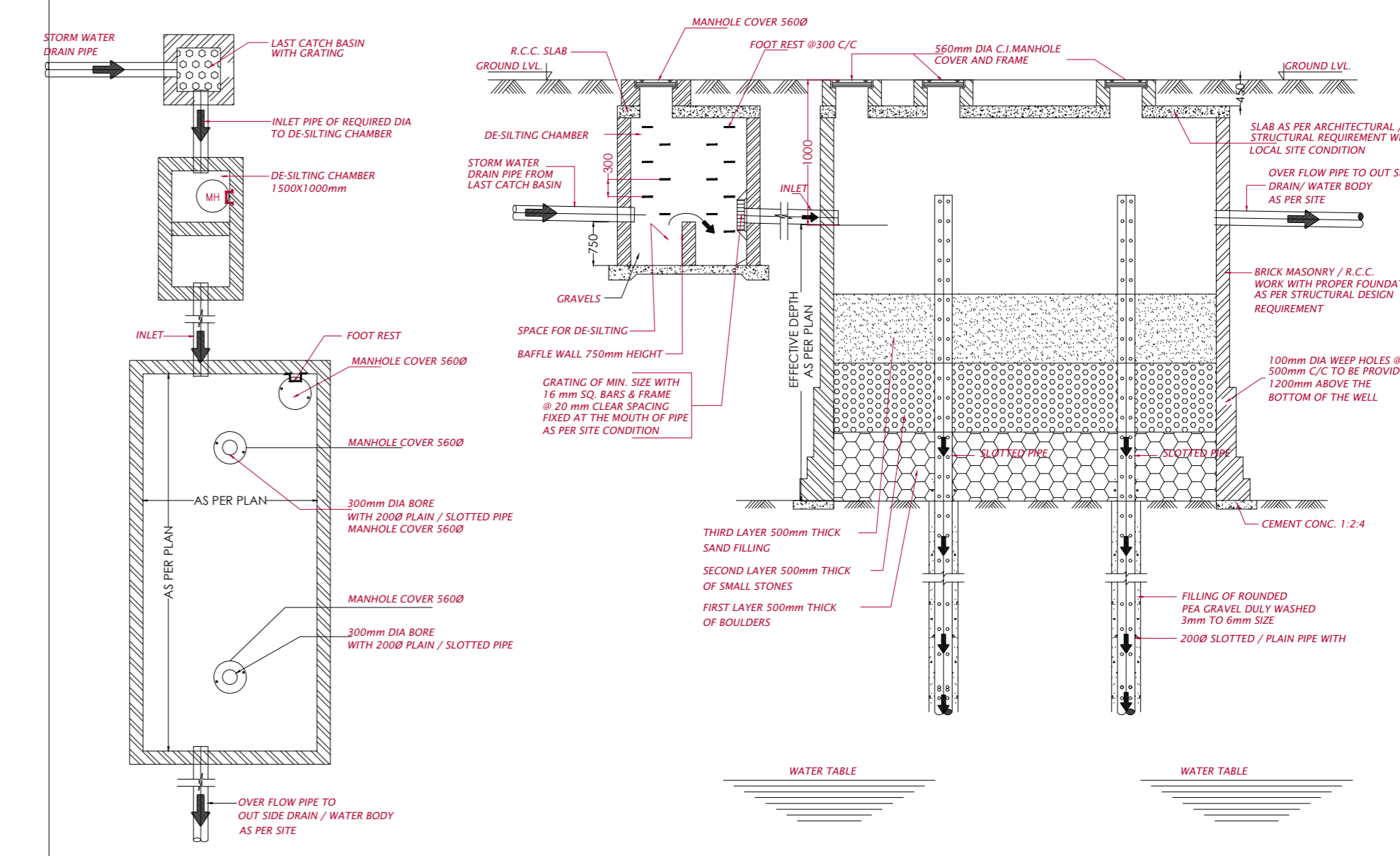
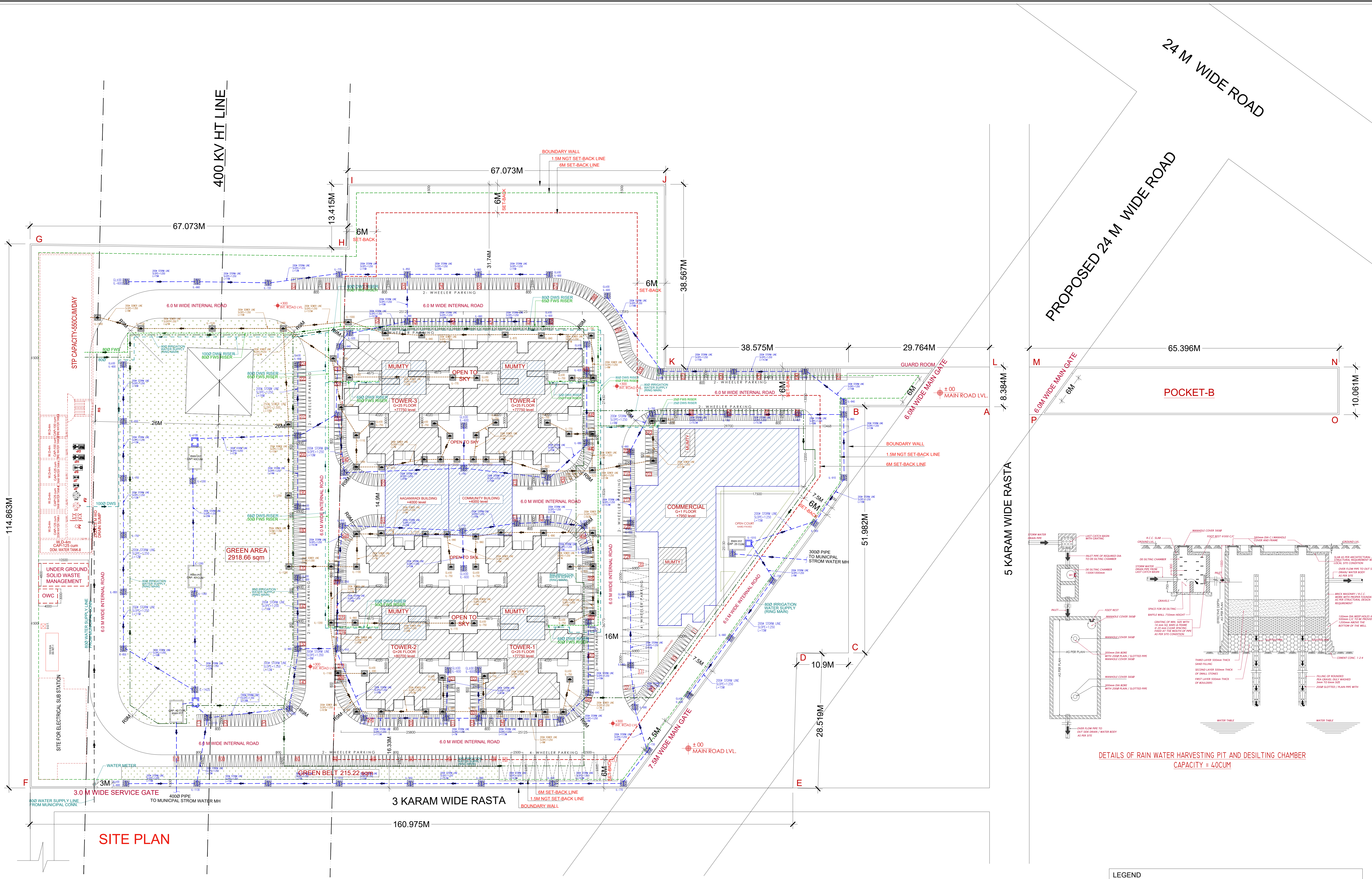

DETAILS OF RAIN WATER HARVESTING PIT AND DESILTING CHAMBER CAPACITY = 40CUM

LEGEND

- IRRIGATION WATER SUPPLY LINE
- FLUSH WATER SUPPLY LINE
- DOM. WATER SUPPLY LINE
- GARDEN HYDRANT LINE
- STORM WATER LINE
- SEWER LINE

UNIT TYPE CALCULATION

S.NO	TOWER	UNIT-1	UNIT-2	UNIT-3	UNIT-4	TOTAL
1	T-1	0	0	101	103	204
2	T-2	54	53	54	53	214
3	T-3	0	0	104	50	154
4	T-4	0	0	104	50	154
TOTAL UNITS		54	53	343	256	726

SCHEDULE OF EQUIPMENTS

S.NO.	DISCRPTION
FIRE PUMPS & EQUIPMENTS	
1	DIESEL DRIVER PUMP
2	FIRE HYDRANT PUMP
3	JOCKEY PUMP
4	PRESSURE VESSEL
5	DAY OIL TANK
6	AMF PANEL
7	ELECTRICAL FIRE PANEL
PLUMBING PUMPS & EQUIPMENTS	
8	FILTER FEED PUMPS
9	FLUS. W. TRANSFER PUMPS (STP PLANT ROOM)
10	DOMESTIC WATER TRANSFER PUMPS
11	FILTER
12	ACTIVATED CARBON FILTER
13	ELECTRICAL PANEL PLUMBING EQP.

Affordable Housing Gurgaon Sector - 112 Area Statement

S.No	Description	Area (sqm)	Value (sqm)	Total Achieved
1	Plot Area (Gross 5025 Acres)	20335.42	5025 Acres (20335.42sqm)	N/A
2	Commercial Area (X)	45 of Plot Area (0.20%)	8134.68	N/A
3	Commercial Area (Y)	175 of Plot Area (0.86%)	1423.46	N/A
4	Additional for all building uses (1) for installing Waste Management Plant	76 of Plot Area (0.37%)	2442.94	N/A
5	Residential Area	5076 of Plot Area (24.99%)	1447.84204	1437.19
6	Residential Area (1) (2) of 1952sqm	4924.5	4924.5	3341.27 (14.44%)
7	Additional for all building uses (2) for installing Waste Management Plant	36 of Plot Area (0.18%)	4472.8	4472.8
8	Community Building Detail (A) 1 No. of Anganwadi	185.81 sqm	185.81	185.81
9	Open Green Area (1) (2) of 2035.42 sqm	8150.31	8150.31	3133.74 (14.41%)
10	1 Scooter / Dwelling Unit	726 Scooters	726 Scooters	726 Scooters
11	2 Wheeler parking	0.5 ECS / Dwelling Unit	363 Nos.	8375 (23-14.6 Nos)
12	Visitor's Car Parking	Open Parking Area	23 Sqm	20 Cars
13	Dwelling Units	750 P.P.A. - 900 P.P.A.	5 PERSONS PER UNIT	726
14	Population	7504.024 - 9004.024	3618 Persons - 4342 Persons	3430
15	Proposed Density	752.488 PPA		

TOWER WISE AREA STATEMENT

S.NO	TOWER	FLOORS	HEIGHT (8M MT)	NO. OF UNITS	GROUND COVERAGE	NON FAR (SILT AREA)	GROUND FLOOR	1st Floor	2nd to 5th Floor	6th to 9th Floor	10th to 13th Floor	14th to 17th Floor	18th to 21th Floor	22th to 25th Floor	26th Floor	TOTAL RESIDENTIAL FAR	COMMERCIAL F.A.R	MUMTY AND MACHINE ROOM	
1	TOWER-1	G + 25	77.75	204	540.35	230.54	288.16	481.2	1924.8	1924.8	1924.8	1924.8	1924.8	1924.8	N/A	12318.19		66.62	
2	TOWER-2	G + 26	80.7	214	584.53	118	414.42	494.92	1979.68	1979.68	1979.68	1979.68	1979.68	1979.68	494.92	13282.38		66.62	
3	TOWER-3	G + 25	77.75	154	435.95	112.98	290.69	365.81	1463.24	1463.24	1463.24	1463.24	1463.24	1463.24	N/A	9435.97		66.62	
4	TOWER-4	G + 25	77.75	154	435.95	112.98	290.69	365.81	1463.24	1463.24	1463.24	1463.24	1463.24	1463.24	N/A	9435.97		66.62	
5	COMMUNITY	G + 1	7.8	N/A	749.07		723.72	714.26								1437.98		53.62	
6	COMMUNITY/ANGANWADI	G	4	N/A	396.64														
7	LT PANEL	G	4.5	N/A	170.35														
8	H.M.T. ROOM	G	4.5	N/A	13.42														
9	TOTAL			726	3346.27	574.5										44472.5	1437.98	320.1	