

AREA STATEMENT

Total Site Area	Acres	Sqm.	%age
Reserved Area for Commercial (4% of total Site)	0.22144	22403.362	4.00%
Permissible F.A.R. @ 1.50% +.03% (Solid waste Mngt.)	1371.086	1371.086	163.00%
Proposed F.A.R.	5.31456	21507.227	96.00%
Permissible area for Residential F.A.R.	49056.478	228.00%	
Allocated F.A.R. @ 2.25% +.03% (Solid waste Mngt.)	48969.102	99.86%	
Achieved F.A.R.	11201.681	50.00%	
Permissible Ground Coverage @ 50%	5456.251	24.35%	
Proposed Green area	3360.504	15.00%	
Permissible Green area	4300.000	19.19%	
Total No. of Main D.U. =	4 BHK	2 BHK	
Total Population/Density =	302	336	
Total Population/Density =	638	X	5
Total Population/Density =	638	X	5
Total Population/Density =	302	X	302
Total of 4 BHK			
Total of 2 BHK			
Total units	638		
Mumty & Machine Room			
Commercial			
Basement below Tower A to E & Commercial (under Stilt - Tower F)			
Aanganwadi/Creche			
Community			
Water body			
TOTAL	5456.25	68610.00	48969.10
Parking Detail			
Total No. of Units	638	Nos.	
Car Parking/ECS	470	Nos.	184
No. of Scooters	638	Nos.	820
Required	Provided	Paid	Visitors
638	570	98	184
470	570	820	
638			

1.

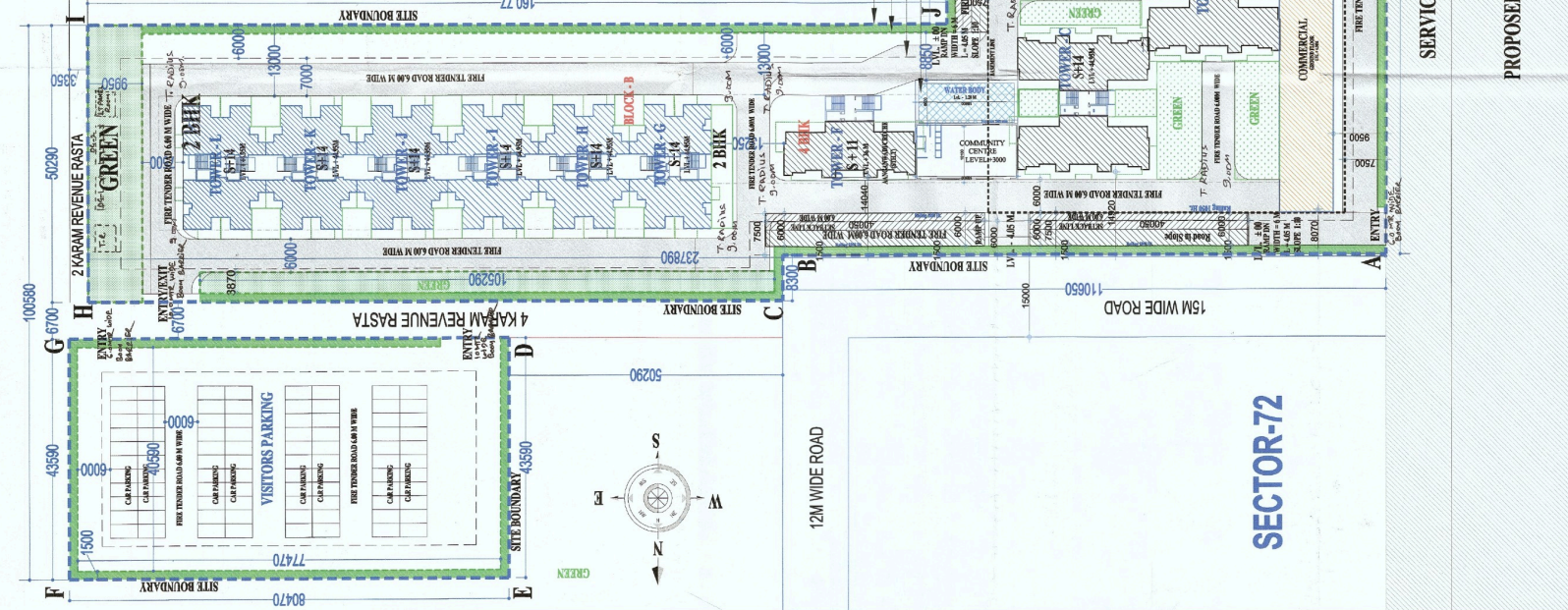

SITE PLAN

For ADHORE HOMES LLP
Authorized Signatory

ARCHITECT
M/s. VASHISTH BUILDERS & ENGINEERS LTD.
GROUP - HOUSING, SECTOR - 72, FARIDABAD, HARYANA.

PLANNERS CLUB
72, Indraprastha, Sector-72, Faridabad, Haryana

For ADHORE HOMES LLP
Authorized Signatory

ARCHITECT
M/s. ADHORE HOMES LLP.
GROUP - HOUSING, SECTOR - 72, FARIDABAD, HARYANA.

PROPOSED BUILDING PLAN OF AFFORDABLE INDUSTRIAL GROUP HOUSING SCHEME, AREA MEASURING 5.536 ACS, VILLAGE NEEMKA & MURTAPUR, SECTOR-72, FARIDABAD, HARYANA.

M/s. ADHORE HOMES LLP.

Checked by: Dr. P. K. Singh
In Charge of the City & Regional Planning Authority, Faridabad

Supervised by: Dr. P. K. Singh
Senior Engineer (H.O.)
HSVP, Faridabad

GENERAL NOTES

- (1) WATER HARVESTING CERTIFIED THAT THE BUILDING SHALL SATISFY THE WATER HARVESTING REQUIREMENT AS WELL AS MINIMUM ANTICIPATED DISCHARGE OF WATER MORE THAN 10,000 LTR OR ABOVE PER DAY SHALL BE INCORPORATE WASTE WATER RECYCLING SYSTEM. RECYCLED WATER SHOULD BE USED FOR HORTICULTURE PURPOSE.
- (2) STRUCTURAL STABILITY CERTIFIED THAT THE STRUCTURAL PARTS OF THE BUILDING HAVE BEEN DESIGNED BY US ON THE BASIS OF CALCULATION AND ARE CONSIDERED SAFE AND IN ACCORDANCE WITH THE PERMISSIBLE STRESSES AND SLENDERNESS RATIO (L/D) DOWN BY THE BYE-LAWS. THE BUILDING IS QUITE SAFE FROM EARTH QUAKE POINT OF VIEW.
- (3) FIRE SAFETY WE SHALL PROVIDE PROPER FIRE SAFETY MEASURES AS PER THE RULES OF 1965/INC.
- (4) SOLAR HEATING WE SHALL PROVIDE PROPER FIRE SAFETY MEASURES AS PER THE RULES OF 1965/INC.
- (5) WATER CALCULATIONS FOR UNDER GROUND & FIRE FIGHTING TANK AS PER NORMS.
- (6) COMMERCIAL BLOCK IS MECHANICALLY VENTILATED REQUIREMENT.

SECTOR-72

SECTOR-73