

NOTES:

- All fixture provided in toilets are as per N.B.C.
- Basement will be mechanically ventilated.
- All spaces (parking basement, services basement etc.) will be artificially lit.
- Standby generating capacity will be provided for the electrical requirement of the total scheme. This therefore includes standby generation for all common services, fire services, lifts etc. And also the entire electrical load for the ventilation.
- Fire safety measures as per NBC includes smoke detector, heat detector, sprinkler spacing in compliance with code.

ARCHITECT

MORPHOGENESIS
 41, Industrial Estate, Okhla Phase - III,
 New Delhi 110020
 TEL: 91 11 41828070
 E Mail: studio@morphogenesis.org

CONSULTING STRUCTURAL ENGINEER

VITECH CONSULTANTS
 Address: C-35, Pragathi Enclave, Greater Kailash - I, New Delhi - 110 048.
 Ph: +91 11 43141515, 26256725, 26256706
 E-mail: vntech@vntechconsultants.com
 vjain@vntechconsultants.com

CONSULTING MEP

SNC

Shri Nagesh Consultants
 20/6, Park Road, Golf Course Road, Sector-54
 Gurgaon, Haryana (India) - 122002
 snrgurgaon@snrc.co.in

KEY PLAN

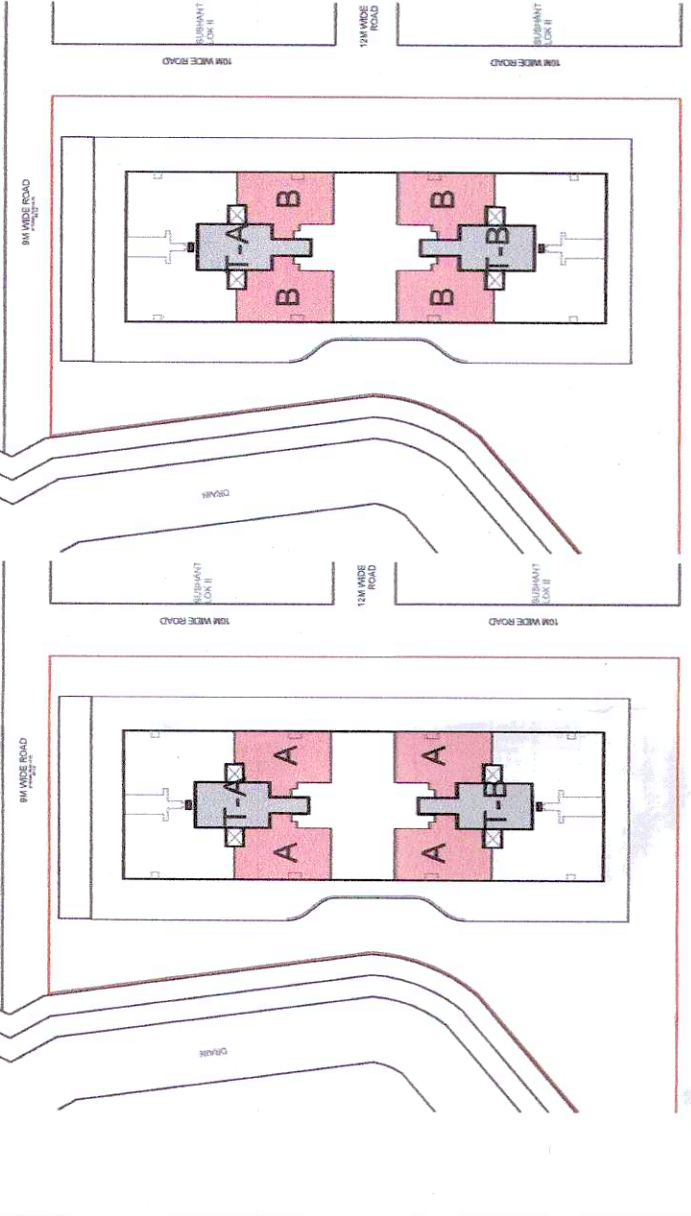

PROJECT

Proposed Building Plan of GH Site no. 13 in Sector-56, Urban Estate Gurgaon II under HSPV IOD Policy (Under mix land use).

DEVELOPER

JHS Estate Private Limited.

DEVELOPER'S SIGNATURE :

For JHS Estate Private Limited
 Authorized Signatory

AUTHORIZED SIGNATORY

ARCHITECT'S SIGNATURE :

MORPHOGENESIS ARCHITECTS

DRAWING NAME

TYPE A - 3BHK GARDEN UNIT & TYPE B - 3BHK UNIT PLAN AND RERA CARPET AREA DIAGRAM

SCALE 1:50

DATE 07.06.2024



TYPE B: 3BHK

2 TYPE B - 3BHK-STUDY-UTILITY UNIT PLAN

TYPE A: 3BHK

1 TYPE A - 3BHK-STUDY-UTILITY (GARDEN UNIT) PLAN

3 TYPE A&B (3BHK + STUDY-UTILITY) - RERA CARPET AREA DIAGRAM

TYPE A & B - 3 BHK					
Description	Length (mm)	Breathth (mm)	Area (sqm)	No. of repetitions	Total Area (sqm)
Area of rectangle A01	8050	3800	30.590	1	30.590
Area of rectangle A02	6150	850	5.228	1	5.228
Area of rectangle A03	1650	100	0.165	1	0.165
Area of rectangle A04	7900	1475	10.768	1	10.768
Area of rectangle A05	6900	750	4.785	1	4.785
Area of rectangle A06	6300	750	4.725	1	4.725
Area of rectangle A07	7075	775	5.483	1	5.483
Area of rectangle A08	425	525	0.223	1	0.223
Area of rectangle A09	6650	2700	17.955	1	17.955
Area of rectangle A10	100	2100	0.210	1	0.210
Area of rectangle A11	7100	4700	33.370	1	33.370
Area of rectangle A12	300	2400	0.720	1	0.720
Area of rectangle A13	4000	1800	7.200	1	7.200
Area of rectangle A14	950	3183	3.183	1	3.183
Area of rectangle A15	200	1200	0.240	1	0.240
Area of rectangle A16	400	900	0.360	1	0.360
Area of rectangle A17	2100	100	0.210	1	0.210
Area of rectangle A18	750	100	0.075	1	0.075
Area of rectangle A19	2125	800	1.700	1	1.700
Area of rectangle A20	3225	1300	4.193	1	4.193
Area of rectangle A22	100	0.080	0.160	2	0.160
Area of rectangle A24	1300	500	0.650	1	0.650
Area of rectangle A25	2400	100	0.240	1	0.240
Total Additions A					128.684

DOORS & WINDOW SCHEDULE				
Type	Width	Height	SHL	
D1	800	2150	0	
D2	800	2450	100	
D3	1200	2450	100	
F01	800	2350	2450	100
FIRE DOORS				
FD1	1200	2450	100	
FD2	1200	2450	100	
FD3	1200	2450	100	
FD4	1200	2450	100	
FD5	1200	2450	100	
FD6	1200	2450	100	
FD7	1200	2450	100	
FD8	1200	2450	100	
FD9	1200	2450	100	
FD10	1200	2450	100	
FD11	1200	2450	100	
FD12	1200	2450	100	
FD13	1200	2450	100	
FD14	1200	2450	100	
FD15	1200	2450	100	
FD16	1200	2450	100	
FD17	1200	2450	100	
FD18	1200	2450	100	
FD19	1200	2450	100	
FD20	1200	2450	100	
FD21	1200	2450	100	
FD22	1200	2450	100	
FD23	1200	2450	100	
FD24	1200	2450	100	
FD25	1200	2450	100	
FD26	1200	2450	100	
FD27	1200	2450	100	
FD28	1200	2450	100	
FD29	1200	2450	100	
FD30	1200	2450	100	
FD31	1200	2450	100	
FD32	1200	2450	100	
FD33	1200	2450	100	
FD34	1200	2450	100	
FD35	1200	2450	100	
FD36	1200	2450	100	
FD37	1200	2450	100	
FD38	1200	2450	100	
FD39	1200	2450	100	
FD40	1200	2450	100	
FD41	1200	2450	100	
FD42	1200	2450	100	
FD43	1200	2450	100	
FD44	1200	2450	100	
FD45	1200	2450	100	
FD46	1200	2450	100	
FD47	1200	2450	100	
FD48	1200	2450	100	
FD49	1200	2450	100	
FD50	1200	2450	100	
FD51	1200	2450	100	
FD52	1200	2450	100	
FD53	1200	2450	100	
FD54	1200	2450	100	
FD55	1200	2450	100	
FD56	1200	2450	100	
FD57	1200	2450	100	
FD58	1200	2450	100	
FD59	1200	2450	100	
FD60	1200	2450	100	
FD61	1200	2450	100	
FD62	1200	2450	100	
FD63	1200	2450	100	
FD64	1200	2450	100	
FD65	1200	2450	100	
FD66	1200	2450	100	
FD67	1200	2450	100	
FD68	1200	2450	100	
FD69	1200	2450	100	
FD70	1200	2450	100	
FD71	1200	2450	100	
FD72	1200	2450	100	
FD73	1200	2450	100	
FD74	1200	2450	100	
FD75	1200	2450	100	
FD76	1200	2450	100	
FD77	1200	2450	100	
FD78	1200	2450	100	
FD79	1200	2450	100	
FD80	1200	2450	100	
FD81	1200	2450	100	
FD82	1200	2450	100	
FD83	1200	2450	100	
FD84	1200	2450	100	
FD85	1200	2450	100	
FD86	1200	2450	100	
FD87	1200	2450	100	
FD88	1200	2450	100	
FD89	1200	2450	100	
FD90	1200	2450	100	
FD91	1200	2450	100	
FD92	1200	2450	100	
FD93	1200	2450	100	
FD94	1200	2450	100	
FD95	1200	2450	100	
FD96	1200	2450	100	
FD97	1200	2450	100	
FD98	1200	2450	100	
FD99	1200	2450	100	
FD100	1200	2450	100	
FD101	1200	2450	100	
FD102	1200	2450	100	
FD103	1200	2450	100	
FD104	1200	2450	100	
FD105	1200	2450	100	
FD106	1200	2450	100	
FD107	1200	2450	100	
FD108	1200	2450	100	
FD109	1200	2450	100	
FD110	1200	2450	100	
FD111	1200	2450	100	
FD112	1200	2450	100	
FD113	1200	2450	100	
FD114	1200	2450	100	
FD115	1200	2450	100	
FD116	1200	2450	100	
FD117	1200	2450	100	
FD118	1200	2450	100	
FD119	1200	2450	100	
FD120	1200	2450	100	
FD121	1200	2450	100	
FD122	1200	2450	100	
FD123	1200	2450	100	
FD124	1200	2450	100	
FD125	1200	2450	100	
FD126	1200	2450	100	
FD127	1200	2450	100	
FD128	1200	2450	100	
FD129	1200	2450	100	
FD130	1200	2450	100	
FD131	1200	2450	100	
FD132	1200	2450	100	
FD133	1200	2450	100	
FD134	1200	2450	100	
FD135	1200	2450	100	
FD136	1200	2450	100	
FD137	1200	2450	100	
FD138	1200	2450	100	
FD139	1200	2450	100	
FD140	1200	2450	100	
FD141	1200	2450	100	
FD142	1200	2450	100	
FD143	1200	2450	100	
FD144	1200	2450	100	
FD145	1200	2450	100	
FD146	1200	2450	100	
FD147	1200	2450	100	
FD148	1200	2450	100	
FD149	1200	2450	100	
FD150	1200	2450	100	
FD151	1200	2450	100	
FD152	1200	2450	100	
FD153	1200	2450	100	
FD154	1200	2450	100	
FD155	1200	2450	100	
FD156	1200	2450	100	
FD157	1200	2450	100	
FD158	1200	2450	100	
FD159	1200	2450	100	
FD160	1200	2450	100	
FD161	1200	2450	100	
FD162	1200	2450	100	
FD163	1200	2450	100	
FD164	1200	2450	100	
FD165	1200	2450	100	
FD166	1200	2450	100	
FD167	1200	2450	100	
FD168	1200	2450	100	
FD169	1200	2450	100	
FD170	1200	2450	100	
FD171	1200	2450	100	
FD172	1200	2450	100	
FD173	1200	2450	100	
FD174	1200	2450	100	
FD175	1200	2450	100	
FD176	1200	2450	100	
FD177	1200	2450	100	
FD178	1200	2450	100	
FD179	1200	2450	100	
FD180	1200	2450	100	
FD181	1200	2450	100	
FD182	1200	2450	100	
FD183	1200	2450	100	
FD184	1200	2450	100	
FD185	1200	2450	100	
FD186	1200	2450	100	
FD187	1200	2450	100	
FD188	1200	2450	100	
FD189	1200	2450	100	
FD190	1200	2450	100	
FD191	1200	2450	100	
FD192	1200	2450	100	
FD193	1200	2450	100	
FD194	1200	2450	100	
FD195	1200	2450	100	
FD196	1200	2450	100	
FD197	1200	2450	100	
FD198	1200	2450	100	
FD199	1200	2450	100	
FD200	1200	2450	100	