

DRAWING NO: S03

SUBMISSION DRAWINGS  
FOR APPROVAL AND STAMPING

NOTES:

1. All fixtures provided in schedule are as per N.B.C.
2. All spaces (parking, basement, services, basement, etc.) will be artificially lit.
3. Standby generating capacity will be provided for the entire area.
4. Standby generating capacity will be provided for the entire area. Therefore includes standby generation for all common services, fire services, lifts etc. And also the entire electrical load for the entire area.
5. Standby generating capacity will be provided for the entire area. Therefore includes standby generation for all common services, fire services, lifts etc. And also the entire electrical load for the entire area. Standby generating capacity will be provided for the entire area. Therefore includes standby generation for all common services, fire services, lifts etc. And also the entire electrical load for the entire area.
6. Standby generating capacity will be provided for the entire area. Therefore includes standby generation for all common services, fire services, lifts etc. And also the entire electrical load for the entire area.

ARCHITECT  
**MORPHOGENESIS**  
41, Industrial Estate, Okhla Phase - III,  
New Delhi - 110048  
TEL: 91 11 41828670  
E-Mail: studio@morphogenesis.org

CONSULTING STRUCTURAL ENGINEER  
**VINTECH CONSULTANTS**  
VINTeCH CONSULTANTS  
CONSULTING ENGINEERS  
PRACTICE REGISTERED  
No. 100, Connaught Place, New Delhi - 110028  
Phone: 91 11 43141616, 26297766  
E-Mail: vntech@vntechconsultants.com  
vntech@vntechconsultants.com

CONSULTING MEP  
**SNC**  
SNC  
Sant Nigam Consultants  
Block - Sector-54  
Phase - III  
Gurgaon  
Haryana - 122002

KEY PLAN

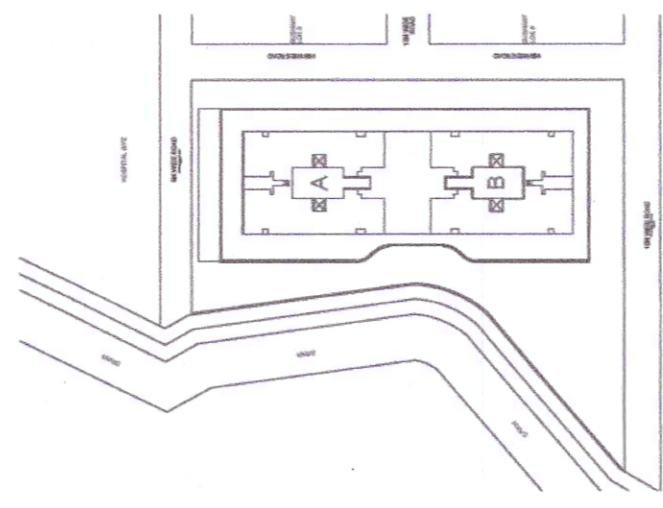

PROJECT  
Proposed Building Plan of GH Site no. 13 in Sector-54, Urban Estate Gurgaon II under HSP TOD Policy (Under mix land use).

DEVELOPER  
JHS Estate Private Limited.  
SANCIONED  
By the  
Building Plan Committee  
Urban Housing Societies  
Gurgaon  
Haryana  
S.T.P.  
HSP GURUGRAM

DEVELOPER'S SIGNATURE:  
For JHS ESTATE PRIVATE LIMITED  
Authorized Signatory

AUTHORIZED SIGNATORY  
ARCHITECT'S SIGNATURE:  
STRAN YADAV  
CA/201048152

DRAWING NAME:  
SITE PLAN - GREEN AREA CALCULATION

SCALE  
DATE  
1:200  
16.06.2024

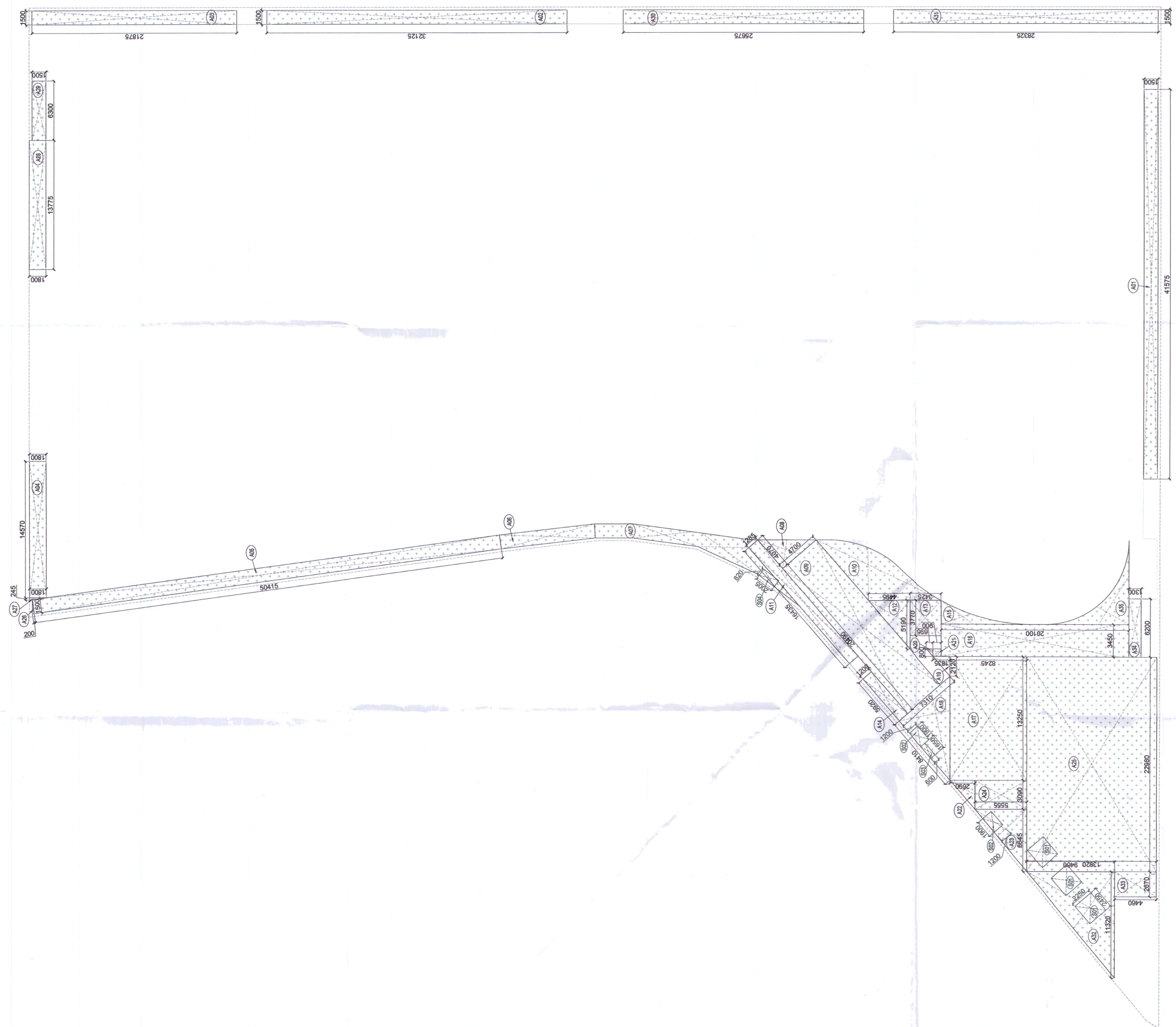

GREEN AREA CALCULATION

Description	Length (mm)	Breadth (mm)	Area (sqm)	No. of repetitions	Total Area (sqm)
Area of rectangle A01	1500	32125	48188	1	48188
Area of rectangle A02	1500	21875	32813	1	32813
Area of rectangle A03	1500	1800	2700	1	2700
Area of rectangle A04	1500	26225	39338	1	39338
Area of rectangle A05	1500	50415	75623	1	75623
Area as per shape A06	As/Polylines	35.600	35.600	1	35.600
Area of triangle A07	4070	9.555	19355	1	19355
Area of triangle A08	4070	20570	83725	1	83725
Area of triangle A09	4070	38260	155965	1	155965
Area of triangle A10	4070	21119	85965	1	85965
Area of triangle A11	12885	16435	21119	1	21119
Area of triangle A12	5190	4895	11665	1	11665
Area of triangle A13	5920	2350	7104	1	7104
Area as per shape A14	As/Polylines	7.990	7.990	1	7.990
Area of rectangle A15	3450	20100	69345	1	69345
Area of rectangle A16	1840	21100	38830	1	38830
Area of rectangle A17	1840	30230	55622	1	55622
Area of triangle A18	800	695	278	1	278
Area of triangle A19	800	695	278	1	278
Area of triangle A20	800	695	278	1	278
Area of triangle A21	800	695	278	1	278
Area of triangle A22	800	695	278	1	278
Area of triangle A23	6645	5555	18456	1	18456
Area of triangle A24	3990	1555	17165	1	17165
Area of triangle A25	200	1590	1590	1	1590
Area of triangle A26	200	1590	1590	1	1590
Area of triangle A27	245	1890	4621	1	4621
Area of triangle A28	13775	1090	14995	1	14995
Area of triangle A29	13775	1090	14995	1	14995
Area of triangle A30	1500	28125	42188	1	42188
Area of triangle A31	1500	28125	42188	1	42188
Area of triangle A32	11320	9460	53544	1	53544
Area of triangle A33	6200	1390	8620	1	8620
Area as per shape A34	As/Polylines	17.370	17.370	1	17.370
Total of all Additions 'A'			2380988		2380988
Area of rectangle S01	2450	2750	5513	3	16539
Area of rectangle S02	1500	1200	1800	2	3600
Area of rectangle S03	1500	1200	1800	2	3600
Area of rectangle S04	1500	1200	1800	2	3600
Total of all Deductions 'W'			1044		1044
<b>TOTAL AREA = A-B</b>					<b>23726</b>

Required Green Area = 1250.14 sq.mts (15%)  
Green Area Provided = 1257.26 sq.mts (15.09%)