

This is a PROFESSIONAL BUILDING PLAN for a HOUSING COLONY BEING DEVELOPED OVER LAND MEASURING 12.356 ACRES SITUATED IN SECTOR-2, GWAL Pahari, HARYANA UNDER LICENSE NO. 98 OF 2011 DATED 11.11.2011 BY ADANI INFRASTRUCTURE AND DEVELOPERS PRIVATE LIMITED.

TO BE READ WITH THIS OFFICE DRAWING NO. 668/1 DATED: 22.12.2014

DTP (RQ) Consultant Architect

ASHWATTHA ARCHITECTS

ASHWATTHA ARCHITECTS

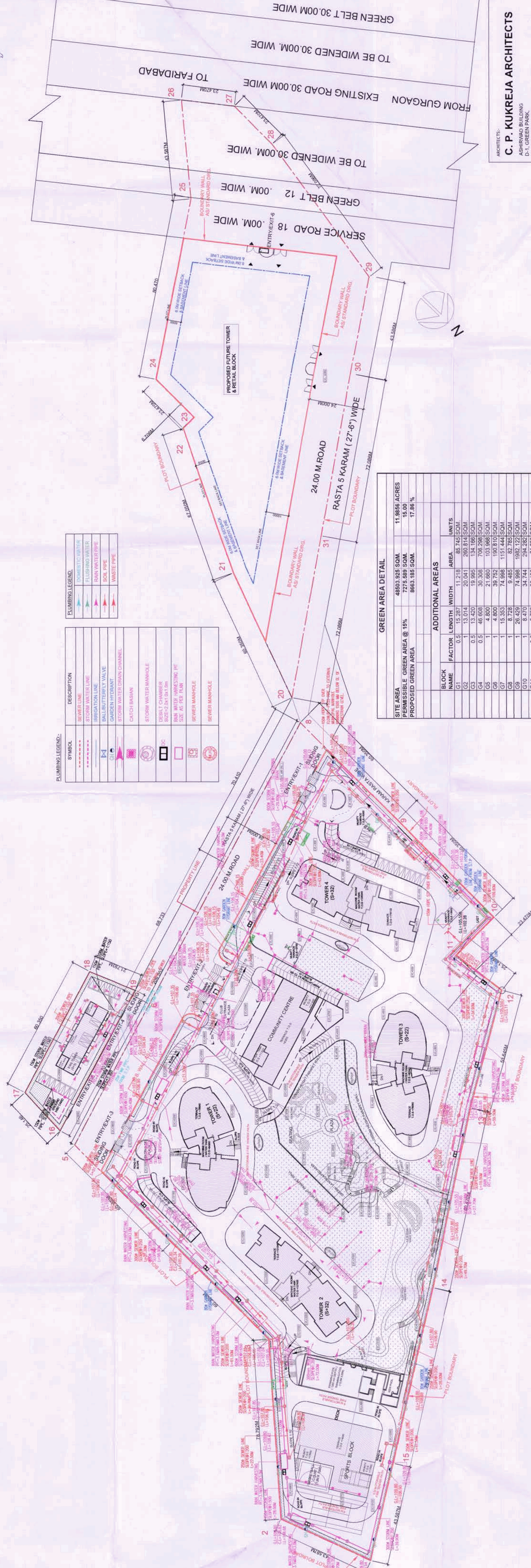

ARCHITECTS:  
**C. P. KUKREJA ARCHITECTS**  
 ASHWATTHA BUILDING  
 D-11, GREEN PARK  
 PHASE-1, SECTOR-14  
 GATE NO. 14, NEW DELHI-110028  
 PHONE: 28683832 FAX: 28685770  
 EMAIL: cpk@cpkarchitects.com

KEY PLAN  
 SUBMISSION DRAWINGS  
 REVISED BUILDING PLAN FOR GROUP HOUSING COLONY BEING DEVELOPED OVER LAND MEASURING 12.356 ACRES SITUATED IN SECTOR-2, GWAL Pahari, HARYANA UNDER LICENSE NO. 98 OF 2011 DATED 11.11.2011 BY ADANI INFRASTRUCTURE AND DEVELOPERS PRIVATE LIMITED.

OWNER'S SIGN: \_\_\_\_\_  
 ARCHITECT'S SIGN: \_\_\_\_\_  
 SCALE: 1:500  
 DATE: DECEMBER 2013  
 DRAWING TITLE: SITE PLAN (SERVICE PLAN)  
 SHEET NO: 3/54

**PLUMBING LEGEND:**

| SYMBOL   | DESCRIPTION               |
|----------|---------------------------|
| [Symbol] | SEWER LINE                |
| [Symbol] | STORM WATER LINE          |
| [Symbol] | BIRGATAION LINE           |
| [Symbol] | BALLCUTTING VALVE         |
| [Symbol] | GARDEN HYDRANT            |
| [Symbol] | STORM WATER DRAIN CHANNEL |
| [Symbol] | CATCH BASIN               |
| [Symbol] | STORM WATER MANHOLE       |
| [Symbol] | SEWER MANHOLE             |
| [Symbol] | SEWER MANHOLE             |
| [Symbol] | SEWER MANHOLE             |

**LANDSCAPING LEGEND:**

| SYMBOL   | DESCRIPTION      |
|----------|------------------|
| [Symbol] | PLANTING WATER   |
| [Symbol] | PLANTING WATER   |
| [Symbol] | RAINY WATER PIPE |
| [Symbol] | SOIL PIPE        |
| [Symbol] | WASTE PIPE       |

**GREEN AREA DETAIL**

| SITE AREA                          | 4853.935 SQM    | 11.8646 ACRES |         |          |       |
|------------------------------------|-----------------|---------------|---------|----------|-------|
| PERMISSIBLE GREEN AREA @ 15%       | 7275.889 SQM    | 15.00 ACRES   |         |          |       |
| PROPOSED GREEN AREA                | 8663.185 SQM    | 17.86 %       |         |          |       |
| SLACK NAME                         | FACTOR          | LENGTH        | WIDTH   | AREA     | UNITS |
| G1                                 | 0.5             | 13.297        | 11.218  | 85.745   | SQM   |
| G2                                 | 1               | 13.014        | 20.041  | 260.814  | SQM   |
| G3                                 | 0.5             | 13.420        | 19.995  | 134.196  | SQM   |
| G4                                 | 0.5             | 48.608        | 30.308  | 705.248  | SQM   |
| G5                                 | 1               | 4.800         | 59.752  | 150.810  | SQM   |
| G6                                 | 1               | 13.353        | 74.988  | 1151.444 | SQM   |
| G7                                 | 1               | 8.728         | 9.485   | 82.785   | SQM   |
| G8                                 | 1               | 25.429        | 74.988  | 1932.122 | SQM   |
| G9                                 | 1               | 6.722         | 21.136  | 74.395   | SQM   |
| G10                                | 1               | 16.844        | 4.795   | 80.767   | SQM   |
| G11                                | 1               | 6.957         | 8.587   | 59.740   | SQM   |
| G12                                | 0.5             | 21.977        | 14.540  | 159.773  | SQM   |
| G13                                | 0.5             | 7.895         | 22.120  | 80.400   | SQM   |
| G14                                | 0.5             | 18.453        | 23.787  | 218.471  | SQM   |
| G15                                | 0.5             | 19.538        | 9.965   | 97.348   | SQM   |
| G16                                | 1               | 16.035        | 3.500   | 24.053   | SQM   |
| G17                                | 1               | 25.026        | 1.500   | 37.539   | SQM   |
| G18                                | 1               | 1.500         | 13.860  | 20.820   | SQM   |
| G19                                | 1               | 1.500         | 2.330   | 3.495    | SQM   |
| G20                                | 1               | 1.500         | 27.858  | 30.613   | SQM   |
| G21                                | 1               | 1.500         | 6.301   | 9.453    | SQM   |
| G22                                | 1               | 1.500         | 10.490  | 15.735   | SQM   |
| G23                                | 1               | 1.500         | 20.489  | 30.734   | SQM   |
| G24                                | 1               | 1.500         | 16.500  | 24.750   | SQM   |
| G25                                | 1               | 1.500         | 3.141   | 4.713    | SQM   |
| G26                                | 1               | 1.500         | 2.885   | 4.328    | SQM   |
| G27                                | 1               | 1.500         | 50.036  | 75.054   | SQM   |
| G28                                | 1               | 1.500         | 9.079   | 13.618   | SQM   |
| G29                                | 1               | 1.500         | 78.820  | 118.620  | SQM   |
| G30                                | 1               | 1.500         | 6.840   | 10.260   | SQM   |
| G31                                | 1               | 1.500         | 13.655  | 20.483   | SQM   |
| G32                                | 1               | 1.500         | 58.862  | 88.293   | SQM   |
| G33                                | 1               | 1.500         | 40.858  | 61.287   | SQM   |
| G34                                | 1               | 1.500         | 139.841 | 209.765  | SQM   |
| G35                                | 1               | 1.500         | 53.538  | 80.302   | SQM   |
| <b>TOTAL GREEN AREA PROPOSED =</b> | <b>8278.841</b> | <b>SQM.</b>   |         |          |       |

Checked and found ok for Public Health in following by \_\_\_\_\_  
 (National) Services only  
 In following by \_\_\_\_\_  
 (HSRT) Planning