

1 SITE PLAN @ TERRACE LVL.
Scale: 1:500

SOLID WASTE GENERATION

The solid waste generated from the project is mainly domestic waste and estimated quantity of the waste is 1941.398 kg/day (@ 0.5 kg per capita per day for Residents, @ 0.15 kg per capita per day for the visitor, 0.25 kg per capita per day for the staff members and landscape wastes @ 0.2 kg/acre/day). Following arrangements will be made at the site in accordance to Municipal Solid Wastes (Management and Handling) Rules, 2016.

S. No.	Category	Counts (Heads)	Waste Generated (kg/day)
1.	Residents	3680 @ 0.5 kg/day	1840
2.	Visitors	368 @ 0.15kg/day	55.2
3.	Staff	184 @ 0.25 kg/day	46
4.	Landscape Waste (1.67 acres)	@0.2kg/acre/day	0.198
Total Solid Waste Generated			1941.398

AREA SUMMARY			
PLOT AREA DETAILS			
PLOT AREA	=	ACRE	SQ. M.
PLOT AREA FOR COMMERCIAL (4%)	=	4.967	20100.704
PLOT AREA FOR RESIDENTIAL	=	0.19868	804.028
SUMMARY OF F.A.R.			
	PERMISSIBLE	PROPOSED	UNITS
COMMERCIAL F.A.R. (1.75)	1407.049	1345.42815	SQ.M.
BALANCED RESIDENTIAL F.A.R.		61.62	SQ.M.
RESIDENTIAL F.A.R. (2.25)	43417.521	-	SQ.M.
ADDITIONAL F.A.R. - SOLID WASTE MANAGEMENT (3% OF RESIDENTIAL PLOT AREA)	578.900	-	SQ.M.
ADDITIONAL F.A.R. - SOLID WASTE MANAGEMENT (1.75% OF COMMERCIAL PLOT AREA)	14.070	-	SQ.M.
TOTAL RESIDENTIAL F.A.R.	43417.521	43417.521	SQ.M.
BALANCED RESIDENTIAL F.A.R.	61.62	61.62	SQ.M.
FAR DETAILS			
T-1 to T-4 (2BHK)	=	3304.833	SQ.M.
T-5 to T-9 (2BHK)	=	29237.126	SQ.M.
T-10 (2BHK)	=	5847.425	SQ.M.
T-11 (2BHK)	=	5900.304	SQ.M.
SUMMARY OF GROUND COVERAGE			
AREA =	10050.35198	5089.821	SQ.M.
PERCENTAGE =	50%	25.32%	
GROUND COVERAGE AREA DETAILS			
T-1 to T-4 (2BHK)	=	1423.423	SQ.M.
T-5 to T-9 (2BHK)	=	2605.437	SQ.M.
T-10 (2BHK)	=	522.423	SQ.M.
T-11 (2BHK)	=	522.423	SQ.M.
BUILT UP AREA DETAILS			
T-1 to T-4 (2BHK)	=	3714.795	SQ.M.
T-5 to T-9 (2BHK)	=	35571.203	SQ.M.
T-10 (2BHK)	=	7115.576	SQ.M.
T-11 (2BHK)	=	6737.460	SQ.M.
TOTAL BUILT UP AREA	=	53139.034	SQ.M.
GREEN AREA SUMMARY			
	4020.141	4020.224	SQ.M.
	20%	20.00%	
CRÈCHE & COMMUNITY AREA SUMMARY			
COMMUNITY HALL AREA	185.81	222.889	SQ.M.
CRÈCHE AREA	185.81	222.889	SQ.M.

DENSITY CALCULATION			
PERMISSIBLE DENSITY	=	750 TO 900	PPA
PROPOSED	=	751	PPA
TOTAL NO. OF 2BHK TYPE A UNITS	=	334	NO.s
TOTAL NO. OF 2BHK TYPE B UNITS	=	334	NO.s
TOTAL NO. OF 2BHK UNITS (TYPE A & B)	=	668	NO.s
NO. OF PERSONS IN 2BHK @ 5	=	3340	NO.s
PERSONS/UNIT	=	48	NO.s
TOTAL NO. OF 3BHK UNITS	=	240	NO.s
PERSONS/UNIT	=	3580	NO.s
TOTAL POPULATION	=	476832	ACRES
AREA OF PLOT FOR DENSITY	=	750.7885	PPA
PERSONS PER ACRE	=	SAY 751	PPA

STILT PARKING AREA			
T-5 - T-9 (2 BHK)			
GROUND COVERAGE OF T5 - T9 (2 BHK)	=	2605.437	SQ.M.
F.A.R. AREA AT GROUND LEVEL T5 - T9 (2BHK)	=	50.498	SQ.M.
PARKING AREA ON STILT T5 - T9 (2BHK)	=	2554.939	SQ.M.
T-10 (2 BHK)			
GROUND COVERAGE OF T10 (2 BHK)	=	522.423	SQ.M.
F.A.R. AREA AT GROUND LEVEL T10 (2BHK)	=	50.498	SQ.M.
PARKING AREA ON STILT T10 (2BHK)	=	471.926	SQ.M.
T-11 (2 BHK)			
GROUND COVERAGE OF T-11 (2 BHK)	=	522.423	SQ.M.
F.A.R. AREA AT GROUND LEVEL T-11 (2BHK)	=	50.498	SQ.M.
PARKING AREA ON STILT T-11 (2BHK)	=	471.926	SQ.M.
AREA OF CRÈCHE & COMMUNITY	=	445.778	SQ.M.
TOTAL PARKING AREA ON STILT	=	3053.012	SQ.M.

PARKING SUMMARY			
PARKING BY AREA			
TOTAL NO. OF APARTMENTS	=	716	
PARKING REQUIRED @ 0.5 ECS PER DU	=	358	ECS
PROPOSED OPEN PARKING AREA	=	7780.841	SQ.M.
OPEN PARKING @ 235 SQ.M./ECS	=	338.297	ECS
PROPOSED STILT PARKING AREA	=	3053.012	SQ.M.
STILT PARKING @ 285 SQ.M./ECS	=	109.036	ECS
TOTAL	=	447.334	ECS
TOTAL 2 WHEELERS PROVIDED	=	716	NO.s
TOTAL 2 WHEELERS PROVIDED FOR VISITORS	=	273	NO.s

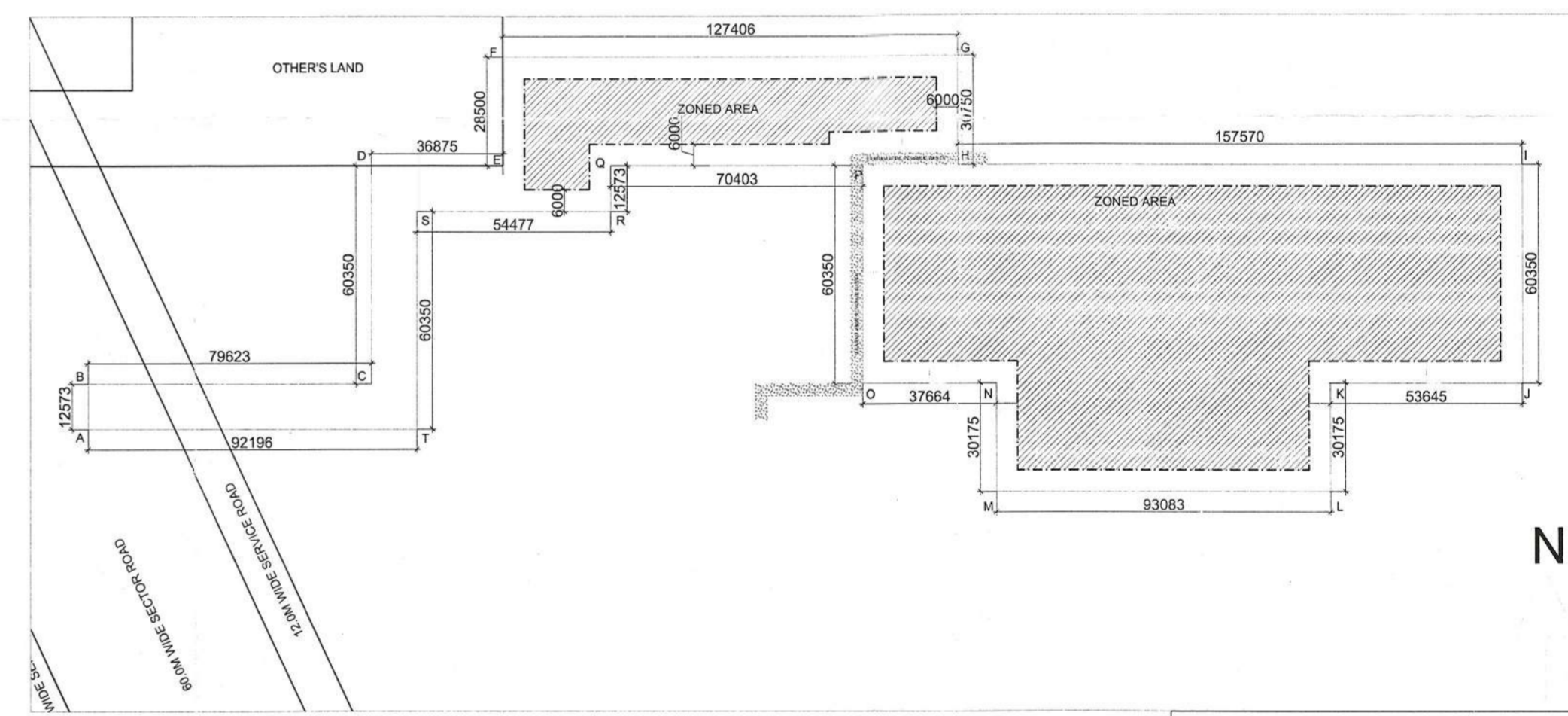
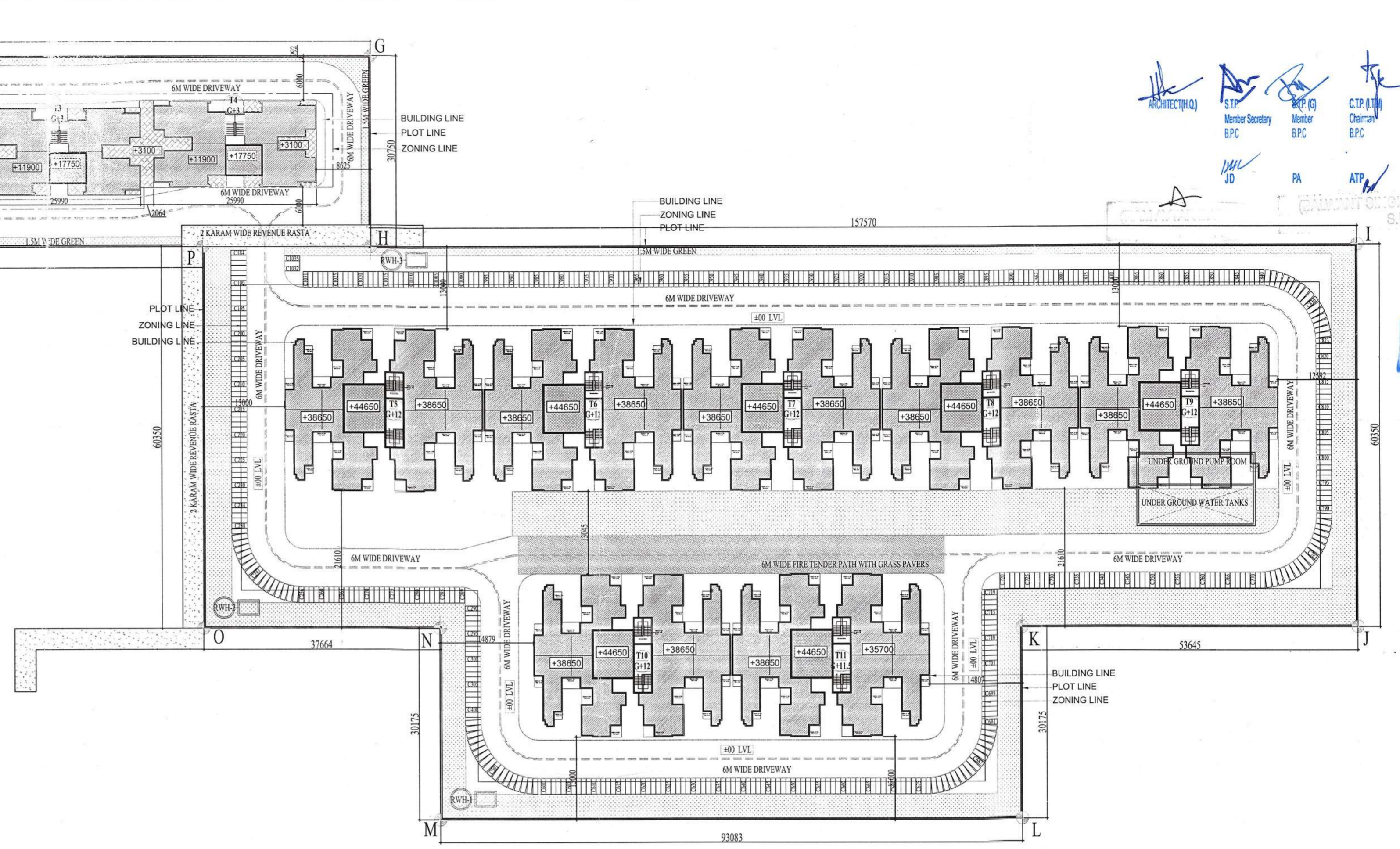

2 ZONING PLAN
NTS

ARCHITECT (H.C.)
S.T.P. Member Secretary B.P.C.
M.P. (G) Member B.P.C.
C.T.P. (G) Chairman B.P.C.
M.P. (D) PA
A.T.P.

A.D.F.C. (H.C.)
D.F.S. P.K.
Member B.P.C.

PROJECT
PROPOSED BUILDING COLONY FOR AN AREA MEASURING 5.00 ACRES (LICENCE NO. 15 OF 2018 DATED 13/02/2018) IN SECTOR-37C, GURUGRAM MANESAR URBAN COMPLEX BEING DEVELOPED BY RENUKA TRADERS PVT.LTD. (LC - 3014)

PRINCIPAL ARCHITECT

DESIGN FORUM INTERNATIONAL
K-47, KAILASH COLONY, NEW DELHI-110048
PHONE NO.: 011-48555816
DRG. TITLE: SITE PLAN
DATE: 23.05.2018
OWNER'S SIGNATURE
ARCHITECT'S SIGNATURE
B. Arch (Hons)
CA/95/18739

SCALE - AS MARKED
SHEET NO. 01
DATE - 23.05.2018