

L.No-167 of 2023 Dt- 18/08/2023

Phase/Licence No.	Land Area (Acres)	Symbol	
Phase-1	Part of Licence No.97 of 2013 Part of Licence No.38 of 2013 Licence no 187 of 2023 Total Land Phase-1	0.6125 10.1375 1.05 11.80	
Phase-2	Part of Licence No.38 of 2013	12.7188	
Phase-3	Part of Licence No.38 of 2013 Part of Licence No.97 of 2013 Total Land Phase-3	0.5625 1.075 1.6375	
Grand Total of Phase-1+2+3		26.1563	

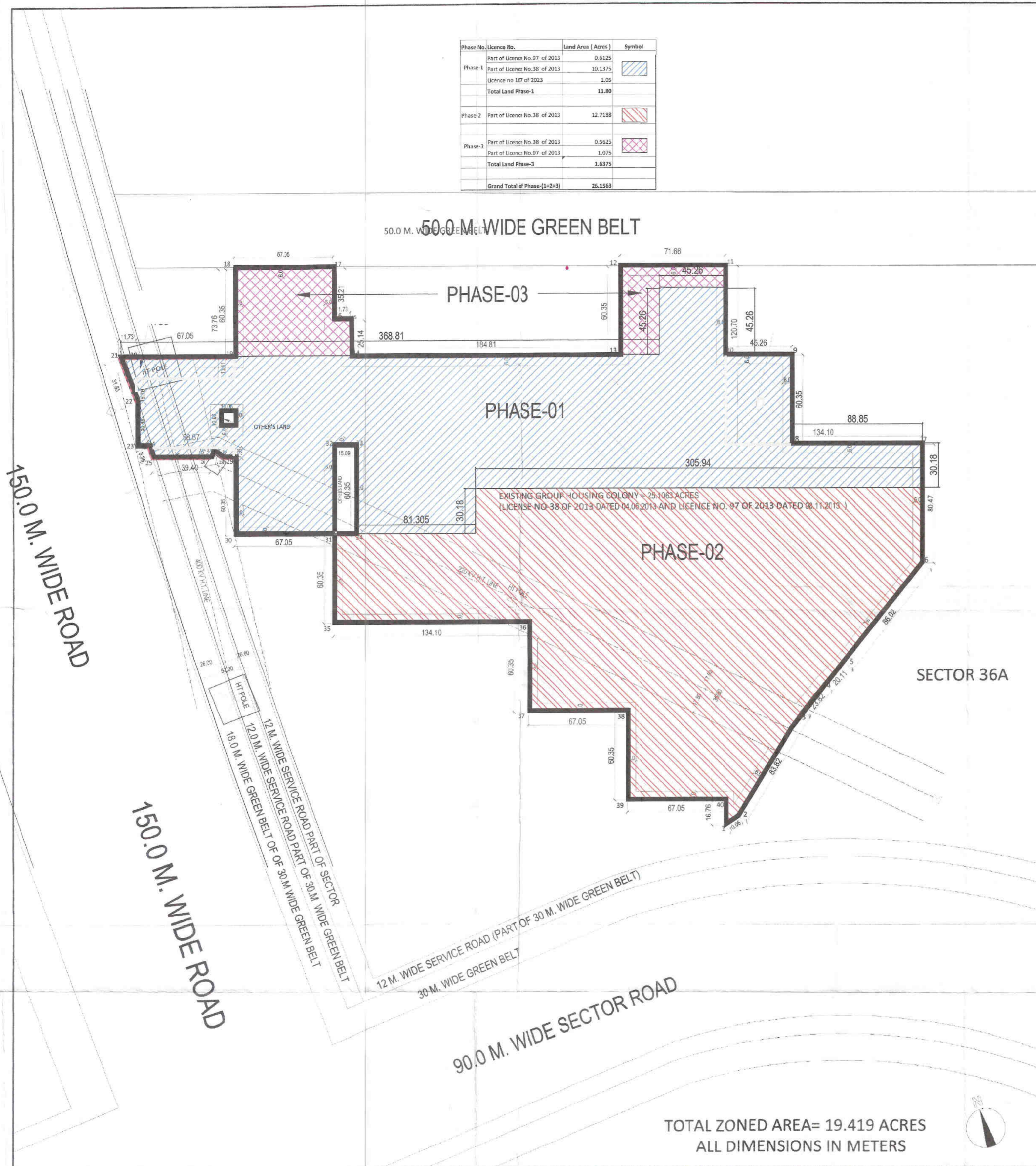

ZONING PLAN FOR AN ADDITIONAL AREA MEASURING 1.05 ACRES UNDER 'TRANSIT ORIENT DEVELOPMENT' POLICY DATED 09.02.2016 IN THE LICENSED GROUP HOUSING COLONY MEASURING 25.1063 ACRES (LICENSE NO. 38 OF 2013 DATED 04.06.2013 GRANTED FOR 23.4188 ACRES AND LICENCE NO 97 OF 2013 DATED 08.11.2013 GRANTED FOR 1.6875 ACRES) THEREBY MAKING THE TOTAL SITE AREA 26.1563 ACRES, SECTOR-36A, GURUGRAM MANESAR URBAN COMPLEX BEING DEVELOPED BY DELTA PROPCON PVT. LTD

FOR THE PURPOSE OF CODE 1.2 (XCVI) & 6.1 (1) OF THE HARYANA BUILDING CODE, 2017, AS AMENDED FROM TIME TO TIME.

- SHAPE & SIZE OF SITE**
The shape and size of the additional land 1.05 acres is in accordance with the demarcation plan shown as 1 to 40 as verified by DTP, Gurugram vide endst. no. 4830 Dated 12.06.2023
- TYPE OF BUILDING PERMITTED**
The type of building permitted on this site shall be buildings designated in the form of flatted development for residential purpose or any ancillary or appurtenant building including community facilities, public amenities and public utility as may be prescribed and approved by the Director General, Town and Country Planning, Haryana.
- GROUND COVERAGE AND FAR**
The building or buildings shall be constructed only within the portion of the site marked as Building zone as explained above, and nowhere else.
a. The maximum coverage on ground floor within the TOD permission granted area (1.05 acres) shall be 40% on the area 1.0057 acres as per the TOD policy dated 09.02.2016 and 35% on the remaining area i.e. 25.0208 acres.
b. The maximum FAR within the TOD permission granted area (1.05 acres) shall not exceed 3.50 on the area 1.0057 acres as per the TOD policy dated 09.02.2016 and 1.75 on the remaining area i.e. 25.0208 acres.
- HEIGHT OF BUILDING**
(a) The maximum height of the building shall be as per the Haryana Building Code 2017.
(b) The plinth height of building shall be as per the Haryana Building Code, 2017.
(c) All building block(s) shall be constructed so as to maintain an inter-se distance not less than the set back required for each building according to the table below:

S.No.	HEIGHT OF BUILDING (in meters)	OPEN SPACE TO BE LEFT AROUND BUILDINGS (in meters)
1.	10	3
2.	15	5
3.	18	6
4.	21	7
5.	24	8
6.	27	9
7.	30	10
8.	35	11
9.	40	12
10.	45	13
11.	50	14
12.	55 & above	16

(d) If, such interior or exterior open space is intended to be used for the benefit of more than one building belonging to the same owner, then the width of such open air space shall be the one specified for the tallest building as specified in (c) above.
- GATE POST AND BOUNDARY WALL**
a. Such Boundary wall, railings or their combination, hedges or fences along with gates and gate posts shall be constructed as per design approved by DG, TCP, Haryana. In addition to the gate/gates an additional wicket gate not exceeding 1.25 meters width may be allowed in the front and side boundary wall provided that no main gate or wicket gate shall be allowed to open on the sector road/public open space.
b. The boundary wall shall be constructed as per HBC 2017.
- DENSITY**
a. The minimum/maximum density of the population provided in the colony within the TOD permission granted area (1.05 acres) shall be 600 (± 10%) PPA on the area of 1.0057 acres as per the TOD policy dated 09.02.2016 and on the remaining area 25.0208 acres the minimum density of the population provided in the colony shall be 100 PPA and maximum be 300 PPA.
b. For computing the density, the occupancy per main dwelling unit shall be taken as five persons and for service dwelling unit two persons per room or one person per 80 sq. feet of living area, whichever is more.
- ACCOMMODATION FOR SERVICE POPULATION**
Adequate accommodation shall be provided for domestic servants and other service population of EWS. The number of such dwelling units for domestic servants shall not be less than 10% of the number of main dwelling units and the carpet area of such a unit if attached to the main units shall not be less than 140 sq. ft. In addition 15% of the total number of dwelling units having a minimum area of 200 sq. ft shall be earmarked for EWS category.
- PARKING**
(a) Parking space for each dwelling unit within the TOD permission granted area (1.05 acres) shall be provided as per the TOD policy dated 09.02.2016 and further, parking space for each dwelling unit within the remaining area (25.1063 acres) shall be provided @ 1.5 Equivalent Car Space. However, parking space for each dwelling unit within the TOD permission granted area shall be calculated on the rational of carpet area of each dwelling unit as per the TOD policy dated 09.02.2016, which is as under:-
Up to 100 sqm = 0.5 ECS
Between 100 sqm to 150 sqm = 1.0 ECS
More than 150 sqm = 1.5 ECS
Adequate parking spaces, covered, open or in the basement shall be provided for vehicles of users and occupiers, within the site.
(b) In no circumstance, the vehicle(s) belonging/ related to the plot/premises shall be parked outside the plot area.
- OPEN SPACES**
While all the open spaces including those between the blocks and wings of buildings shall be developed, equipped and landscaped according to the plan approved by the DG, TCP, Haryana. At least 15% of the total site area shall be developed as organized open space i.e. tot lots and play-ground.
- LIFTS AND RAMP**
a) Lifts & Ramps shall be provided as per Haryana Building Code, 2017.
b) Lifts shall be provided with 100% standby generators along with automatic switchover along with staircase of required width & number.
- APPROVAL OF BUILDING PLANS**
The building plans of the building to be constructed at site shall have to be got approved from the Director General, Town & Country Planning, Haryana/ any other persons or the committee authorized by him, as per provision of Haryana Building Code-2017(as amended time to time) before starting up the construction.
- BUILDING BYE-LAWS**
The construction of the building/buildings shall be governed by provisions of the Haryana Building Code, 2017. On the points where Haryana Building Code, 2017 is silent the National Building Code of India, 2016 shall be followed.
- CONVENIENT SHOPPING**
0.5% area of 26.0265 acres shall be reserved to cater for essential convenient shopping with the following conditions:
i) The ground coverage 100% with FAR 3.50 on the area of 1.0057 acres (falling within TOD Zone) and FAR 1.00 on the area of 25.0208 acres (falling within non TOD area) will be permissible. However, this will be a part of the permissible ground coverage and FAR of the Group Housing Colony.
- PROVISION OF COMMUNITY BUILDINGS**
The community buildings shall be provided as per the composite norms in the Group Housing Colony and as per the provisions of the TOD policy dated 09.02.2016.
- BASEMENT**
(a) The number of basement storeys within building zone of site shall be as per Chapter 6.3(iii) of the Haryana Building Code, 2017.
(b) The basement shall be constructed, used and maintained as per Chapter 7.16 of the Haryana Building Code, 2017.
- APPROACH TO SITE**
a. The vehicular approach to the site shall be planned and provided giving due consideration to the junctions with the surrounding roads to the satisfaction of the competent authority.
b. The approach to the site shall be shown on the zoning plan.
- FIRE SAFETY MEASURES**
i. The owner will ensure the provision of proper fire safety measures in the multi storeyed buildings conforming to the provisions of Haryana Building Code 2017/ National Building Code of India, 2016 and the same should be got certified from the competent authority.
ii. Electric Sub Station / generator room if provided should be on solid ground near DG/ALT. Control panel on ground floor or in upper basement and it should be located on outer periphery of the building, the same should be got approved from the competent authority.
iii. To ensure the Fire Fighting Scheme shall be got approved from the Director, Urban Local Bodies, Haryana or any person authorized by the Director, Urban Local bodies, Haryana. These approvals shall be obtained prior to starting the construction work at site.
- RAIN WATER HARVESTING SYSTEM**
The rain water harvesting system shall be provided as per Central Ground Water Authority norms/Haryana Govt. notification as applicable.
- That the coloniser/owner shall obtain the clearance/NOC as per the provisions of the Notification No. S.O. 1533 (E) Dated 14.9.2006 issued by Ministry of Environment and Forest, Government of India before starting the construction, if applicable.
- That the rain water harvesting system shall be provided as per Central Ground Water Authority norms/Haryana Government notification as applicable.
- That the coloniser/owner shall use only Light-Emitting Diode lamps (LED) fitting for internal lighting as well as Campus lighting.
- That the coloniser/owner shall ensure the installation of Solar Photovoltaic Power Plant as per the provisions of order No. 22/52/2005-5Power dated 21.03.2016 issued by Haryana Government Renewable Energy Department.
- That the coloniser/owner shall strictly comply with the directions issued vide Notification No. 19/6/2016-5P dated 31.03.2016 issued by Haryana Government Renewable Energy Department.
- GENERAL**
(a) Among other plans and papers detailed elevations of buildings along all sides exposed to public view shall be drawn according to scale as mentioned in the Haryana Building Code-2017.
(b) The water storage tanks and other plumbing works etc. shall not be exposed to view each face of building but shall be suitably encased.
(c) No applied decoration like inscription, crosses, names of persons or buildings are permitted on any external face of the building.
(d) Garbage collection center of appropriate size shall be provided within the site.
(e) Color trade emblem and other symbols shall be subject to the approval of the Competent Authority.
(f) That you shall abide by the policies issued by the Department time to time regarding allotment of EWS flats.
(g) Garbage collection center of appropriate size shall be provided within the site.
(h) That you shall provide the minimum access of 2.0 Karam (11.0 feet) to the other's land in the building plans.

DRG. NO. DGTCP 9505 DATED: 21-08-23

TOTAL ZONED AREA= 19.419 ACRES
ALL DIMENSIONS IN METERS

DRG. NO:-DTP 10210 DATED:-06-05-24

(DINESH KUMAR) PA(HQ) (PANKAJ BENIWAJ) ATP (HQ) (NARENDER KUMAR) DTP(HQ) (HITESH SHARMA) STP(HQ) (P.P. SINGH) CTP(HR) (T.L. SATYAPRAKASH, IAS) (DGTCP(HR))

(RAM AVTAR BASSI) JD (HQ) (VIKAS) ATP (HQ) (NARENDER KUMAR) DTP (HQ) (HITESH SHARMA) STP (HQ) (P.P. SINGH) CTP (HR) (AMIT KHATRI, IAS) DTCP (HR)

For Delta Propcon Pvt. Ltd.
Authorised Signatory