

AREA CHART - UGT

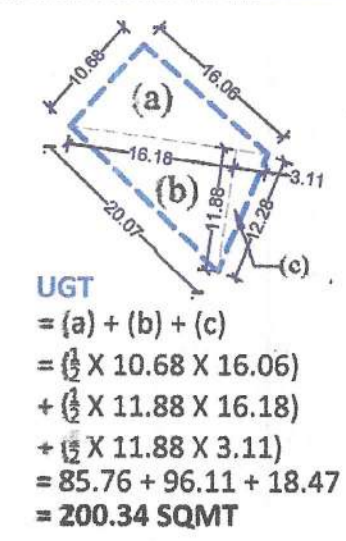

UGT = (a) + (b) + (c)
 = (1/2 X 10.68 X 16.06) + (1/2 X 11.88 X 16.18) + (1/2 X 11.88 X 3.11)
 = 85.76 + 96.11 + 18.47
 = 200.34 SQMT

AREA CHART - ET

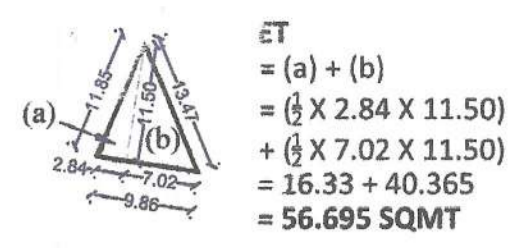

ET = (a) + (b)
 = (1/2 X 2.84 X 11.50) + (1/2 X 7.02 X 11.50)
 = 16.33 + 40.365
 = 56.695 SQMT

AREA CHART - UG STP

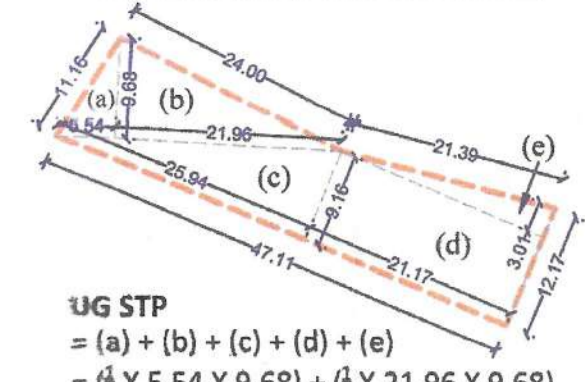

UG STP = (a) + (b) + (c) + (d) + (e)
 = (1/2 X 5.54 X 9.68) + (1/2 X 21.96 X 9.68) + (1/2 X 25.94 X 9.16) + (21.17 X 9.16) + (1/2 X 21.17 X 3.01)
 = 26.81 + 106.29 + 118.81 + 193.92 + 31.86
 = 477.69 SQMT

AREA CHART - COMMERCIAL

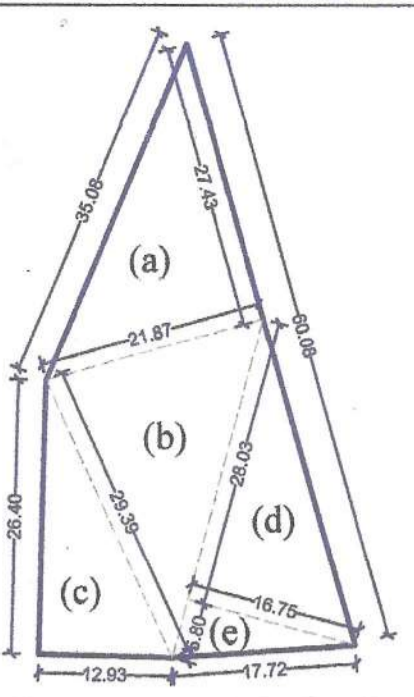

COMMERCIAL = (a) + (b) + (c) + (d) + (e)
 = (1/2 X 21.87 X 27.43) + (1/2 X 29.39 X 21.87) + (1/2 X 12.93 X 26.40) + (1/2 X 16.75 X 28.03) + (1/2 X 16.75 X 5.80)
 = 299.95 + 321.38 + 170.68 + 234.75 + 48.575
 = 1075.335 SQMT OR 0.2657 ACRE

AREA CHART - COMMUNITY FACILITIES

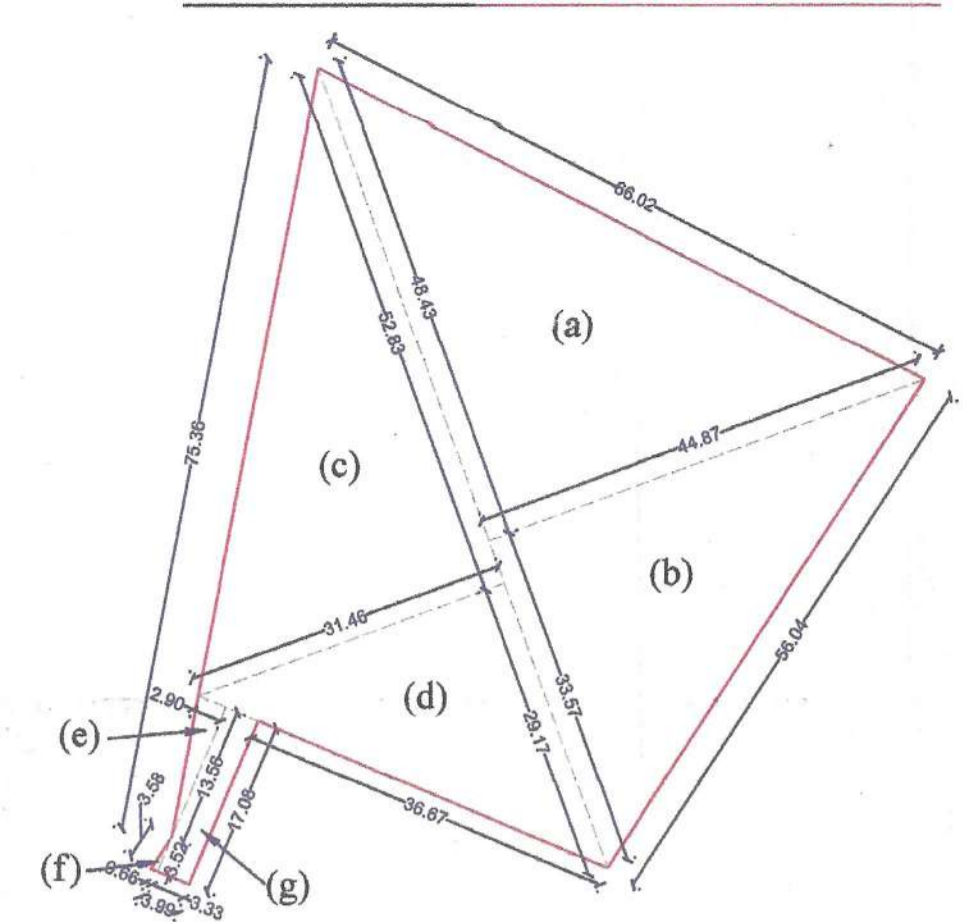

COMMUNITY FACILITIES = (a) + (b) + (c) + (d) + (e) + (f) + (g)
 = (1/2 X 44.87 X 48.43) + (1/2 X 44.87 X 33.57) + (1/2 X 31.46 X 52.83) + (1/2 X 31.46 X 29.17) + (1/2 X 13.56 X 2.90) + (1/2 X 3.52 X 0.66) + (17.08 X 3.33)
 = 1086.53 + 753.14 + 831.02 + 458.84 + 19.66 + 1.16 + 56.88
 = 3207.23 SQMT OR 0.7925 ACRE

REVISED LAYOUT CUM DEMARCATION PLAN OF AFFORDABLE RESIDENTIAL PLOTTED COLONY UNDER DEEN DAYAL JAN AWAS YOJANA-2016 OVER AN AREA MEASURING 5.10625 ACRES (LICENCE NO.148 OF 2023 DATED 18.07.2023) & ADDITIONAL AREA MEASURING 2.81875 ACRES (LICENCE NO.58 OF 2024 DATED 16.03.2024) IN THE REVENUE ESTATE OF VILL. JIND, SECTOR 4-B, TEHSIL & DISTT. JIND (HARYANA), BELONGS TO M/s. SWARN BHOOMI ASSOCIATES

| S.NO. | PARTICULARS | PROPOSAL (ACRE) | PROPOSAL (%) | PERMISSIBLE (ACRE) | PERMISSIBLE (%) |
|-------|---|-----------------|--------------|--------------------|-----------------|
| 1 | ALREADY LICENSED AREA HAVING LICENCE NO. 148 OF 2023 DATED 18.07.2023 | 5.10625 | - | - | - |
| 2 | ADDITIONAL AREA HAVING LICENCE NO.58 OF 2024 DATED 16.03.2024 | 2.81875 | - | - | - |
| 3 | NOW, AREA OF THE SCHEME | 7.9250 | - | - | - |
| 4 | AREA UNDER RESIDENTIAL PLOTS | 3.6518 | 46.08% | 4.8342 | 61.00% |
| 5 | AREA UNDER COMMERCIAL | 0.2657 | 3.35% | 0.3170 | 4.00% |
| 6 | TOTAL SALEABLE AREA(4 + 5) | 3.9175 | 49.43% | 5.1512 | 65.00% |
| 7 | OPEN SPACE/PARKS | 0.6045 | 7.63% | 0.5944 | 7.50% |
| 8 | COMMUNITY FACILITIES | 0.7925 | 10.00% | 0.7925 | 10.00% |

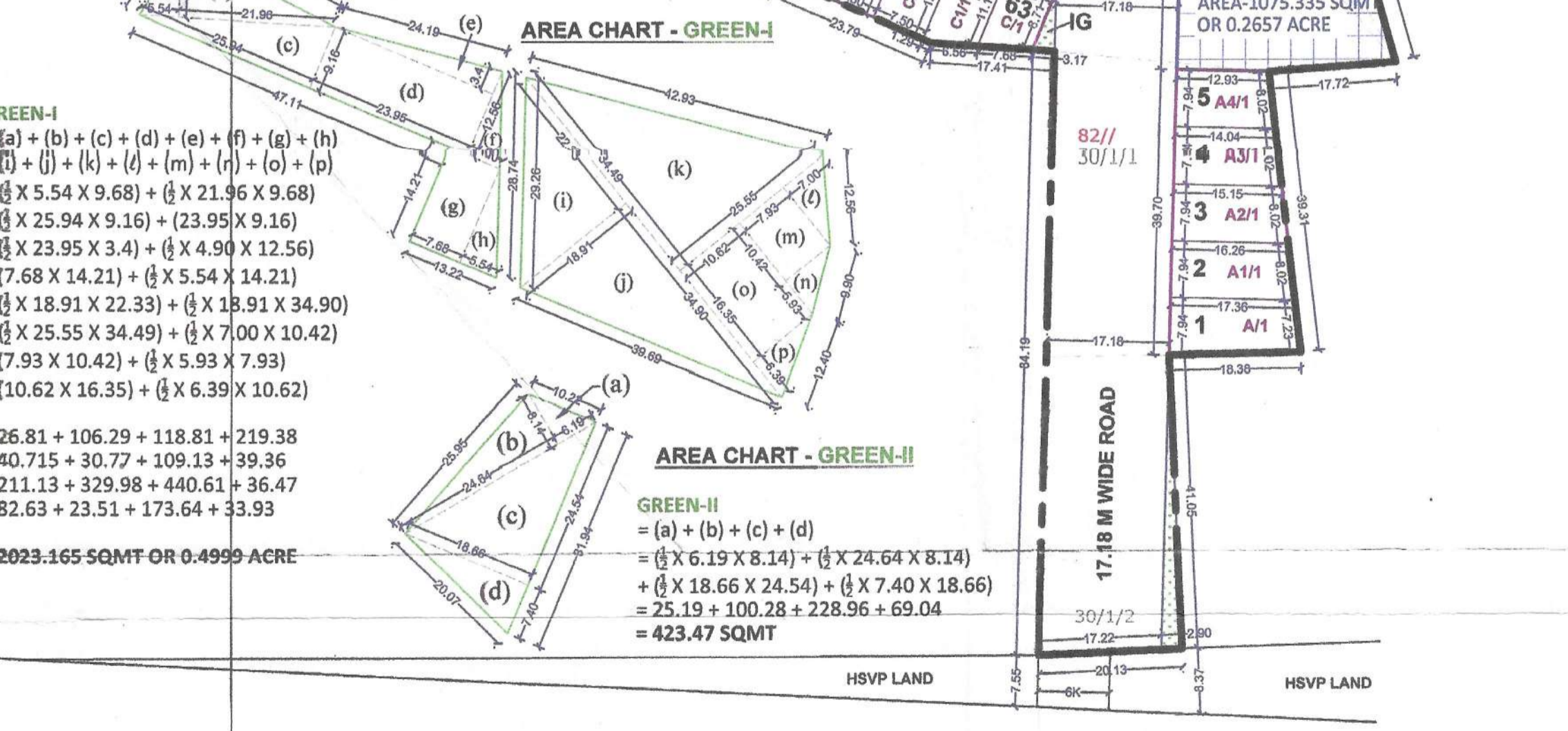
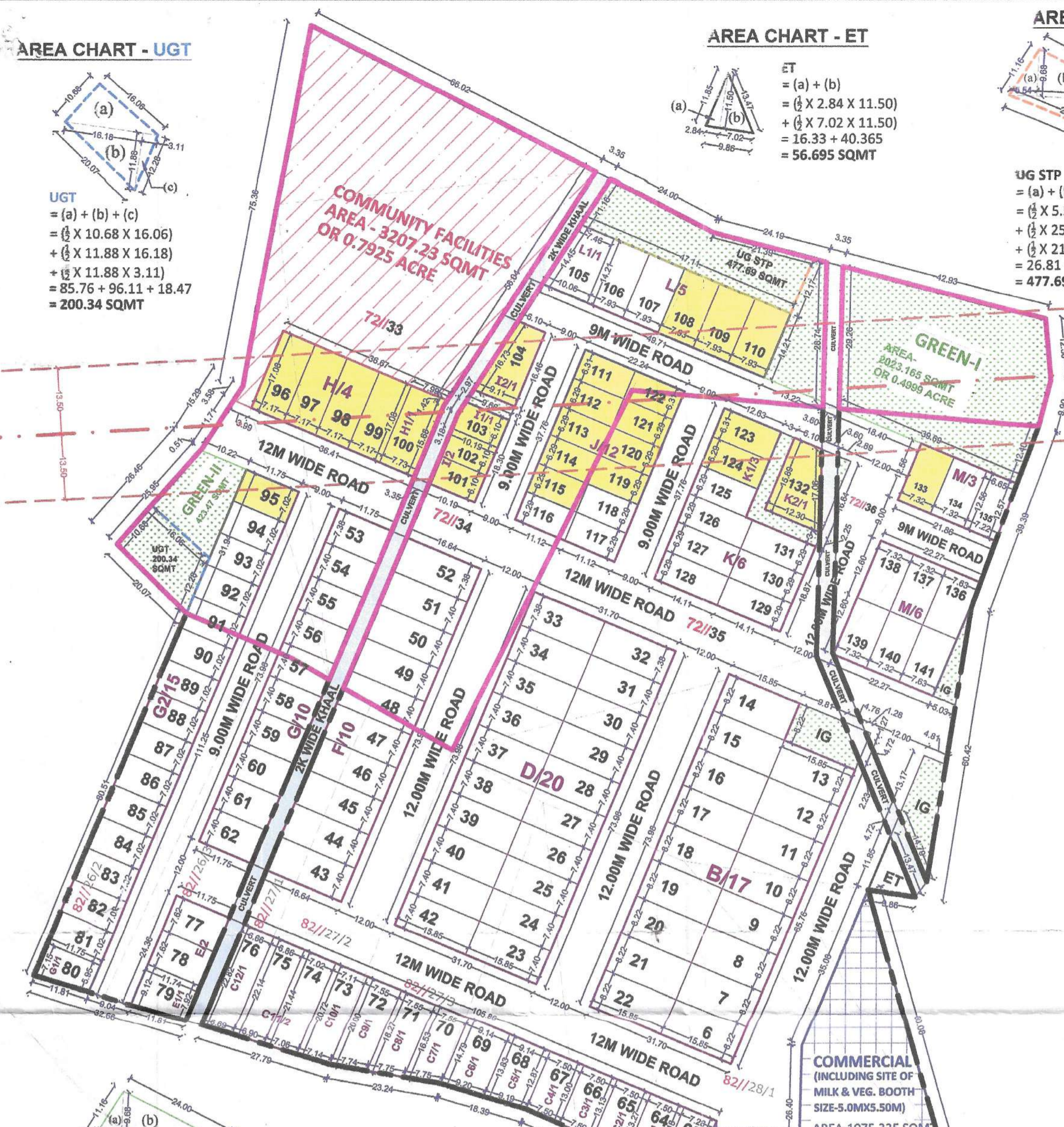

AREA CHART - MISCELLANEOUS PLOTS

| CATEGORY | Plot No. | Area (SQMT) |
|--------------|-------------|-------------|
| Category-A | Plot No.1 | 135.16 |
| Category-A1 | Plot No.2 | 133.47 |
| Category-A2 | Plot No.3 | 124.70 |
| Category-A3 | Plot No.4 | 115.89 |
| Category-A4 | Plot No.5 | 107.07 |
| Category-C | Plot No.63 | 2214.93 |
| Category-C1 | Plot No.64 | 2111.22 |
| Category-C2 | Plot No.65 | 233.94 |
| Category-C3 | Plot No.66 | 1108.26 |
| Category-C4 | Plot No.67 | 122.80 |
| Category-C5 | Plot No.68 | 86.72 |
| Category-C6 | Plot No.69 | 782.55 |
| Category-C7 | Plot No.70 | 72.40 |
| Category-C8 | Plot No.71 | 93.10 |
| Category-C9 | Plot No.72 | 99.00 |
| Category-C10 | Plot No.73 | 97.99 |
| Category-C11 | Plot No.74 | 97.01 |
| Category-C12 | Plot No.75 | 122.02 |
| Category-E1 | Plot No.76 | 130.80 |
| Category-E2 | Plot No.77 | 118.23 |
| Category-E3 | Plot No.78 | 131.37 |
| Category-E4 | Plot No.79 | 144.47 |
| Category-E5 | Plot No.80 | 144.76 |
| Category-E6 | Plot No.81 | 147.98 |
| Category-E7 | Plot No.82 | 149.48 |
| Category-E8 | Plot No.83 | 149.71 |
| Category-E9 | Plot No.84 | 149.71 |
| Category-E10 | Plot No.85 | 179.08 |
| Category-E11 | Plot No.86 | 100.02 |
| Category-E12 | Plot No.87 | 70.90 |
| Category-E13 | Plot No.88 | 1237.35 |
| Category-E14 | Plot No.89 | 489.84 |
| Category-E15 | Plot No.90 | 132.21 |
| Category-E16 | Plot No.91 | 112.69 |
| Category-E17 | Plot No.92 | 124.32 |
| Category-E18 | Plot No.93 | 61.39 |
| Category-E19 | Plot No.94 | 125.18 |
| Category-E20 | Plot No.95 | 124.48 |
| Category-E21 | Plot No.96 | 124.48 |
| Category-E22 | Plot No.97 | 563.45 |
| Category-E23 | Plot No.98 | 112.69 |
| Category-E24 | Plot No.99 | 70.17 |
| Category-E25 | Plot No.100 | 140.34 |
| Category-E26 | Plot No.101 | 69.94 |
| Category-E27 | Plot No.102 | 69.94 |
| Category-E28 | Plot No.103 | 79.70 |
| Category-E29 | Plot No.104 | 158.88 |
| Category-E30 | Plot No.105 | 532.50 |
| Category-E31 | Plot No.106 | 146.19 |
| Category-E32 | Plot No.107 | 146.19 |
| Category-E33 | Plot No.108 | 183.88 |
| Category-E34 | Plot No.109 | 87.10 |
| Category-E35 | Plot No.110 | 192.28 |
| Category-E36 | Plot No.111 | 368.92 |
| Category-E37 | Plot No.112 | 146.19 |
| Category-E38 | Plot No.113 | 146.19 |
| Category-E39 | Plot No.114 | 183.88 |
| Category-E40 | Plot No.115 | 87.10 |
| Category-E41 | Plot No.116 | 192.28 |
| Category-E42 | Plot No.117 | 368.92 |
| Category-E43 | Plot No.118 | 146.19 |
| Category-E44 | Plot No.119 | 146.19 |
| Category-E45 | Plot No.120 | 183.88 |
| Category-E46 | Plot No.121 | 87.10 |
| Category-E47 | Plot No.122 | 192.28 |
| Category-E48 | Plot No.123 | 368.92 |
| Category-E49 | Plot No.124 | 146.19 |
| Category-E50 | Plot No.125 | 146.19 |
| Category-E51 | Plot No.126 | 183.88 |
| Category-E52 | Plot No.127 | 87.10 |
| Category-E53 | Plot No.128 | 192.28 |
| Category-E54 | Plot No.129 | 368.92 |
| Category-E55 | Plot No.130 | 146.19 |
| Category-E56 | Plot No.131 | 146.19 |
| Category-E57 | Plot No.132 | 183.88 |

DETAIL OF RESIDENTIAL PLOTS

| S.NO. | PLOT NO. | CATEGORY | SIZE(IN METERS) | AREA(IN SQMT) | NO. OF PLOTS | TOTAL(IN SQMT) |
|-------|--------------------|----------|----------------------------|---------------|--------------|--------------------------------------|
| 1 | 1 | A | AS PER PLAN | 135.16 | 1 | 135.16 |
| 2 | 2 | A1 | AS PER PLAN | 133.47 | 1 | 133.47 |
| 3 | 3 | A2 | AS PER PLAN | 124.70 | 1 | 124.70 |
| 4 | 4 | A3 | AS PER PLAN | 115.89 | 1 | 115.89 |
| 5 | 5 | A4 | AS PER PLAN | 107.07 | 1 | 107.07 |
| 6 | 6 TO 22 | B | 8.22 X | 15.85 | 17 | 2214.93 |
| 7 | 23 TO 31, 34 TO 42 | D | 7.40 X | 15.85 | 18 | 2111.22 |
| 8 | 43 TO 51 | F | 7.38 X | 16.64 | 9 | 1108.26 |
| 9 | 52 | F | 7.38 X | 16.64 | 1 | 122.80 |
| 9 | 53 | G | 7.38 X | 11.75 | 1 | 86.72 |
| 9 | 54 TO 62 | G | 7.40 X | 11.75 | 9 | 782.55 |
| 10 | 63 | C | AS PER PLAN | 72.40 | 1 | 72.40 |
| 11 | 64 | C1 | AS PER PLAN | 93.10 | 1 | 93.10 |
| 12 | 65 | C2 | 7.50 X (13.27 + 13.13) / 2 | 13.20 | 1 | 99.00 |
| 13 | 66 | C3 | 7.50 X (13.13 + 13.00) / 2 | 13.065 | 1 | 97.99 |
| 14 | 67 | C4 | 7.50 X (13.00 + 12.87) / 2 | 12.935 | 1 | 97.01 |
| 15 | 68 | C5 | AS PER PLAN | 122.02 | 1 | 122.02 |
| 16 | 69 | C6 | AS PER PLAN | 130.80 | 1 | 130.80 |
| 17 | 70 | C7 | AS PER PLAN | 118.23 | 1 | 118.23 |
| 18 | 71 | C8 | AS PER PLAN | 131.37 | 1 | 131.37 |
| 19 | 72 | C9 | AS PER PLAN | 144.47 | 1 | 144.47 |
| 20 | 73 | C10 | AS PER PLAN | 144.76 | 1 | 144.76 |
| 21 | 74 | C11 | AS PER PLAN | 147.98 | 1 | 147.98 |
| 21 | 75 | C11 | AS PER PLAN | 149.48 | 1 | 149.48 |
| 22 | 76 | C12 | AS PER PLAN | 149.71 | 1 | 149.71 |
| 23 | 77, 78 | E | 7.62 X | 11.75 | 2 | 179.08 |
| 24 | 79 | E1 | AS PER PLAN | 100.02 | 1 | 100.02 |
| 25 | 80 | E1 | AS PER PLAN | 70.90 | 1 | 70.90 |
| 26 | 81 TO 95 | G2 | 7.02 X | 11.75 | 15 | 1237.35 |
| 27 | 96 TO 99 | H | 7.17 X | 17.08 | 4 | 489.84 |
| 28 | 100 | H1 | AS PER PLAN | 132.21 | 1 | 132.21 |
| 29 | 101, 102 | I | 6.10 X | 10.19 | 2 | 124.32 |
| 30 | 103 | I1 | AS PER PLAN | 61.39 | 1 | 61.39 |
| 31 | 104 | I2 | AS PER PLAN | 125.18 | 1 | 125.18 |
| 32 | 105 | L1 | AS PER PLAN | 124.48 | 1 | 124.48 |
| 33 | 106 TO 110 | L | 7.93 X | 14.21 | 5 | 563.45 |
| 34 | 111, 122 | J | 6.31 X | 11.12 | 2 | 140.34 |
| 34 | 112 TO 121 | J | 6.29 X | 11.12 | 10 | 69.94 |
| 35 | 123 | K1 | 6.31 X | 12.63 | 1 | 79.70 |
| 35 | 124, 125 | K | 6.29 X | 12.63 | 2 | 158.88 |
| 36 | 126 TO 131 | K | 6.29 X | 14.11 | 6 | 532.50 |
| 37 | 132 | K2 | AS PER PLAN | 146.19 | 1 | 146.19 |
| 38 | 133, 134 | M | 7.32 X | 12.56 | 2 | 183.88 |
| 38 | 135 | M | AS PER PLAN | 87.10 | 1 | 87.10 |
| 38 | 136, 141 | M | 7.63 X | 12.60 | 2 | 192.28 |
| 38 | 137 TO 140 | M | 7.32 X | 12.60 | 4 | 368.92 |
| 39 | | TOTAL | | | 141 | 14778.50 SQMT 3.6518 ACRES 46.08% |

NOTE - PLOTS FALLING UNDER R.O.W. OF 132KV HT LINE SHALL BE FREEZED TILL THE 132KV HT LINE SHIFTED AT SITE SHOWN THUS

EXISTING 45M WIDE SECTOR ROAD FROM SECTOR -6 TO SECTOR-8

DIVINE ARCHITECTS & PLANNERS

LEGEND:
 PARKS / OPEN SPACES
 COMMERCIAL AREA
 COMMUNITY FACILITIES
 KILLA LINE
 LICENSED BOUNDARY
 KHAAL
 132KV HT LINE
 ADDITIONAL AREA BOUNDARY
 UG STP

ABBREVIATIONS:
 ET = ELECTRIC TRANSFORMER
 IG = INCIDENTAL GREEN
 UGT = UNDERGROUND WATER TANK
 UG STP = UNDERGROUND SEWAGE TREATMENT PLANT

DENSITY CALCULATION(PPA)-
 NUMBER OF PLOTS = 141
 UNITS ALLOWED = 3
 POPULATION ALLOWED PER UNIT = 4.5
 DENSITY CALCULATION = 141 X 3 X 4.5
 = 1903.50 / 7.9250
 = 240.19, SAY 240 PPA

GREEN AREA CALCULATION:-
 = GREEN-I + GREEN-II
 = 2023.165 + 423.47
 = 2446.635 SQMT OR 0.6045 ACRE

(SCALE-N.T.S.) (PERMISSIBLE DENSITY: 240 PPA - 400 PPA)

FOR SWARN BHOOMI ASSOCIATES AUTH. SIGN.

SIGNATURE OF OWNER / APPLICANT

SIGNATURE OF ARCHITECT / M. PLANNER

AR. MOUJIB SHARMA
 C.No.10/7857
 (R) 8913-00178