

ZONING PLAN OF AFFORDABLE RESIDENTIAL, PLOTTED COLONY UNDER DEEN DAVAJI, JAM AWAS YOJANA OVER AN AREA MEASURING 13.60 ACRES/PLOTS NO. 29 OF 2019 DATED 04.05.2019 IN THE REVENUE ESTABLISHMENT OF VILLAGE RAVALGANI SECTION-4B AMBALA CANTT. DISTRICT AMBALA (HARYANNA) BEING DEVELOPED BY M/S HERMAN PROPERTIES PVT. LTD. & OTHERS

FOR PURPOSE OF CHAPTER 12 (MCO) & 6.1 (I) OF THE HARYANA BUILDING CODE, 2017, AS AMENDED FROM TIME TO TIME.

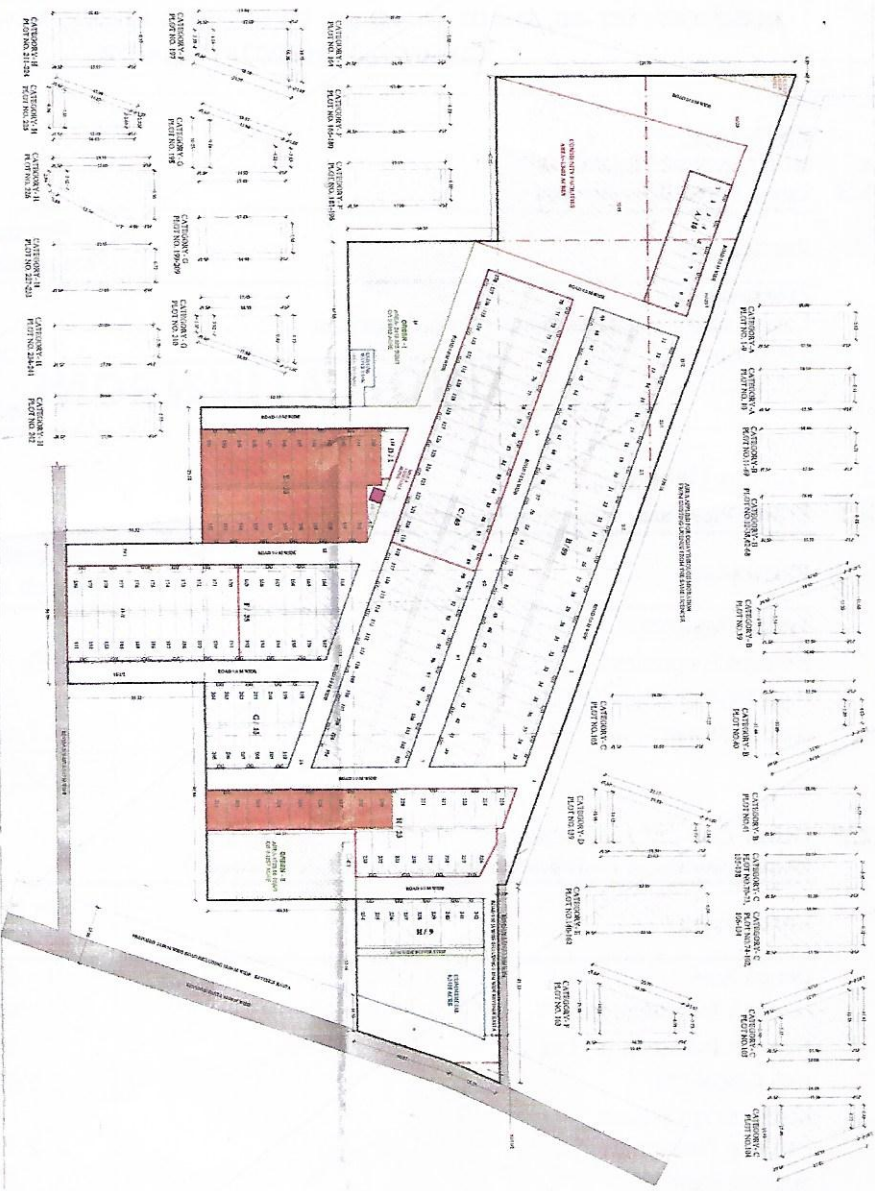

**ZONING PLAN
SCALE: 1:50**

1. USE ZONE

The land shown in this zoning plan shall be used in accordance with the following categories:

Category	Permissible use of land	Height of building (permissible on land parcel and its sub-plot)
Residential	High density residential	As per approved plan
Commercial	Trade and service	As per approved plan
Industrial	Manufacturing	As per approved plan
Public	Public use	As per approved plan
Community	Community building	As per approved plan

1. The land shown in this zoning plan shall be used in accordance with the following categories:
2. The height of building shall be as per the following table:
3. The use of land shall be as per the following table:
4. The use of land shall be as per the following table:
5. The use of land shall be as per the following table:
6. The use of land shall be as per the following table:
7. The use of land shall be as per the following table:
8. The use of land shall be as per the following table:
9. The use of land shall be as per the following table:
10. The use of land shall be as per the following table:
11. The use of land shall be as per the following table:
12. The use of land shall be as per the following table:
13. The use of land shall be as per the following table:
14. The use of land shall be as per the following table:
15. The use of land shall be as per the following table:
16. The use of land shall be as per the following table:
17. The use of land shall be as per the following table:
18. The use of land shall be as per the following table:
19. The use of land shall be as per the following table:
20. The use of land shall be as per the following table:
21. The use of land shall be as per the following table:
22. The use of land shall be as per the following table:
23. The use of land shall be as per the following table:
24. The use of land shall be as per the following table:
25. The use of land shall be as per the following table:
26. The use of land shall be as per the following table:
27. The use of land shall be as per the following table:
28. The use of land shall be as per the following table:
29. The use of land shall be as per the following table:
30. The use of land shall be as per the following table:
31. The use of land shall be as per the following table:
32. The use of land shall be as per the following table:
33. The use of land shall be as per the following table:
34. The use of land shall be as per the following table:
35. The use of land shall be as per the following table:
36. The use of land shall be as per the following table:
37. The use of land shall be as per the following table:
38. The use of land shall be as per the following table:
39. The use of land shall be as per the following table:
40. The use of land shall be as per the following table:
41. The use of land shall be as per the following table:
42. The use of land shall be as per the following table:
43. The use of land shall be as per the following table:
44. The use of land shall be as per the following table:
45. The use of land shall be as per the following table:
46. The use of land shall be as per the following table:
47. The use of land shall be as per the following table:
48. The use of land shall be as per the following table:
49. The use of land shall be as per the following table:
50. The use of land shall be as per the following table:
51. The use of land shall be as per the following table:
52. The use of land shall be as per the following table:
53. The use of land shall be as per the following table:
54. The use of land shall be as per the following table:
55. The use of land shall be as per the following table:
56. The use of land shall be as per the following table:
57. The use of land shall be as per the following table:
58. The use of land shall be as per the following table:
59. The use of land shall be as per the following table:
60. The use of land shall be as per the following table:
61. The use of land shall be as per the following table:
62. The use of land shall be as per the following table:
63. The use of land shall be as per the following table:
64. The use of land shall be as per the following table:
65. The use of land shall be as per the following table:
66. The use of land shall be as per the following table:
67. The use of land shall be as per the following table:
68. The use of land shall be as per the following table:
69. The use of land shall be as per the following table:
70. The use of land shall be as per the following table:
71. The use of land shall be as per the following table:
72. The use of land shall be as per the following table:
73. The use of land shall be as per the following table:
74. The use of land shall be as per the following table:
75. The use of land shall be as per the following table:
76. The use of land shall be as per the following table:
77. The use of land shall be as per the following table:
78. The use of land shall be as per the following table:
79. The use of land shall be as per the following table:
80. The use of land shall be as per the following table:
81. The use of land shall be as per the following table:
82. The use of land shall be as per the following table:
83. The use of land shall be as per the following table:
84. The use of land shall be as per the following table:
85. The use of land shall be as per the following table:
86. The use of land shall be as per the following table:
87. The use of land shall be as per the following table:
88. The use of land shall be as per the following table:
89. The use of land shall be as per the following table:
90. The use of land shall be as per the following table:
91. The use of land shall be as per the following table:
92. The use of land shall be as per the following table:
93. The use of land shall be as per the following table:
94. The use of land shall be as per the following table:
95. The use of land shall be as per the following table:
96. The use of land shall be as per the following table:
97. The use of land shall be as per the following table:
98. The use of land shall be as per the following table:
99. The use of land shall be as per the following table:
100. The use of land shall be as per the following table:

PREPARED BY: **HERMAN PROPERTIES PVT. LTD.**

DATE: **27-03-2019**

SCALE: **1:50**

PROJECT NO: **13.60 ACRES**

SECTION: **4B**

DISTRICT: **AMBALA**

STATE: **HARYANA**

APPROVED BY: **LOCAL AUTHORITY**

DATE OF APPROVAL: **04.05.2019**

FOR MORE INFORMATION CONTACT: **HERMAN PROPERTIES PVT. LTD.**

CONTACT NO: **011-26101111**

WEBSITE: **WWW.HERMANPROPERTIES.COM**