

AREA STATEMENT			
PLOT AREA	=	11.2820 ACERS	FAR AGAINST WASTE MANAGEMENT CALCULATION
PERMISSIBLE GR. COVG 50%	=	4575.825 SQM	OCCUPANCY OBTAINED
ACHIEVED GR. COVERAGE 18.89%	=	22787.812 SQM	BALANCE AREA
FAR CALCULATION			ACHIEVED
PERMISSIBLE FAR 1.75%	=	8005.013 SQM	BALANCE LAND AREA FOR WASTE MANAGEMENT FAR
ADDITIONAL AREA FOR WASTE MANAGEMENT PLANT 3% ON 2.063 ACRES= 834.98 SQM			2.273 ACRES
NET PERMISSIBLE			9199.490 SQM
ACHIEVED FAR (HOUSING)	=	79757.343 SQM	FAR FOR WASTE MANAGEMENT
PERMISSIBLE COMMERCIAL 4%			275.985 SQM
PERMISSIBLE FAR FOR SHOPPING 1.5 OF 1823.025			
ACHIEVED ARE FOR COMMERCIAL	=	2731.730 SQM	
ACHIEVED FAR (A + B)	=	80028.894 SQM	
MINIMUM GREEN AREA 15%	=	8638.344 SQM	
GREEN AREA PROVIDED (17.03%)	=	7789.000 SQM	

PROPOSED GROUND COVERAGE					
BLOCK'S NAME	NO. OF FLOORS	NO. OF BLK	OC GRANTED	ALREADY SANCTIONED	PROPOSED
BLOCK - A, F	G+13	2	491.24		992.48
BLOCK - B	G+13	1	490.01		980.01
BLOCK - C	G+13	1	489.94		979.88
BLOCK - D	G+13	1	488.51		977.02
BLOCK - E	G+13	1	490.23		980.46
BLOCK - G,H,I	G+13	3	478.65		1435.95
BLOCK - K	G+3	1	225.96		225.96
BLOCK - L,M,N & O	G+3	4	225.96		903.84
BLOCK - P	G+3	1	353.08		353.08
BLOCK - Q	G+S+15	1		492.990	492.990
BLOCK - J	G+13	1	478.65		478.65
COMMERCIAL BLK-1	G+2	1	969.513		969.513
COMMERCIAL BLK-2	G+1	1	315.740		315.740
COMMUNITY BUILDING	B+G	1	205.460		205.460
Sale Hours 3:00:00 m#		2			18.36
NURSERY SCHOOL		1	284.670		284.670
TOTAL					8606.01
					18.88

PROPOSED FAR					
BLOCK'S NAME	NO. OF FLOORS	NO. OF BLK	OC GRANTED	ALREADY SANCTIONED	PROPOSED
BLOCK - A	G+13	1	6433.92		6433.920
BLOCK - B	G+13	1	6416.01		6416.010
BLOCK - C	G+13	1	6414.95		6414.950
BLOCK - D	G+13	1	6390.67		6390.670
BLOCK - E	G+13	1	6419.36		6419.360
BLOCK - F	G+13	1	6427.00		6427.000
BLOCK - G,H,I	G+13	3	6425.26		19275.780
BLOCK - K	G+3	1	851.20		851.200
BLOCK - L,M,N & O	G+3	4	903.82		315.280
BLOCK - P	G+3	1	1412.34		1412.340
BLOCK - Q	G+S+15	1		7009.934	7009.934
BLOCK - J	G+13	1	6425.26		6425.260
COMMUNITY BUILDING	G	1	205.460		205.460
TOTAL FOR HOUSING			2100.040		77287.664
COMMERCIAL BLK-1	G+2	1	2100.040		2100.040
COMMERCIAL BLK-2	G+1	1	631.690		631.690
TOTAL FOR COMMERCIAL			2731.730		2731.730
TOTAL			80028.894		80028.894
NURSERY SCHOOL		1			794.000

STILT AREA					
BLOCK'S NAME	NO. OF FLOORS	NO. OF BLK	OC GRANTED	ALREADY SANCTIONED	PROPOSED
BLOCK - A	G+13	1	107.38		107.38
BLOCK - B	G+13	1	109.41		109.41
BLOCK - C	G+13	1	109.41		109.41
BLOCK - D	G+13	1	113.27		113.27
BLOCK - E	G+13	1	108.45		108.45
BLOCK - F	G+13	1	115.85		115.85
BLOCK - G,H,I	G+13	3	113.88		341.64
BLOCK - K	G+3	1	15		15
BLOCK - L,M,N & O	G+3	4	16		64
BLOCK - P	G+3	1	24		24
BLOCK - Q	G+S+15	1		123	123
BLOCK - J	G+13	1	113.88		113.88
TOTAL					1388.133

DENSITY CALCULATION					
PERMISSIBLE DENSITY					
PERMISSIBLE DENSITY	=	800 PPA			
PROPOSED DENSITY	=	678.20 PERSONS			
PROPOSED DENSITY	=	589 PPA			

BASEMENT AREA					
BLOCK'S NAME	NO. OF FLOORS	NO. OF BLK	OC GRANTED	ALREADY SANCTIONED	PROPOSED
BLOCK - A, F	G+13	2	110		220
BLOCK - B	G+13	1	110		110
BLOCK - C	G+13	1	110		110
BLOCK - D	G+13	1	110		110
BLOCK - E	G+13	1	110		110
BLOCK - G,H,I	G+13	3	110		330
BLOCK - K (ONE UNIT LESS ON 4TH FL)	G+3	1	15		15
BLOCK - L,M,N & O	G+3	4	16		64
BLOCK - P	G+3	1	24		24
BLOCK - Q	G+S+15	1		123	123
BLOCK - J	G+13	1	110		110
TOTAL DENSITY					1326

BASEMENT AREA FOR PARKING OC + REVISID					
SANCTIONED	OC GRANTED	BALANCE	REVISED	TOTAL	
22980.730	17051.950	6028.780		22980.730	SQM
	17051.950		4526.028	21677.978	SQM

PARKING CALCULATION					
REQUIRED PARKING	SANCTIONED	REVISED	OC GRANTED	SANCTIONED	PROPOSED
TOTAL NO OF UNITS X 1.0 (ECS)	1203	1325	1106	110	123
COVERED PARKING REQUIRED 50%	601.5	663			
OPEN PARKING REQUIRED 50%	601.5	663			

PARKING PROVIDED					
PARKING IN BASEMENT (30SQMECS)	PARKING IN STILT (30SQMECS)	TOTAL COVD. PARKING PROVIDED	OPEN PARKING AREA 250SQMECS	TOTAL PARKING PROVIDED	
510	4526.028	1220	44	639	ECB
36	269.852	8		44	ECB
				1342	ECB
				1108	ECB

GREEN AREA CALCULATION					
DESCRIPTION					
A	=	22.625	X	44.56	1008.17
B	=	16.94	X	17.5	296.45
C	=	51.151	X	30.772	1574.02
D	=	10.12	X	23.845	241.19
E	=	19.46	X	26.775	520.91
F	=	10.26	X	15.575	159.80
G	=	2.95	X	51.525	151.74
H	=	9.09	X	14.83	134.76
J	=	56.25	X	11.77	662.00
K	=	14.17	X	27.375	387.90
L	=	12.88	X	26.652	171.56
M	=	7.23	X	16.08	348.53
N	=	7.45	X	7.34	163.94
P	=	7.04	X	15.32	323.33
R	=	7.23	X	16.656	481.36
S	=	3.30	X	6.82	45.05
T	=	2.50	X	6.82	85.25
U	=	26.48	X	17.685/2	234.17
V	=	10.36	X	17.074	176.94
W	=	14.60	X	24.647	359.85
X	=	9.62	X	10.15	97.63
Y	=	18.59	X	4.5	83.66
Z	=	14.84	X	4.5	66.77
TOTAL GREEN AREA	=				7774.99
					17.06%

AREA FOR FEE		
F.A.R BLOCK- Q		7009.934 SQM
STILT AREA (NON F.A.R) BLOCK- Q		268.85 SQM
BASEMENT AREA (NON F.A.R)		4526.028 SQM
MUMMITY AREA & OHT		86.189 SQM
FIRE STAIR		218.79 SQM
TOTAL AREA FOR FEE		12109.793 SQM

OPEN PARKING AREA CALCULATION (OC GRANTED)					
1	167.63	X	12.00	2011.56	SQM
2	58.02	X	12.00	696.23	SQM
3	100.58	X	12.00	1206.96	SQM
4	12.00	X	48.347	580.16	SQM
5	79.05	X	12.00	948.62	SQM
6	12.00	X	40.293	483.52	SQM
7	141.41	X	12.00	1696.91	SQM
8	12.00	X	63.99	767.84	SQM
12	95.21	X	8.00	761.67	SQM
13	89.74	X	8.00	717.90	SQM
15	6.00	X	48.073	288.44	SQM
16	75.03	X	6.000	450.18	SQM
17	6.00	X	61.232	367.39	SQM
18	28.23	X	6.00	169.38	SQM
19	6.00	X	92.033	552.20	SQM
20	29.54	X	8.000	236.28	SQM
TOTAL				11935.25	SQM

OPEN PARKING AREA CALCULATION (PROPOSED)					
9	82.00	X	12.00	984.00	SQM
11	76.07	X	10.46	795.65	SQM
21	21.00	X	49.738	1044.50	SQM
22	31.44	X	13.590	427.32	SQM
23	18.06	X	12.000	216.72	SQM
TOTAL				3468.19	SQM

DRAWING TITLE
LAYOUT PLAN

DRG. NO.
S-01

MEMO NO. ZP-656/AD(RA)/2021/17743 DATED 23.07.2021
O.C. GRANTED

NEW PROPOSED BLOCK- Q

ALREADY SANCTIONED VIDE MEMO NO ZP-656/JD(BS)/2011/1987 DATED 15.02.2011

PROPOSED UTILITY AREA FOR 33 KVA GRID SUB STN AND SOLID WASTE MANGEMENT PLANT

This is a "FINAL BUILDING PLAN" approved on the purpose of inviting objections from general public.

DTP(HQ) [Signature] [Signature] [Signature]

ATP(HQ) [Signature] [Signature] [Signature]

DDT(M) MEMBER BPAC [Signature] [Signature]

TO BE READ WITH THIS OFFICE MEMO NO. DATED: [Signature]

PA [Signature] [Signature]

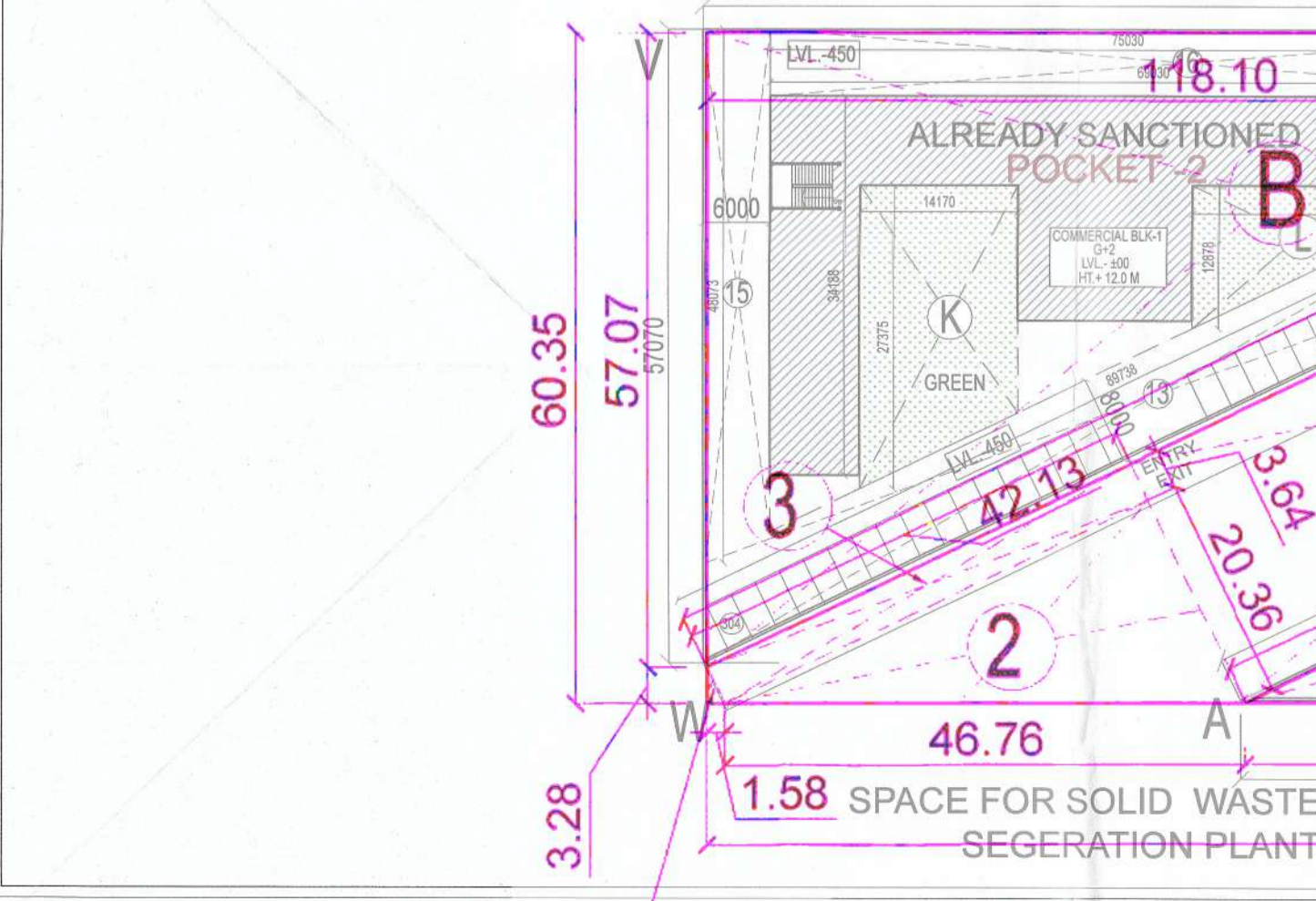
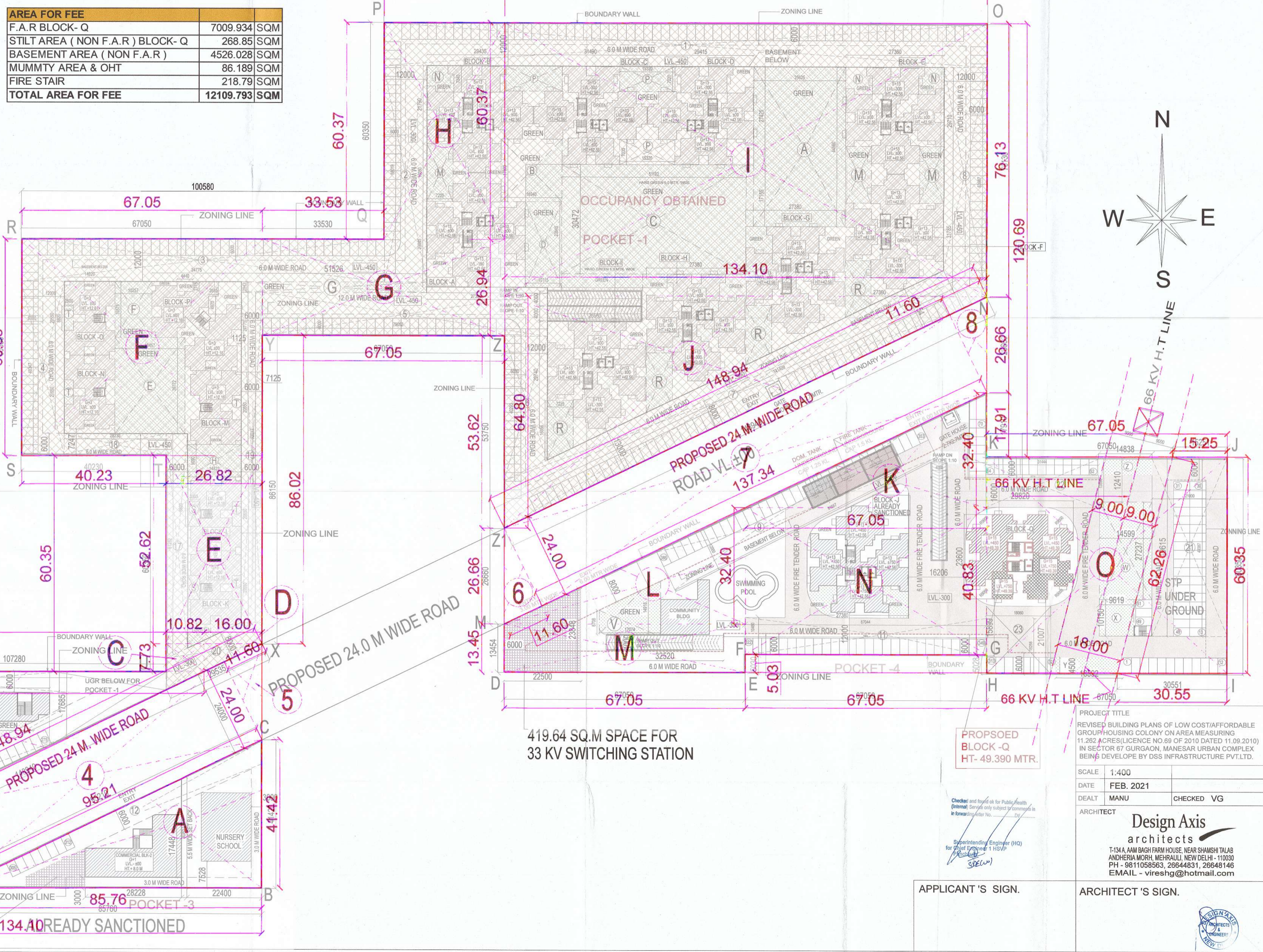

PROJECT TITLE
REVISED BUILDING PLANS OF LOW COST/AFFORDABLE GROUP HOUSING COLONY ON AREA MEASURING 11.282 ACRES (LICENSE NO. 69 OF 2010 DATED 11.09.2010) IN SECTOR 67 GURGAON, MANASAR URBAN COMPLEX BEING DEVELOPE BY DSS INFRASTRUCTURE PVT.LTD.

SCALE: 1:400
DATE: FEB. 2021
DEALT: MANU CHECKED: VG
ARCHITECT: Design Axis architects

T-13A AM BAGH FARM HOUSE, NEAR SHAMSH TALAB ANDHERIA MORTH, MEHRAULI, NEW DELHI - 110030
PH - 9811058563, 26644831, 26648146
EMAIL - vireshg@hotmail.com

APPLICANT'S SIGN. [Signature]

ARCHITECT'S SIGN. [Signature]