

OTHER'S LAND

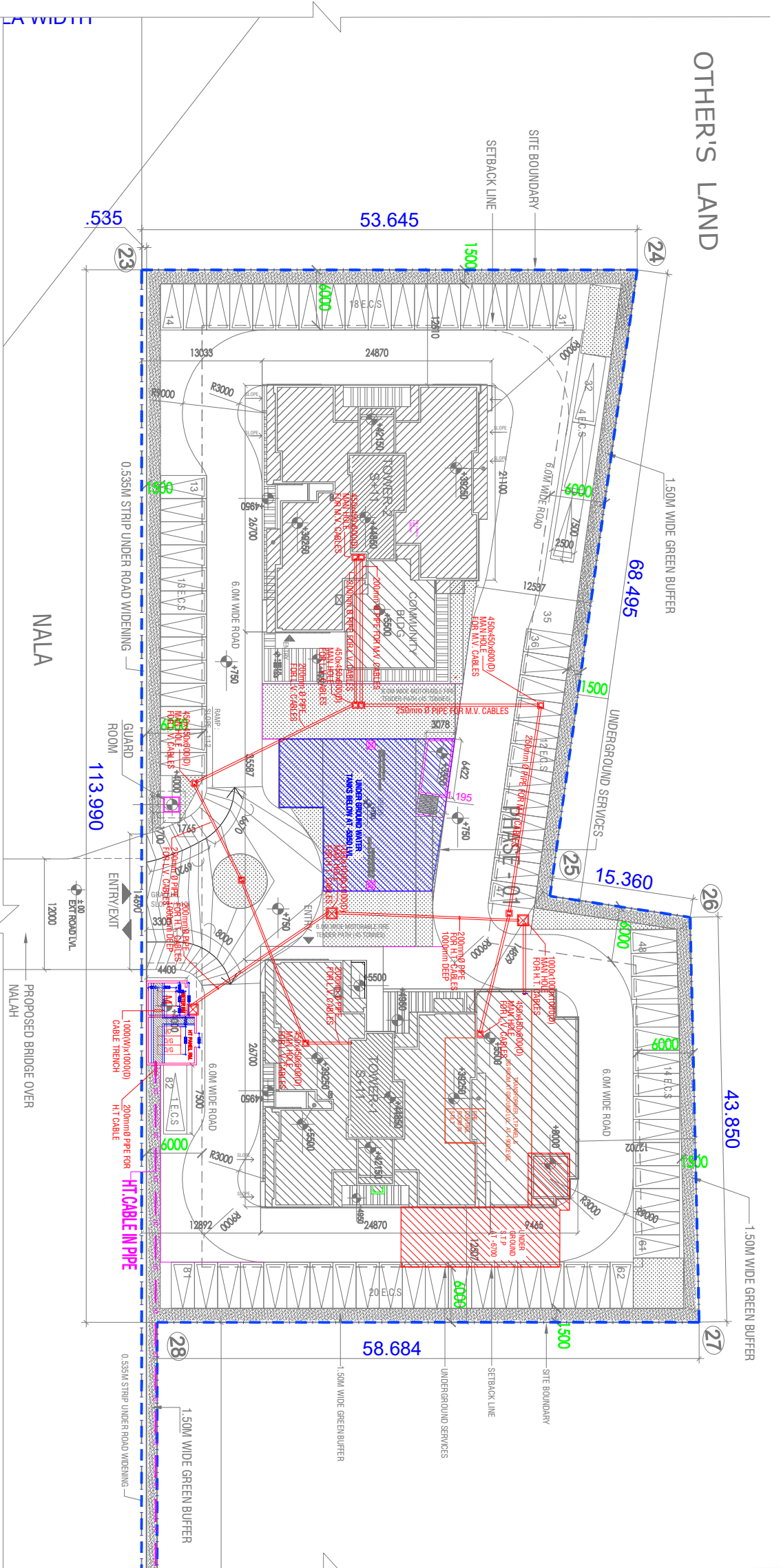

PART 1

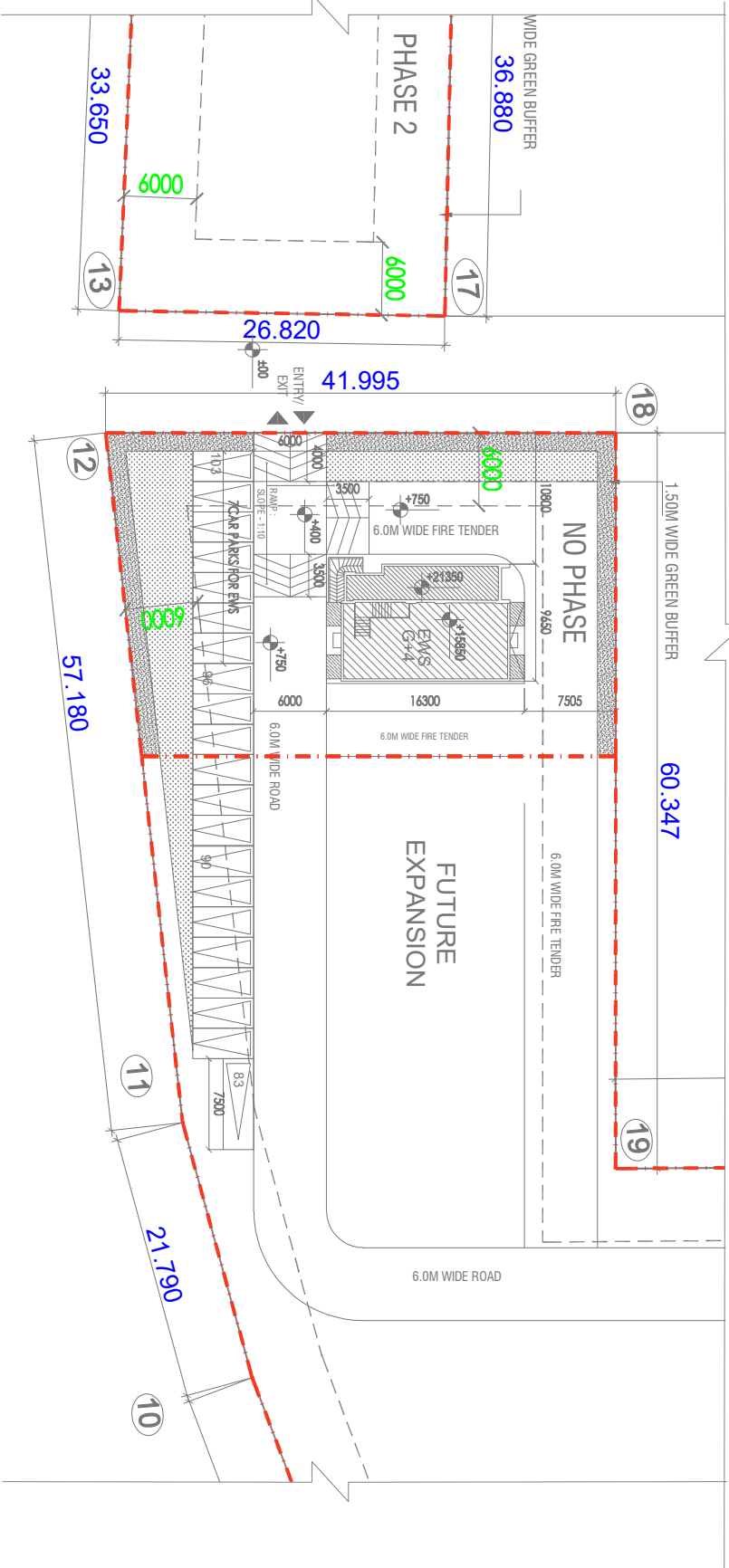

PART 2

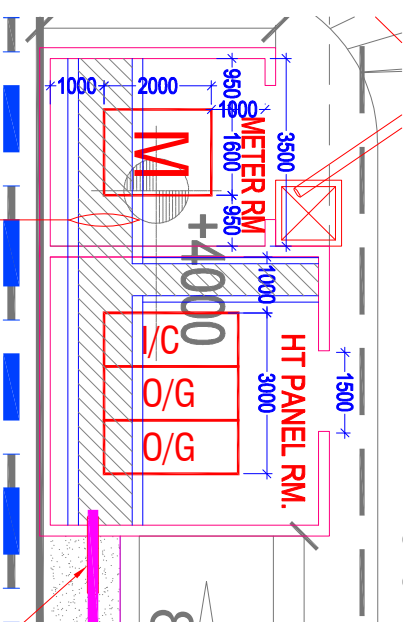

1000(W)x1000(D)
CABLE TRENCH

- NOTES
1. ALL DIMENSIONS IN MILLIMETERS UNLESS OTHERWISE SPECIFIED.
 2. ALL PAVEMENT AREAS SHALL BE MECHANICALLY LIT.
 3. ALL PAVEMENT AREAS SHALL BE MECHANICALLY LIT.
 4. THE PROVISION OF SOLAR WATER HEATING SYSTEM TO BE AS PER NORMS SPECIFIED BY BAREILLY, AND MADE OPERATIONAL BEFORE APPLYING FOR OCCUPANCY.
 5. SOLAR WATER HEATING SYSTEM SHALL BE AS PER BAREILLY GOVT.
 6. FIRE FIGHTING PROVISIONS INCLUDING FIRE SPRINKLERS SHALL BE AS PER NBC GUIDELINES.

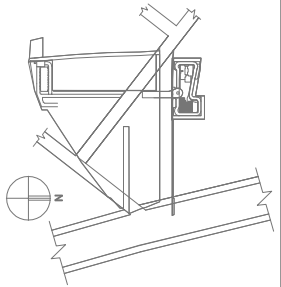

HUDA SUBMISSION DRAWING

Client :
St. Alp Singh And Other in Collaboration With
BMAAR MGF LAND LTD.

Job Title :
Proposed Building Plans for Housing Group Colony
Measuring 10.74 acre land (license no. 4 of 2013
dated 18/02/2013) in Sector 112, Gurgaon, Haryana,
Urban Complex, Gurgaon, Haryana, being developed
by St. Alp Singh and Others in Collaboration with
BMAAR MGF LAND LTD.

Architect:
Atrop Associates Pvt. Ltd.
Plot No. 16, Basement, Sector 112, New Delhi 110028
Tel: +91-11-26420000 | Fax: +91-11-26420000
Email: info@atropassociates.com

Structure:
TPC Technical Projects Consultants Pvt. Ltd.
B-7/1 Sector 27 | Metro 20201 | Uttar Pradesh | India
Tel: +91-120-450000 | Fax: +91-120-450000 | Email: info@tpc.in

MEP:
Porcedia Consultants
Plot No. 16, Basement, Sector 112, New Delhi 110028
Tel: +91-11-26420000 | Fax: +91-11-26420000
Email: info@porcediaconsultants.com

Owner's Signature

Architect's Signature

Drawing Title
PART SITE PLAN(PHASE-1)
ELECTRICAL LAYOUT

Date	Scale	Drawing No.
12-10-2023	1:200	A-007