



AREA SUMMARY FOR ALREADY SANCTIONED 5 ACRES

ITEM	AREA (SQ.M)	PERCENTAGE
TOTAL AREA	33000	100%
PLANT AREA	10000	30%
ROADS	10000	30%
GREEN	10000	30%
OPEN SPACE	3000	9%

AREA SUMMARY FOR PROPOSED 5 ACRES

ITEM	AREA (SQ.M)	PERCENTAGE
TOTAL AREA	33000	100%
PLANT AREA	10000	30%
ROADS	10000	30%
GREEN	10000	30%
OPEN SPACE	3000	9%

SUBMISSION DRAWING

CLIENT
M/S SIGNATURE GLOBAL (INDIA) PRIVATE LIMITED
Signature Global, 1308 Dr. Gopal Das Building,
28 Barakhamba Road C.P., New Delhi

PROJECT TITLE
PROPOSED REVISED BUILDING PLAN OF AFFORDABLE GROUP
HOUSING COLONY FOR AN AREA MEASURING 5.444 ACRES
(LICENSE NO. 89 OF 2019 DATED 02/06/2019 & LICENSE NO. 02
OF 2022 DATED 04/01/2022) IN SECTOR-89, GURUGRAM
MANEER URBAN COMPLEX BEING DEVELOPED BY RAMPASTHA
SARE LAND HOLDING COMPANY ONE PVT. LTD. AND OTHERS IN
COLLABORATION WITH SIGNATURE GLOBAL (INDIA) PVT. LTD.

CONSULTANT
Consummate Engineering Services Pvt. Ltd.
B-67, Sec-67, Noida
U.P. PIN-201301

DESIGNER
R.K. & ASSOCIATES
B-67, Sec-67, Noida
U.P. PIN-201301

ARCHITECT'S SIGNATURE: *Signature* OWNER'S SIGNATURE: *Signature*

DRAWING TITLE: EXTERNAL DRAINAGE SYSTEM

SCALE: 1:450 DATE: AUG 2022

DETAILS OF DRAIN LINES

Catch Pit No.	From	To	Length (m)	Di. (mm)	Slope	C.P. Top Level (m)	Invert Level (m)	Depth (m)
D1	D2	28	400	500	0.30	-1.10	1.40	0.30
D2	D3	30	400	500	0.30	-1.16	1.46	0.30
D3	D6	37	400	500	0.30	-1.22	1.52	0.30
D4	D5	17	400	500	0.30	-1.10	1.40	0.30
D5	D6	31	400	500	0.30	-1.13	1.43	0.30
D6	D9	38	400	500	0.30	-1.29	1.59	0.30
D7	D8	30	400	500	0.30	-1.10	1.40	0.30
D8	D9	13	400	500	0.30	-1.16	1.46	0.30
D9	D10	29	400	500	0.30	-1.37	1.67	0.30
D10	D12	40	400	500	0.30	-1.42	1.72	0.30
D11	D12	24	400	500	0.30	-1.10	1.40	0.30
D12	D14	47	400	500	0.30	-1.50	1.80	0.30
D13	D14	19	400	500	0.30	-1.10	1.40	0.30
D14	OUT-01	10	400	500	0.30	-1.80	1.90	0.30
D15	D16	54	400	500	0.30	-1.10	1.40	0.30
D16	D17	26	400	500	0.30	-1.21	1.51	0.30

DETAILS OF DRAIN LINES

Catch Pit No.	From	To	Length (m)	Di. (mm)	Slope	C.P. Top Level (m)	Invert Level (m)	Depth (m)
D17	D18	13	400	500	0.30	-1.26	1.56	0.30
D18	D19	27	400	500	0.30	-1.29	1.59	0.30
D19	D22	41	400	500	0.30	-1.34	1.64	0.30
D20	D21	20	400	500	0.30	-1.10	1.40	0.30
D21	D22	8	400	500	0.30	-1.14	1.44	0.30
D22	D26	15	400	500	0.30	-1.42	1.72	0.30
D23	D24	26	400	500	0.30	-1.10	1.40	0.30
D24	D25	33	400	500	0.30	-1.15	1.45	0.30
D25	D28	30	400	500	0.30	-1.22	1.52	0.30
D26	D27	42	400	500	0.30	-1.45	1.75	0.30
D27	D29	37	400	500	0.30	-1.54	1.84	0.30
D28	D29	45	400	500	0.30	-1.10	1.40	0.30
D29	D30	45	400	500	0.30	-1.19	1.49	0.30
D30	D31	34	400	500	0.30	-1.28	1.58	0.30
D31	OUT-2	10	400	500	0.30	-1.61	1.91	0.30

INVENTORY OF UNITS (PROPOSED)

TOWERS	TYPE	NO. OF UNITS	AREA (SQ.M)
TOWER-1 (G+8)	2BHK	80	10400
TOWER-2 (G+19)	2BHK	80	10400
TOWER-3 (G+19)	2BHK	80	10400
TOWER-4 (G+19)	2BHK	80	10400
TOWER-5 (G+25/26)	2BHK	80	10400
TOWER-6 (G+19)	2BHK	80	10400
TOWER-7 (G+14)	2BHK	80	10400
TOWER-8 (G+19)	2BHK	80	10400
TOWER-9 (G+19)	2BHK	80	10400
TOWER-10 (G+19)	2BHK	80	10400
TOWER-11 (G+19)	2BHK	80	10400
TOWER-12 (G+19)	2BHK	80	10400
TOWER-13 (G+19)	2BHK	80	10400
TOWER-14 (G+19)	2BHK	80	10400
TOWER-15 (G+19)	2BHK	80	10400
TOWER-16 (G+19)	2BHK	80	10400
TOWER-17 (G+19)	2BHK	80	10400
TOWER-18 (G+19)	2BHK	80	10400
TOWER-19 (G+19)	2BHK	80	10400
TOWER-20 (G+19)	2BHK	80	10400
TOWER-21 (G+19)	2BHK	80	10400
TOWER-22 (G+19)	2BHK	80	10400
TOWER-23 (G+19)	2BHK	80	10400
TOWER-24 (G+19)	2BHK	80	10400
TOWER-25 (G+19)	2BHK	80	10400
TOWER-26 (G+19)	2BHK	80	10400
TOWER-27 (G+19)	2BHK	80	10400
TOWER-28 (G+19)	2BHK	80	10400
TOWER-29 (G+19)	2BHK	80	10400
TOWER-30 (G+19)	2BHK	80	10400
TOWER-31 (G+19)	2BHK	80	10400
TOWER-32 (G+19)	2BHK	80	10400
TOWER-33 (G+19)	2BHK	80	10400
TOWER-34 (G+19)	2BHK	80	10400
TOWER-35 (G+19)	2BHK	80	10400
TOWER-36 (G+19)	2BHK	80	10400
TOWER-37 (G+19)	2BHK	80	10400
TOWER-38 (G+19)	2BHK	80	10400
TOWER-39 (G+19)	2BHK	80	10400
TOWER-40 (G+19)	2BHK	80	10400
TOWER-41 (G+19)	2BHK	80	10400
TOWER-42 (G+19)	2BHK	80	10400
TOWER-43 (G+19)	2BHK	80	10400
TOWER-44 (G+19)	2BHK	80	10400
TOWER-45 (G+19)	2BHK	80	10400
TOWER-46 (G+19)	2BHK	80	10400
TOWER-47 (G+19)	2BHK	80	10400
TOWER-48 (G+19)	2BHK	80	10400
TOWER-49 (G+19)	2BHK	80	10400
TOWER-50 (G+19)	2BHK	80	10400
TOWER-51 (G+19)	2BHK	80	10400
TOWER-52 (G+19)	2BHK	80	10400
TOWER-53 (G+19)	2BHK	80	10400
TOWER-54 (G+19)	2BHK	80	10400
TOWER-55 (G+19)	2BHK	80	10400
TOWER-56 (G+19)	2BHK	80	10400
TOWER-57 (G+19)	2BHK	80	10400
TOWER-58 (G+19)	2BHK	80	10400
TOWER-59 (G+19)	2BHK	80	10400
TOWER-60 (G+19)	2BHK	80	10400
TOWER-61 (G+19)	2BHK	80	10400
TOWER-62 (G+19)	2BHK	80	10400
TOWER-63 (G+19)	2BHK	80	10400
TOWER-64 (G+19)	2BHK	80	10400
TOWER-65 (G+19)	2BHK	80	10400
TOWER-66 (G+19)	2BHK	80	10400
TOWER-67 (G+19)	2BHK	80	10400
TOWER-68 (G+19)	2BHK	80	10400
TOWER-69 (G+19)	2BHK	80	10400
TOWER-70 (G+19)	2BHK	80	10400
TOWER-71 (G+19)	2BHK	80	10400
TOWER-72 (G+19)	2BHK	80	10400
TOWER-73 (G+19)	2BHK	80	10400
TOWER-74 (G+19)	2BHK	80	10400
TOWER-75 (G+19)	2BHK	80	10400
TOWER-76 (G+19)	2BHK	80	10400
TOWER-77 (G+19)	2BHK	80	10400
TOWER-78 (G+19)	2BHK	80	10400
TOWER-79 (G+19)	2BHK	80	10400
TOWER-80 (G+19)	2BHK	80	10400
TOWER-81 (G+19)	2BHK	80	10400
TOWER-82 (G+19)	2BHK	80	10400
TOWER-83 (G+19)	2BHK	80	10400
TOWER-84 (G+19)	2BHK	80	10400
TOWER-85 (G+19)	2BHK	80	10400
TOWER-86 (G+19)	2BHK	80	10400
TOWER-87 (G+19)	2BHK	80	10400
TOWER-88 (G+19)	2BHK	80	10400
TOWER-89 (G+19)	2BHK	80	10400
TOWER-90 (G+19)	2BHK	80	10400
TOWER-91 (G+19)	2BHK	80	10400
TOWER-92 (G+19)	2BHK	80	10400
TOWER-93 (G+19)	2BHK	80	10400
TOWER-94 (G+19)	2BHK	80	10400
TOWER-95 (G+19)	2BHK	80	10400
TOWER-96 (G+19)	2BHK	80	10400
TOWER-97 (G+19)	2BHK	80	10400
TOWER-98 (G+19)	2BHK	80	10400
TOWER-99 (G+19)	2BHK	80	10400
TOWER-100 (G+19)	2BHK	80	10400

CONNECTING TERRACE/BEAMS AREA CALCULATION

T1 = 2.030 X 6.765 = 13.733 SQ.M.
T2 = 2.400 X 3.510 = 8.424 SQ.M.
B = 2.400 X 0.23 = 0.552 SQ.M.

TOTAL AREA OF CONNECTING TERRACE/BEAMS = T1 + (2T2) + (3XB)
= 13.733 + 16.848 + 1.656
= 32.237 SQ.M.

GUARD ROOM AREA CALCULATION

AREA OF GUARD ROOM = 2 X 1.725 X 1.740
= 6.003 SQ.M.

DWELLING UNITS (DU) CALCULATIONS

S.NO.	TOWERS	UNITS	GROUND FL. UNITS	EACH FFL UNITS	TP. FL. UNITS	TOTAL FFL UNITS	NON-TYPICAL FLOOR	TOTAL UNITS IN TOWER	POPULATION PER UNIT	TOTAL
1	TOWER-1 (G+8)	2BHK+STORE	4	4	8	32	---	40	5	200
2	TOWER-2 (G+19)	2BHK	8	8	19	152	---	187	5	935
3	TOWER-3 (G+19)	2BHK	8	8	19	152	---	187	5	935
4	TOWER-4 (G+19)	2BHK	8	8	19	152	---	187	5	935
5	TOWER-5 (G+25/26)	2BHK	---	8	25	200	8	331	5	1655
6	TOWER-6 (G+19)	2BHK	---	8	8	19	---	35	5	175
7	TOWER-7 (G+14)	2BHK	---	6	4	24	6	30	5	150
TOTALS								752		3910

DENSITY CALCULATION (750-900 PPA)

S.NO.	BUILDING BLOCKS	NO. OF BLOCKS	NO. OF FLOORS	GROUND COVERAGE	TOTAL FAR	TOTAL NO. OF DU'S	POPULATION PERSON/UNIT
1	TOWER-1 (G+8)	1	(G+8)	305.944	2510.464	36	180
2	TOWER-2 (G+19)	1	(G+19)	540.768	10132.234	150	750
3	TOWER-3 (G+19)	1	(G+19)	540.768	10132.234	150	750
4	TOWER-4 (G+19)	1	(G+19)	540.768	10132.234	150	750
5	TOWER-5 (G+25/26)	1	(G+25/26)	613.215	13920.851	204	1020
6	TOWER-6 (G+19)	1	(G+19)	102.831	2290.909	32	160
7	TOWER-7 (G+14)	1	(G+14)	180.584	1413.190	30	150
8	CRECHE / COMMUNITY BUILDING	1	(G+1)	196.583	---	---	---
9	GUARD ROOM	1	G/G+1/G+2	1402.073	---	---	---
10	CONNECTING TERRACES/BEAMS	---	G	6.003	---	---	---
11	REFUGEE AREA IN TOWER T-5	1	AT 21st FLOOR	30.515	---	---	---
TOTAL				4492.289	46703.196	782	3910

FAR CALCULATION OF TOWER 6 & 7

S.NO.	FLOORS	TOWER-T-1	TOWER-T-2	TOWER-T-3	TOWER-T-4	TOWER-T-5	TOWER-T-6	TOWER-T-7	TOTAL (SQM)
1	GROUND	305.944	540.768	540.768	540.768	74.281	89.215	65.202	2156.386
2	1st	275.565	504.814	504.814	504.814	509.646	6.896	136.568	2446.117
3	2nd	275.565	504.814	504.814	504.814	509.646	274.356	139.568	2711.577
4	3rd	275.565	504.814	504.814	504.814	509.646	274.356	206.963	2840.972
5	4th	275.565	504.814	504.814	504.814	509.646	274.356	266.963	2840.972
6	5th	275.565	504.814	504.814	504.814	509.646	274.356	266.963	2840.972
7	6th	275.565	504.814	504.814	504.814	509.646	274.356	266.963	2840.972
8	7th	275.565	504.814	504.814	504.814	509.646	274.356	---	2574.029
9	8th	275.565	504.814	504.814	504.814	509.646	274.356	---	2574.029
10	9th	---	504.814	504.814	504.814	509.646	274.356	---	2236.444
11	10th	---	504.814	504.814	504.814	509.646	---	---	2024.088
12	11th	---	504.814	504.814	504.814	509.646	---	---	2024.088
13	12th	---	504.814	504.814	504.814	509.646	---	---	2024.088
14</									



AREA SUMMARY FOR REVISED PLOT AREA 5.441 ACRES

NO.	DESCRIPTION	AREA (SQ.M)
1	TOTAL PLOT AREA FOR FAR	5441.00
2	PERMISSIBLE COMMERCIAL AREA (2.00 ACRES)	2720.50
3	PERMISSIBLE RESIDENTIAL AREA (3.441 ACRES)	2720.50
4	TOTAL PERMISSIBLE AREA FOR COMMERCIAL	2720.50
5	TOTAL PERMISSIBLE AREA FOR RESIDENTIAL	2720.50
6	TOTAL PERMISSIBLE AREA FOR COMMERCIAL & RESIDENTIAL	5441.00

AREA SUMMARY FOR ALREADY SANCTIONED 9 ACRES

NO.	DESCRIPTION	AREA (SQ.M)
1	TOTAL PLOT AREA FOR FAR	9000.00
2	PERMISSIBLE COMMERCIAL AREA (2.00 ACRES)	2720.50
3	PERMISSIBLE RESIDENTIAL AREA (7.00 ACRES)	6279.50
4	TOTAL PERMISSIBLE AREA FOR COMMERCIAL	2720.50
5	TOTAL PERMISSIBLE AREA FOR RESIDENTIAL	6279.50
6	TOTAL PERMISSIBLE AREA FOR COMMERCIAL & RESIDENTIAL	9000.00

SUBMISSION DRAWING

CLIENT: M/S. SIGNATURE GLOBAL (INDIA) PRIVATE LIMITED
Signature Global, 1308 Dr. Gopal Das Building, 28 Banohamba Road C.P. New Delhi

PROJECT TITLE: PROPOSED REVISED BUILDING PLAN OF AFFORDABLE GROUP HOUSING COLONY FOR AN AREA MEASURING 5.441 ACRES (LICENCE NO. 89 OF 2019 DATED 02/08/2019 B. LICENCE NO. 02 OF 2022 DATED 04.01.2022) IN SECTOR 89, GURUGRAM, HANSEATIC URBAN COMPLEX BEING DEVELOPED BY BANPRASHTHA SARE LAND HOLDING COMPANY ONE PVT. LTD. AND OTHERS IN COLLABORATION WITH SIGNATURE GLOBAL INDIA PVT. LTD.

CONSULTANT: Consummate Engineering Services Pvt. Ltd.
NDC DESIGN INTERNATIONAL
R.K. & ASSOCIATES

ARCHITECT'S SIGNATURE: *hob.o* OWNER'S SIGNATURE: _____

DRAWING TITLE: EXTERNAL WATER SUPPLY & YARD HYDRANT

SCALE: 1:1450 DATE: AUG 2022

LEGEND

S. No.	SYMBOL	DESCRIPTION
1.	---	DOMESTIC WATER LINE TO FILL OHT (HIGH RISE)
2.	---	DOMESTIC WATER LINE TO FILL OHT (LOW RISE)
3.	---	FLUSHING WATER LINE TO FILL OHT (HIGH RISE)
4.	---	FLUSHING WATER LINE TO FILL OHT (LOW RISE)
5.	---	RECYCLED WATER SUPPLY PIPE LINE FOR HORTICULTURE
6.	---	MUNICIPAL / TANKER WATER SUPPLY PIPE LINE
7.	GH	GARDEN HYDRANT
8.	YH	PROPOSED TUBE WELL

LEGEND: FIRE SYSTEM

S. No.	SYMBOL	DESCRIPTION
1.	---	FIRE LINE
2.	OOOO	FIRE BRIGADE CONNECTION
3.	---	BUTTERFLY VALVE
4.	---	NONRETURN VALVE (CHECK VALVE)
5.	---	ISOLATING VALVE WITH MASONRY CHAMBER
6.	YH	YARD HYDRANT 63 MM. DIA. SINGLE HEADED HYDRANT VALVE WITH 2 NOS. 15 M. LONG, 63 MM. DIA. FIRE HOSE PIPE & 1 NO. BRANCH PIPE WITH NOZZLE

INVENTORY OF UNITS (PROPOSED)

NO.	TOWER	TYPE	NO. OF UNITS	TOTAL
1.	TOWER-T-1 (G+8)	2BHK	32	32
2.	TOWER-T-2 (G+19)	2BHK	80	80
3.	TOWER-T-3 (G+19)	2BHK	80	80
4.	TOWER-T-4 (G+19)	2BHK	80	80
5.	TOWER-T-5 (S+25/26)	2BHK	160	160
6.	TOWER-T-6 (G+9)	2BHK	32	32
7.	TOWER-T-7 (S+45)	2BHK	32	32
TOTAL			544	544

CONNECTING TERRACE/BEAMS AREA CALCULATION

T1 = 2.030 X 6.765 = 13.733 SQ.M.
T2 = 2.400 X 3.510 = 8.424 SQ.M.
B = 2.400 X 0.23 = 0.552 SQ.M.
TOTAL AREA OF CONNECTING TERRACE/BEAMS = T1 + (2X T2) + (3XB) = 13.733 + 16.848 + 1.656 = 32.237 SQ.M.

GUARD ROOM AREA CALCULATION

AREA OF GUARD ROOM = 2 X 1.725 X 1.740 = 6.003 SQ.M.

DWELLING UNITS (DU) CALCULATIONS

S. NO.	TOWERS	UNITS	GROUND FL. UNITS	EACH TP. FL. UNITS	TYP. FL. NOS.	TOTAL TP. FL. UNITS	NON TYPICAL FLOOR	TOTAL UNITS IN TOWER	POPULATION PER UNIT	TOTAL
1.	TOWER-T-1 (G+8)	2BHK	4	8	8	32	---	36	5	180
2.	TOWER-T-2 (G+19)	2BHK	8	8	19	132	---	140	5	700
3.	TOWER-T-3 (G+19)	2BHK	8	8	19	132	---	140	5	700
4.	TOWER-T-4 (G+19)	2BHK	8	8	19	132	---	140	5	700
5.	TOWER-T-5 (S+25/26)	2BHK	---	8	25	200	4	204	5	1020
6.	TOWER-T-6 (G+9)	2BHK	---	4	8	32	---	36	5	180
7.	TOWER-T-7 (S+45)	2BHK	---	6	4	24	6	30	5	150
TOTAL UNITS								792		3960

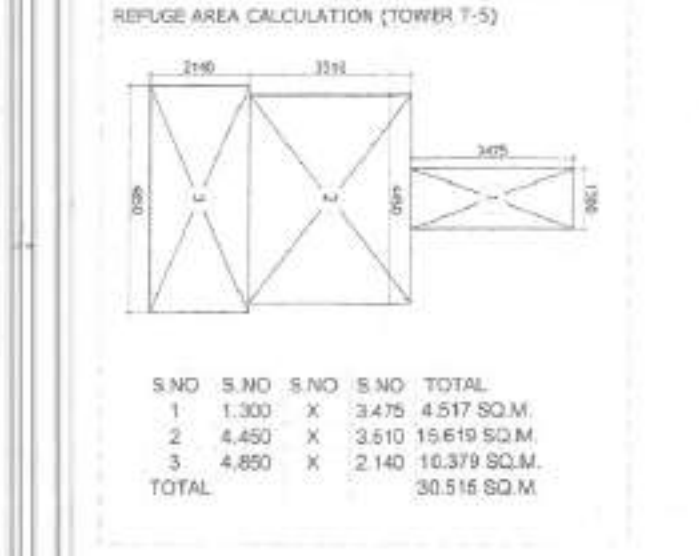

DENSITY CALCULATION (750 - 900 PPA)

S. NO.	BUILDING BLOCKS	NO. OF BLOCKS	NO. OF FLOORS	GROUND COVERAGE	TOTAL FAR	TOTAL NO. OF DU'S	POPULATION PERSON/UNIT
1.	TOWER-T-1 (G+8)	1	(G+8)	305.944	2510.464	36	180
2.	TOWER-T-2 (G+19)	1	(G+19)	540.768	10132.234	140	700
3.	TOWER-T-3 (G+19)	1	(G+19)	540.768	10132.234	140	700
4.	TOWER-T-4 (G+19)	1	(G+19)	540.768	10132.234	140	700
5.	TOWER-T-5 (S+25/26)	1	(S+25/26)	613.215	13092.881	204	1020
6.	TOWER-T-6 (G+9)	1	(G+9)	102.831	2290.959	36	180
7.	TOWER-T-7 (S+45)	1	(S+45)	180.584	1412.130	30	150
8.	CRECHE / COMMUNITY BUILDING	1	G+1	196.583	---	---	---
9.	COMMERCIAL	3	G/G+1/G-2	1402.973	---	---	---
10.	GUARD ROOM	2	G	6.003	---	---	---
11.	CONNECTING TERRACES/BEAMS	---	---	32.237	---	---	---
12.	REFUGE AREA IN TOWER T-5	1	AT 21st FLOOR	30.515	---	---	---
TOTAL				4492.289	49703.156	792	3960

FAR CALCULATION OF TOWER 6 & 7

S. NO.	FLOORS	TOWER-T-1	TOWER-T-2	TOWER-T-3	TOWER-T-4	TOWER-T-5	TOWER-T-6	TOWER-T-7	TOTAL (SQ.M)
1.	GROUND	305.944	540.768	540.768	540.768	74.281	89.215	95.202	2156.946
2.	1st	275.565	504.814	504.814	504.814	509.646	509.646	509.646	2446.117
3.	2nd	275.565	504.814	504.814	504.814	509.646	509.646	509.646	2713.577
4.	3rd	275.565	504.814	504.814	504.814	509.646	509.646	509.646	2840.972
5.	4th	275.565	504.814	504.814	504.814	509.646	509.646	509.646	2840.972
6.	5th	275.565	504.814	504.814	504.814	509.646	509.646	509.646	2840.972
7.	6th	275.565	504.814	504.814	504.814	509.646	509.646	509.646	2840.972
8.	7th	275.565	504.814	504.814	504.814	509.646	509.646	509.646	2574.009
9.	8th	275.565	504.814	504.814	504.814	509.646	509.646	509.646	2574.009
10.	9th	275.565	504.814	504.814	504.814	509.646	509.646	509.646	2256.444
11.	10th	275.565	504.814	504.814	504.814	509.646	509.646	509.646	2024.088
12.	11th	275.565	504.814	504.814	504.814	509.646	509.646	509.646	2024.088
13.	12th	275.565	504.814	504.814	504.814	509.646	509.646	509.646	2024.088
14.	13th	275.565	504.814	504.814	504.814	509.646	509.646	509.646	2024.088
15.	14th	275.565	504.814	504.814	504.814	509.646	509.646	509.646	2024.088
16.	15th	275.565	504.814	504.814	504.814	509.646	509.646	509.646	2024.088
17.	16th	275.565	504.814	504.814	504.814	509.646	509.646	509.646	2024.088
18.	17th	275.565	504.814	504.814	504.814	509.646	509.646	509.646	2024.088
19.	18th	275.565	504.814	504.814	504.814	509.646	509.646	509.646	2024.088
20.	19th	275.565	504.814	504.814	504.814	509.646	509.646	509.646	2024.088
21.	20th	275.565	504.814	504.814	504.814	509.646	509.646	509.646	2024.088
22.	21st	275.565	504.814	504.814	504.814	509.646	509.646	509.646	2024.088
23.	22nd	275.565	504.814	504.814	504.814	509.646	509.646	509.646	2024.088
24.	23rd	275.565	504.814	504.814	504.814	509.646	509.646	509.646	2024.088
25.	24th	275.565	504.814	504.814	504.814	509.646	509.646	509.646	2024.088
26.	25th	275.565	504.814	504.814	504.814	509.646	509.646	509.646	2024.088
27.	26th	275.565	504.814	504.814	504.814	509.646	509.646	509.646	2024.088
TOTAL FAR		2510.464	10132.234	10132.234	10132.234	13092.881	2290.959	1412.130	49703.156

CARPET AREA CALCULATION OF TOWER 6 & 7

S. NO.	FLOORS	TOWER-T-1	TOWER-T-2	TOWER-T-3	TOWER-T-4	TOWER-T-5	TOWER-T-6	TOWER-T-7	TOTAL (SQ.M)
1.	GROUND	229.230	438.049	438.049	437.902	571.117	COMMERCIAL	COMMERCIAL	1543.210
2.	1st	239.816	438.049	438.049	437.902	437.902	230.871	95.898	2302.287
3.	2nd	239.816	438.049	438.049	437.902	437.902	230.871	200.420	2403.009
4.	3rd	239.816	438.049	438.049	437.902	437.902	230.871	200.420	2403.009
5.	4th	239.816	438.049	438.049	437.902	437.902	230.871	200.420	2403.009
6.	5th	239.816	438.049	438.049	437.902	437.902	230.871	200.420	2403.009
7.	6th	239.816	438.049	438.049	437.902	437.902	230.871	200.420	2403.009
8.	7th	239.816	438.049	438.049	437.902	437.902	230.871	200.420	2403.009
9.	8th	239.816	438.049	438.049	437.902	437.902	230.871	200.420	2403.009
10.	9th	239.816	438.049	438.049	437.902	437.902	230.871	200.420	2403.009
11.	10th	239.816	438.049	438.049	437.902	437.902	230.871	200.420	2403.009
12.	11th	239.816	438.049	438.049	437.902	437.902	230.871	200.420	2403.009
13.	12th	239.816	438.049	438.049	437.902	437.902	230.871	200.420	2403.009
14.	13th	239.816	438.049	438.049	437.902	437.902	230.871	200.420	2403.009
15.	14th	239.816	438.049	438.049	437.902	437.902	230.871	200.420	2403.009
16.	15th	239.816	438.049	438.049	437.902	437.902	230.871	200.420	2403.009
17.	16th	239.816	438.049	438.049	437.902	437.902	230.871	200.420	2403.009
18.	17th	239.816	438.049	438.049	437.902	437.902	230.871	200.420	2403.009
19.	18th	239.816	438.049	438.049	437.902	437.902	230.871	200.420	2403.009
20.	19th	239.816	438.049	438.049	437.902	437.902	230.871	200.420	2403.009
21.	20th	239.816	438.049	438.049	437.902	437.902	230.871	200.420	2403.009
22.	21st	239.816	438.049	438.049	437.902	437.902	230.871	200.420	2403.009
23.	22nd	239.816	438.049	438.049	437.902	437.902	230.871	200.420	2403.009
24.	23rd	239.816	438.049	438.049	437.902	437.902	230.871	200.420	2403.009
25.	24th	239.816	438.049	438.049	437.902	437.902	230.871	200.420	2403.009
26.	25th	239.816	438.049	438.049	437.902	437.902	230.871	200.420	2403.009
27.	26th	239.816	438.049	438.049	437.902	437.902	230.871	200.420	2403.009
TOTAL		2147.738	8760.560	8760.980	8,758.040	11,166.728	1,686.968	1,091.076	42,282.510

This is a 'PROVISIONAL BUILDING PLAN' approved only for the purpose of using algorithms from the general public.

Checked and found to be in accordance with the provisions of the Building Bye-Laws, 2017.

Checked and found to be in accordance with the provisions of the Building Bye-Laws, 2017.

Checked and found to be in accordance with the provisions of the Building Bye-Laws, 2017.