

LAND SCHEDULE FOR LAND IN SEC 59-63					
SNO	VILLAGE	MUSTIL NO.	KILLA NO.	KANAL	MARLA
1	ULLAHAWAS	27	12/2	1	7
2			13/2	0	12
3			18 min	1	11
4			19 1/2 min	5	14
5			19/2	1	4
6			20	8	0
7			21 1/2 min	0	1
8			21 2/2 min	4	8.5
9			23 2/2 min	0	11
10	28		24 1/3	3	13
11			24 2/1 1/2	0	17
12			24 2/2	0	12
13			25 1/1	1	10
14			25 1/2 min	3	0
15	40		4/1	4	19
16			4/2	1	7
17			5/1	3	12
18			7/2	1	9
19	BEHRAMPUR	45	14/1	5	9
20			14/2	3	14
21			15 1/1	2	9
22			15 1/2	1	19
23			15 2/2 1/2	0	7
24			16 2/1	1	9
25			16 2/2	1	4
26			16 2/3	1	14
27			17/1	3	2
28			17/2	4	18
29			18/1	0	19
30			18/2	1	7
31			24	7	18
TOTAL APPLIED LAND					311.5
TOTAL					11.5
					10.071875 ACRES

AREA DETAIL :-
 A) TOTAL SITE AREA = 10.071875 Acres = 40759.367 Sq.mt.
 B) AREA UNDER 24 M WIDE ROAD = 4264.609 Sq.mt.
 C) AREA UNDER 12 M WIDE SERVICE ROAD = 894.556 Sq.mt.
 D) AREA UNDER PROP. 60.0 M WIDE ROAD = 974.439 Sq.mt.
 E) SITE AREA LEFT (A-(B+C+D)) = 40759.367 - (4264.609 + 894.556 + 974.439) = 34625.763 Sq.mt. = 8.556 Acres

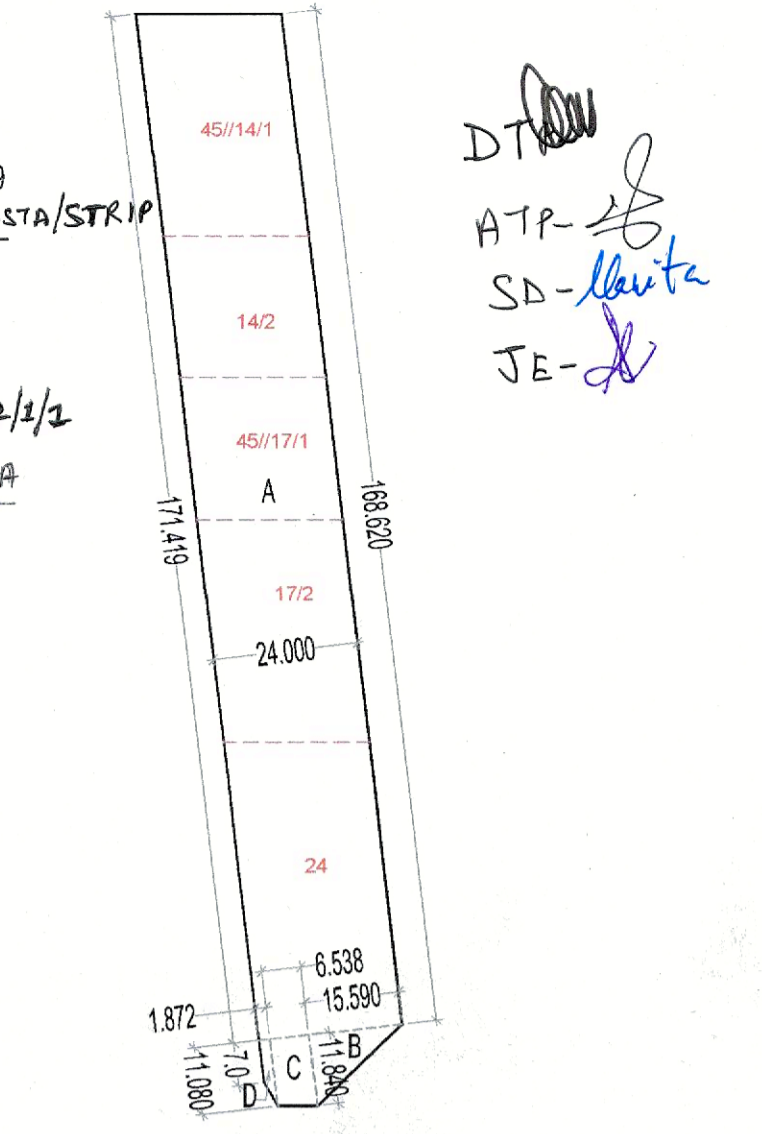
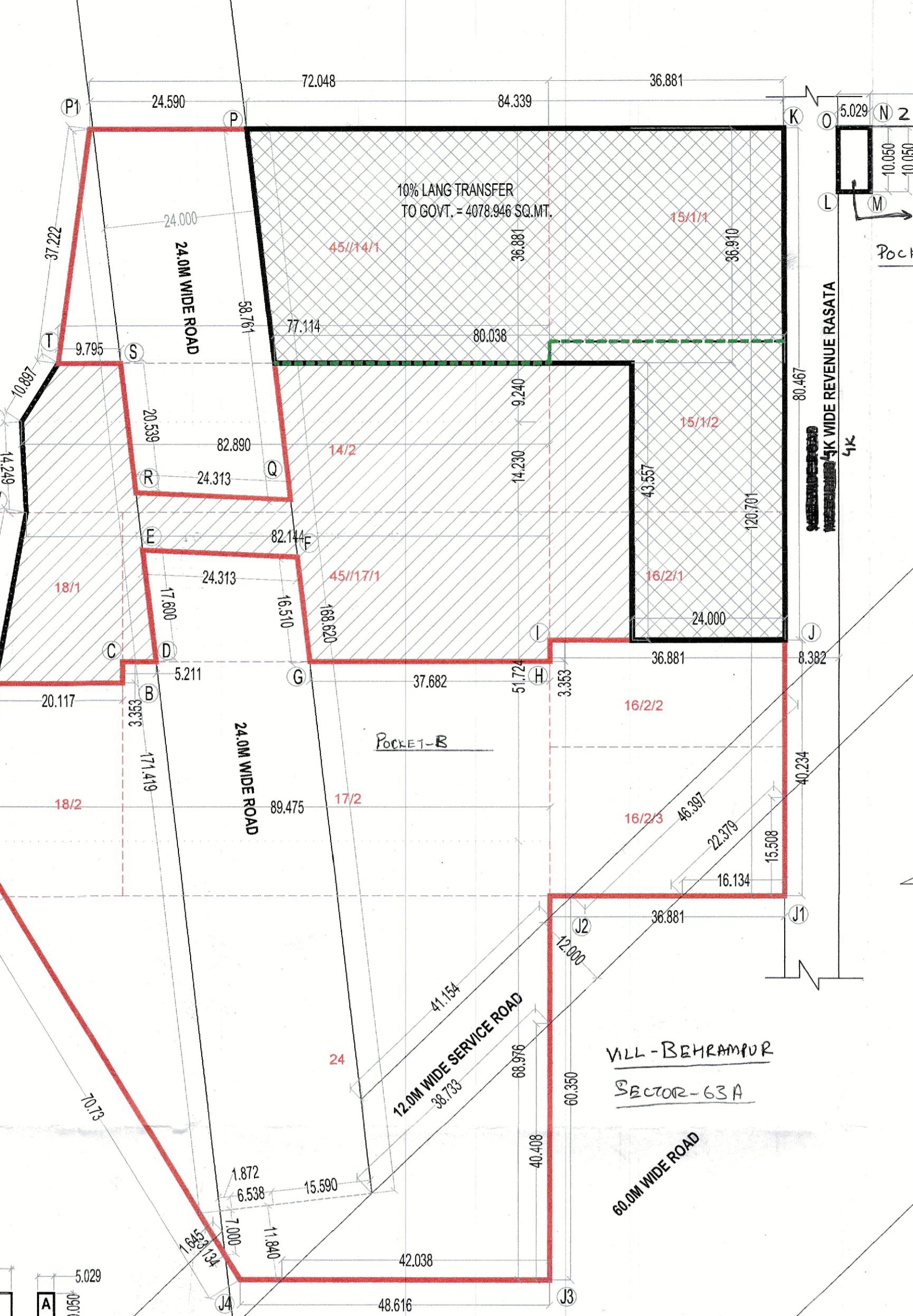
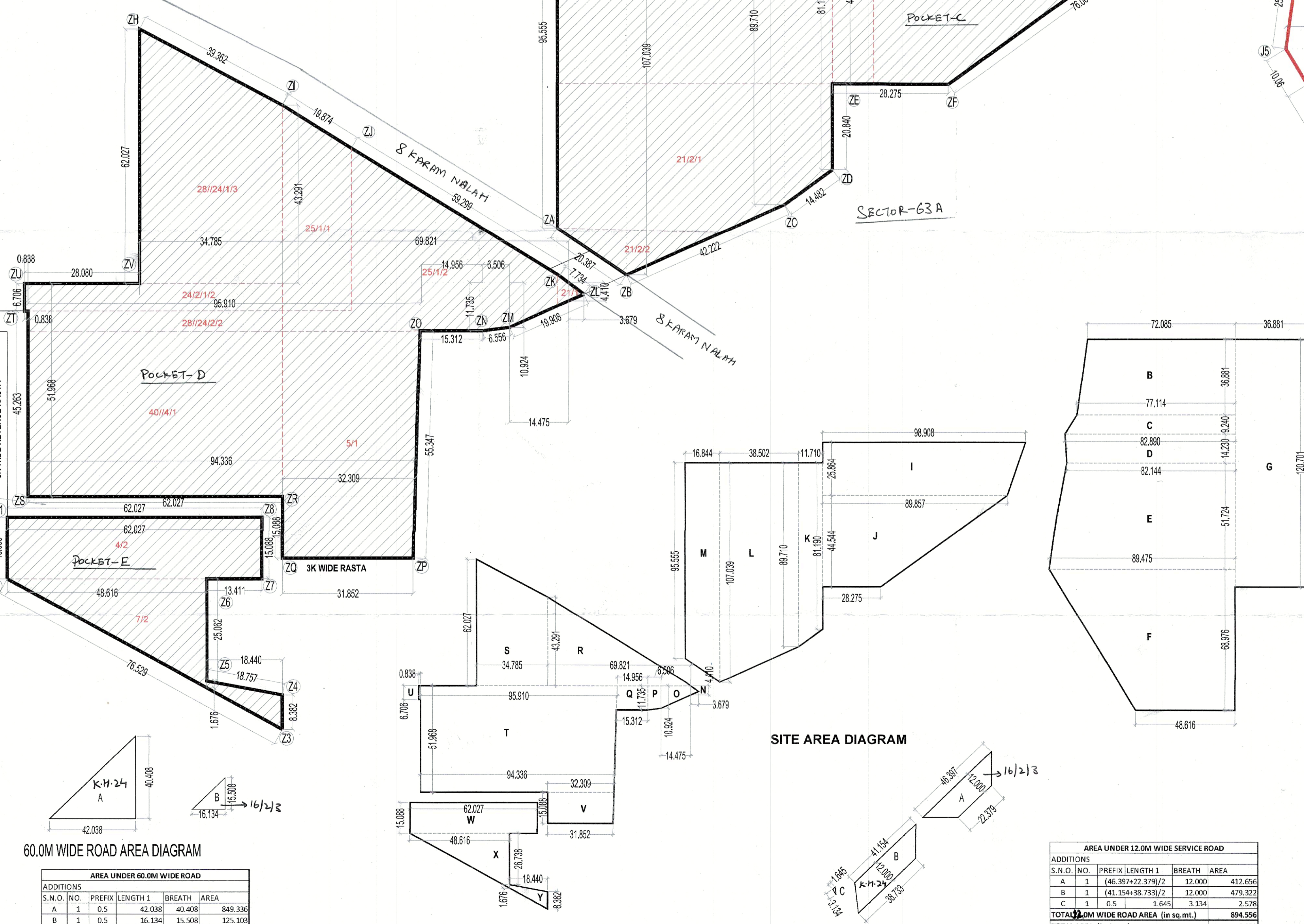

24.0M WIDE ROAD AREA DIAGRAM

AREA UNDER 24.0M WIDE ROAD					
S.N.O.	NO.	PREFIX	LENGTH 1	BREATH	AREA
A	1	(171.419+168.620)/2	24.000	4,080.468	
B	1	0.5	15.590	11.840	92.293
C	1	(11.080+11.840)/2	6.538	74.925	
D	1	(7.0+11.080)/2	1.872	16.933	
TOTAL 24.0M WIDE ROAD AREA (in sq.mt.)					4,264.609
TOTAL AREA (in Acres)					1.034

LEGEND:-

- EXISTING LICENCE
- 10% LAND TO BE TRANSFER TO GOVT.
- ADDITIONAL LAND LOT GRANTED

TITLE:-
 DEMARCATION PLAN FOR NILP COLONY OVER AN OVER AREA OF 10.071875 ACRES (7.434375 THROUGH MIGRATION FROM DDJAY AFFORDABLE PLOTTED COLONY LC NO. 92 OF 2023 DATED 21-04-2023 AND ADDITIONAL APPLIED LAND OF AREA MEASURING 2.6375 ACRES) FALLING IN THE REVENUE ESTATE OF VILLAGE BEHRAMPUR & ULLAHAWAS, SECTOR 59 & 63, G.M.U.C. (HR) BEING DEVELOPED BY - 4S DEVELOPERS PVT.LTD.)

OWNERS SIGNATURE:- ARCHITECT SIGNATURE:-

For 4S Developers Pvt. Ltd.
 Authorised Signatory

DRAWING TITLE:
 DEMARCATION PLAN

DATE:- FEB.-2022 NORTH SHEET NO. 01
 SCALE:- 1:550(A1)

60.0M WIDE ROAD AREA DIAGRAM

AREA UNDER 60.0M WIDE ROAD					
S.N.O.	NO.	PREFIX	LENGTH 1	BREATH	AREA
A	1	0.5	42.038	40.408	849.336
B	1	0.5	16.134	15.508	125.103
TOTAL 60.0M WIDE ROAD AREA (in sq.mt.)					974.439
TOTAL AREA (in Acres)					0.240

12.0M WIDE ROAD AREA DIAGRAM

AREA UNDER 12.0M WIDE SERVICE ROAD					
S.N.O.	NO.	PREFIX	LENGTH 1	BREATH	AREA
A	1	(46.397+22.379)/2	12.000	412.656	
B	1	(41.154+38.733)/2	12.000	479.322	
C	1	0.5	1.645	3.134	2.578
TOTAL 12.0M WIDE ROAD AREA (in sq.mt.)					894.556
TOTAL AREA (in Acres)					0.221

SITE AREA (Pocket-A to E)

S.N.O.	NO.	PREFIX	LENGTH 1	BREATH	AREA
A	1	5.029	10.050	50.541	
B	1	(72.085+77.114)/2	36.881	2,751.304	
C	1	(77.114+82.890)/2	9.240	739.218	
D	1	(82.890+82.144)/2	14.230	1,174.217	
E	1	(82.144+89.475)/2	51.724	4,438.411	
F	1	(89.475+48.616)/2	68.976	4,762.482	
G	1	36.881	120.701	4,451.574	
I	1	(98.908+89.857)/2	25.864	2,441.109	
J	1	(89.857+28.275)/2	44.544	2,631.036	
K	1	(89.71+81.19)/2	11.710	1,000.620	
L	1	(107.039+89.71)/2	38.502	3,787.615	
M	1	(107.039+95.555)/2	16.844	1,706.247	
N	1	0.5	3.679	4.410	8.112
O	1	(10.924+4.411)/2	14.475	110.980	
P	1	(11.735+10.924)/2	6.506	73.710	
Q	1	(15.312+14.956)/2	11.735	177.597	
R	1	0.5	43.291	69.821	1,511.310
S	1	(62.027+43.291)/2	34.785	1,831.743	
T	1	(95.910+94.336)/2	51.968	4,943.352	
U	1	0.838	6.706	5.620	
V	1	(32.309+31.852)/2	15.088	484.031	
W	1	62.027	15.088	935.863	
X	1	0.5	48.616	26.738	649.947
Y	1	(1.676+8.382)/2	18.440	92.735	
TOTAL ADDITIONS					40,759.374
TOTAL SITE AREA (in SQ.MT.)					40759.374
TOTAL SITE AREA (in ACRES)					10.071875

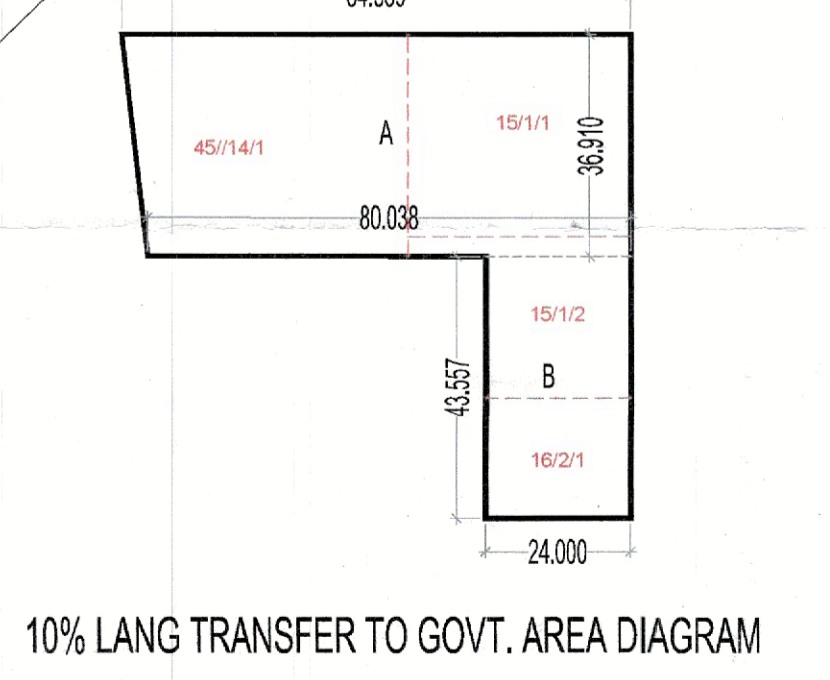

10% LANG TRANSFER TO GOVT.

S.N.O.	NO.	PREFIX	LENGTH 1	BREATH	AREA
A	1	(84.339+80.038)/2	36.910	3,033.578	
B	1	24.000	43.957	1,045.368	
TOTAL 10% LANG TRANSFER TO GOVT. AREA (in sq.mt.)					4,078.946
TOTAL AREA (in Acres)					1.007