

ZONING PLAN OF GROUP HOUSING COLONY AREA MEASURING 5.43263 ACRES (LICENCE NO. 128 OF 2022 DATED 24.08.2022 IN SECTOR-63A, GURUGRAM BEING DEVELOPED BY ANANT RAJ LTD.

For purpose of Code 1.2 (ccv) & 6.1 (1) of the Haryana Building Code, 2017, amended from time to time.

1. SHAPE & SIZE OF SITE.

The shape and size of site is in accordance with the demarcation plan shown as A to P as confirmed by DTP, Gurugram vide Enfr No. 10493 dated 29.08.2022.

2. TYPE OF BUILDING PERMITTED AND LAND USES.

- (a) The type of building permitted on this site shall be buildings designated in the form of flatted development for residential purpose or any ancillary or appurtenant building, including community facilities, public amenities and public utility as may be prescribed and approved by the Director General, Town and Country Planning, Haryana.
- (b) The site shall be developed and building constructed thereon as indicated in and explained in the table below:

Notation	Land use Zone	Type of Building permitted / permissible structure
○	Open Space Zone	Open parking, garden, landscaping features, underground services etc.
■	Building Zone	Building as per permissible land use in clause-a above and uses permissible in the open space zone.

3. SITE COVERAGE AND FLOOR AREA RATIO (FAR)

- (a) The building or buildings shall be constructed only within the portion of the site marked as Building zone as explained above, and over the same.
- (b) The maximum coverage on ground floor shall be 35% and on subsequent floors shall be 30% on the area of 4.3263 acres.
- (c) Maximum Permissible FAR shall be 175 on the area of 5.43263 acres. However, it shall not include community buildings, which shall be as per the prescribed norms; the building plan of which shall have to be got approved from the Director General, Town and Country Planning, Haryana.

4. HEIGHT OF BUILDING.

- The height of the building block, subject to course to the provisions of the site coverage and FAR, shall be governed by the following:
- (a) The maximum height of buildings shall be as per Code 6.3 (3)(viii) of the Haryana Building Code, 2017.
- (b) The plinth height of building shall be as per Code 7.3 of the Haryana Building Code, 2017.
- (c) All building blocks shall be constructed so as to maintain an inter-site distance not less than the set back required for each building according to the table below:

Sr.No.	HEIGHT OF BUILDING (in meters)	SET BACK / OPEN SPACE TO BE LEFT AROUND BUILDINGS (in meters)
1	3	3
2	15	5
3	18	6
4	21	7
5	24	8
6	27	9
7	30	10
8	35	11
9	40	12
10	45	13
11	50	14
12	55 & above	16

- (d) If each lot/lot or exterior open space is intended to be used for the benefit of more than one building belonging to the same owner, then the width of such open space shall be the one specified for the parking block as specified in (c) above.

5. PARKING

- (a) Adequate parking spaces, covered, open or in the basement shall be provided for vehicles of users and occupants, within the site as per Code 7.1 of the Haryana Building Code, 2017.
- (b) In no circumstance, the vehicle(s) belonging/related to the plot/premises shall be parked outside the plot area.

6. APPROACH TO SITE

- (a) The vehicular approach to the site and parking lots shall be planned and provided giving due consideration to the junctions of and the junctions with the surrounding roads to the satisfaction of the DTP/Haryana.
- (b) The approach to the site shall be shown on the zoning plan.

7. GATE POST AND BOUNDARY WALL

- (a) Each Boundary wall, railing or their combination, hedges or fences along with gates and gate posts shall be constructed as per design approved by Competent Authority. In addition to the gate/ gates an additional wicket gate not exceeding 2.0 meters width may be allowed in the front and side boundary wall provided that no main gate or wicket gate shall be allowed to open on the sector road/public open space.
- (b) The boundary wall shall be constructed as per Code 7.5 of the Haryana Building Code, 2017.

8. DENSITY

- (a) The minimum density of the population provided in the colony shall be 100 PPA and maximum be 300 PPA on the area of 4.3263 acres.
- (b) For computing the density, the occupancy per main dwelling unit shall be taken as five persons and for service dwelling unit two persons per room or one person per 80 square feet of living area, whichever is more.

9. ACCOMMODATION FOR SERVICE POPULATION

- Adequate accommodation shall be provided for domestic servants and other service population of CWS. The number of such dwelling units for domestic servants shall not be less than 15% of the number of main dwelling units and the carpet area of such a unit if attached to the main units shall not be less than 140 sqft. In addition 15% of the total number of dwelling units having a minimum area of 200 sqft shall be reserved for L-1 category.

10. CONVENIENT SHOPPING

- 0.5% of the area of 5.43263 acres shall be reserved to cater for essential convenient shopping with following conditions:
- (a) The ground coverage of 100% with FAR of 300 will be permissible. However, this will be a part of the permissible ground coverage and FAR of the Group Housing Colony.
- (b) The size of Kiosk/Shop shall not be more than 2.75 mtr x 2.75 mtr and 2.75 mtr x 8.25 mtr.
- (c) The height of Shop/Shop/ Departmental stores shall not exceed 4.0 mtr.

11. OPEN SPACES

- Within all the open spaces including those between the blocks and wings of buildings shall be developed, equipped and landscaped according to the plan approved by the Competent Authority. At least 15% of the total site area shall be developed as organized open space i.e. tot lots and play ground.

12. PROVISIONS OF COMMUNITY BUILDINGS

- The community buildings shall be provided as per the composite norms in the Group Housing Colony.

13. BAR ON SUB-DIVISION OF SITE

- (a) The site of the Group Housing Colony shall be governed by the Haryana Apartment Ownership Act 1988 and Rules framed thereunder.
- (b) Sub-division of the site shall not be permitted.

14. APPROVAL OF BUILDING PLANS

- The building plans of the buildings to be constructed at site shall have to be got approved from the Director Town & Country Planning, Haryana/ any other persons or the committee authorized by him, as per provision of Haryana Building Code- 2017 (as amended time to time) before starting up the construction.

15. BASEMENT

- (a) The number of basement stores in Group Housing shall be as per Code 6.3(3)(viii) of the Haryana Building Code, 2017.
- (b) The construction of basement shall be executed as per Code 7.16 of the Haryana Building Code, 2017.

16. PROVISIONS OF PUBLIC HEALTH FACILITIES

- The W.C. and urinals provided in the buildings shall conform to the Haryana Building Code, 2017 and National Building Code, 2016.

17. EXTERNAL FINISHES

- (a) The external wall finishes, so far as possible shall be in natural or permanent type of materials like bricks, stone, concrete, terrazzo, granite, marble, clay, glass, glass blocks or any other finish which may be allowed by the Competent Authority.
- (b) All sign boards and names shall be written on the spaces provided on buildings as per approved buildings plans specifically for this purpose and at no other places, whatsoever.
- (c) For building services, plumbing services, construction practice, building material, foundation and Damp Proof Course Chapter 10 of the Haryana Building Code, 2017 shall be followed.

18. LIFTS AND RAMPS

- (a) Lift and Ramps in building shall be provided as per Code 7.7 of the Haryana Building Code, 2017.
- (b) Lift shall be provided with 100% standby generators along with automatic walkover along with staircase of required width and number.
- (c) Ramps shall also be provided as per the provisions of Haryana Building Code, 2017 and National Building Code, 2016, as applicable.

19. BUILDING BYE-LAWS

- The construction of the building/buildings shall be governed by provisions of the Haryana Building Code, 2017. On the points where Haryana Building Code, 2017 is silent the National Building Code of India, 2016 shall be followed.

20. FIRE SAFETY MEASURES

- (a) The owner will ensure the provision of proper fire safety measures in the multi storied buildings conforming to the provisions of The Haryana Building Code, 2017 National Building Code of India, 2016 and the same should be got certified from the Competent Authority.
- (b) Electric Sub Station/ generator room if provided should be on solid ground near DG/ LT. Control panel on ground floor or in upper basement and it should be located on outer periphery of the building, the same should be got approved from the Competent Authority.
- (c) To ensure fire fighting scheme shall be got approved from the Director, Urban Local Bodies, Haryana or any person authorized by the Director, Urban Local Bodies, Haryana. This approval shall be obtained prior to starting the construction work at site.

21. That the colonizer/owner shall obtain the clearance/NOC as per the provisions of the Notification No. S.O. 2133 (1) Dated 14.8.2006, issued by Ministry of Environment and Forest, Government of India before starting the construction.

22. That the rain water harvesting system shall be provided as per Central Ground Water Authority norms/Haryana Govt. notification as applicable.

23. That the colonizer/owner shall use only Light-Emitting Diode lamps (LED) fitting for internal lighting as well as Campus lighting.

24. That the colonizer/owner shall strictly comply with the directions issued vide Notification No. 19/10/2018-SP dated 31.03.2018 issued by Haryana Government Renewable Energy Department.

25. That the colonizer/owner shall ensure the installation of Solar Photovoltaic Power Plant as per provisions of order No. 22/52/2005-S/Power dated 23.03.2016 issued by Haryana Government Renewable Energy Department.

26. GENERAL

- (a) Among other plans and papers, detailed elevations of buildings along all sides exposed to public view shall be drawn according to scale as mentioned in the Haryana Building Code-2017.
- (b) The water storage tanks and other plumbing works etc. shall not be exposed to view each face of building but shall be suitably enclosed.
- (c) No applied decoration like inscription, crosses, names of persons or buildings are permitted on any external face of the building.
- (d) Garbage collection center of appropriate size shall be provided within the site.
- (e) Color trade emblems and other symbols shall be subject to the approval of the Competent Authority.

DRG No. DG.TCP- 8710 Dated 31-10-2022

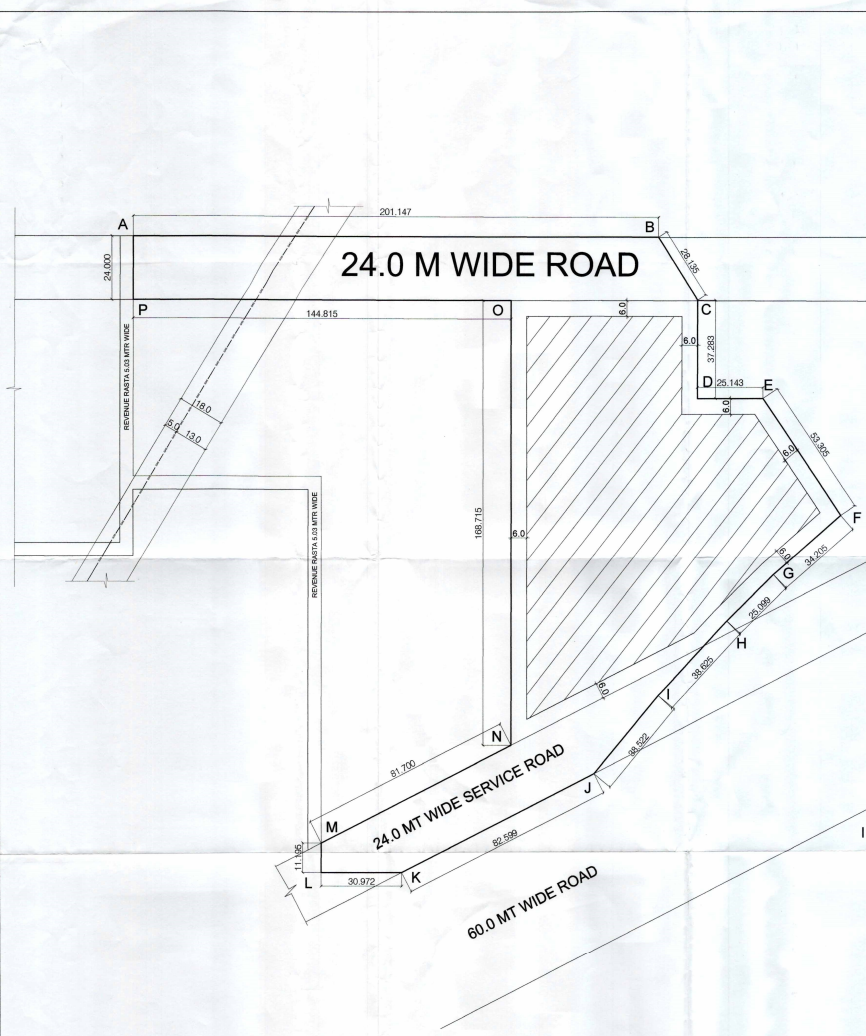

ALL DIMENSIONS ARE IN METERS.
ZONED AREA = 10952.7142 SQM (2.706 ACRES)

(RAM ANANT BASSI) ADH(C)
(SARJAY NARANG) ATP(HQ)
(R.S. BATHI) DTP (HQ)
(HITESH SHARMA) STRP (HQ)
(SINGH) CTP (HR)
(T.L. SATYAPRAKASH) IAS) DG,TCP (HR)